

Ready for your kitchen installation?
Our guide will help you.



wren
AFFORDABLE LUXURY KITCHENS

Index

Wren Kitchens Installation Tips.....	3
Carefully check your kitchen delivery.....	4
Measuring out and marking up	5
Fitting the base cabinets	6
Fitting the corner cabinets	7
The 972mm or 'L' shaped corner base and Internal Curved Corner base.....	11
Door and Drawer adjustment	13
Curved Base unit.....	16
Belfast Sink Base.....	17
Half Height Base Unit.....	18
Attaching Plinth.....	19
Larder Units and Appliance Housing	20
Fitting the Wall Cabinets.....	21
Cornice and Light Pelmet	25
Curved Cornice and Light Pelmet	26
Curved Posts.....	27
Fitting Handles.....	28
Lighting.....	29

Wren Kitchens Installation Tips

All Wren Kitchens are built to the highest specifications and from the best quality materials and components. To ensure you get many years of enjoyment from your new kitchen, we have compiled this guide to help you through the installation process.

If you are going to install your new kitchen yourself, make sure you have pre-booked qualified service engineers and plumbers to connect up appliances, sinks and taps as the installation progresses.



The following instructions are simple but helpful kitchen installation guidelines. We list the sequence of events you need to follow to successfully install your kitchen and point out some of the potential complications that could arise or cause delays during installation.

Ready for your kitchen installation?

Please read all of the information contained within this guide before proceeding with your kitchen installation. We at Wren Kitchens strongly advise you to get professional help if you are at all unsure on any of the points covered in the guide pages.

Make sure that any pre-installation work on re-positioning electrical sockets, gas and water supplies has been carried out before you start installing your Wren Kitchen.

Carefully check your kitchen delivery

Look over each item that has been delivered for your Wren Kitchen. If there is any noticeable damage to the packaging, open the pack and check if the item of furniture or component is damage free.

If the item is damaged please advise the driver. When you sign for the delivery please mention what item is damaged.



If any damage has occurred you have 48 hours from delivery to report this to Wren Customer Services on: **0845 404 1000**

Using your invoice or delivery note, try to group your furniture into the following categories making sure that you know what is in each package – base cabinets, wall cabinets, tower cabinets, appliances, worktop, sinks & accessories.

If you have enough space, stack your grouped cabinets outside your empty kitchen. You can then fit each item without having to climb over anything.

At this stage leave the packaging on the furniture, only unwrap when you need each item. This will avoid damaging the pieces when they are moved around.

Measuring out and marking up

The base cabinets for your Wren Kitchen will be installed first.

Before you start to bring any cabinets into your kitchen, you should mark a horizontal line onto your walls to help check the level of your kitchen. This is critical to ensure a professional kitchen fit.

Find the highest point on your kitchen floor where wall and floor meet.

A laser leveller is the best tool for this task.

Mark a horizontal line 150mm above the highest point around your walls. This line will indicate the bottom line of your run of base cabinets. You can adjust each cabinet leg to ensure your base cabinet run is horizontal.

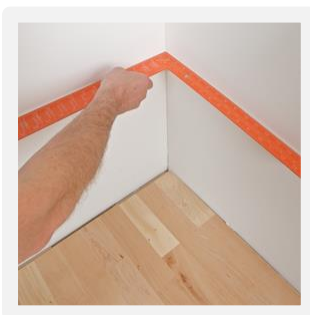
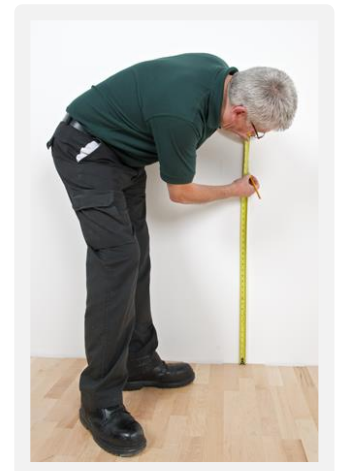

Draw a second horizontal line 720mm above the bottom line. 870mm is the height of your base cabinets including the 150mm plinth so this will give you the level position for the top of each cabinet.

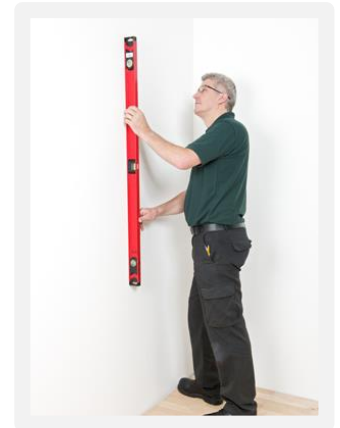

Check how square your kitchen corners are if you have included any base corner cabinets in your kitchen.

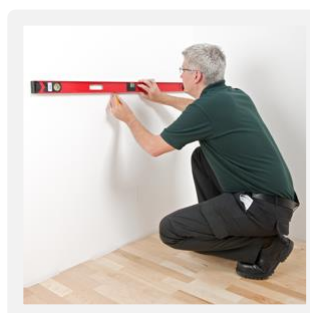

Using a spirit level or your laser leveller, check the flatness and vertical line of your walls. This will give you some idea of what cabinet levelling needs to take place for your base, wall and tall cabinets.

You now have the horizontal position for your base cabinets marked out. Using your kitchen plan, mark out the approximate width of each cabinet on to your wall to check that service elements are positioned as you want them.

Fitting the base cabinets

Begin your kitchen installation with the base cabinets, installing them one cabinet at a time.

If you have a corner base cabinet in your kitchen then start the installation here.

Remove all of the packaging. Release the clip hinges and take the door off the cabinet, take out the drawer box and remove the shelves. Keep all these in a safe place until they're needed.

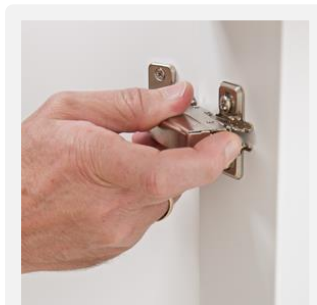
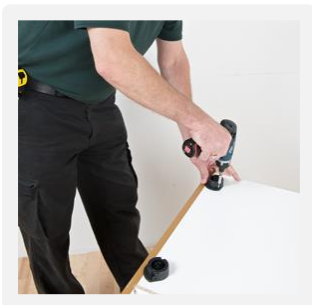

Position the cabinet approximately in the space you have already marked for it.

Screw fix the black adjustable legs to the underside of the cabinet. Four legs should be attached to cabinets up to 600mm wide, fix legs on all 800mm, 900mm and 1000mm wide cabinets and eight on 972mm 'L Shaped' cabinets.

The holes for the legs have been pre-drilled. There are 2 positions.

The first position will position the legs 25mm away from the front of the unit.

The second position will have the legs stepped back to 100mm away from the front of the unit.

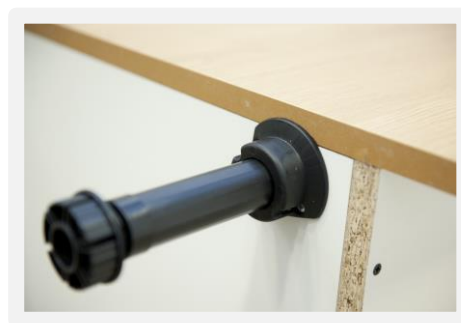
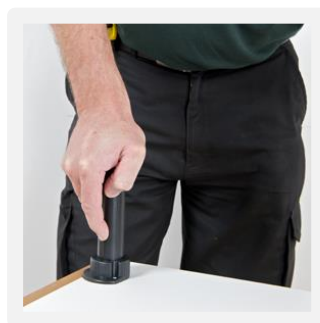

Fitting the corner cabinets

Level the cabinet against your 870mm horizontal line and will fix with the appropriate screws. If your corner is not square i.e. more or less than 90° you must ensure the position of your corner cabinet to make sure that adjoining cabinets can be levelled and fixed to the wall correctly.

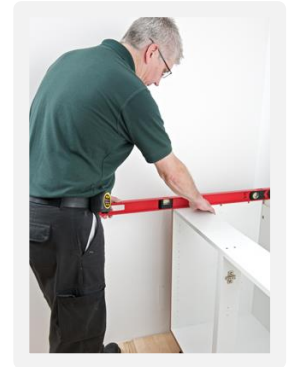

Wren Kitchens have developed a base corner post which must be fixed to your base corner cabinet before installing the adjoining base cabinets.

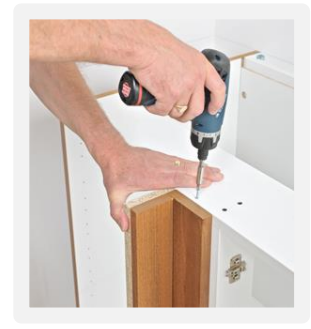
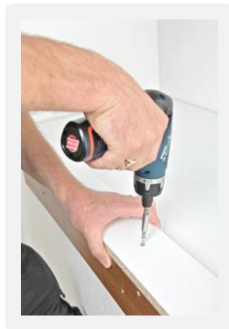
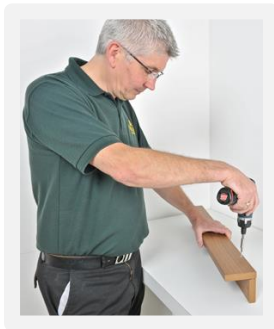

Please see the three diagrams on the following pages for information on void allowance for the Standard Corner Cabinets.

Continue your base cabinet run out from the corner. Level each cabinet to the 870mm horizontal line by adjusting each cabinet leg in turn. Then wall fix the cabinet using the steel brackets provided. Firstly, attach the brackets to the top inside face of each end panel with the screws provided then fix the cabinet to the wall using suitable screws (these screws are not provided due to the many different type of wall the cabinet could be fixed to).

Adjustable Corner Posts for Linda Barker Range Corner Units

Example below shows a Standard 1000 corner base with the 2 ways the Adjustable Corner Post can be used.

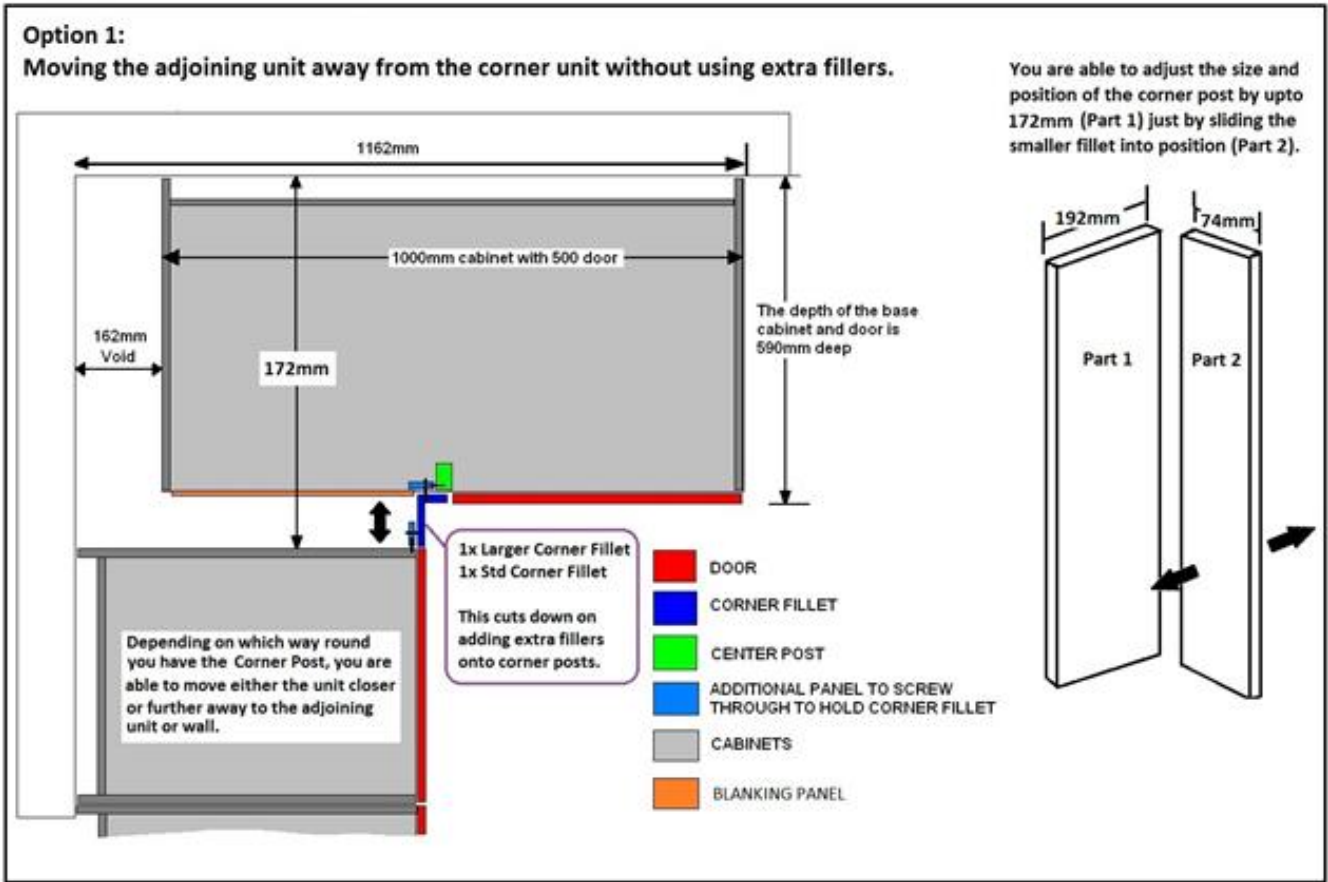

You are able to adjust the size and position of the corner post by upto 172mm (Part 1) just by sliding the smaller fillet into position (Part 2).

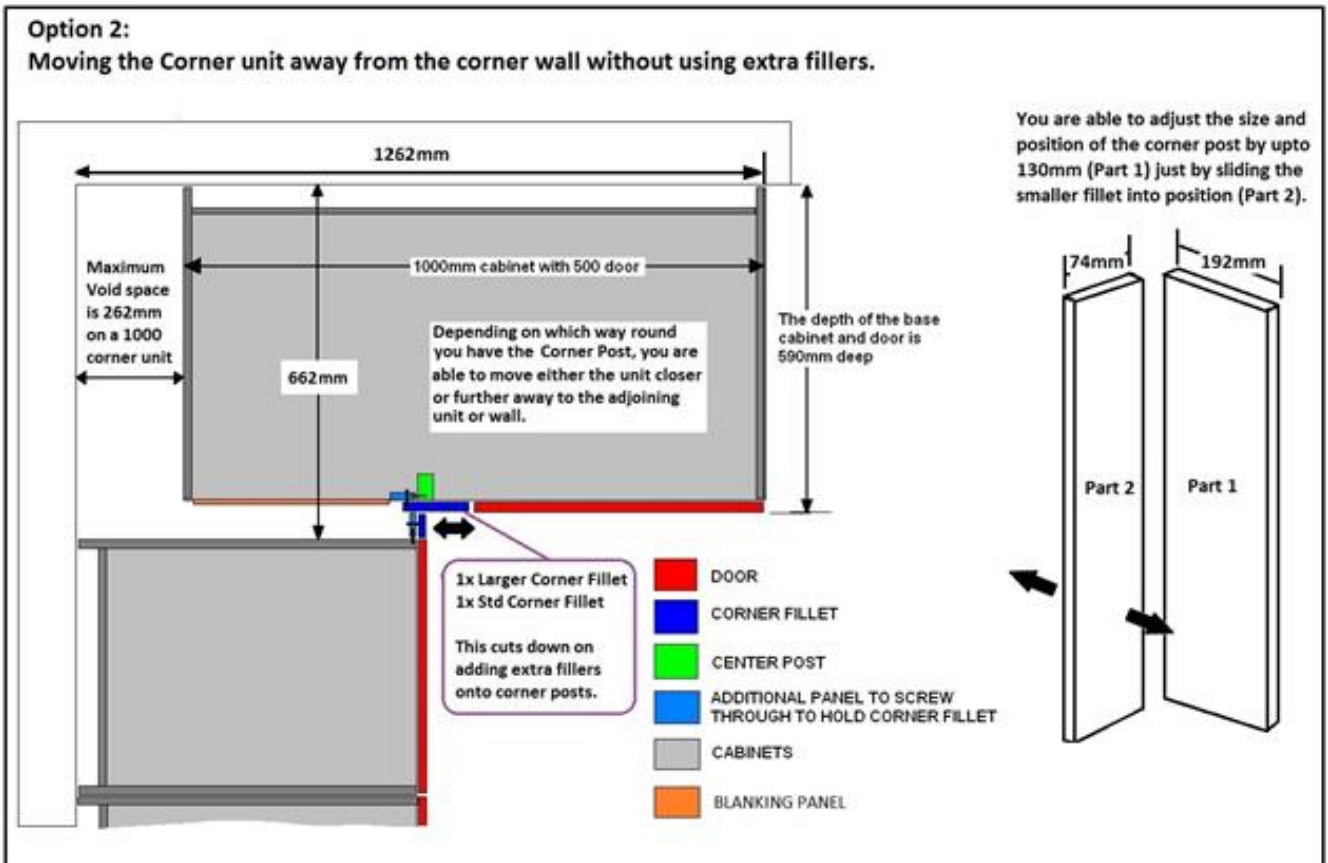

You are able to adjust the size and position of the corner post by upto 130mm (Part 1) just by sliding the smaller fillet into position (Part 2).

Standard base corner units

800 Standard Corner Cabinet

Standard Position showing Void space.

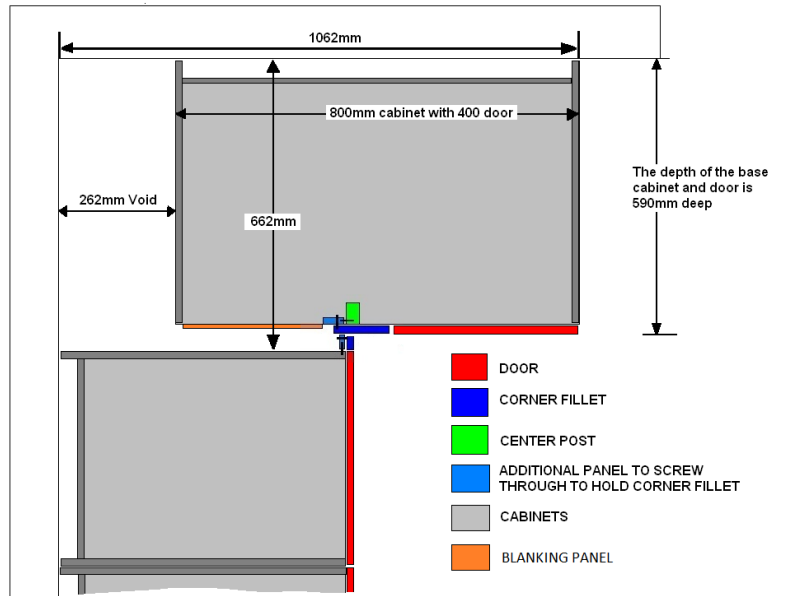

900 Standard Corner Cabinet

Standard Position showing Void space.

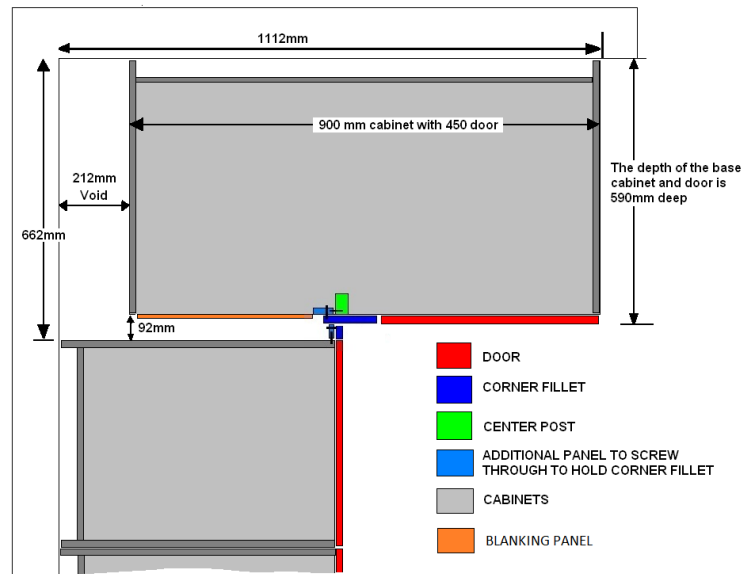

1000 Standard Corner Cabinet

Standard Position showing Void space.

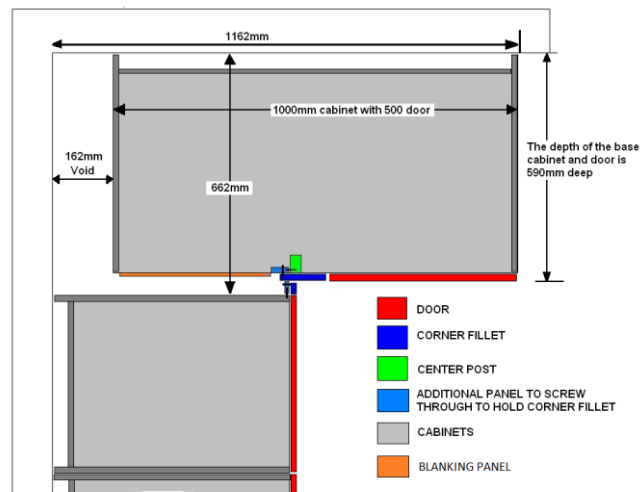

Standard Corner Posts for Designer Ranges

800 Standard Corner Cabinet

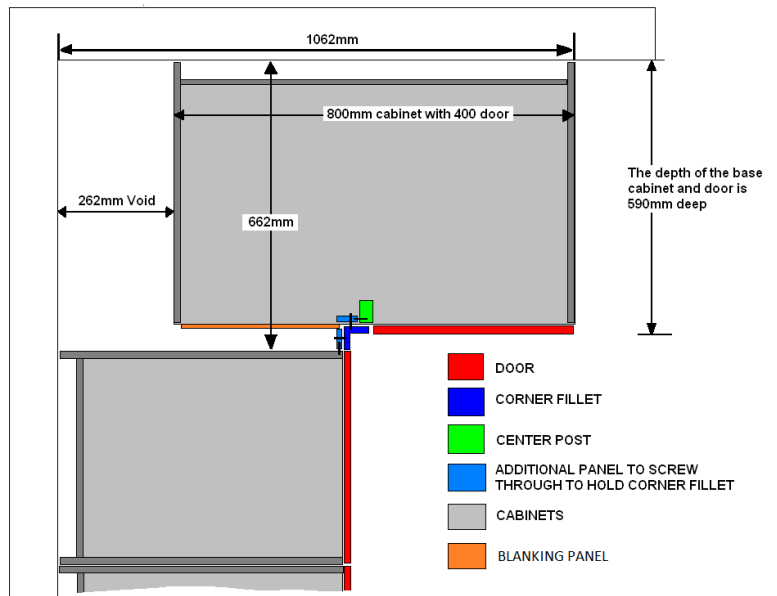

900 Standard Corner Cabinet

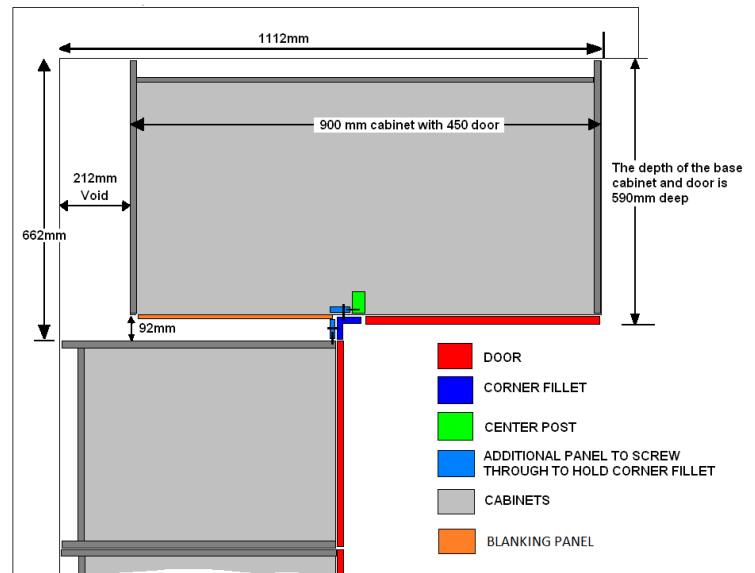

1000 Standard Corner Cabinet

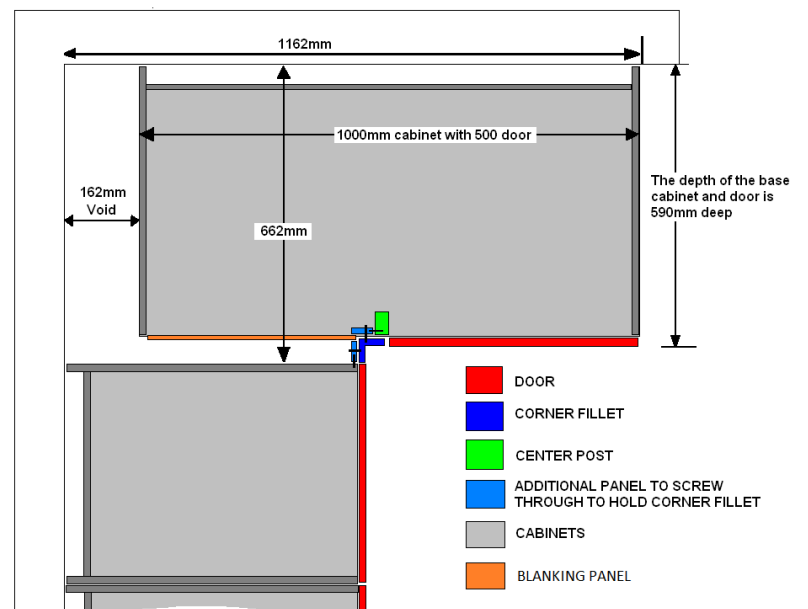

The 972mm or 'L Shaped' Corner Base and Internal Curved Corner Base

The 972mm corner base does not require a void, the side panels are fixed to both walls.

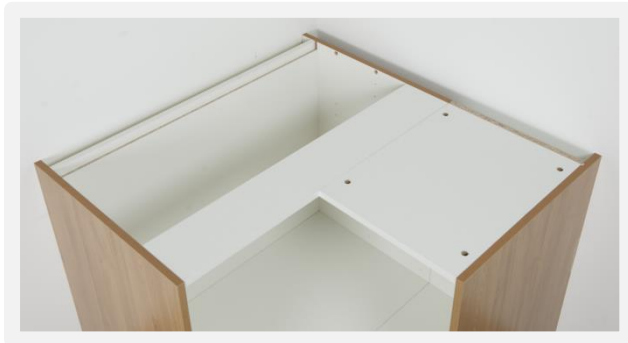

Unlike the standard corner base units, the corner post on the 972mm corner base is not fixed to the cabinet, but attached to one of the doors using the brackets provided.

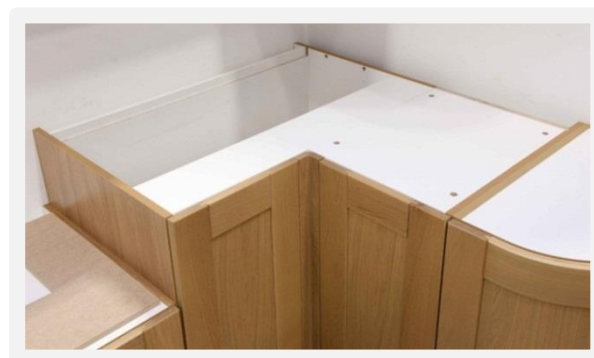

'L' shaped corner base

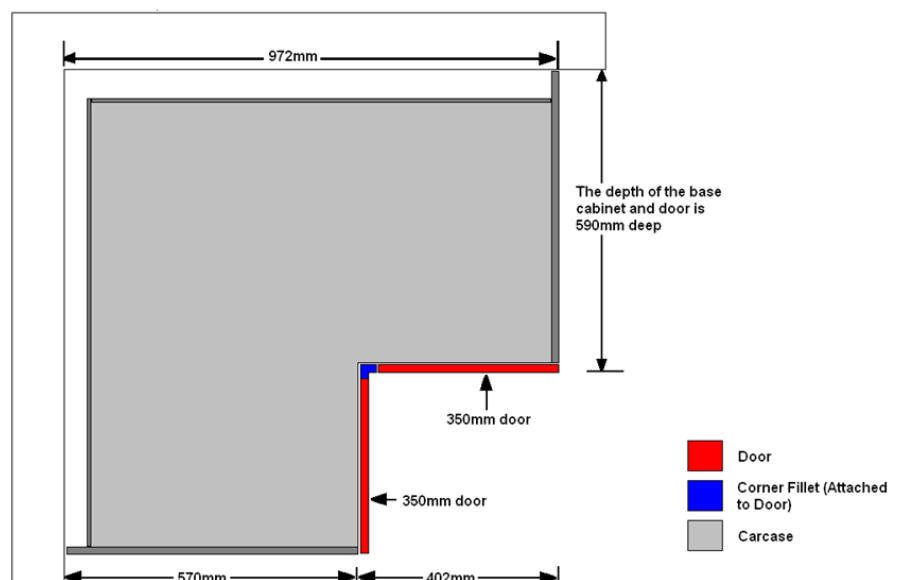

As you continue to position and fix each cabinet you must ensure that each one is levelled and square before final fixing. To secure your cabinets to each other, brace them with a gripping tool.

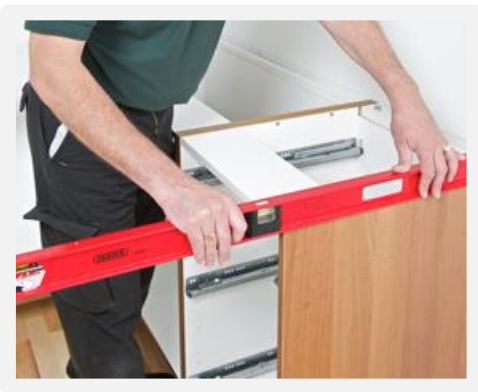
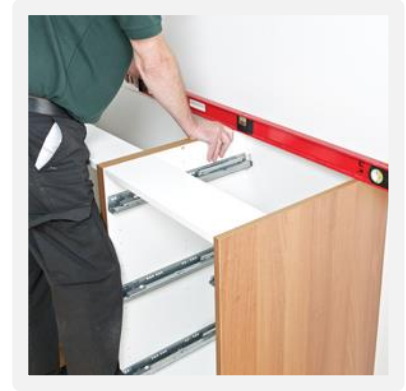

Once joined and level, simply screw the cabinets together using a 'self tapping screw' which is no longer than 30mm. Do this behind the hinge plate and for extra strength you could add a further screw to the rear of the unit, hidden behind the shelf edge.

Re-fit all doors, drawer boxes and shelves into each base cabinet in turn. This will mean you are not faced with an ever increasing pile of doors, drawer boxes etc cluttering your space.



You should adjust and level each door and drawer front as you go along. Try to make sure that gaps and lines are consistent as you install each cabinet.

Door and drawer adjustment

The “clip-on” door hinges we have chosen for your kitchen are of the finest quality.

Once you have clipped the hinge arm back on to its mounting plate to connect the door back to the cabinet, you can still adjust the door up and down, side to side and in and out.

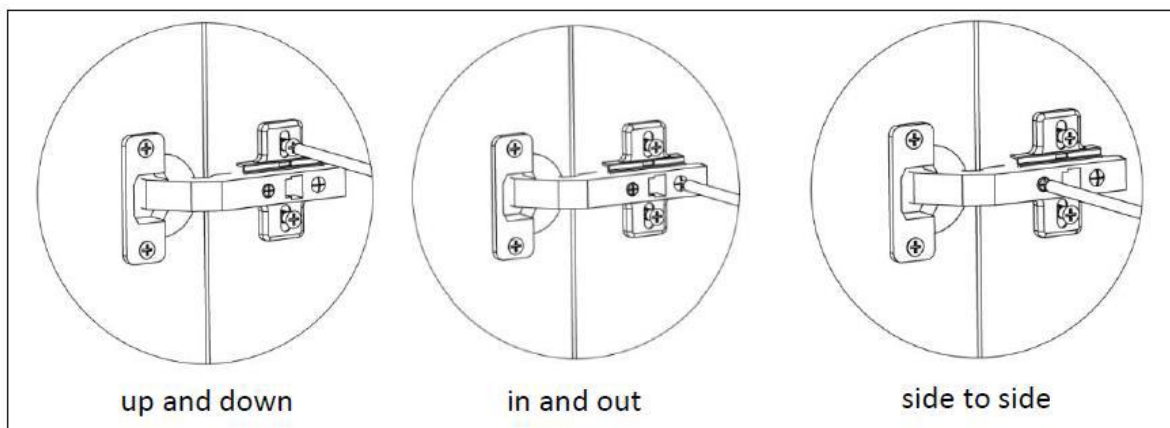

This fine turning will even out all the gaps between your doors and drawers to make your kitchen look fantastic.

Your drawer boxes and runners have a soft closing mechanism to ensure that you cannot slam close a drawer. As with your door hinges we have chosen the best drawer system on the market. All base drawer cabinets are delivered fully assembled.

Once you have installed the drawer cabinet, each drawer can be adjusted up and down and side to side to maintain constant gaps around your kitchen.



Making adjustments to the drawer box and Frontal

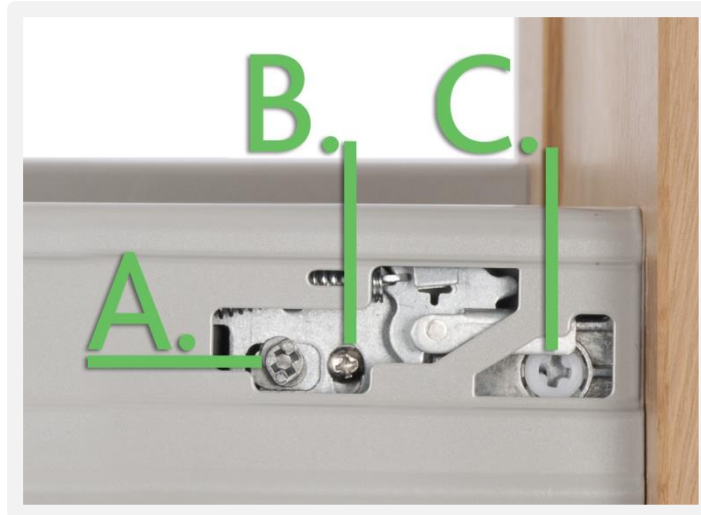

1. Screw A adjusts the drawer front up and down.
2. Screw B is the locking screw to hold your drawer in place after adjustment
3. Screw C adjusts the drawer front from side to side

When the drawer has been aligned and the locking screw tightened, clip the plastic cover plates into place as below.



Extra Value Soft Close Drilling for Drawers



FIG.N.BLS.044 - Slowmotion Zeta Damper Blister

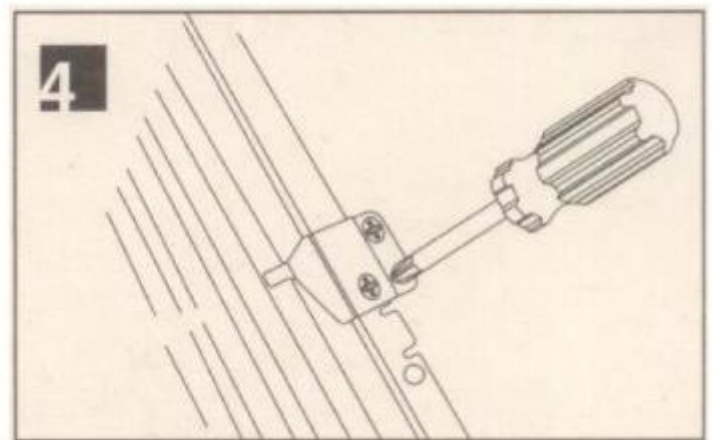
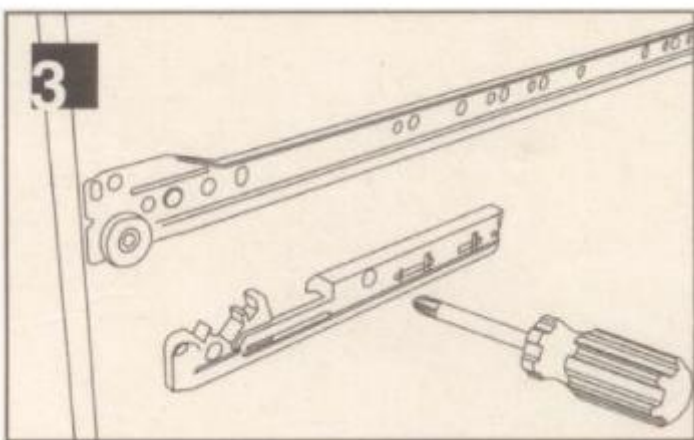
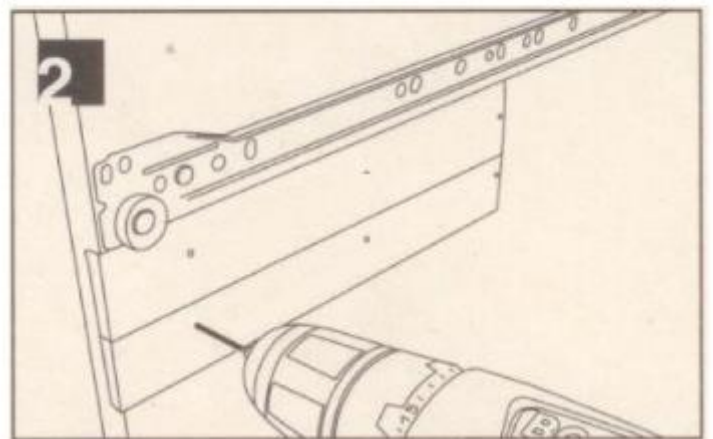
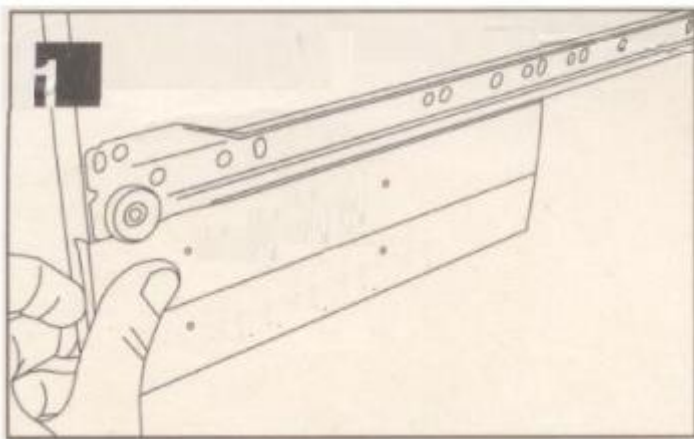

Curved Base Unit

Remove all packaging. Release the clip hinges and take off the door. Screw fix the black adjustable legs to the underside of the cabinet.

Level the cabinet to 870mm horizontal line by adjusting the cabinet legs then brace with a gripping tool to the cabinet.

When all the levels are checked, screw together using 'self-tapping screw' no longer than 30mm just in front of the hinge plate and in the recess at the rear of the adjacent unit.

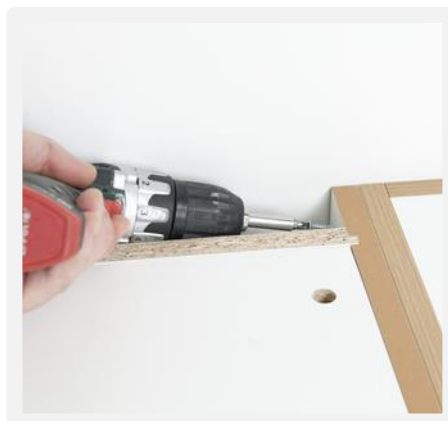
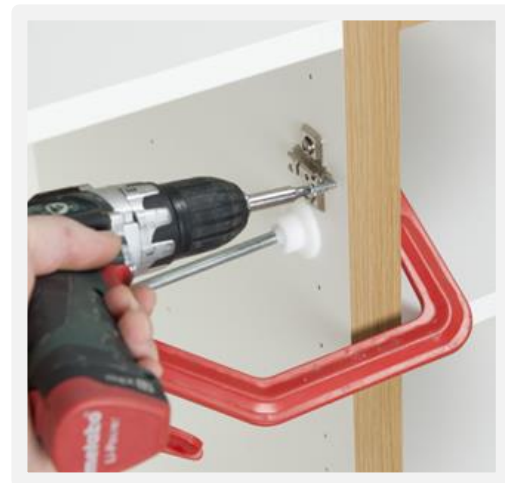

Belfast Sink Base

The Belfast Sink unit should be positioned as per the other base units, checking for level before securing to adjacent unit.

Place sink on the unit and mark position of waste, then cut hole in top panel for sink waste and pipework.

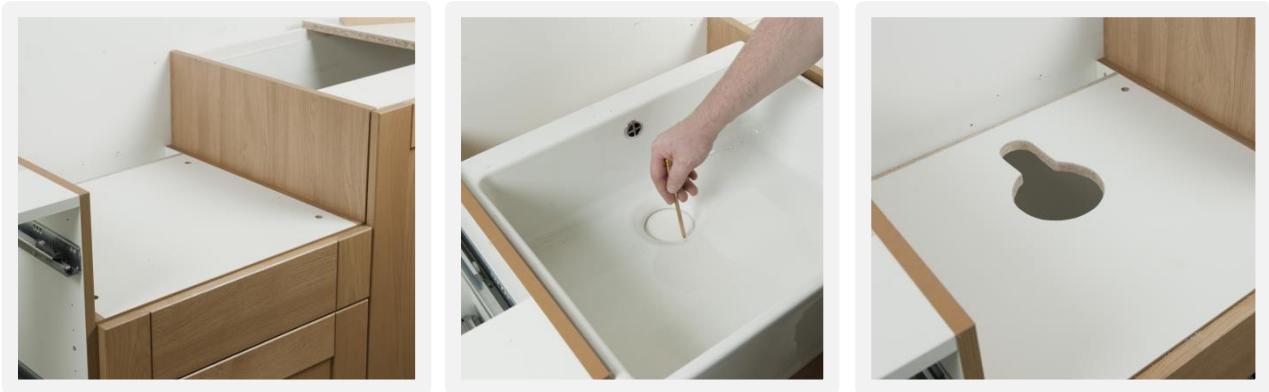

Due to the different heights of Belfast sinks in the market place, you may need to use packing to align the top of the sink to the sides of the adjacent cabinets.



The picture above shows 10mm MDF



Position the sink and attach the waste.

Half Height Base Unit

Remove the drawer, check level and brace to adjacent unit with gripping tool. It may need extra support at this stage, if this is to be the last unit on the run.

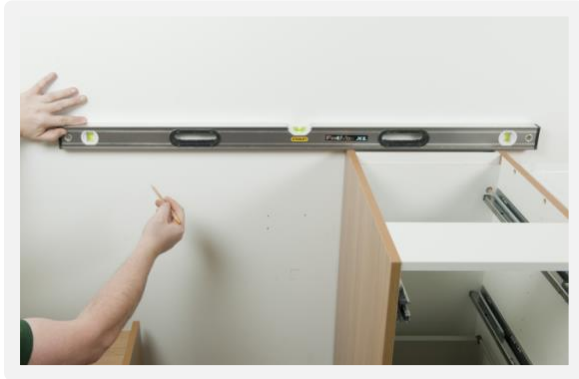

Drill holes in the back panel and mark the wall for extra fixing points. Remove the cabinet and drill/insert fixings into the wall. Replace your cabinet, re-check for level and screw together through the side of the cabinet using 'self-tapping screw' no longer than 30mm and in the recess at the rear of the adjacent unit. Secure through the back panel to the wall fixings.



Attaching Plinth

If you have ordered the Servo drawer system then your drawer base cabinets will have the system pre-installed. You will need to house a transformer and cradle below a base shelf in a chosen base cabinet and then connect the single or multiple servo cabinets to the mains in a ring system.

Drawer sensor lighting is available in drawer base cabinets wider than 600mm. Lighting is installed once all base cabinets are fixed. You must connect all strip lights to a transformer before linking to the mains.

Once all base cabinets have been levelled and fixed, the continuous plinth is fitted below the run of base cabinets.

Firstly, cut your plinth to length then mark the position of the adjustable legs on the rear face and screw fix the leg clips provided.

Base cabinet return plinths are also available if required in most ranges rather than using décor ends.

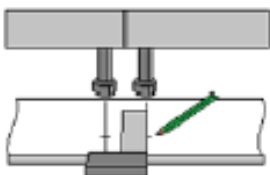

Lay the plinth down in front of the units (Front side Down) and mark off where the plinth clip plates will go.

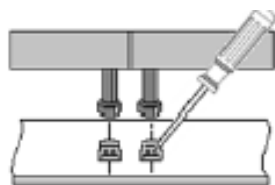

Screw the plinth clip plates into position

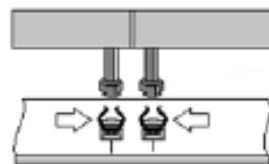

Slide the plinth clips into position onto the plinth plates.

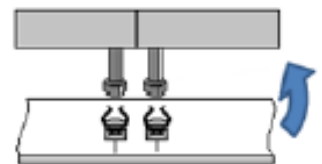

Stand the plinth up and push the clips against the legs till they click into place.

Larder units and appliance cabinets

Look upon the installation of your tower cabinets as an extension to your base cabinet run. You have received your tower cabinets pre-built and ready for installation. Remove all of the packaging. Remove all doors and drawers. Screw fix the black adjustable legs to the underside of the cabinet as done on your base cabinets. Be sure to get help to stand the cabinet upright and into position. Do not attempt to lift or move a cabinet on its legs around your kitchen.

It is critical that your tower cabinet is level vertically from the front and side when you fix it back to your wall. It is fixed as a base cabinet with the steel brackets provided. Make sure that the 150mm plinth line is carried through from the adjoining base or tower cabinets.



If the wall behind your tower cabinet is not flat or vertically level you will need to take advice from an expert as to how you can overcome this problem. Do not install your cabinet out of level as this will affect its performance and may create further problems with the kitchen all cabinets.

Please be aware that we supply a standard fascia with appliance cabinets. This fascia will need cutting down in order to fit the wide range of different appliances available in the market place.

Fitting the wall cabinets

If you have chosen full height wall cabinets, draw a line 1200mm above the 870mm line and this will show the top line of your wall cabinets. If you have chosen tall wall cabinets the top line must be 1380mm above the 870mm line.

These top lines correspond to the heights of the full height and tall tower cabinets respectively.

Remove all of the packaging. Remove all doors and shelves.

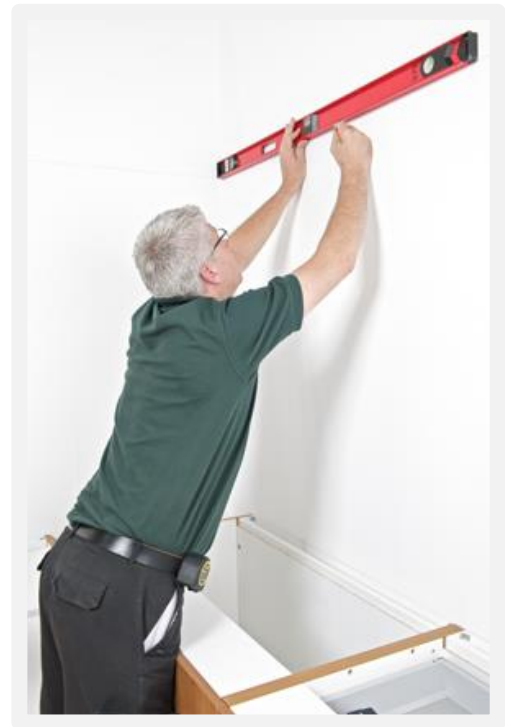

Your wall cabinets hang on two steel plates that are screw fixed behind each cabinet. The plates are supplied in one piece and need to be carefully snapped apart.

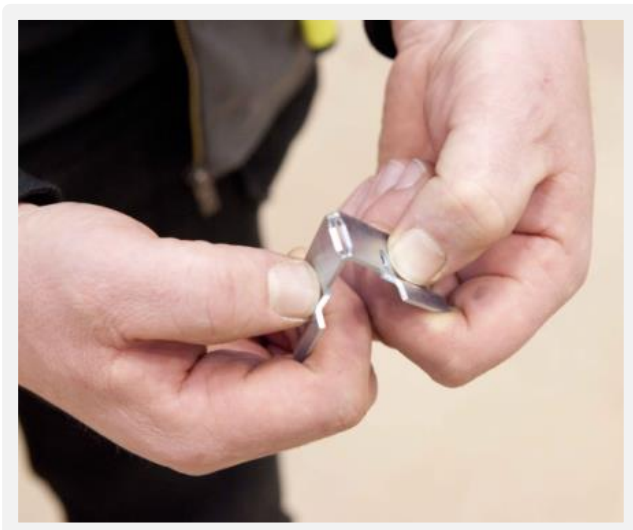

Wren wall cabinets have the latest concealed cabinet suspension brackets. These are not visible from inside the cabinet but can be adjusted through each top rear hole in the cabinet back.

1. To position the wall plates, measure down 115mm from your 2070mm or 2250mm line to give you the height for all the plates (This is to the centre of the holes in the wall plate). Now mark the combination of cabinet widths on each line and this will get you each plate position if you measure 20mm in from the end of each cabinet.

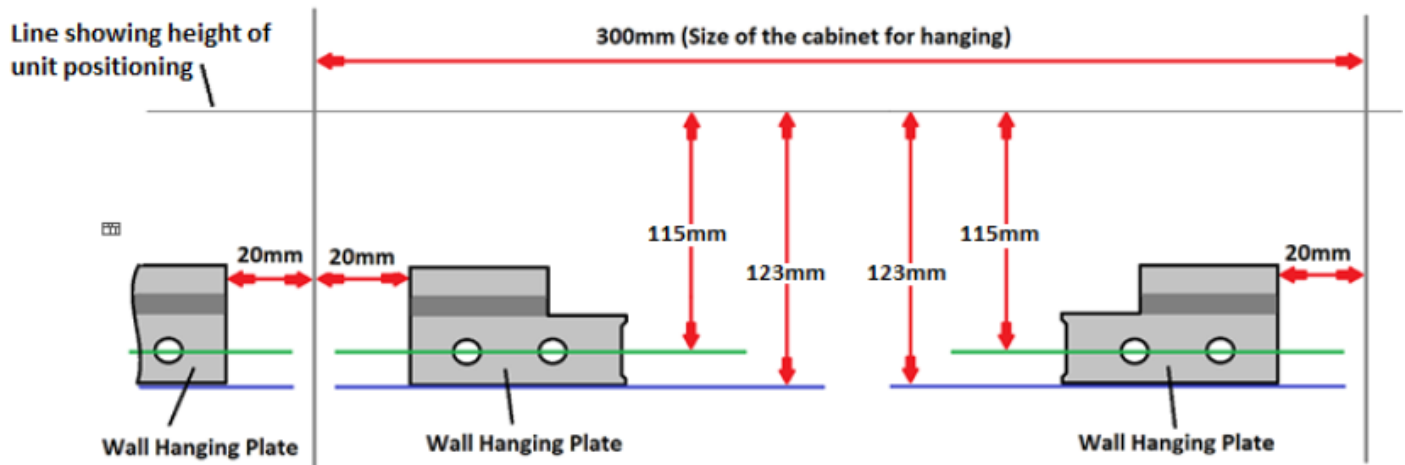

2. Hang the unit onto the wall plates. Ensure the brackets are securely located
3. Adjust the bracket accordingly for up/down (Fig.1) and In/Out (Fig.2)
4. Finally when you have set the unit to the correct position and aligned with adjacent units lock into place with the locking screw (Fig.3) this will prevent the unit below lifting from the wall.

Image from inside the unit.

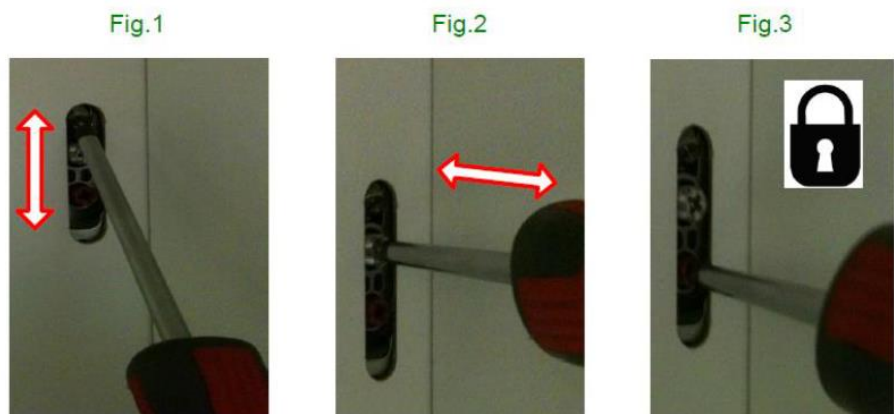

Rear of hanging bracket and wall plate location point.

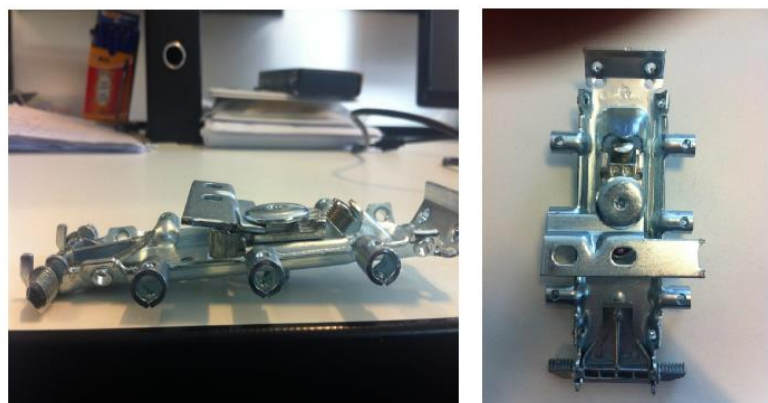

When do not provide screws to fix the steel wall plates as we do not know what your wall is made from. Our cabinets are designed to carry “heavy domestic” loading, please ensure your method of fixing is equal to this task.

If you have a wall corner cabinet in your kitchen then, as with the base cabinets, begin your installation in the corner. Measure 662mm from the corner and fix your 600mm corner cabinet up to this line. Now fix the wall corner post and you are ready to build away in both directions.

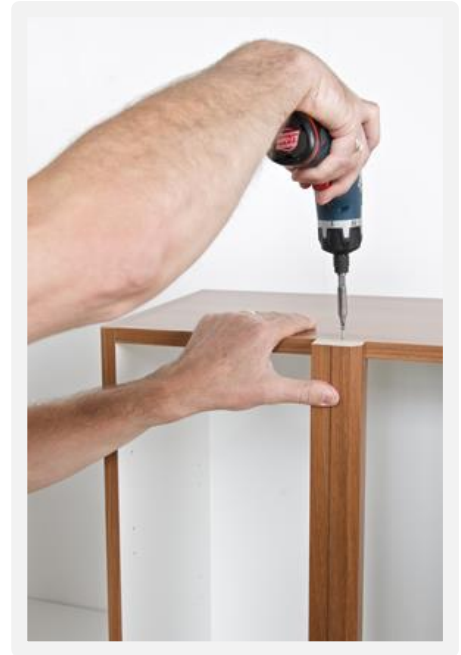

If you have any problems with the flatness or plumb of your walls, take advice on how to level and fix your cabinets securely. Do not take chances.

For added strength and security, each of your wall cabinets is supplied with two rear corner brackets that are screw fixed to the bottom corner behind each back panel. When you have hung and levelled a wall cabinet, mark the central hole in each corner bracket onto your wall through the back panel. Take off the whole cabinet and drill / insert two fixings into the wall. Replace your cabinet, re-check for level and then fix through the two bottom corners making sure that the cabinet is level.



We recommend that you screw fix each cabinet to the adjoining cabinet by screwing behind each hinge plate when cabinets are clamped together.

Replace the doors and shelves and continue with the next wall cabinet.

Where you have more than 1 wall cabinet stacked vertically e.g. two bridging cabinets, the same rules for installation apply. Mark out the wall plate and corner bracket positions and ensure sound fixing points are available.

Adjustable Corner Posts for Linda Barker Range Units Only.

Example below shows a Standard 600 corner wall with the 2 ways the Adjustable Corner Post can be used.

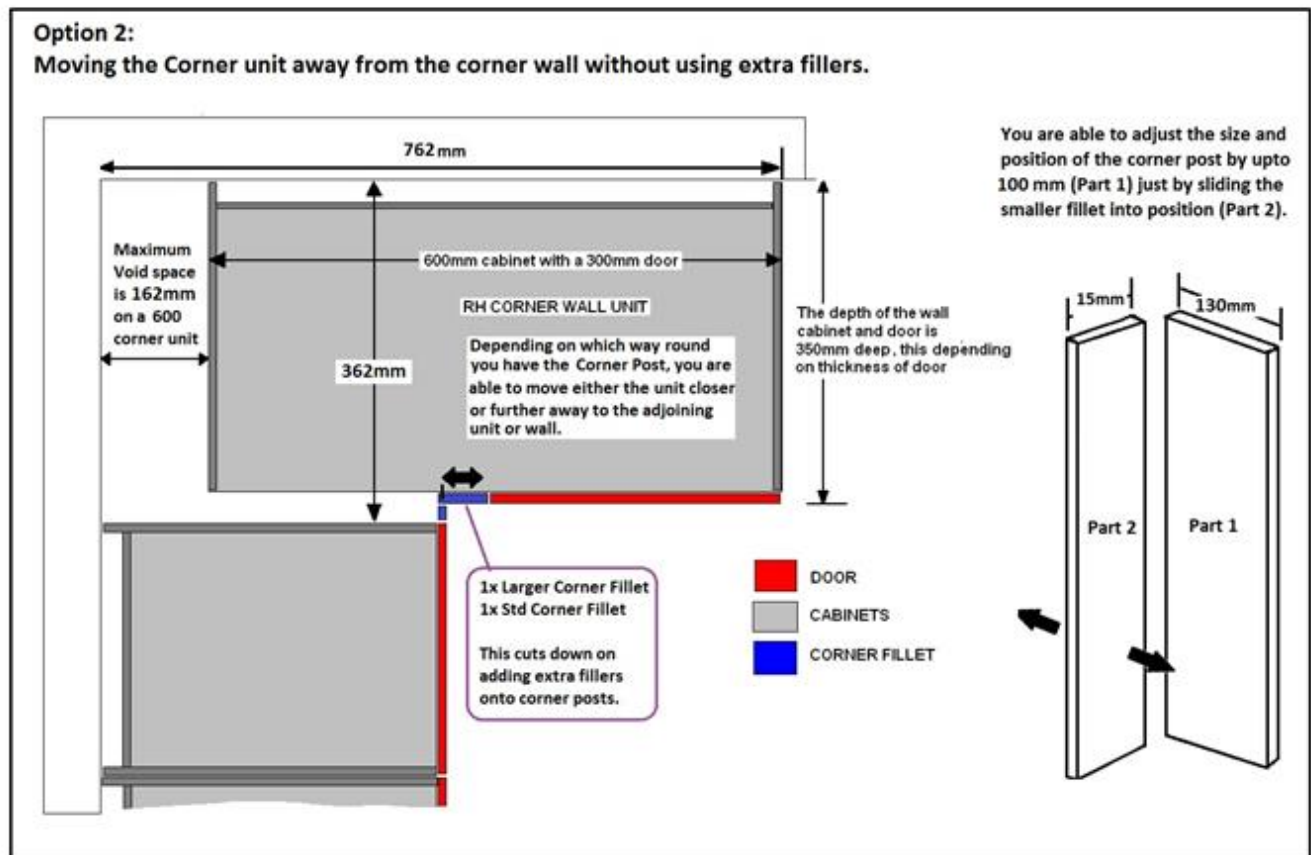
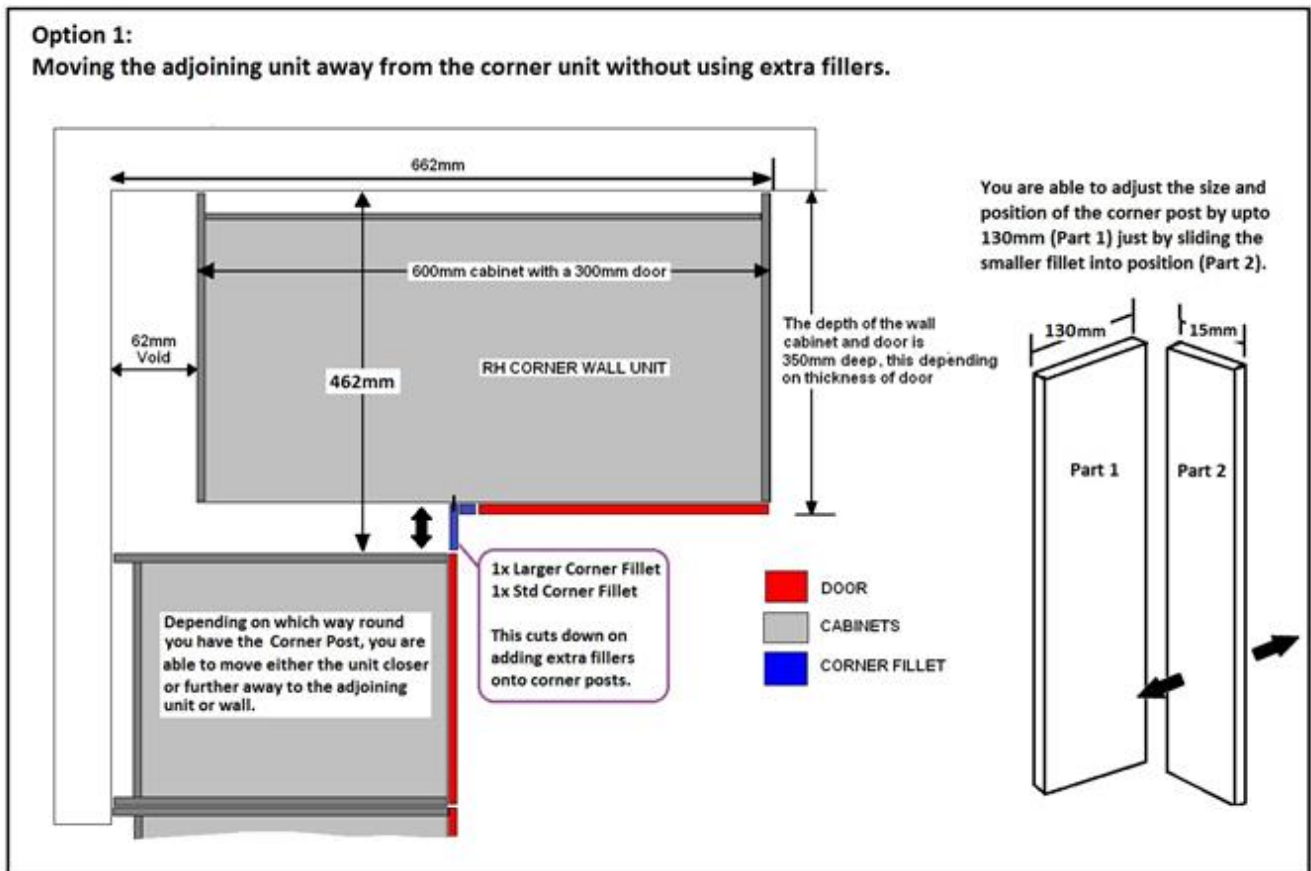

Cornice and Light Pelmet

If you have chosen to attach cornice and light pelmets to your kitchen wall cabinets, here are some pointers to carry out a successful installation.

Traditional style cornice and modern combined cornice and light pelmets should be positioned so that they cover the doors in their run of wall cabinets.

Where a length of cornice/pelmet butts up to a returning wall, simply cut to length and pre-drill the rear section of the moulding before screw fixing it into the wall cabinet.

If you need to mitre an internal or external corner into your moulding, we strongly suggest that you do this with a powered precision saw. Do not attempt to cut a mitre joint by hand.

When you have cut the mitred lengths lay them out on the kitchen floor and glue the faces of each joint before taping together. Leave the tape on until the glued joint is set, then pilot drill and screw fix the finished assembly to your wall cabinet.

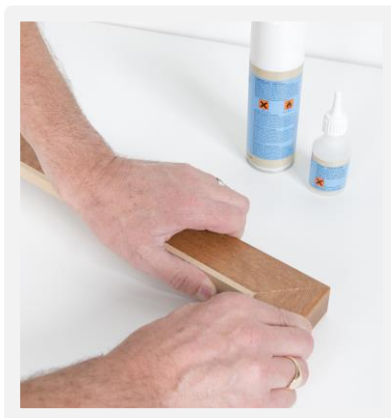

Curved Cornice & Light Pelmet

If your kitchen has curved wall units, there is a pre-shaped modern style and traditional style cornice and light pelmet available to match the curve of the door.

Place the curved cornice and pelmet on the wall unit and mark the position for cutting. Cut the moulding to size and blue to any adjoining pieces.

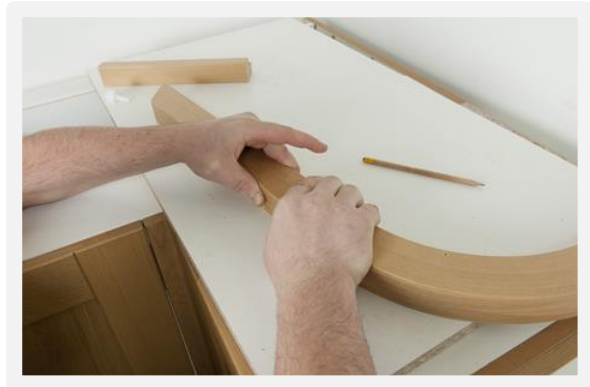
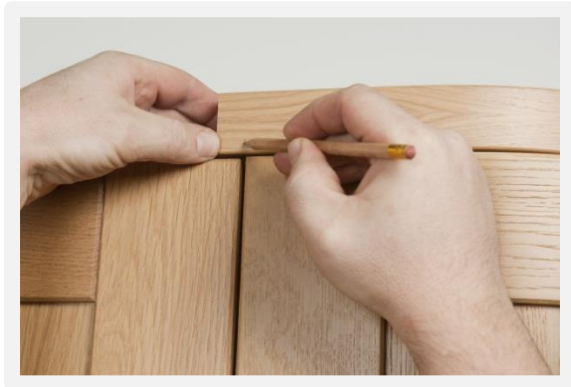

When the joints are set, pilot drill and screw fix to your wall cabinet.

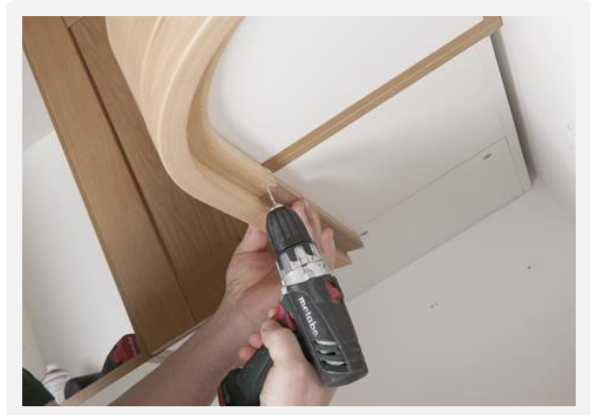

Cornice (goes on top of the wall units) Pelmet (goes underneath the wall unit)

Please Note:

The modern cornice and pelmet are just the same shape so they can be used on top or underneath the wall unit, whereas the traditional cornice and light pelmet are a different shape altogether.

Curved Posts

Cut the post to the length required and attach to the relevant clad panel.

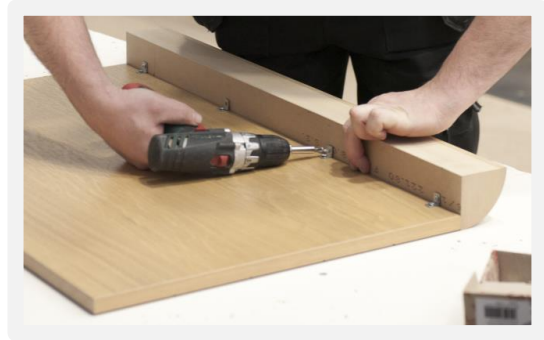

Mark the post to match the thickness of the door to be fitted, and trim the panel so the post will fit flush to the front edge of the door.



Attach the post to the cabinet using self-tapping screws and to the wall with 'L Shaped' brackets or fixing blocks (not supplied).

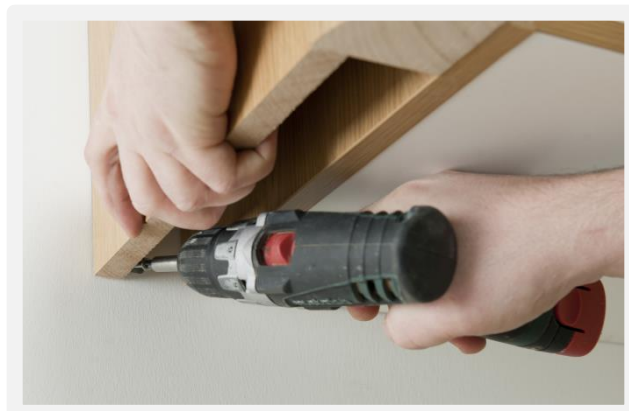
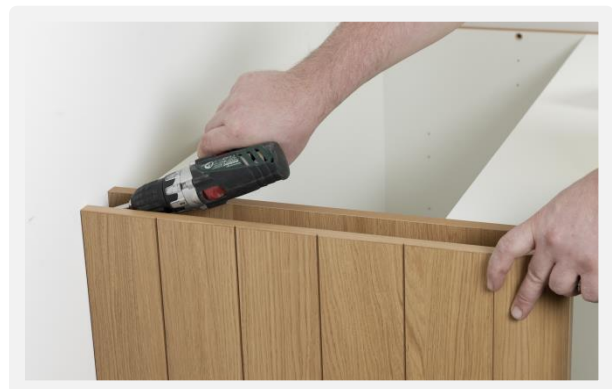
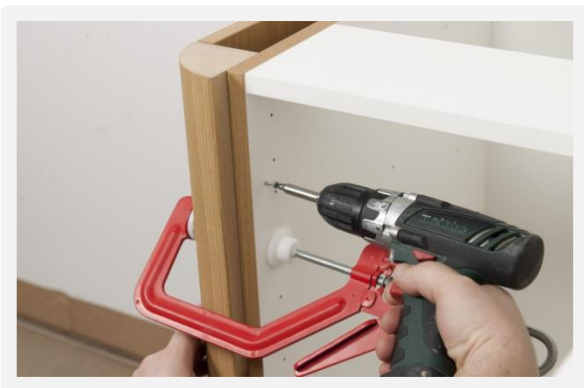

Fitting handles

The handles you have chosen will complete your Wren kitchen.

It is important that they are positioned accurately and well fixed. Firstly, decide where you are going to position each handle to maintain symmetry around your kitchen.

Then make a plywood template to mark the fixing positions on to the front of each door and drawer front.

Drill through the door or drawer using a fine drill i.e. less than 2.5mm you can then drill back from the rear face of your door or drawer using a 4.5mm drill.

By drilling twice you eliminate the chance of breaking out the door surface and help the accuracy of the holes positioned ready for handle fixing.

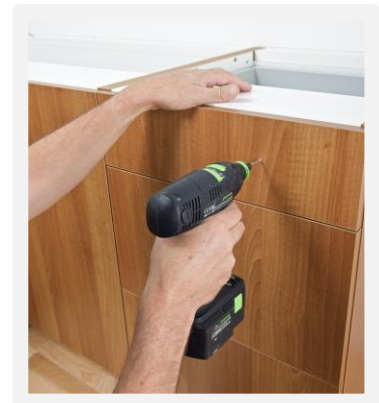
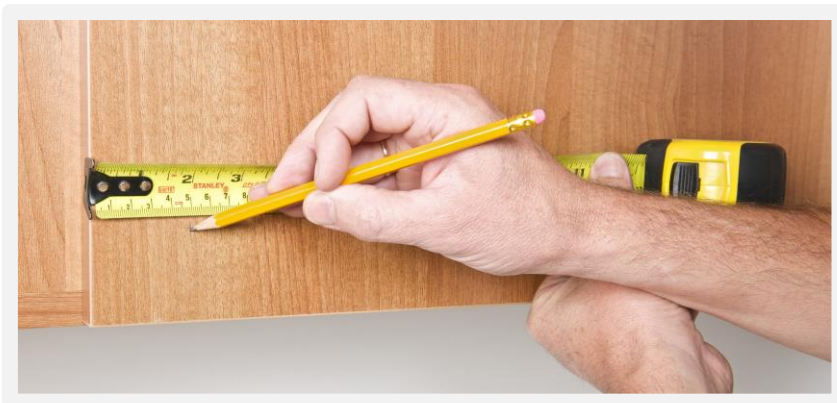

Lighting

Lighting should be installed as a final task once all other installation has been completed.

Wren offer you the possibility to install lighting into your wall cabinets (usually combined with glass doors and shelves), base cabinets (usually associated with drawer storage) or under and over your base and wall cabinets to give general illumination to your kitchen.



For inside wall cabinets, it is best to surface fix our low voltage spotlights.

Best drawer cabinets can be fitted with our drawer sensor lighting to give light to each drawer box when opened.

General illumination is achieved by using our plinth lights below your base cabinets and fluorescent strip lighting or pyramid lights below your wall cabinets.

The LED strip lights can be used anywhere that you feel like making a designer statement in your Wren Kitchen.

For all Wren lighting simply follow the manufacturer's installation guides.

If in doubt, consult a trained electrician.