

TOWER UNIT

600 Double Appliances

Inc Dr+Drw

Assembly Guide

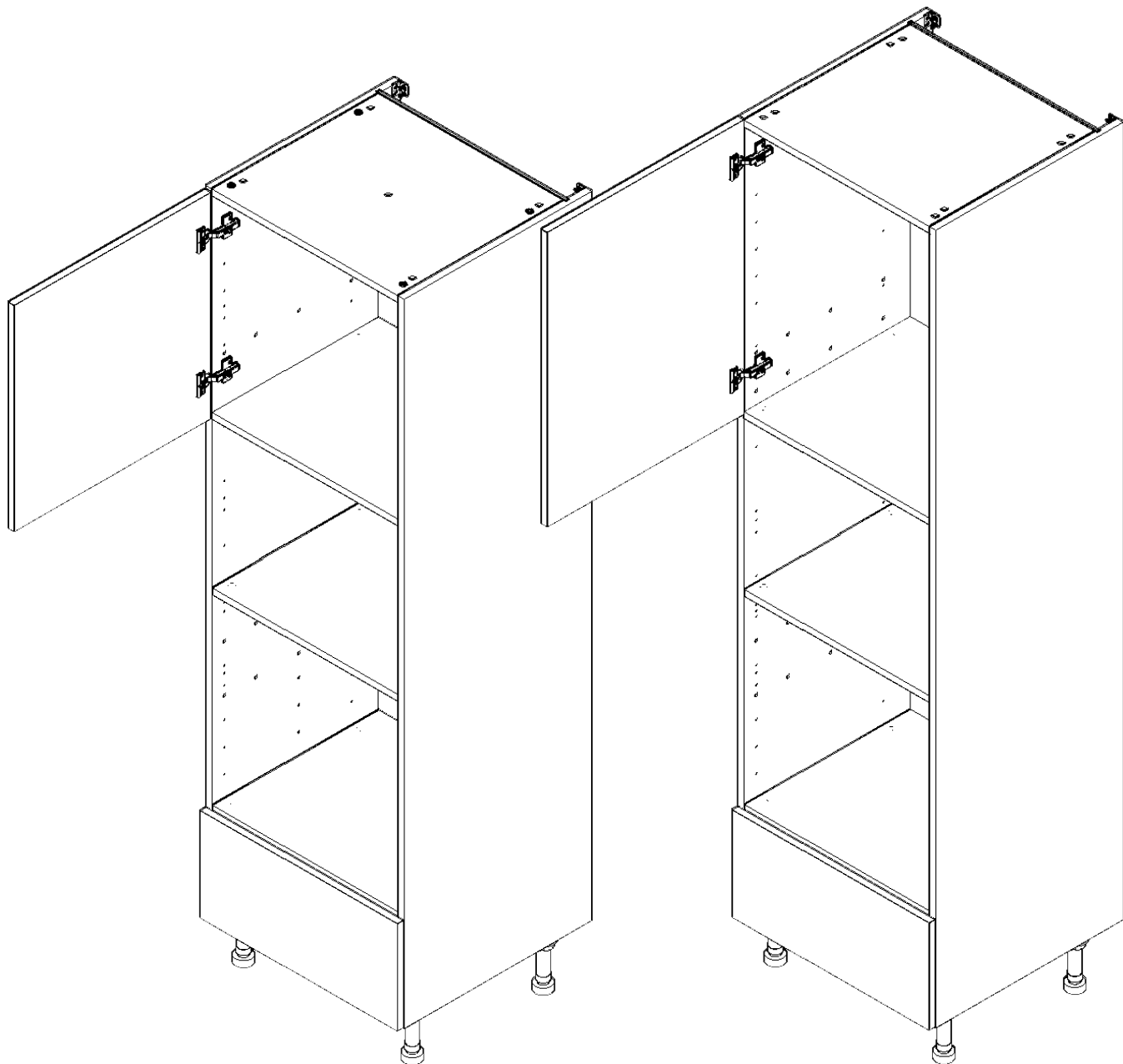

2070 x 600
600 + 450 Appliance

2250 x 600 Tall
600 + 450 Appliance

wren
KITCHENS

TOWER UNIT

600 Double Appliances

Inc Dr+Drw

Drawer Assembly

BEFORE YOU START

INSTALLATION
SHOULD BE
PERFORMED BY A
COMPETENT
PERSON ONLY.

THIS PRODUCT COULD
BE DANGEROUS
IF INCORRECTLY
INSTALLED

Deep Drawer (Packed Separately)

Fitting Pack Contents

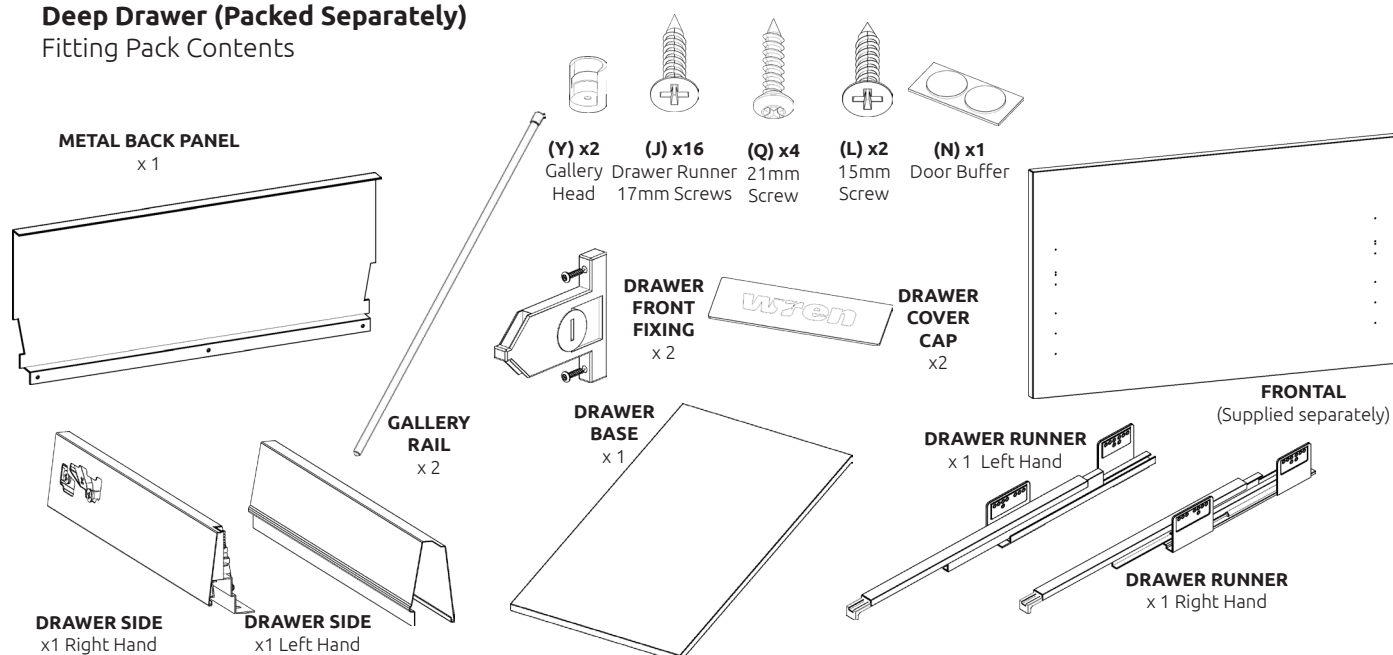

REQUIRED TOOLS

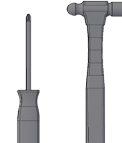

TOWERUNIT

600 Double Appliances
Inc Dr+Drw

Assembly Guide

Step 1.

Secure drawer base to drawer side using 4 x 17mm drawer runner screws (**J**) in holes provided.
Seat the edge of drawer base tight into corner of casing, as shown.

The decorative face of drawer base to be positioned as shown.

Repeat step 1 so both drawer sides are attached to drawer base.

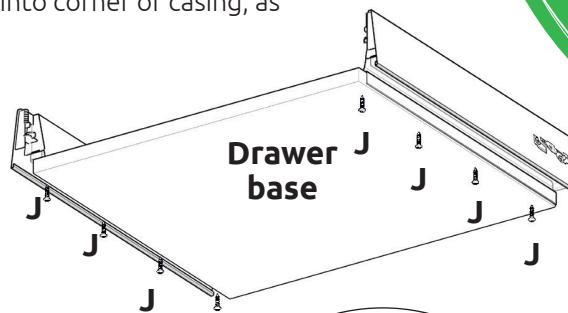

Step 2.

Clip on metal back panel to drawer base & drawer sides.

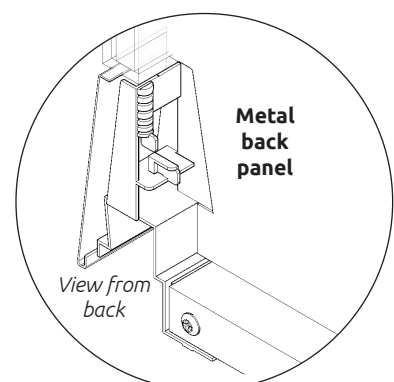
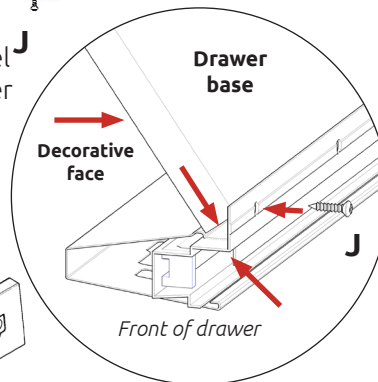
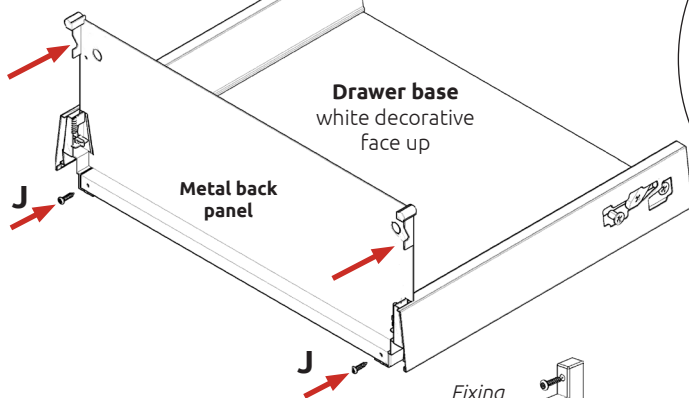

Step 3.

Screw back panel in position using 2 x 17mm screws (**J**) to drawer base in holes provided.

Step 4.

Frontal Attachment

Secure **Drawer Side Fixing Clips** using 4 x 21mm screws (**Q**) and **Gallery Head (Y)** using 2 x 21mm screws (**Q**) in pilot holes provided as shown.

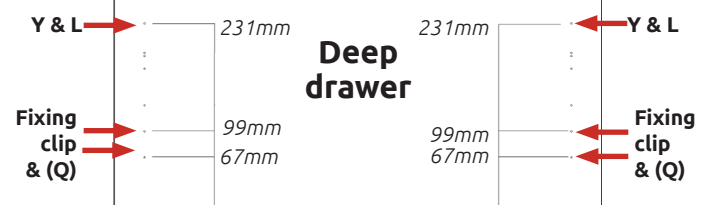
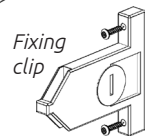

Drawer Frontal Adjustment

Step 5.

Draw Adjustment
Screw point **1** as shown to adjust drawer frontal right & left.

Screw point **2a** as shown to adjust drawer frontal up & down.

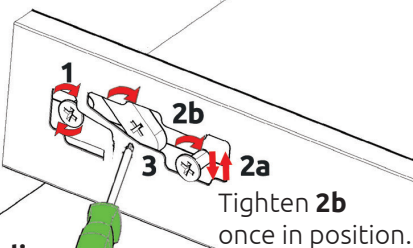

Releasing **fixing clip**.

Screw point **3** whilst applying downward pressure as shown to release.

View on side of drawer side

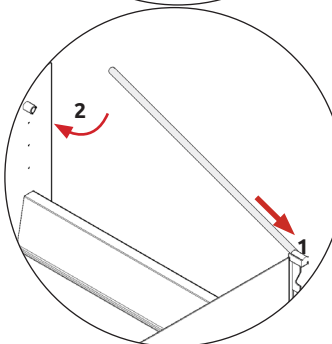
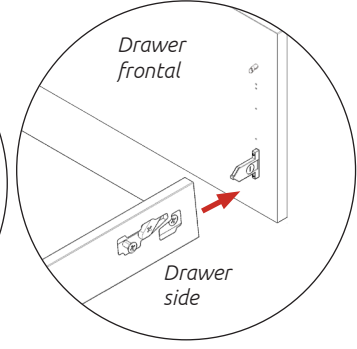
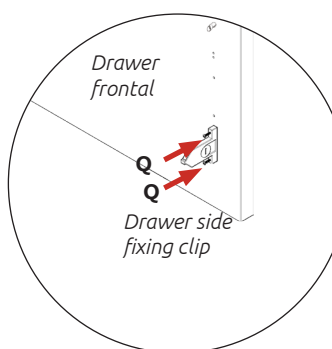

Drawer Cover Cap

Step 6.

Fit Gallery Rail into the top corners of Metal Back-panel.
Locate front end of the Gallery Rail into the opening of the gallery Head, which is secured to the frontal as shown

Step 7.

Fit Drawer Cover Caps over drawer side adjustment.

TOWER UNIT

600 Double Appliances
Inc Dr+Drw
Assembly Guide

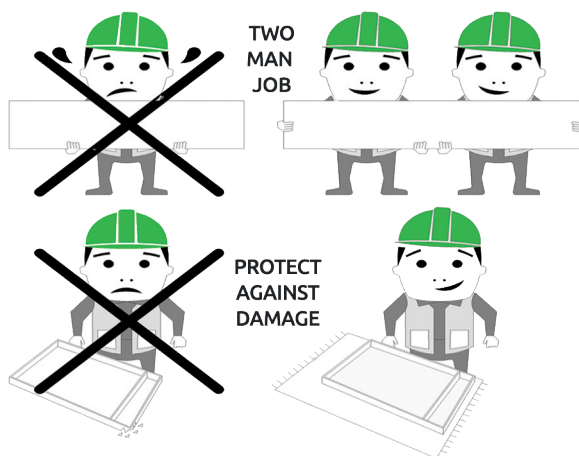

BEFORE YOU START

INSTALLATION
SHOULD BE
PERFORMED BY A
COMPETENT
PERSON ONLY.

THIS PRODUCT COULD
BE DANGEROUS
IF INCORRECTLY
INSTALLED

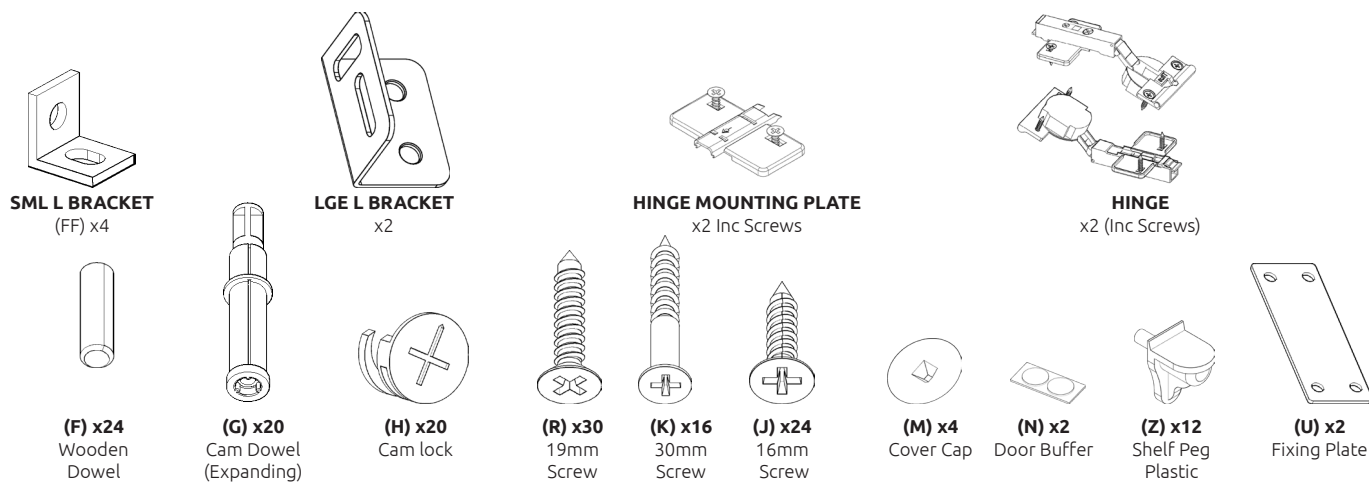
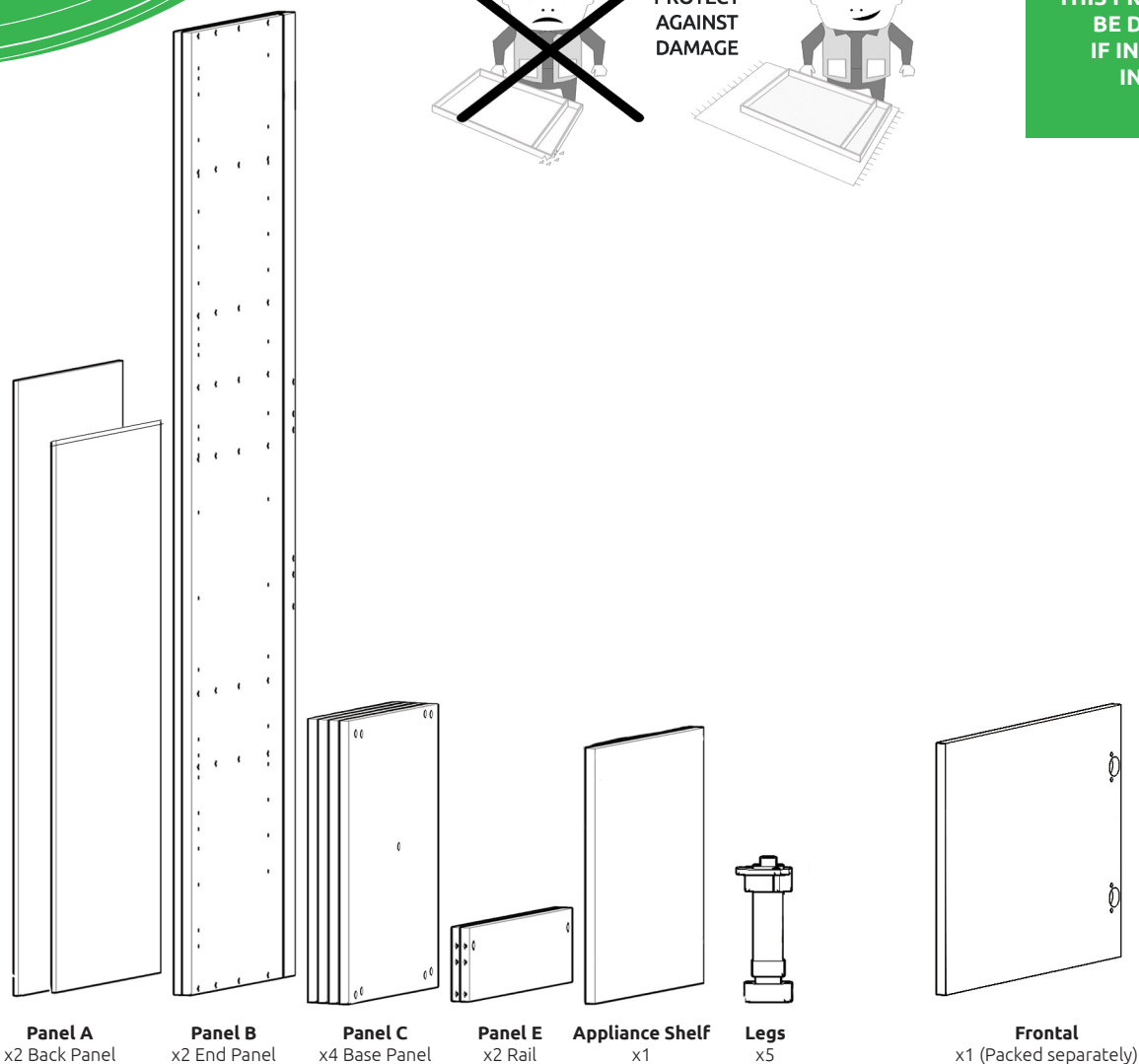

REQUIRED TOOLS



TOWER UNIT

600 Double Appliances
Inc Dr+Drw

Assembly Guide 2070

Step 1.

To attach drawer runner screw into end panels (**B**) using 2 x 16mm screws (**J**) per drawer rail, into pilot holes provided, 3rd hole from front, as shown.

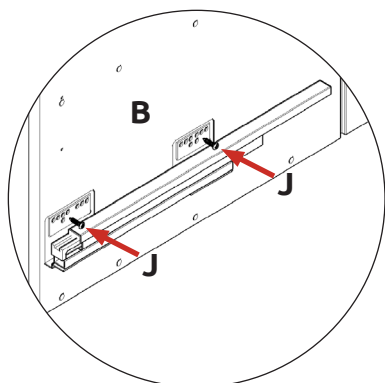

Drawer runner bracket screw position



Step 2.

Attach hinge plates onto end panels (**B**) in locations shown using 4x 15mm screws (**L**).

Hinge side to be mounted in accordance to customer kitchen plan.

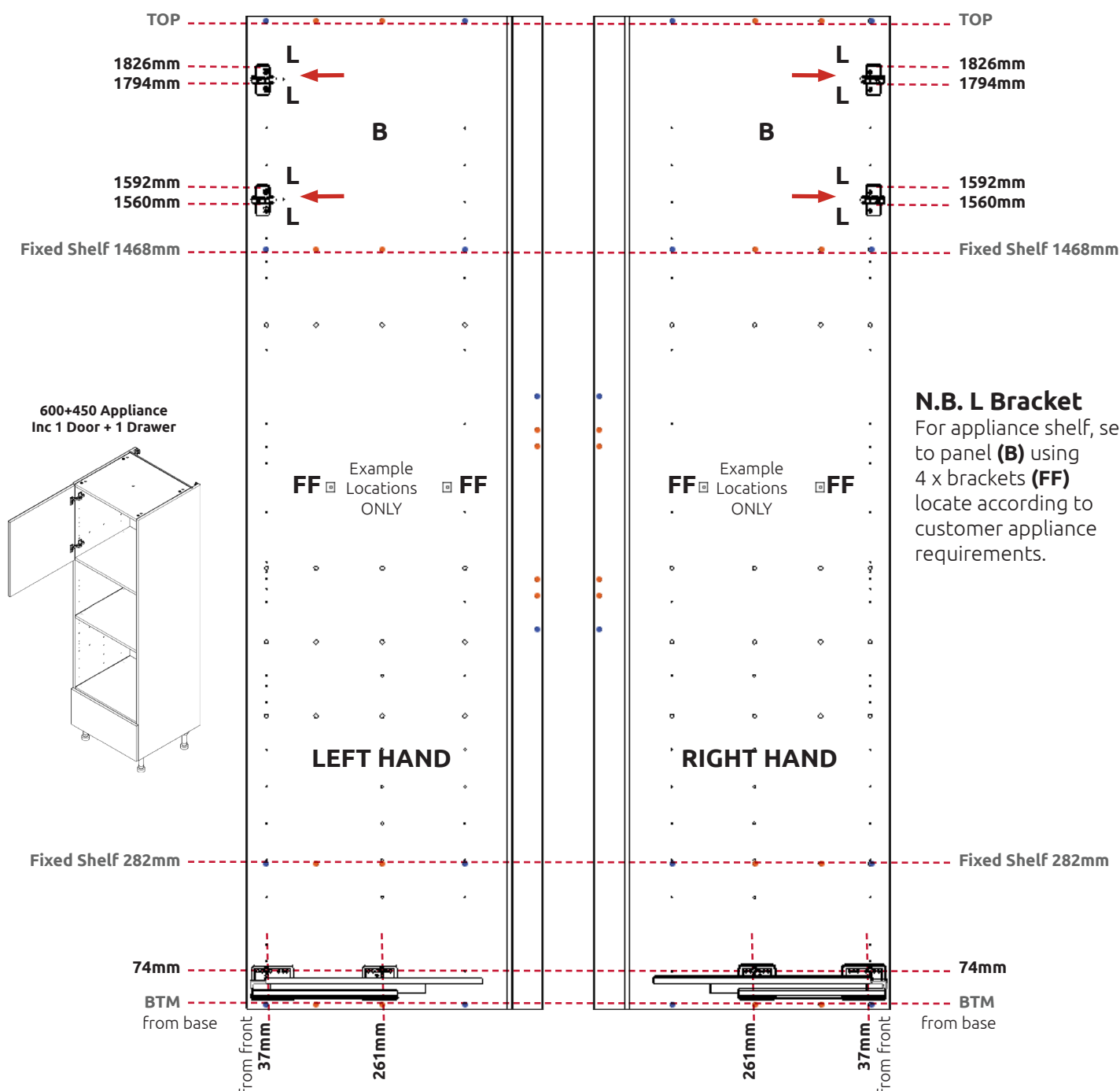

TOWER UNIT

600 Double Appliances

Inc Dr+Drw

Assembly Guide

2250 Tall

Step 1.

To attach drawer runner screw into end panels (B) using 2 x 16mm screws (J) per drawer rail, into pilot holes provided, 3rd hole from front, as shown.

Drawer runner bracket screw position

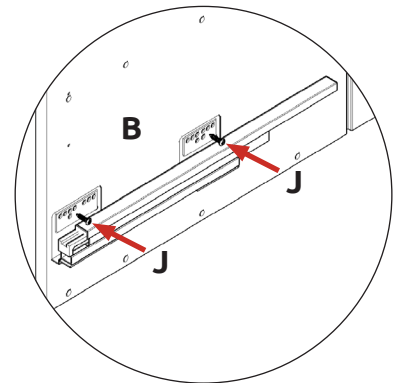

Step 2.

Attach hinge plates onto end panels (B) in locations shown using 4x 15mm screws (L).

Hinge side to be mounted in accordance to customer kitchen plan.

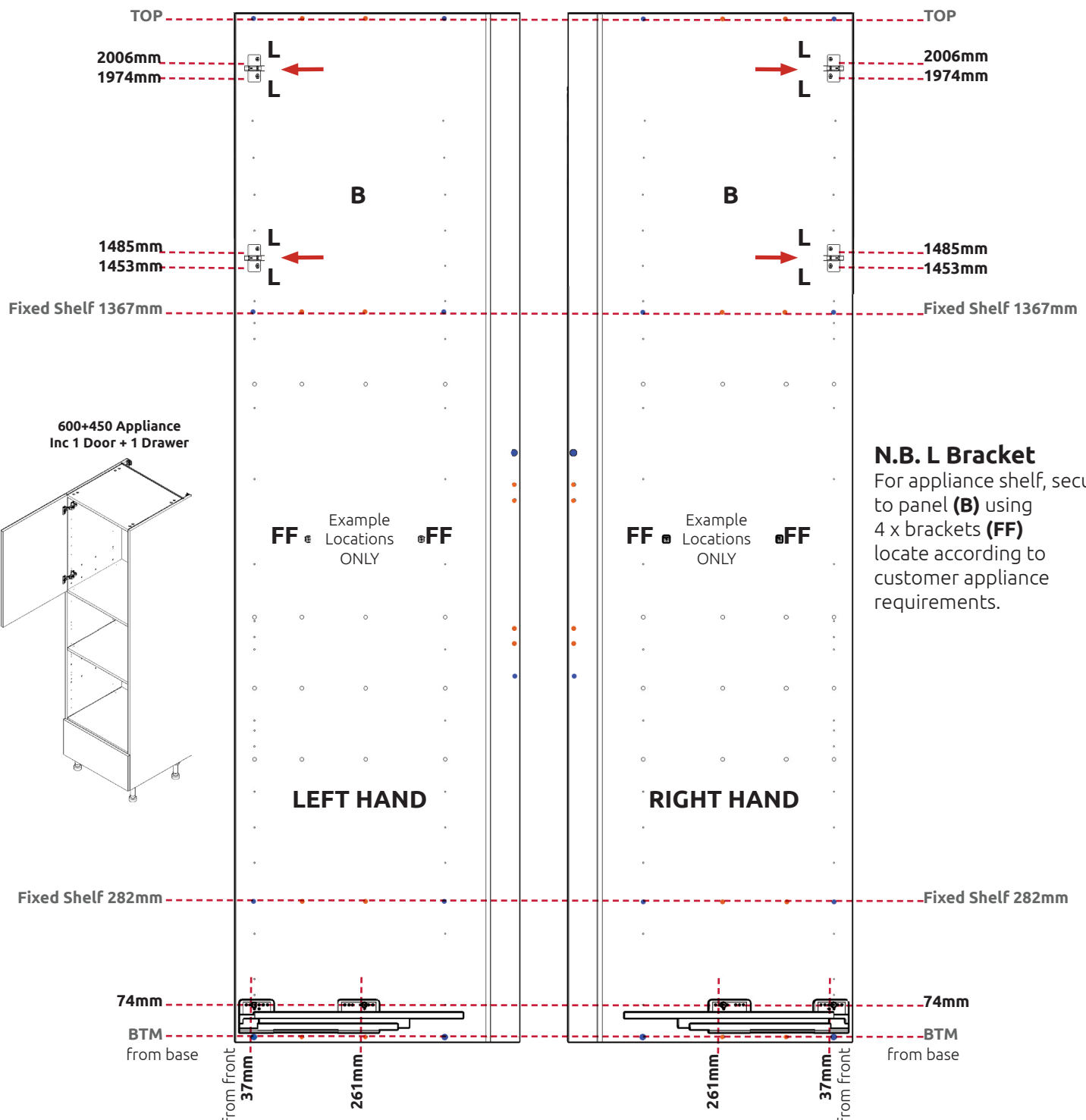

TOWERUNIT

600 Double Appliances
Inc Dr+Drw

Assembly Guide

Step 3.

Seat dowel **(F)** into holes in both end panels **(B)** as shown.

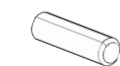

Step 4.

Seat cam dowel **(G)** into holes in both end panels **(B)** as shown.

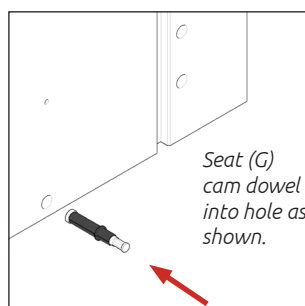
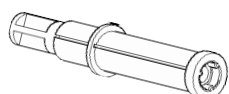

Step 5.

Attach Panels **(C)** & **(E)** to panels **(B)**, using cam dowel **(G)** & cam lock **(H)** (in blue), and also using dowels **(F)** (in orange) in positions as shown.

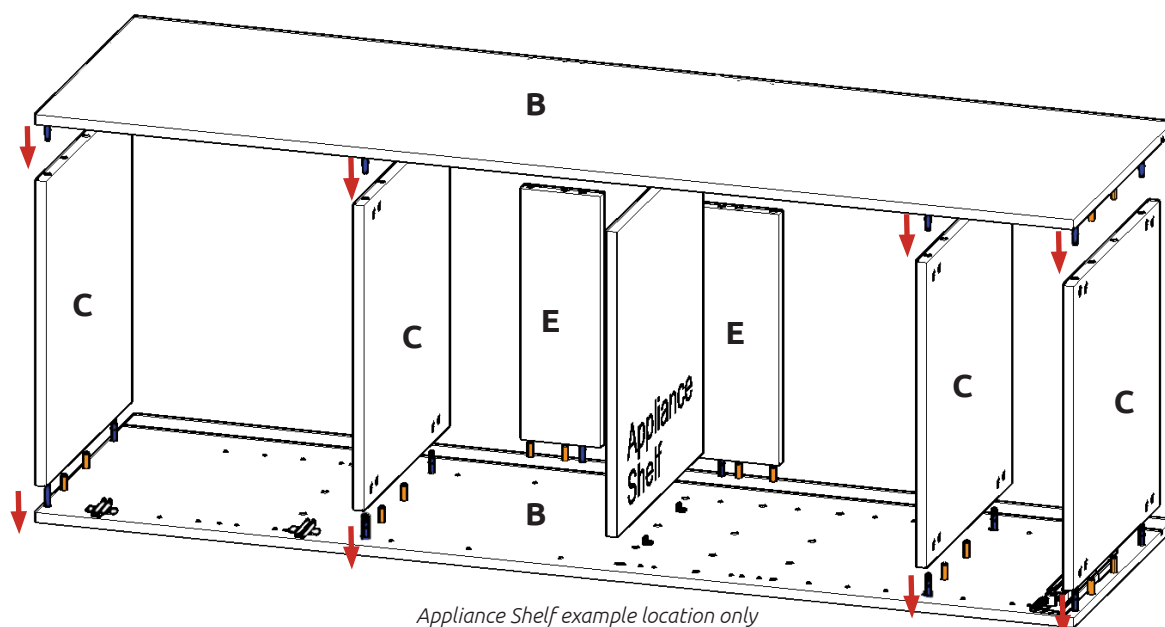

NB. All **Cam Locks (H)** are to be positioned facing the outside of the unit carcass, for ease of tightening.

Do **not** use power tools with cam dowel **(G)** or cam lock **(H)**

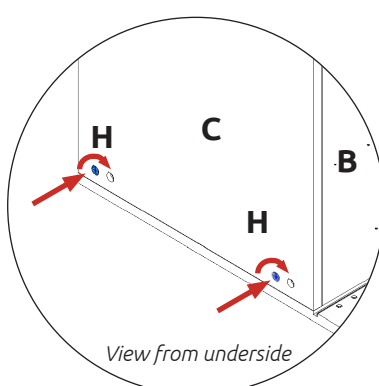
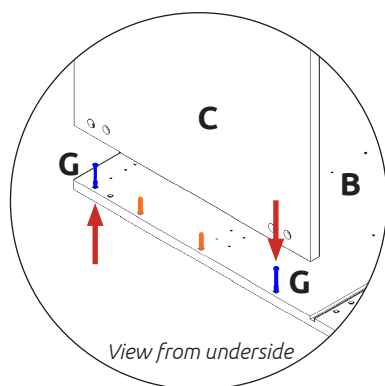

Step 6.

Cam Lock **(H)**

Join panels **(C)** & **(E)** to **(B)**.

Insert cam lock **(H)**.

Do NOT tighten until Step 9.



TOWER UNIT

600 Double Appliances

Inc Dr+Drw

Assembly Guide

Step 7.

Cut back panel (A) to suit appliance option, leaving the centre appliance aperture open.

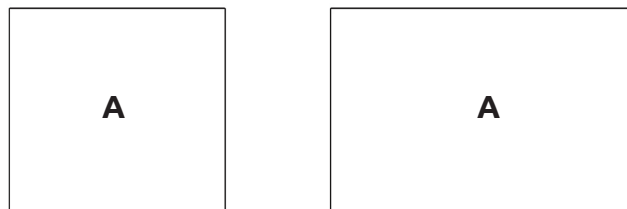

Step 8.

Slide back panel (A) into groove of end panels (B).

Once back panel (A) is in position, ensure the panel is flush & square with bottom of end Panels (B).

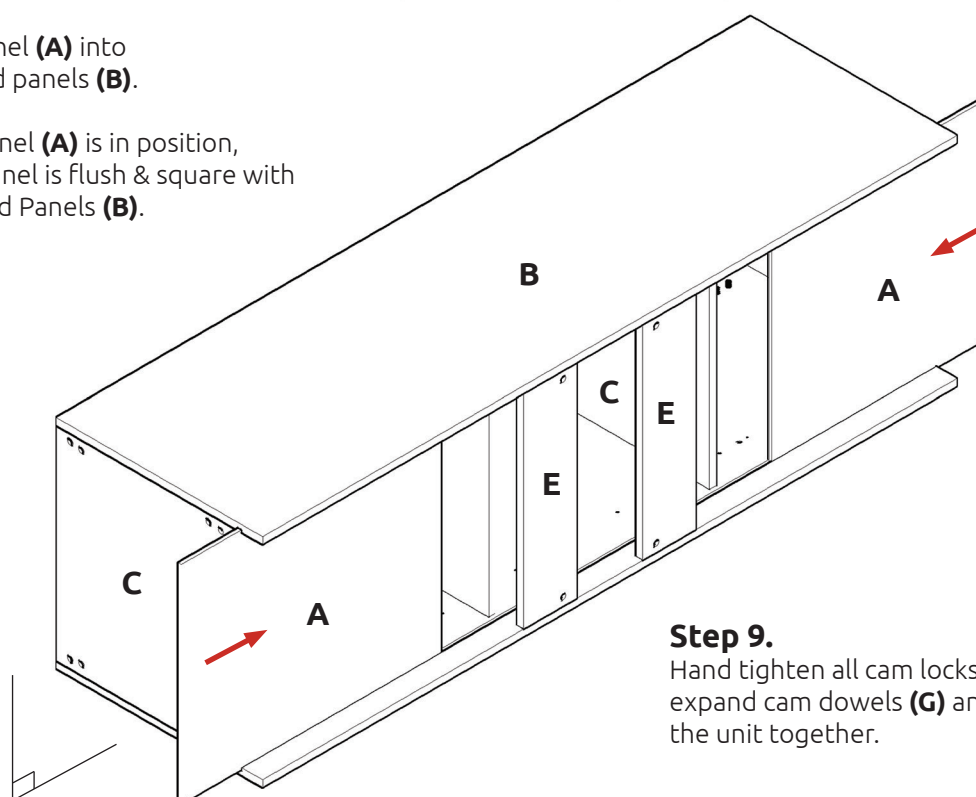

Step 9.

Hand tighten all cam locks (H), this will expand cam dowels (G) and tighten the unit together.

Step 10.

Ensure carcass is square. Secure back panel (A) with 12 x 30mm screws (K) equally spaced at the top & bottom of back panels (A) into base panels (C), as shown.

Ensure you screw into the centre of base panel (C) (9mm from the top or bottom edge where applicable).

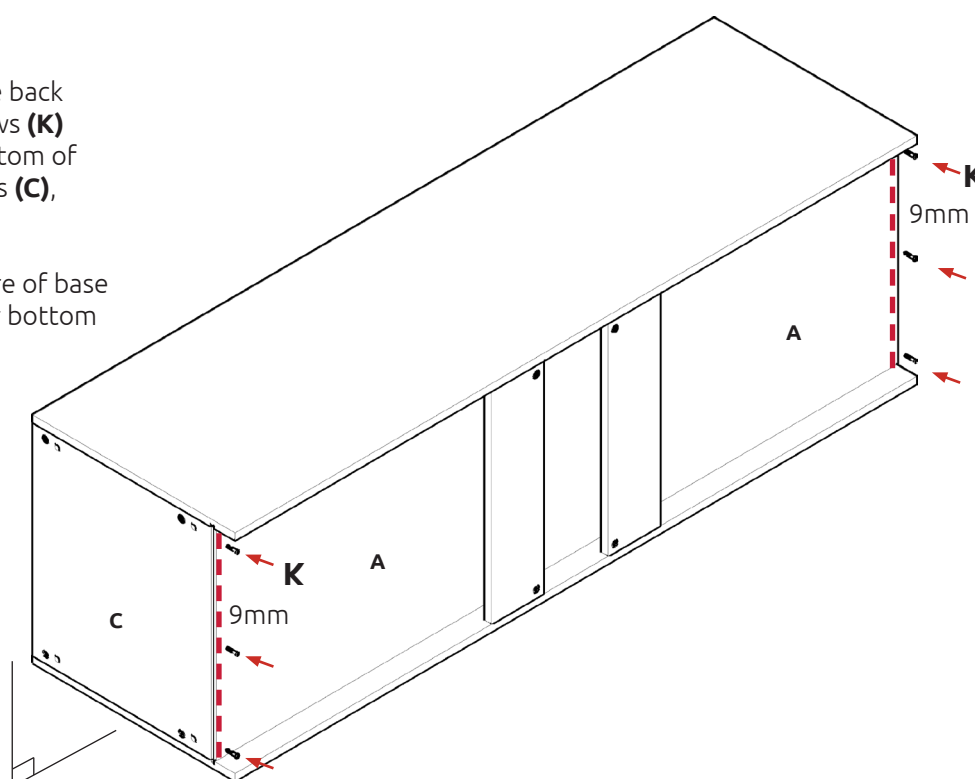

TOWERUNIT

600 Double Appliances
Inc Dr+Drw

Assembly Guide

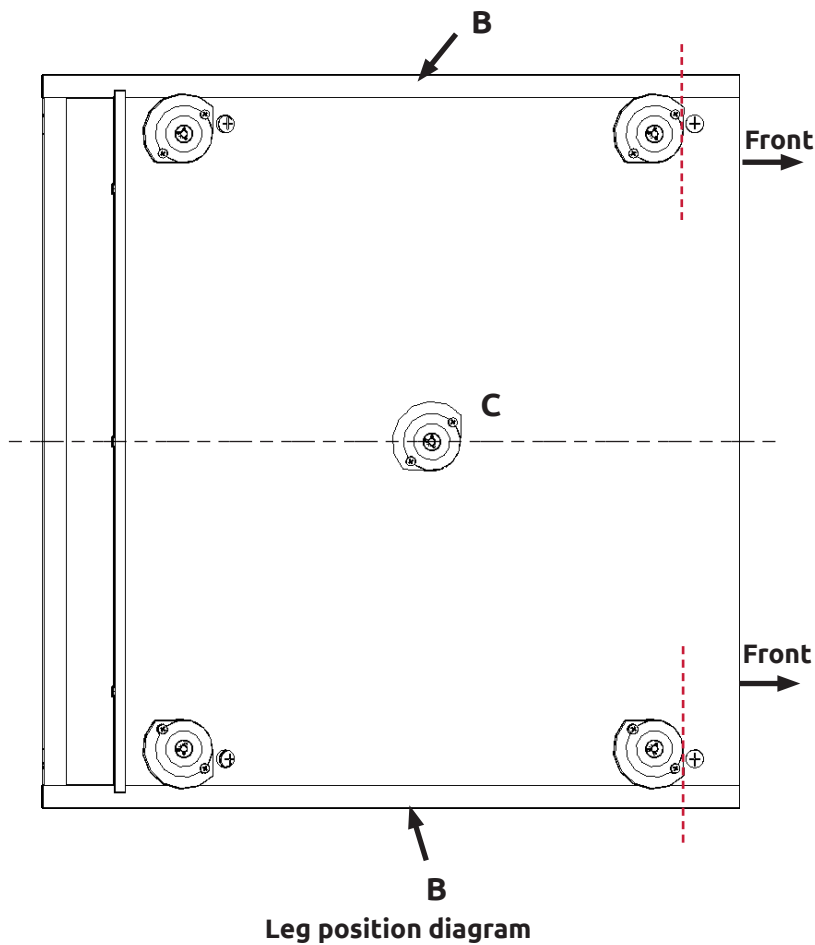

Step 11.

Secure each of the legs into place with 2 x 15mm screws (**L**) per leg

Ensure legs are rotated as shown so that part of it is supporting the end panels (**B**).

Front legs should have flat edge to the front.

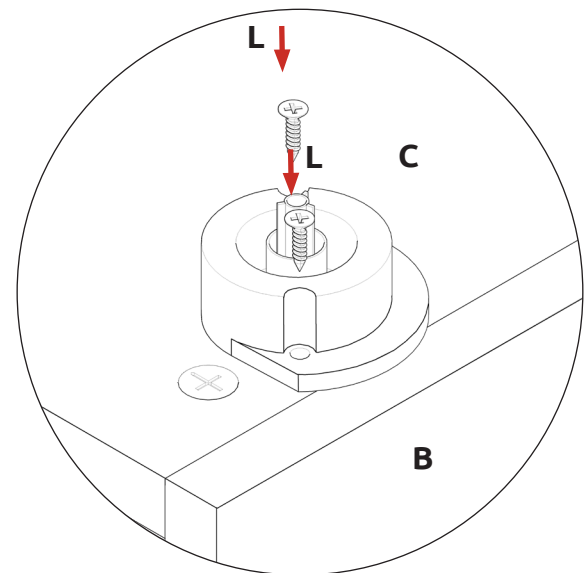

Step 12.

Lightly hit centre peg of leg base with hammer until flush with the leg base.

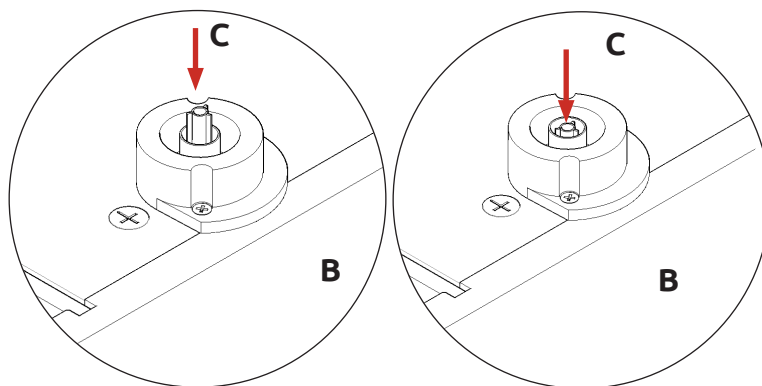

Step 13.

Push leg firmly down into leg base.
Adjust legs to 155mm before turning carcass upright.
Once in situ level accordingly.

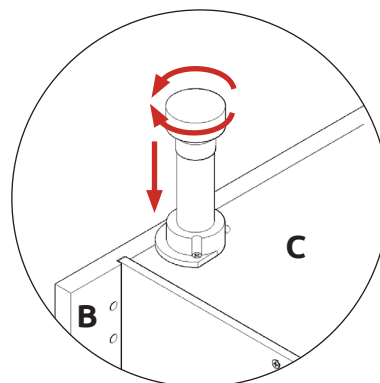

It is **important** to lift the unit onto its legs. Do not tilt as depicted in the image.

TOWER UNIT

600 Double Appliances

Inc Dr+Drw

Assembly Guide

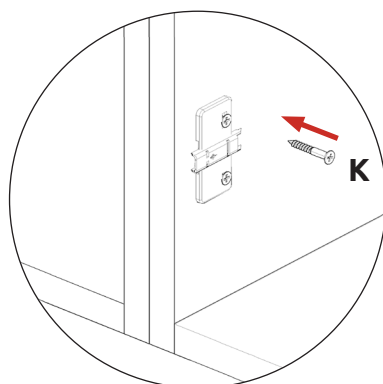

Securing to Adjacent Units

Screw into any side units using the 30mm screws (**K**) provided to secure to unit. Screw just to the rear of the Hinge Mounting Plate, at the top and bottom of both sides of the unit, place a cover cap on the head to conceal it.

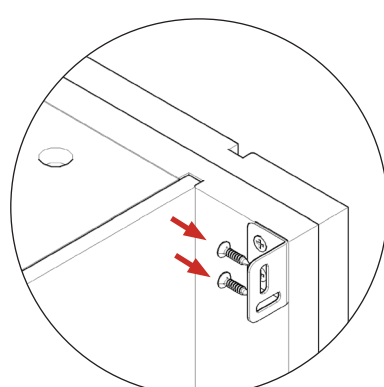
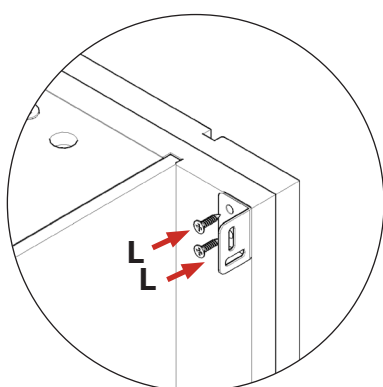

Secure tower to the wall using L brackets. Use 2 x 15mm screws (**L**) to secure each of the L brackets to the cabinets at either side. Then screw through into the wall as shown.

Screws for fixing to walls are not provided as these vary depending on your wall material and construction. Ensure appropriate fixings for wall constructions are used.

Secure tower to the wall using screws through rail panel (**E**) into the wall as shown.

Screws for fixing to walls are not provided as these vary depending on your wall material and construction. Ensure appropriate fixings for wall constructions are used.

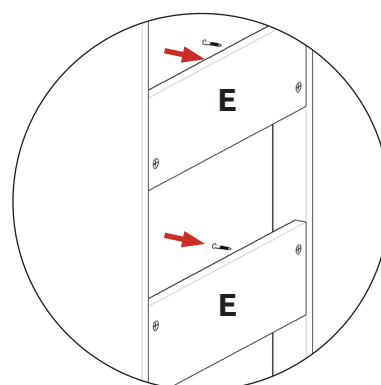

**FOR TOWER FRONTALS
SEE CUSTOMER SPECIFIC KITCHEN PLAN**

Step 14.

Insert hinge in top & bottom holes as shown.

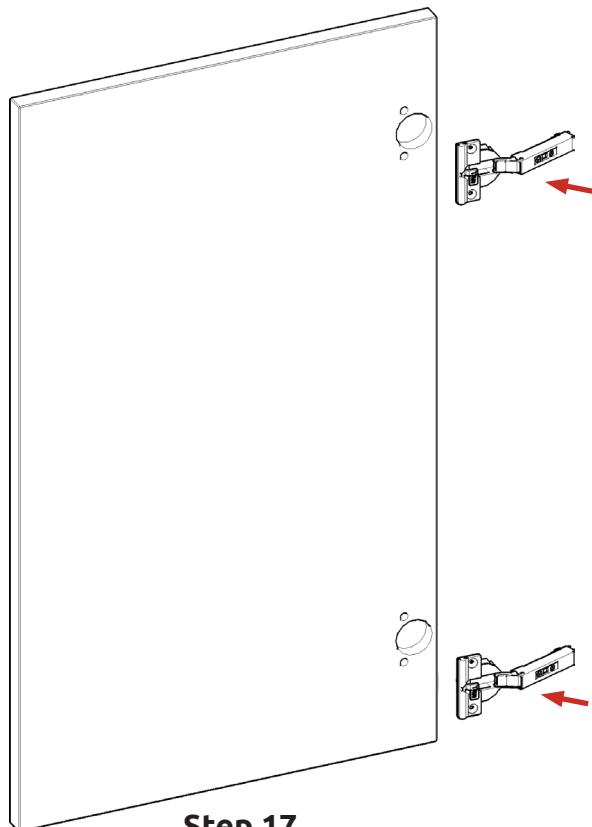

Step 17.

Adjust **hinge** to suit. As shown below.

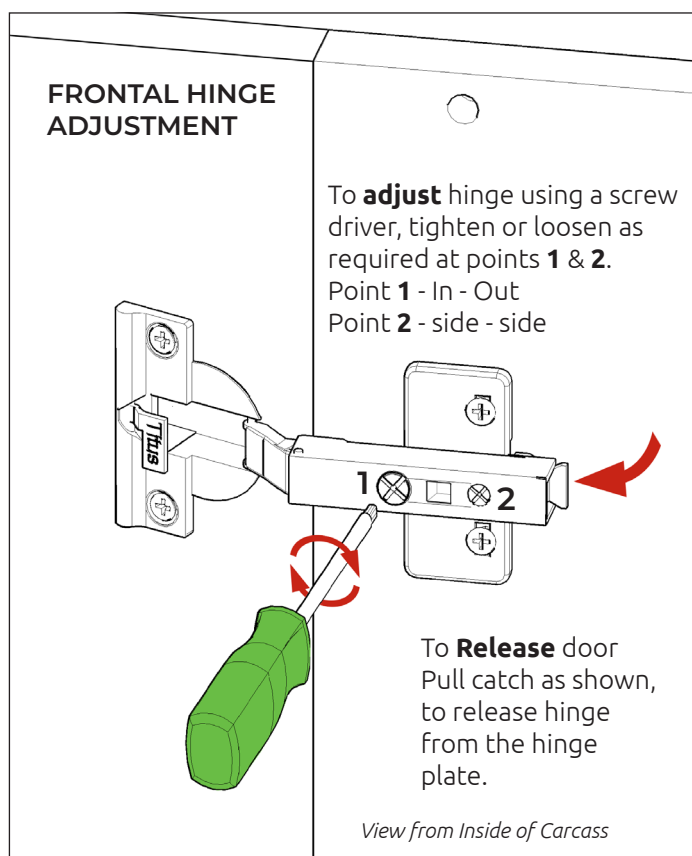

Step 15.

Secure hinges by tightening 2 x screws with hinge dowels attached. These are already positioned within the hinges.

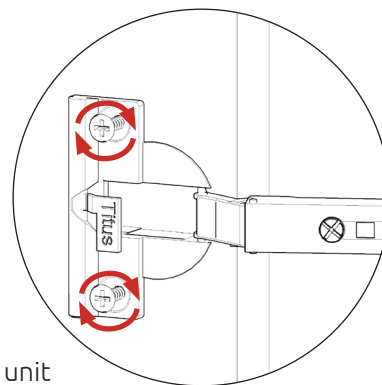

Step 16.

Attach the door to unit where required. Adjust hinges to suit. See below.

To **attach** door
clip hinge onto hinge
plate and click to secure.

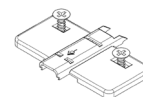

Hinge Plates

Step 18.

Fit cover caps to hinge.
Adjust SoftClose to Suit.

Hinge Cover Caps

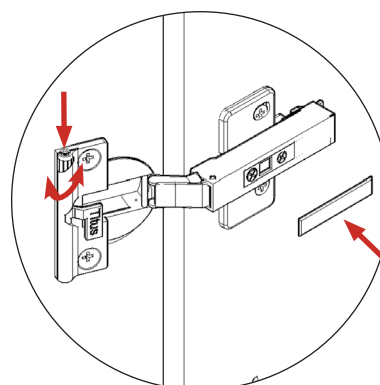

The top and bottom hinges **MUST** be adjusted to the **SAME STRENGTH**.

