

# BASE UNIT

600 Built Under Oven Housing

## Assembly Guide

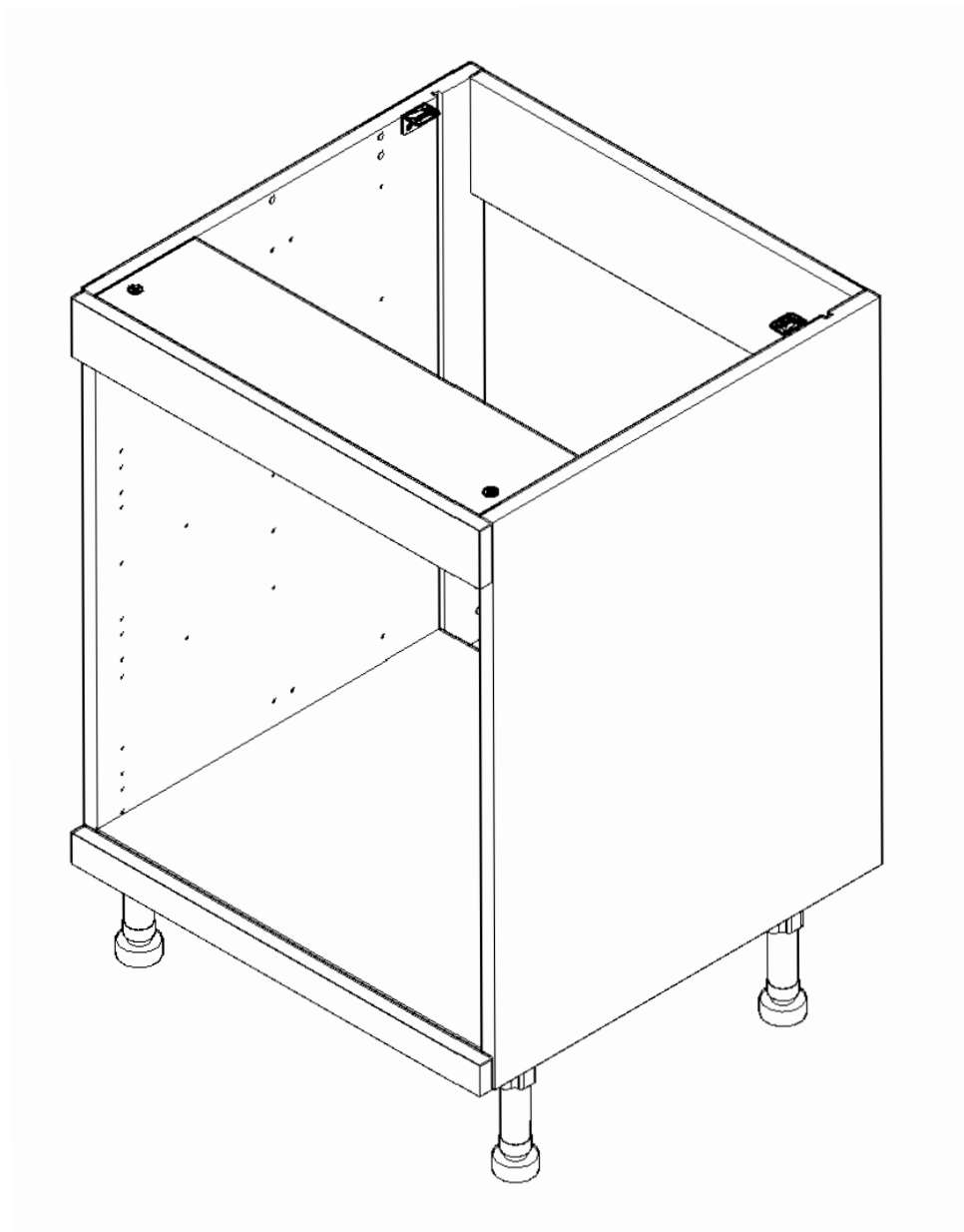

**wren**  
KITCHENS

For Internal Use: FI.WR.INS.031\_WKIN00110\_BASE\_600\_BUOH\_Rev3.indd

# BASE UNIT

600 Built Under Oven Housing

## Assembly Guide

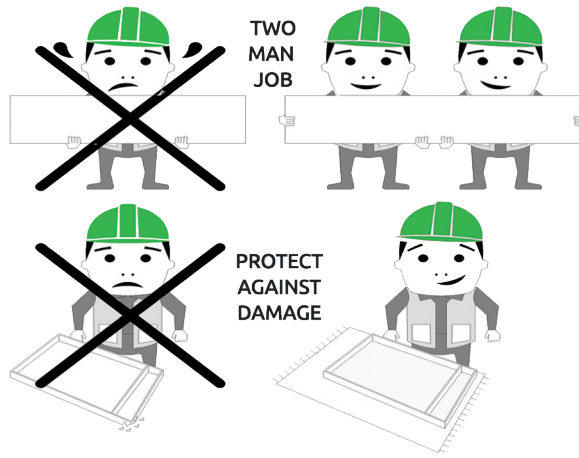

### BEFORE YOU START

INSTALLATION SHOULD BE PERFORMED BY A COMPETENT PERSON ONLY.

THIS PRODUCT COULD BE DANGEROUS IF INCORRECTLY INSTALLED

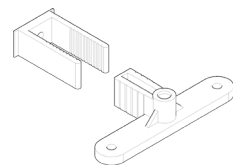
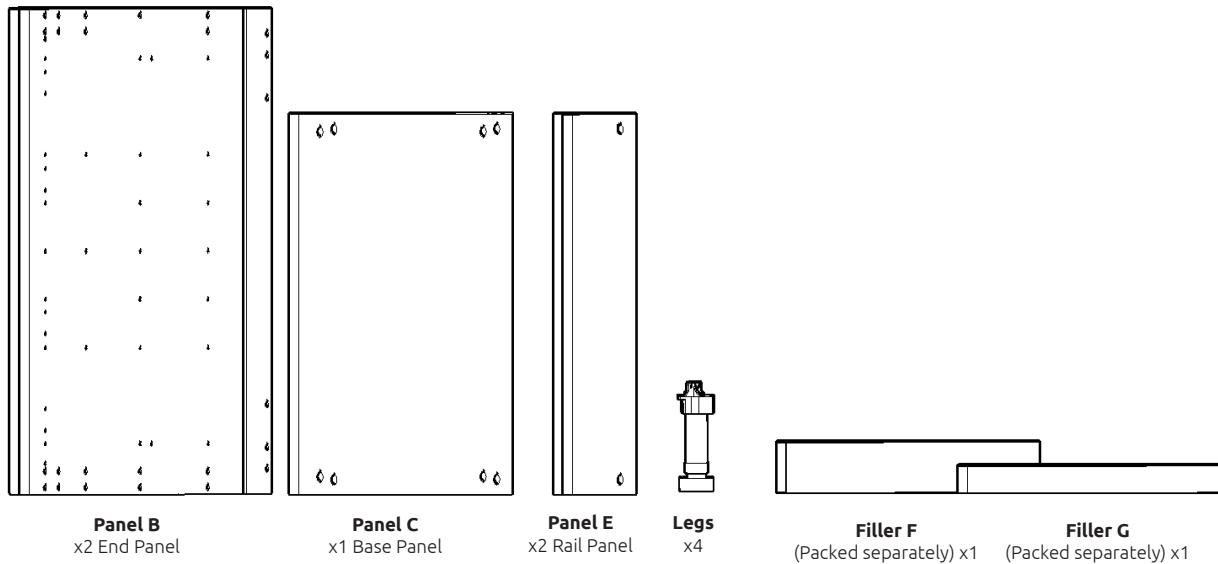

**Dummy Fixing Clip**  
x2 Inc Screws

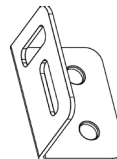

**Large Bracket**  
x2

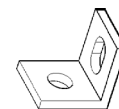

**Small Bracket (FF)**  
x2



**(F) x16**  
Wooden Dowel



**(G) x12**  
Cam Dowel (Expanding)



**(H) x12**  
Cam Lock

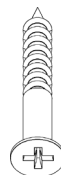

**(K) x4**  
30mm Screw

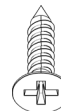

**(L) x26**  
15mm Screw



**(M) x4**  
Cover Cap

### REQUIRED TOOLS



NOT to be used with CAM DOWEL & CAM LOCK

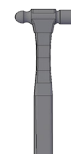

# BASE UNIT

600 Built Under Oven Housing

## Assembly Guide

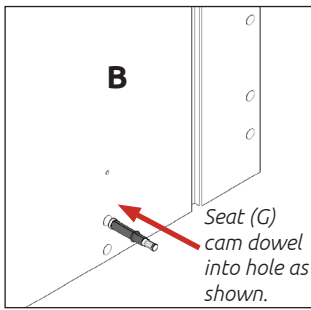

**Step 1.**  
Seat dowel (F)  
into holes in  
panels as shown.



**Step 2.**  
Seat cam dowel (G)  
into holes in panels  
as shown.

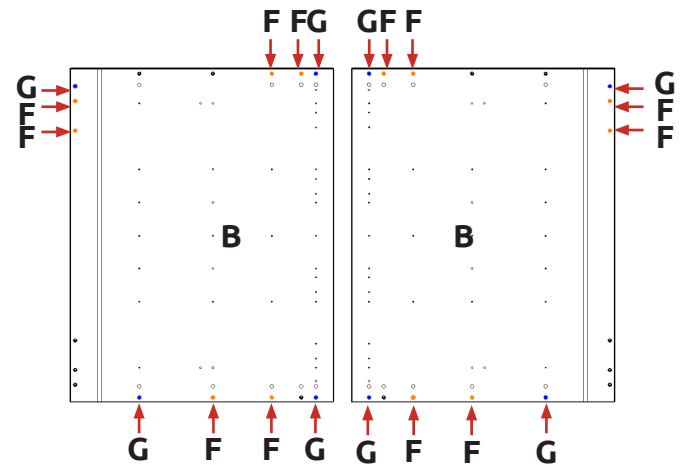
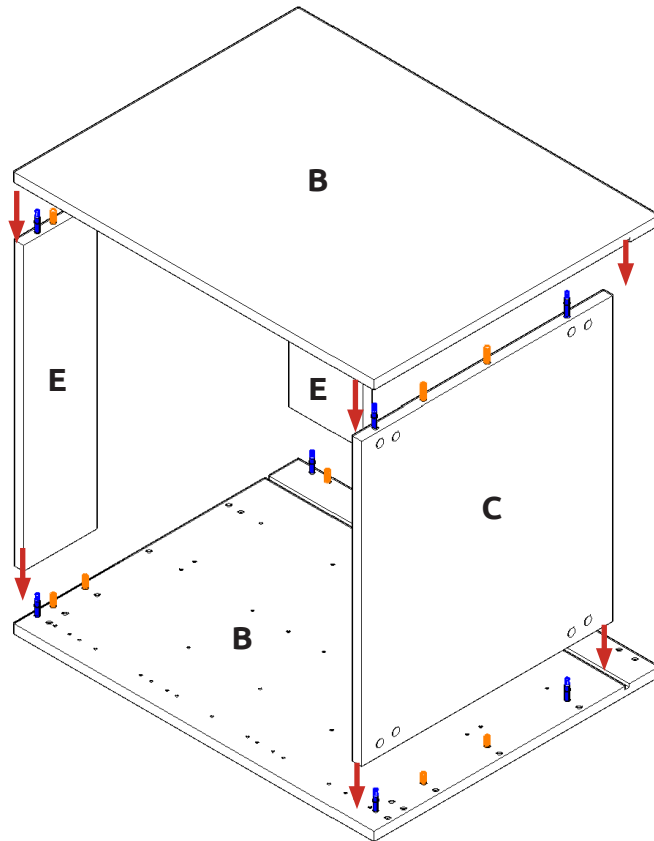
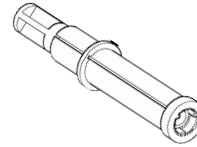

Dowel (F)  
& Cam Dowel (G)  
location detail

**Step 3.**  
Attach panels (C) & (E) to  
panels (B), using cam dowel (G)  
& cam lock (H) (in blue),  
and also using dowels (F) (in  
orange) in positions as shown.

**!** All **Cam Locks (H)** are to be positioned facing the outside of the unit carcass, for ease of tightening.

Do **NOT** use power tools with  
cam dowel (G) or cam lock (H)

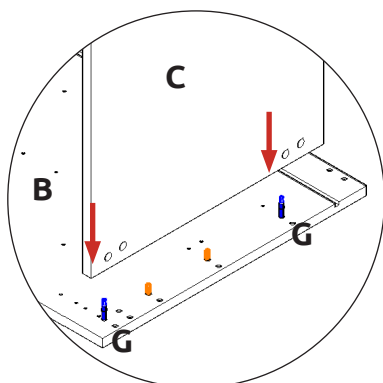

View from underside

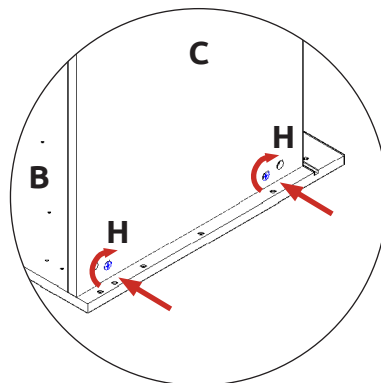

View from underside

**Step 4.**  
Join panels (C) & (E) to  
(B). Insert cam lock (H).



# BASE UNIT

600 Built Under Oven Housing

## Assembly Guide

### Step 5.

Secure each of the legs into place with 4 x 15mm screws (L) as shown.

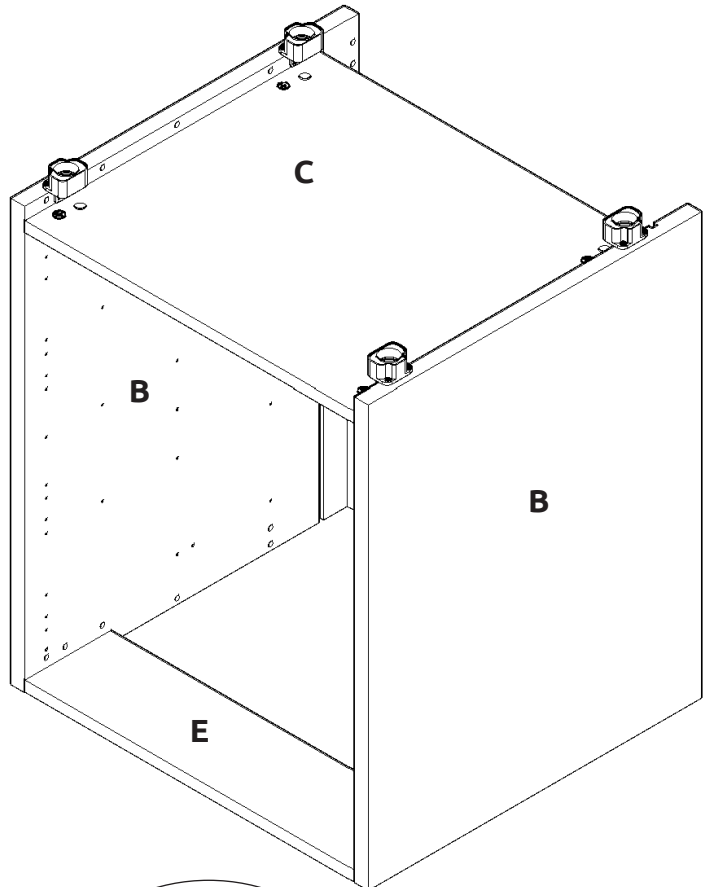
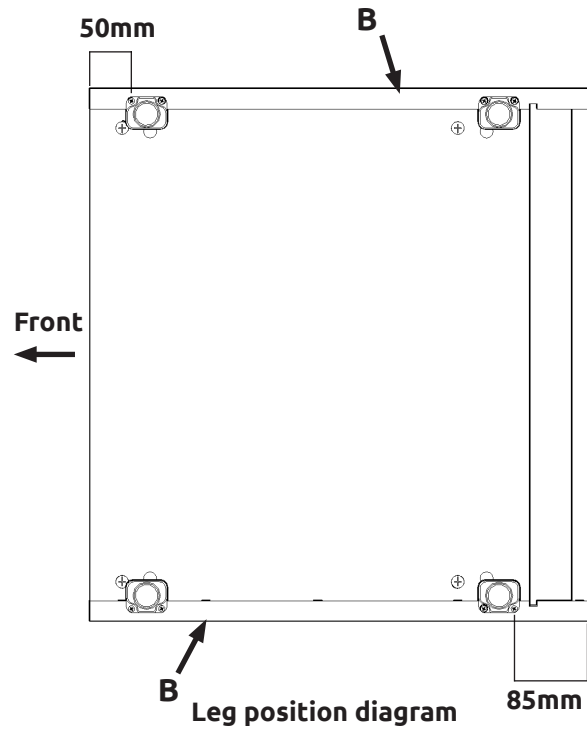
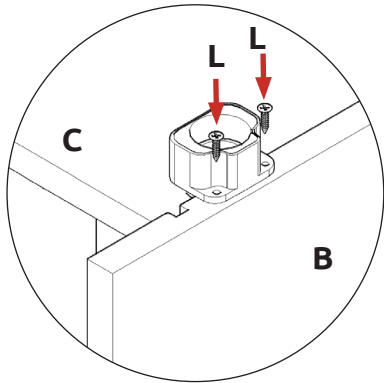
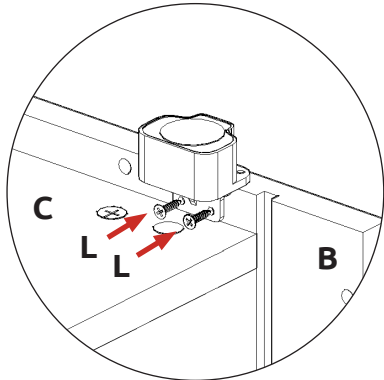

### Step 6.

Push leg firmly down into leg base. Adjust legs to 155mm before turning carcass upright. Once in situ level accordingly.

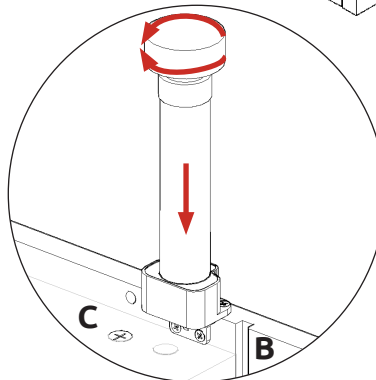

# BASE UNIT

600 Built Under Oven Housing

## Assembly Guide

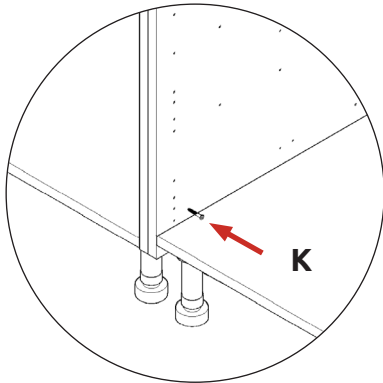

**Securing to Adjacent Units**  
Screw into any side units using the 30mm screws (**K**) provided to secure to unit. Screw at the top and bottom of both sides of the unit, place a cover cap (**M**) on the head to conceal it.

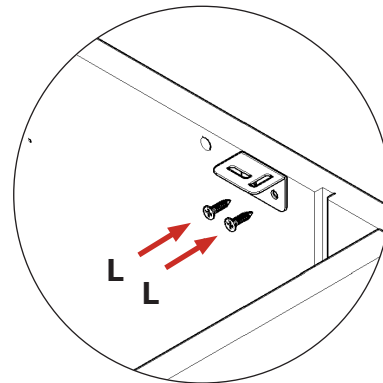

### L Brackets

Use 2 x 15mm screws (**L**) to secure each of the L brackets to the cabinets at either side. Then screw up through into the worktop as shown.

**Screws for attaching to worktop are not supplied as these vary depending on worktop material and thickness. Ensure appropriate fixings for attaching worktop are used. L brackets should only be fitted for securing wood and laminate worktops, please refer to the specialist worktop supplier if these are required for solid surface worktops.**

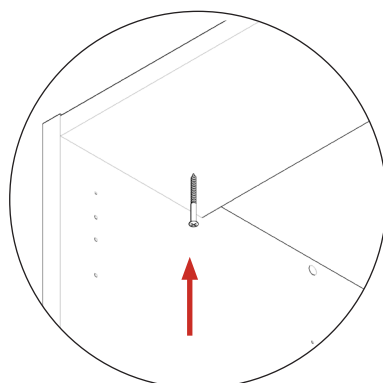
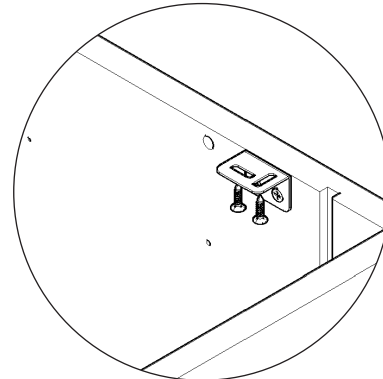

### Worktop

Screw up through the front rail into your worktop to secure it in place.

**Screws for attaching to worktop are not supplied as these vary depending on worktop material and thickness. Ensure appropriate fixings for attaching worktop are used. Please refer to the specialist worktop supplier if these are required for solid surface worktops.**

# BASE UNIT

600 Built Under Oven Housing

## Assembly Guide

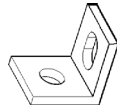

Small Bracket

Filler F

Filler G

### Step 7.

Use 15mm screw (**L**) per small L Bracket (**FF**) to secure to inside face of Filler (**G**). Attached equally spaced as shown.

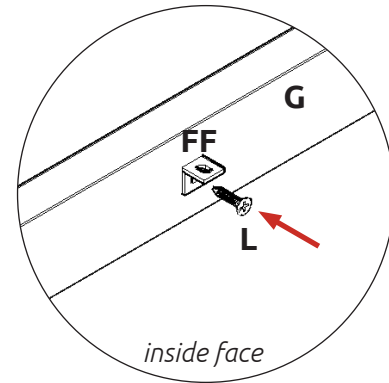
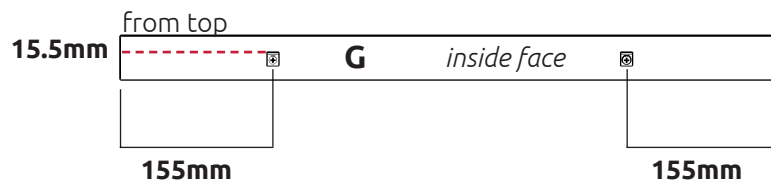

### Step 8.

Align Filler (**G**) to unit ensuring it is in line with adjacent units. Secure Filler (**G**) with Small L bracket (**FF**) to Base of unit with 15mm Screw (**L**) as shown.

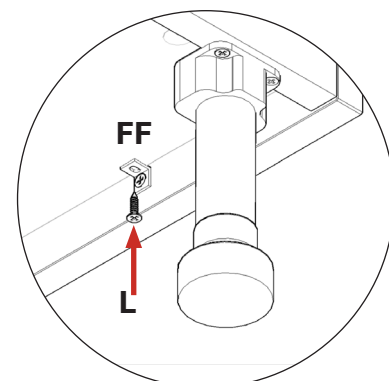
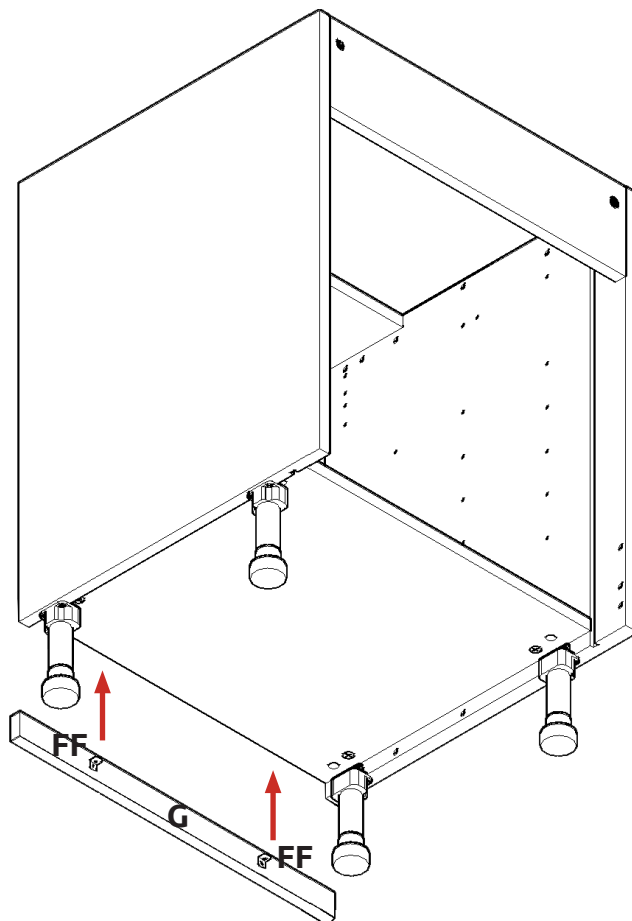

View from bottom of unit

# BASE UNIT

600 Built Under Oven Housing

## Assembly Guide

### Step 9.

Secure dummy fixing clip Parts **(B)** onto the inside face at the bottom of panel **(F)**, 17mm from the edge spaced evenly either side as shown, using screws **(L)**. Align so frontal is in line with adjacent frontals.

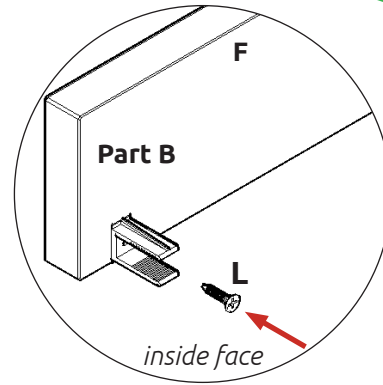
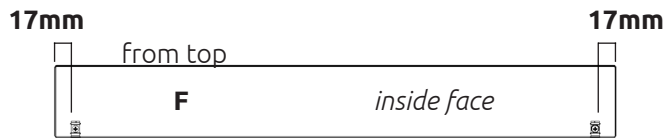
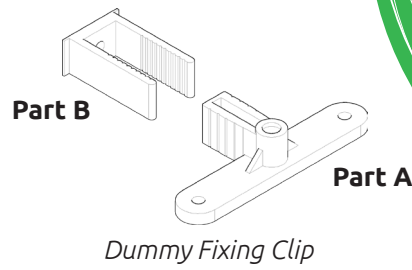

### Step 10.

Secure dummy fixing clip parts **(A)** onto both End Panels **(B)** using 2 x 15mm screws **(L)** each, as shown. The top screw hole is to be positioned 45mm from the top of the panel (marked by an indentation).

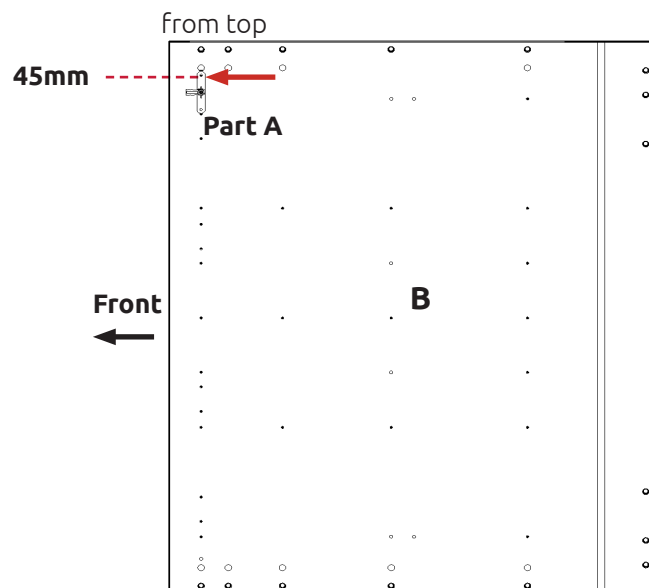
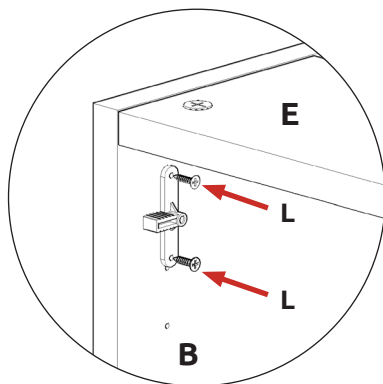

### Step 11.

Align and push panel **(F)** into place. Ensure frontal is in line with adjacent units. Space appropriately from carcass.

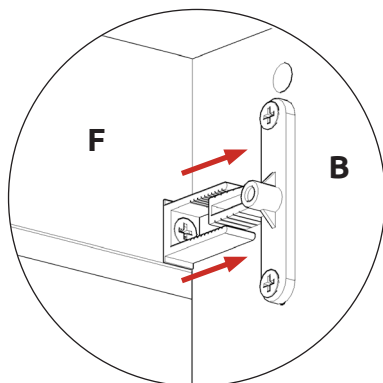

View from inside of unit

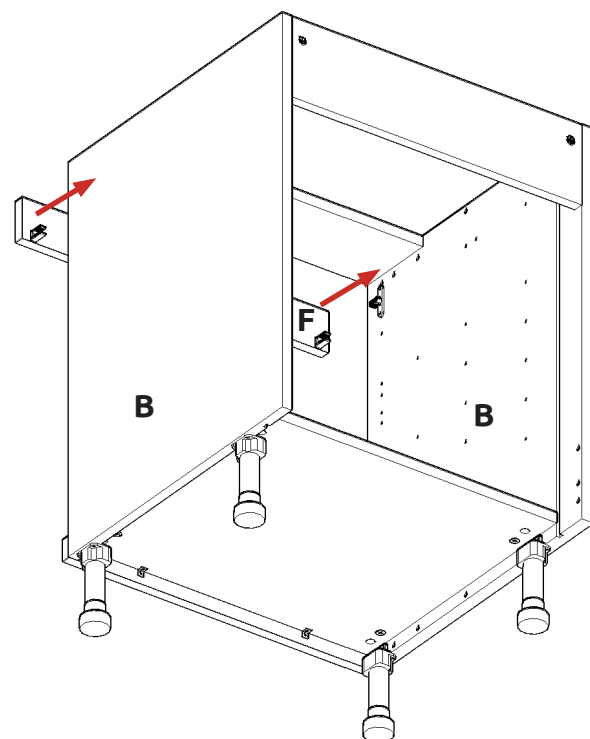

**wren**  
KITCHENS