

FRONTALS

Titus Hinge - Replacement Frontal Attachment Guide

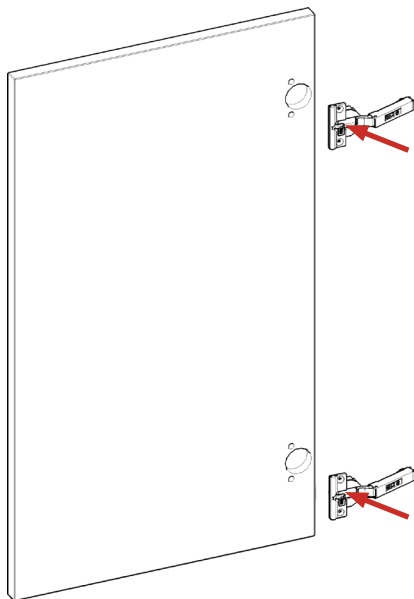

For frontals with unit mechanisms, see specific mechanism instructions for frontal attachment guidelines.



Step 1.

Discard existing hinge dowels and replace with new ones provided.

Step 2.

Insert hinges into hinge holes provided, in accordance with customer specific kitchen plan.

Step 3.

Secure hinges with the 2 x screws already located in the hinges.

Step 4.

Attach the door to unit, clip hinge onto hinge plate and click to secure.

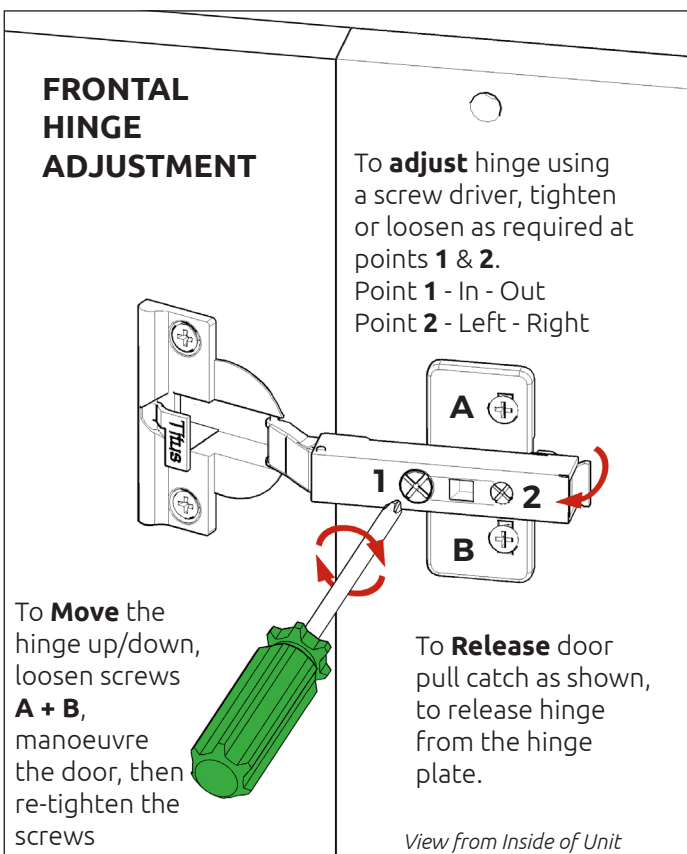
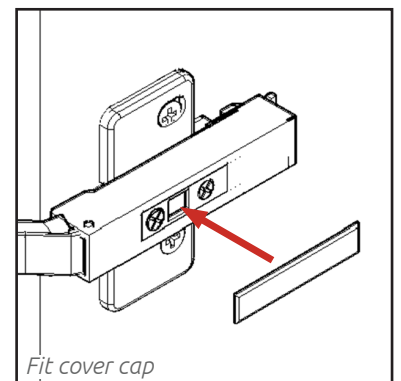
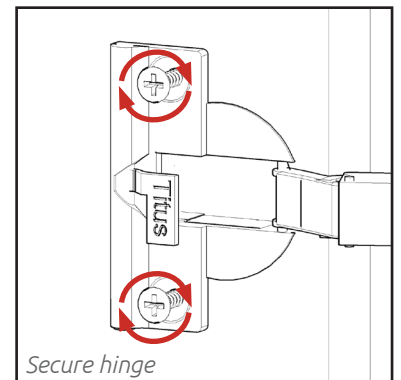
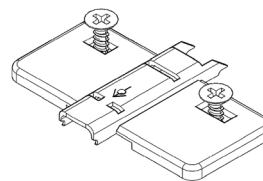

Step 5.

Adjust hinge to suit. As shown on the left.

Step 6.

Fit cover cap to hinge. Adjust soft-close to suit.

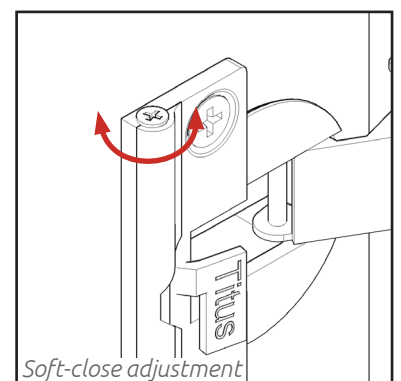
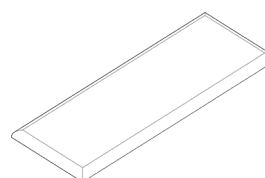

The top and bottom hinges **MUST** be adjusted to the **SAME STRENGTH**.

wren
KITCHENS

FRONTALS

Grass Hinge - Replacement Frontal Attachment Guide



For frontals with unit mechanisms, see specific mechanism instructions for frontal attachment guidelines.

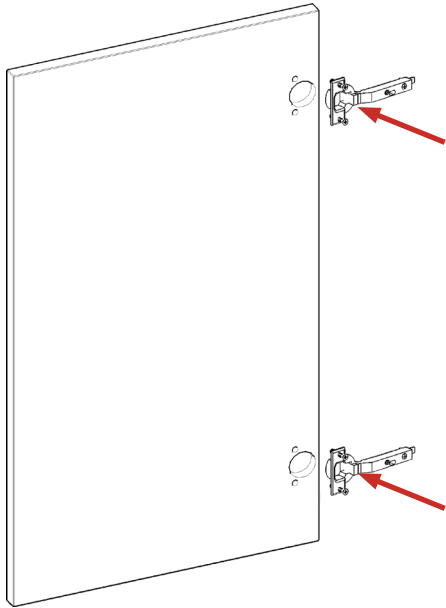
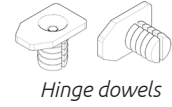

Step 1.

Discard existing hinge dowels and replace with new ones provided.

Step 2.

Insert hinges into hinge holes provided, in accordance with customer specific kitchen plan.

Step 3.

Secure hinges with the 2 x screws already located in the hinges.

Step 4.

Attach the door to unit, clip hinge onto hinge plate and click to secure.

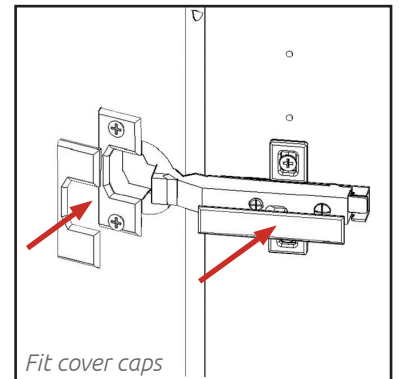
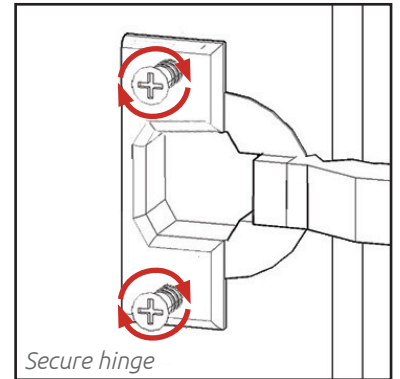
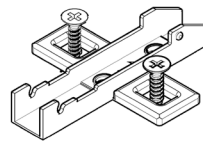

FRONTAL HINGE ADJUSTMENT

To **adjust** hinge using a screw driver, tighten or loosen as required at points **1 & 2**.
 Point **1** - In - Out
 Point **2** - Left - Right

To **Move** the hinge up/down, loosen screws **A + B**, manoeuvre the door, then re-tighten the screws

To **Release** door pull catch as shown, to release hinge from the hinge plate.

View from Inside of Unit

Step 5.

Adjust hinge to suit. As shown on the left.

Step 6.

Fit cover caps to hinge. Adjust soft-close to suit.

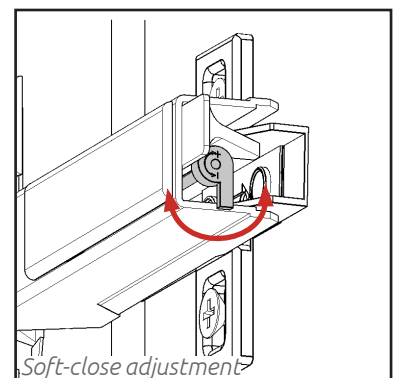
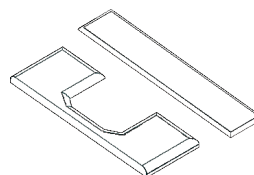

The top and bottom hinges **MUST** be adjusted to the **SAME STRENGTH**.