

TOWER UNIT

2070 & 2250 Diagonal Corner Office Assembly Guide

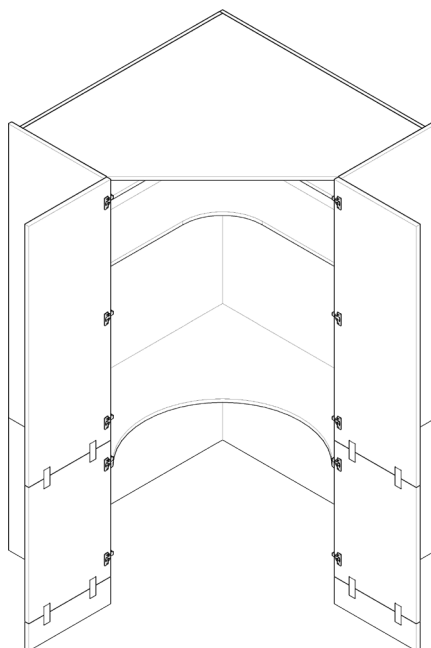

2070 - 2250 x 1302

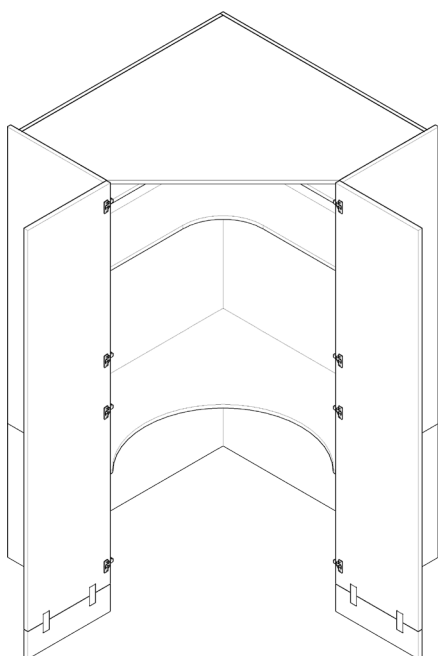
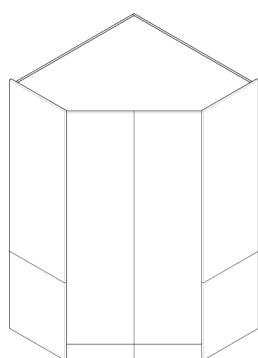
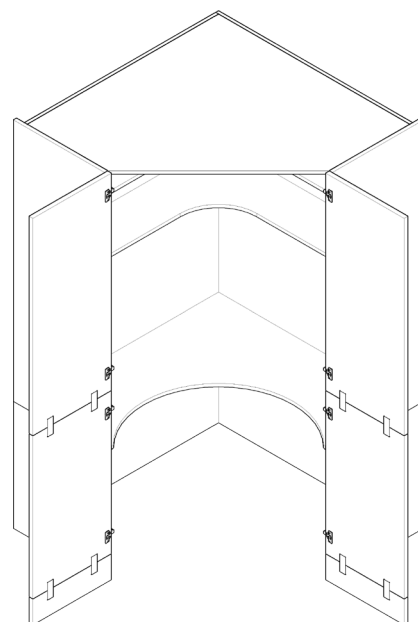

1 Door

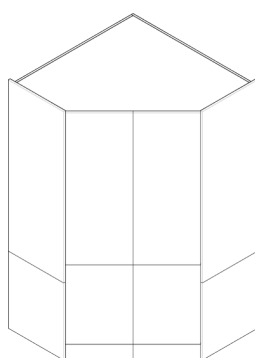

70/30 Door

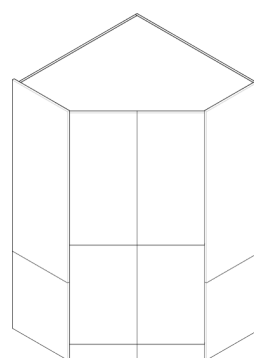

50/50 Door

TOWER UNIT

2070 & 2250 Diagonal Corner Office Assembly Guide

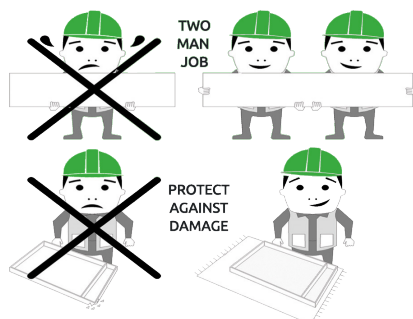

BEFORE YOU START

INSTALLATION SHOULD BE PERFORMED BY A COMPETENT PERSON ONLY.

THIS PRODUCT COULD BE DANGEROUS IF INCORRECTLY INSTALLED

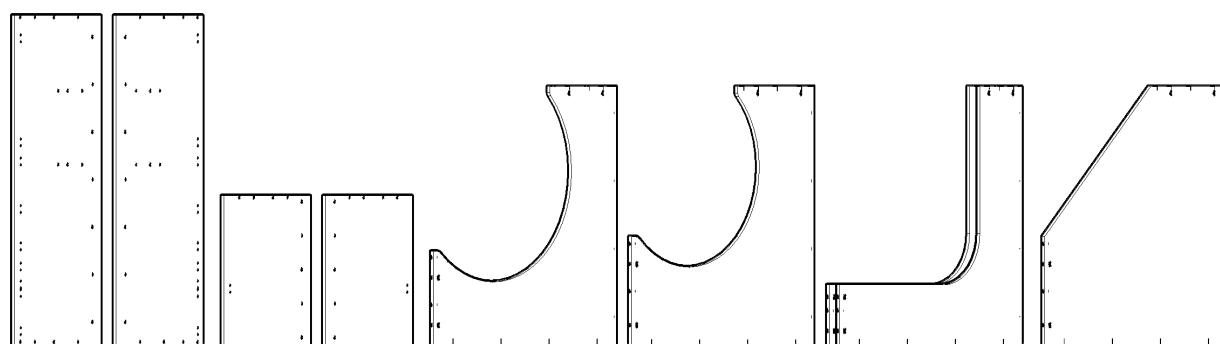

Panel eA x1 End Panel Left Hand
Panel eB x1 End Panel Right Hand
Panel eC x1 End Panel Left Hand
Panel eD x1 End Panel Right Hand
Panel eE x1 Fixed Shelf
Panel eF x1 Fixed Shelf
Panel eG x2 Fixed Shelf
Panel eH x1 Top Panel

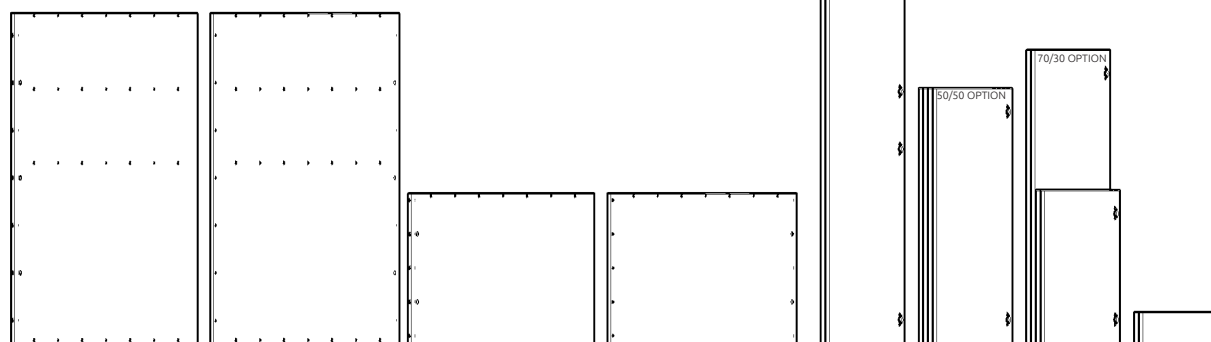

Panel bK x1 Back Panel Left Hand
Panel bL x1 Back Panel Right Hand
Panel bM x1 Back Panel Left Hand
Panel bN x1 Back Panel Right Hand
Frontals 1Dr or 50/50 or 70/30 (Packed Separately)
Plinth x2



Cam Dowel (W)
x 30



Cam Lock (H)
x 30



Wooden Dowel (F)
x 70

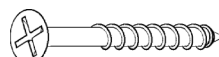

45mm Screw (P)
x 42

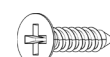

15mm Screw (L)



30mm Screw (K)
x 16

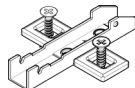

Hinge Mounting Plate
Inc Screws

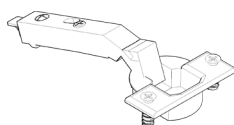

Hinge
Inc Screws

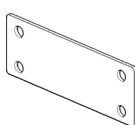

Fixing Plate (U)

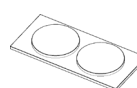

Door Buffer
x1



Screw Cover Cap
x 4 (Per Colour)



L Bracket (LGE)
x4

REQUIRED TOOLS



NOT to be used with CAM DOWEL & CAM LOCK



Step 1.

Seat 4 cam dowels (**W**) into holes in end panel (**eC**) as shown.

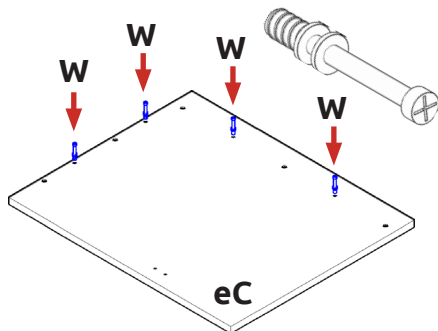

Step 2.

Seat 2 wooden dowels (**F**) into holes in panel (**sE**) as shown.

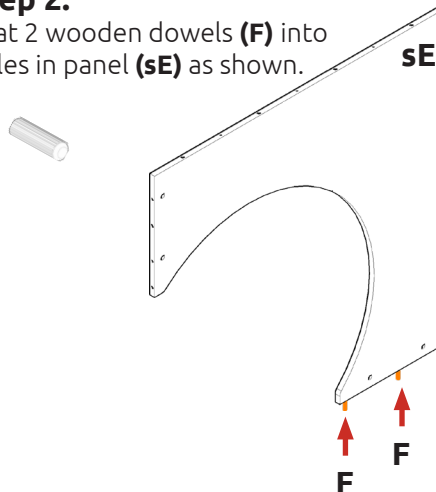

Step 3.

Attach panel (**sE**) to end panel (**eC**), using cam dowels (**W**) (in **blue**) and wooden dowels (**F**) (in **orange**) in positions as shown.

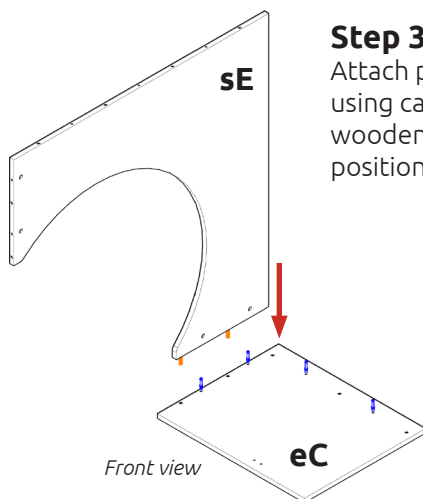

Front view

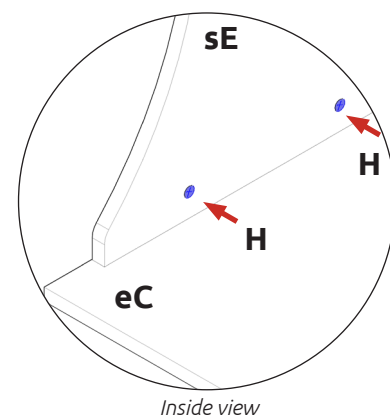
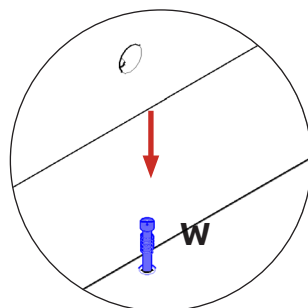

Inside view



Step 4.

Insert 2 cam locks (**H**) into holes in panel (**sE**) as shown.
Do NOT tighten until step 16.

Do **not** use power tools with cam dowel (**W**) or cam lock (**H**)

Step 5.

Seat 8 wooden dowels (**F**) into holes in panel (**sE**) and 3 wooden dowels (**F**) into holes in end panel (**eC**) as shown.

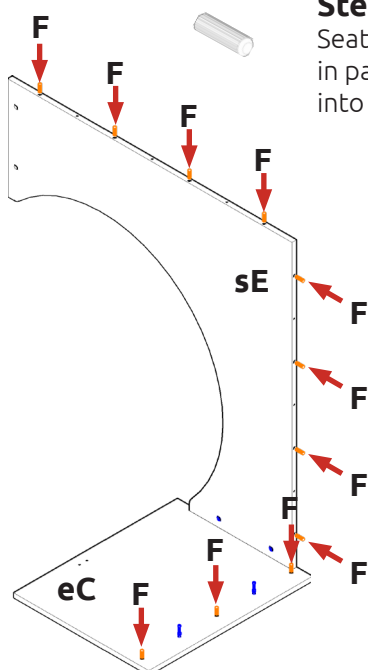

Back right view

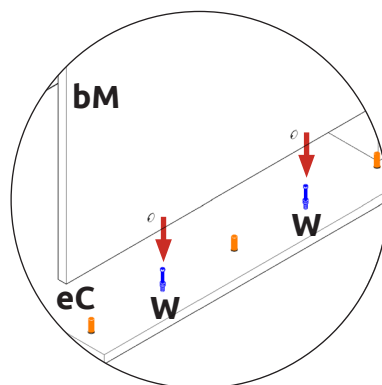

Back right view

Step 6.

Attach back panel (**bm**) to end panel (**eC**) and panel (**sE**), using cam dowels (**W**) (in **blue**) and wooden dowels (**F**) (in **orange**) in positions as shown.

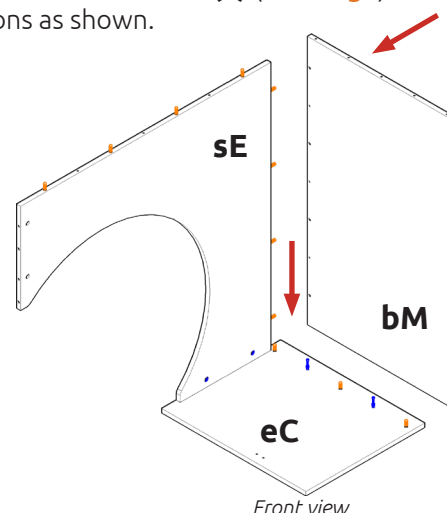

Front view

Once back panel (**bm**) is in position, ensure it is flush & square with bottom of end panel (**eC**).

TOWER UNIT

2070 & 2250 Diagonal Corner Office Assembly Guide

Step 7.



Insert 2 cam locks (**H**) into holes in back panel (**bM**) as shown.
Do NOT tighten until step 16.

Do **not** use power tools with cam dowel (**W**) or cam lock (**H**)

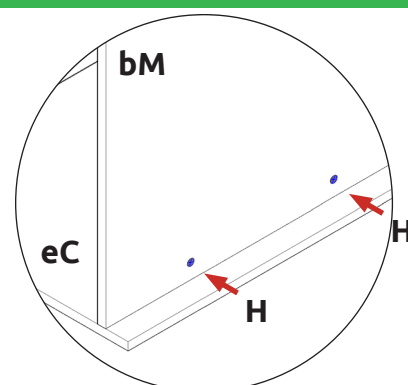

Back right view

Step 8.

Secure back panels (**bM**) to panel (**sE**), using 3 x 45mm screws (**P**) as shown.

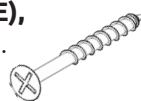

Step 9.

Attach back panel (**bN**) to panel (**sE**), using wooden dowels (**F**) (in orange) in positions as shown.

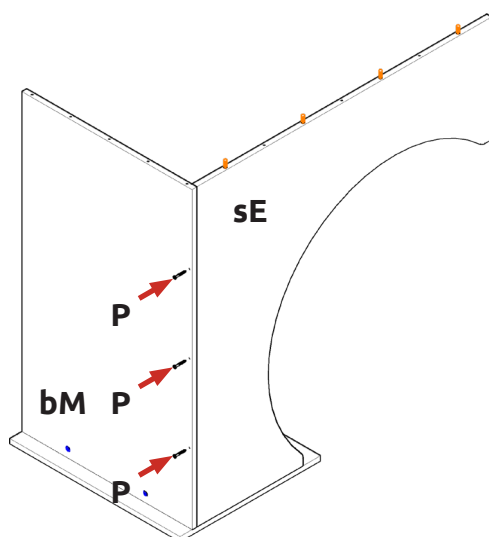

Back right view

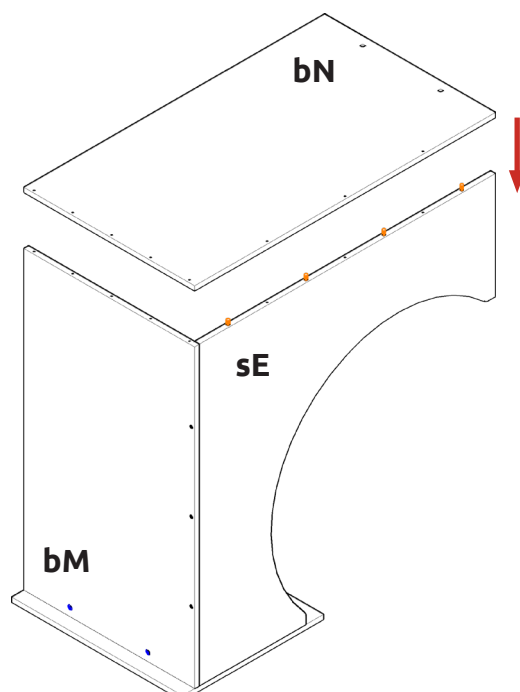

Back view

Step 10.

Secure back panel (**bN**) to panel (**sE**), using 3 x 45mm screws (**P**) as shown.

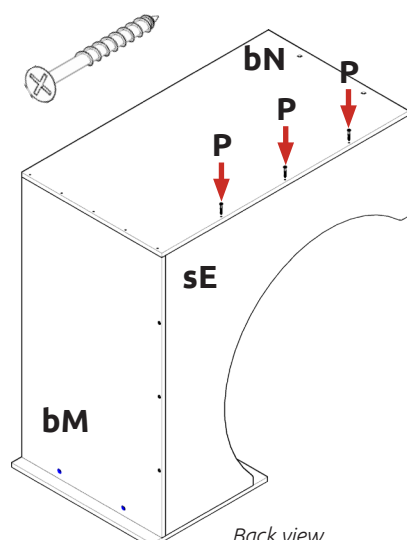

Back view

Step 11.

Secure back panel (**bN**) to back panel (**bM**), using 5 x 45mm screws (**P**) as shown.

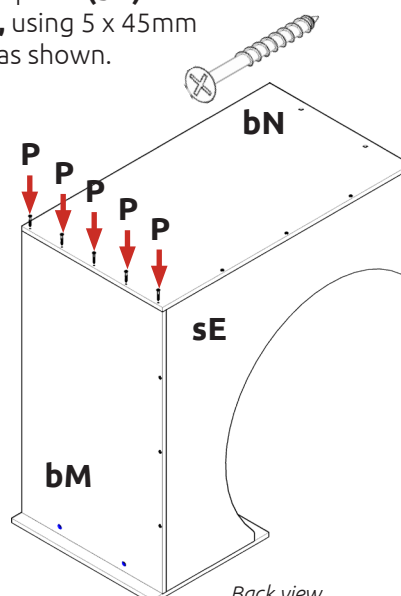

Back view

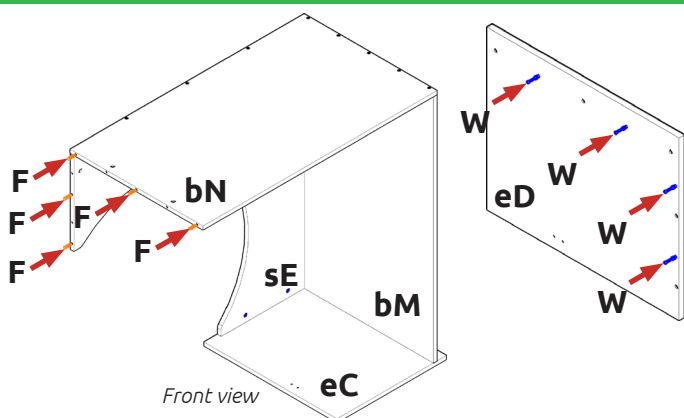

Step 12.

Seat 2 wooden dowels (**F**) into holes in panel (**sE**) and 3 wooden dowels (**F**) into holes in back panel (**bN**) as shown.

Step 13.

Seat 4 cam dowels (**W**) into holes in end panel (**eD**) as shown.



Do **not** use power tools with cam dowel (**W**) or cam lock (**H**)

Step 14.

Attach end panel (**eD**) to back panel (**bN**) and panel (**sE**), using cam dowels (**W**) (in **blue**) and wooden dowels (**F**) (in **orange**) in positions as shown.



Step 15.

Insert 2 cam locks (**H**) per panel into holes in back panel (**bN**) and in panel (**sE**)

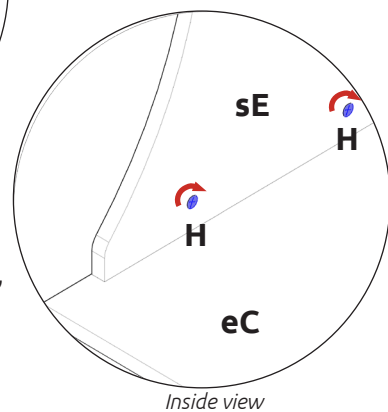
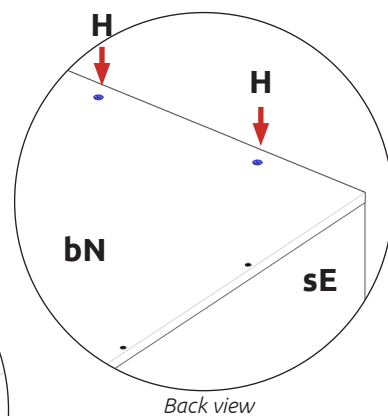
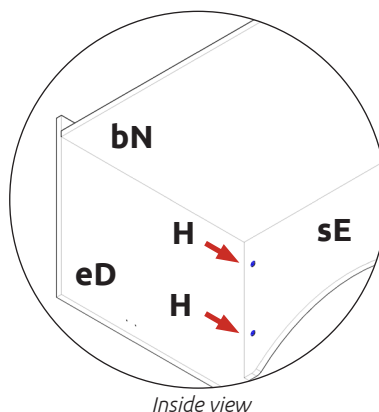
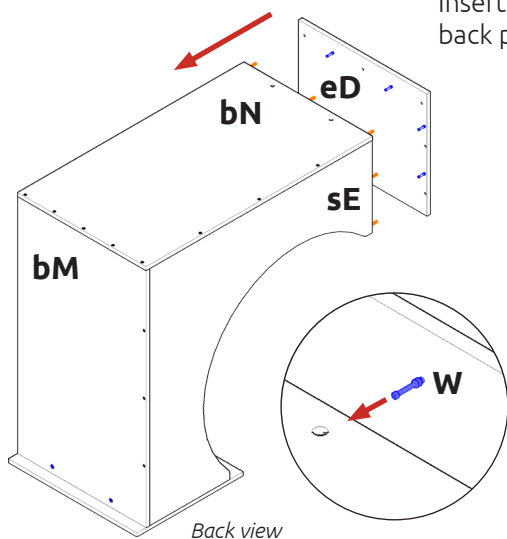

Step 17.

Secure unit to wall, using **L brackets LGE**. Use 2 x 15mm screws (**L**) to secure each of the **L brackets LGE** to the end panel at either side. Then screw through into the wall as shown.

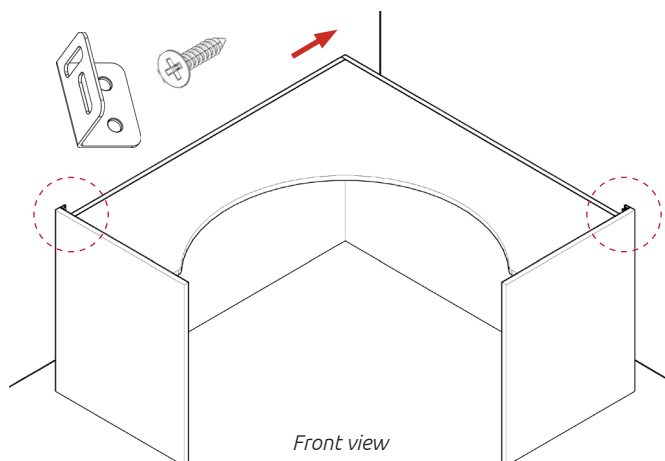

Step 16.

Hand tighten all cam locks (**H**), this will expand cam dowels (**W**) and tighten the unit together.

Screws for fixing to walls are not provided as these vary depending on your wall material and construction. Ensure appropriate fixings for wall constructions are used.

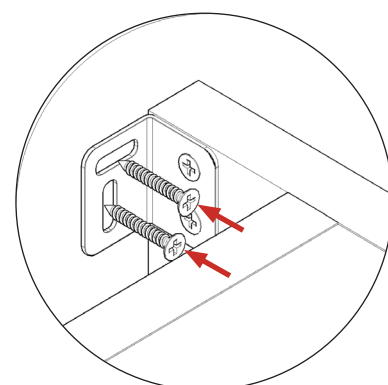
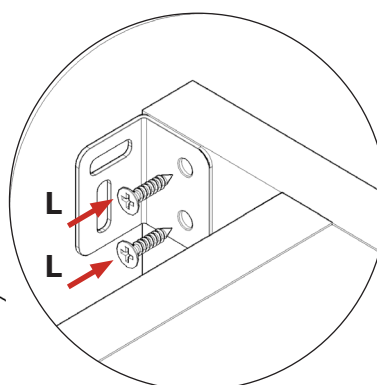

TOWER UNIT

2070 & 2250 Diagonal Corner Office Assembly Guide

Step 19.

Seat 2 wooden dowels (**F**) per panel into holes in panel (**sF**) and (**sH**) as shown.

Seat 1 wooden dowel (**F**) per panel into hole in panels (**sG**) as shown.

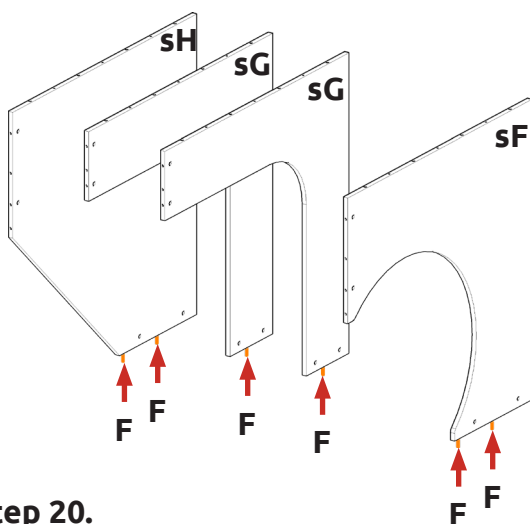

Step 20.

Attach panels (**sF**), (**sG**), (**sH**), to end panel (**eA**), using cam dowels (**W**) (in blue) and wooden dowels (**F**) (in orange) in positions as shown.

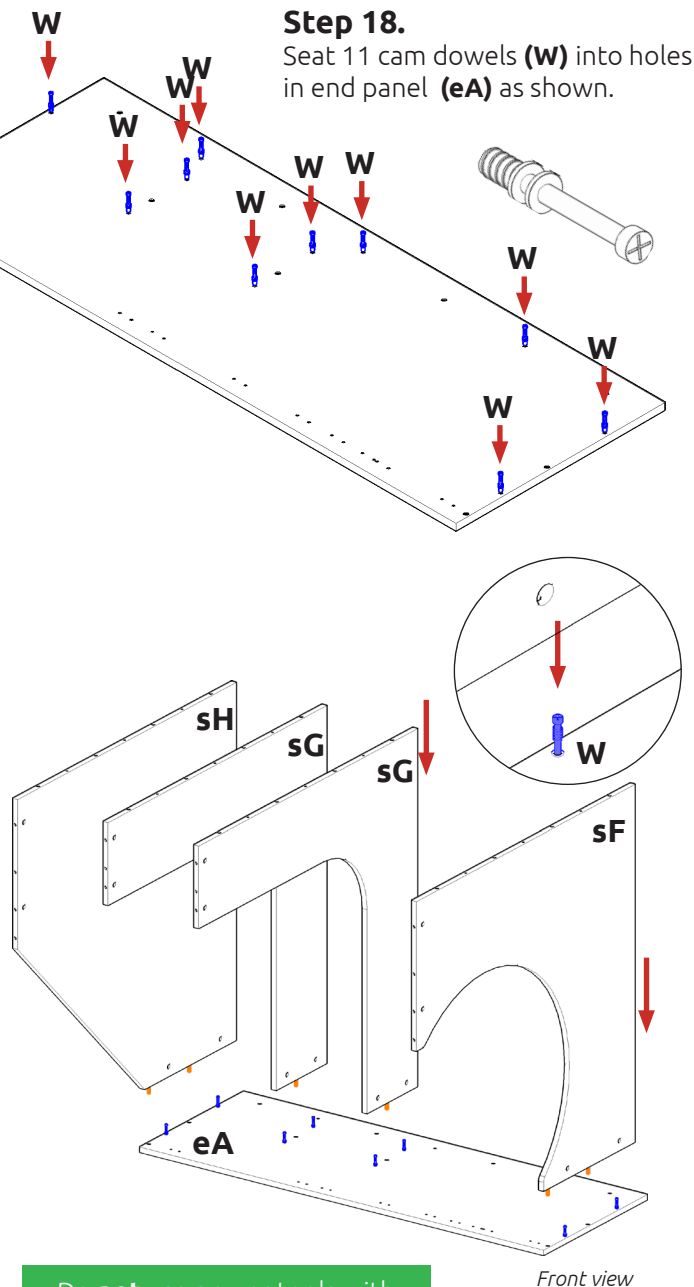

Front view

Step 21.



Insert 2 cam locks (**H**) per panel into holes in panels (**sF**), (**sG**) and (**sH**) as shown. Do NOT tighten until step 33.

Do **not** use power tools with cam dowel (**W**) or cam lock (**H**)

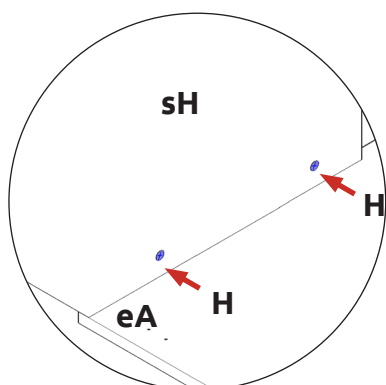

Inside view

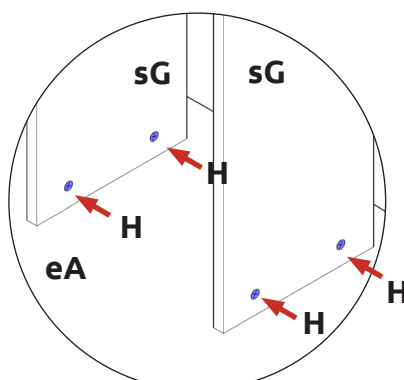

Inside view

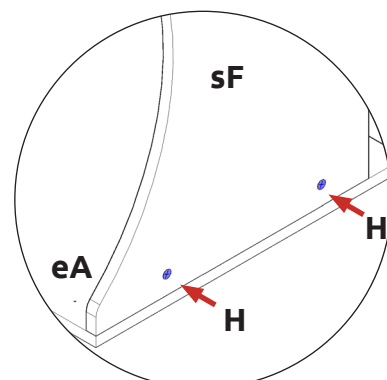

Front view

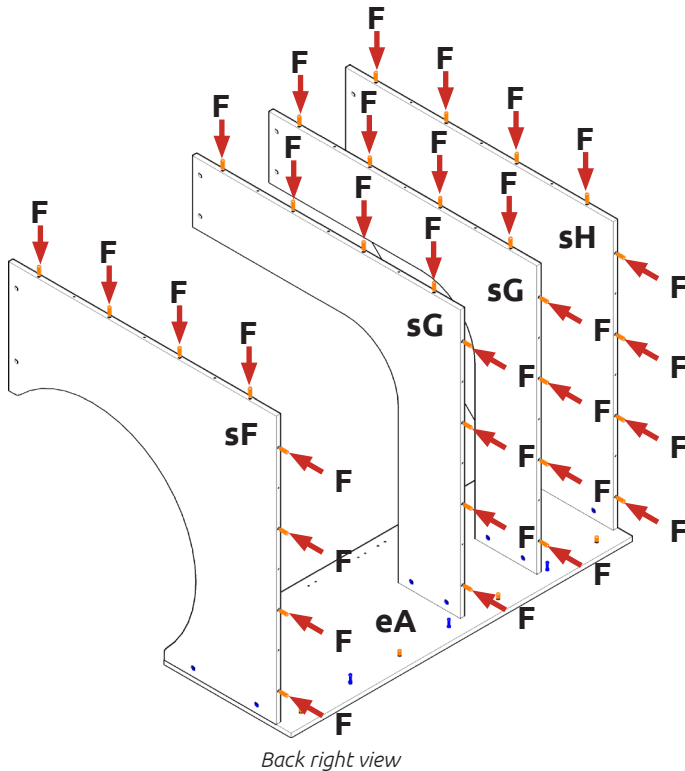

Step 23.

Attach back panel (**bK**) to end panel (**eA**) and panels (**sF**), (**sG**), (**sH**), using cam dowels (**W**) (in blue) and wooden dowels (**F**) (in orange) in positions as shown.

Once back panel (**bK**) is in position, ensure it is flush & square with bottom of end panel (**eA**).

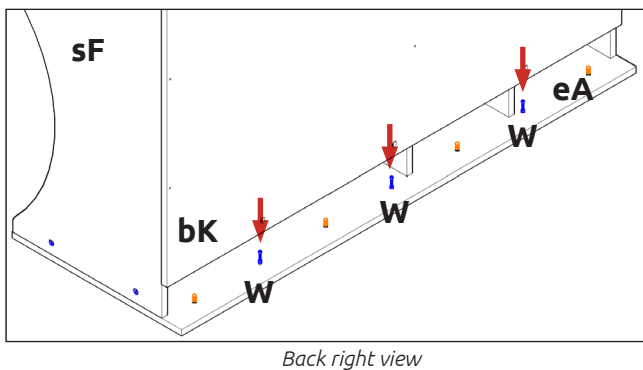

Step 24.

Insert 3 cam locks (**H**) into holes in back panel (**bK**) as shown. Do NOT tighten until step 33.



Do **not** use power tools with cam dowel (**W**) or cam lock (**H**)

Step 22.

Seat 8 wooden dowels (**F**) per panel into holes in panels (**sF**), (**sG**) and (**sH**) and 4 wooden dowels (**F**) into holes in end panel (**eA**) as shown.

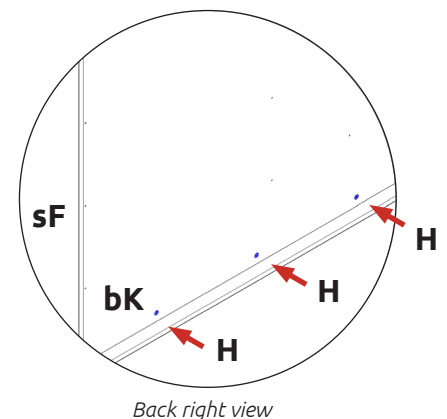
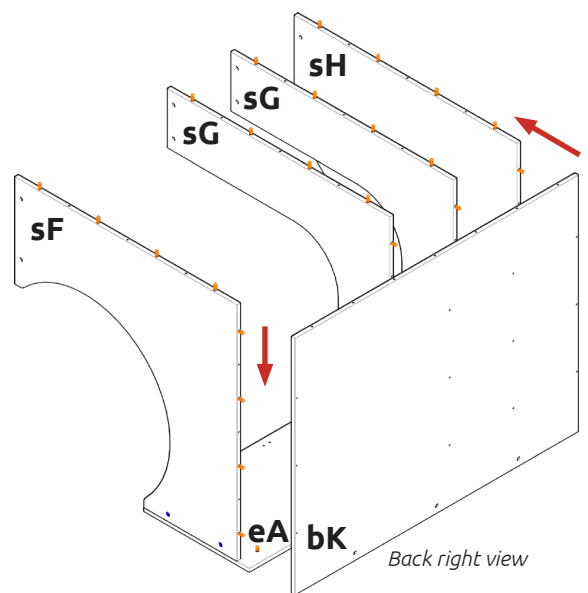
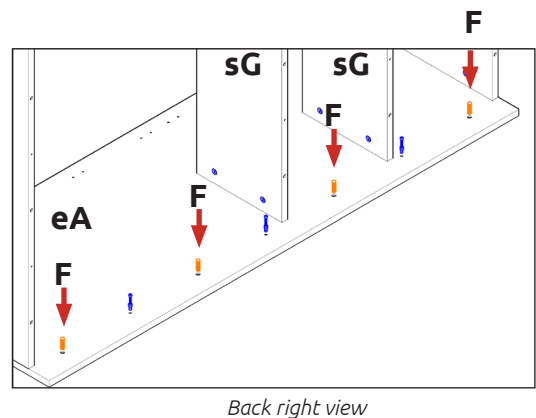

TOWER UNIT

2070 & 2250 Diagonal Corner Office Assembly Guide

Step 25.

Secure back panel (**bK**) to panels (**sF**), (**sG**) and (**sH**), using 12 x 45mm screws (**P**) as shown.

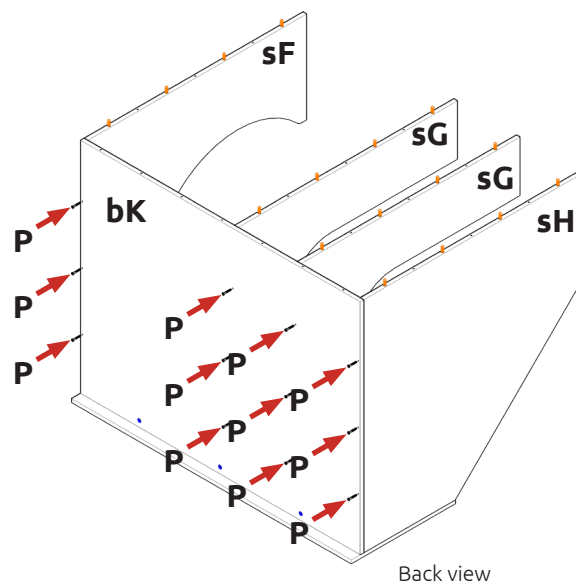
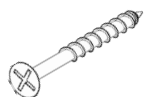

Step 26.

Attach back panel (**bL**) to panels (**sF**), (**sG**), (**sH**), using wooden dowels (**F**) (in orange) in positions as shown.

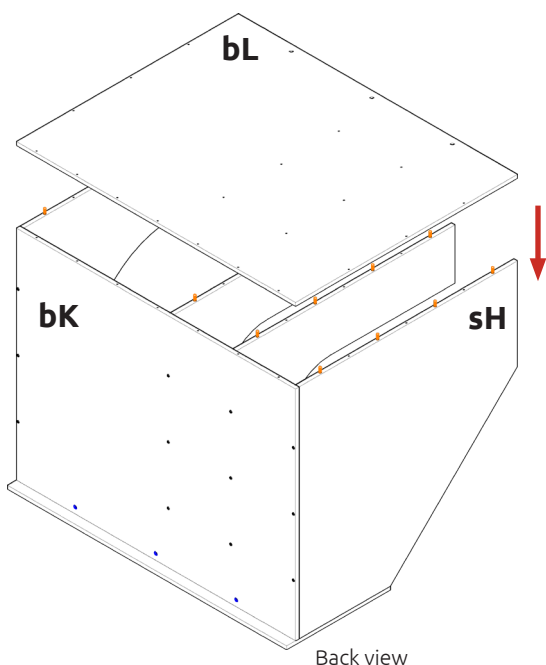

Step 27.

Secure back panel (**bL**) to panels (**sF**), (**sG**) and (**sH**), using 12 x 45mm screws (**P**) as shown.

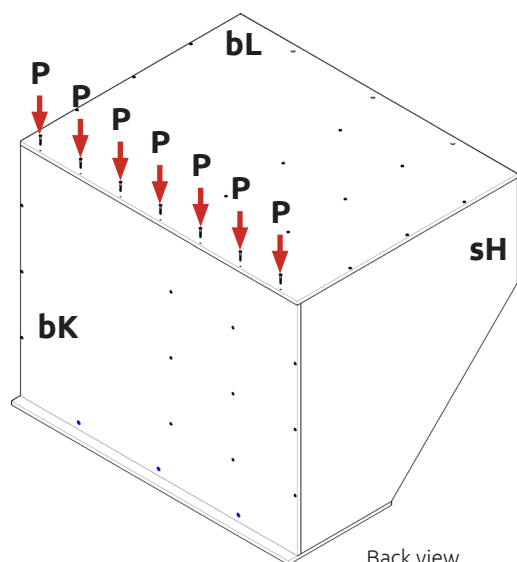
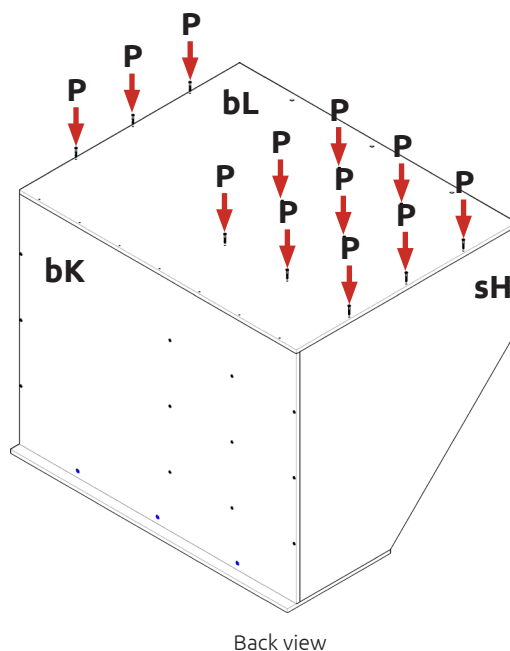
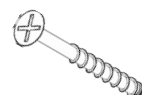

Step 28.

Secure back panel (**bL**) to back panel (**bK**), using 7 x 45mm screws (**P**) as shown.

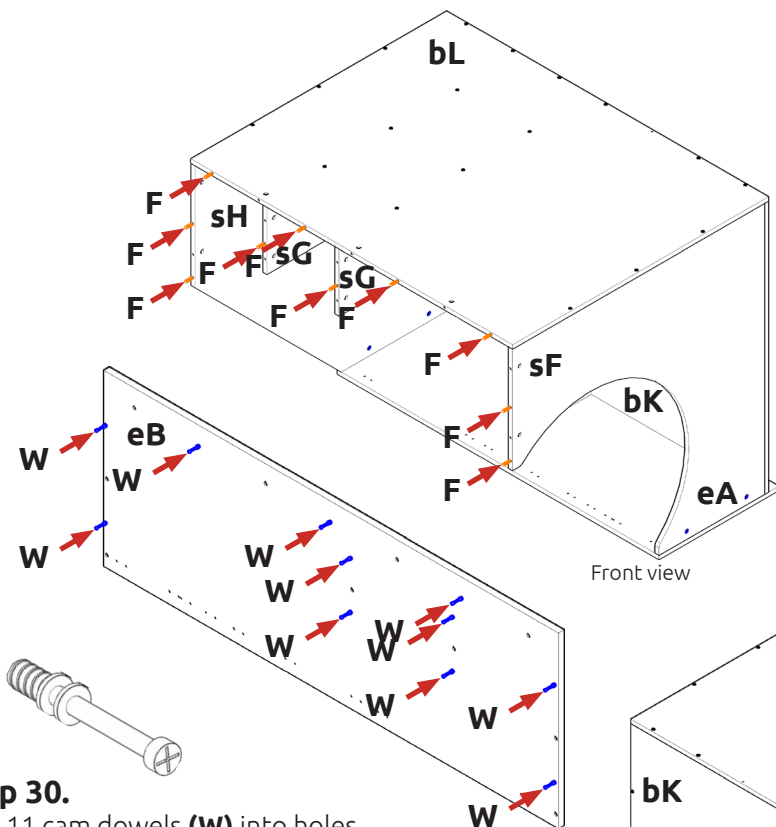

Step 29.

Seat 2 wooden dowels (**F**) per panel into holes in panel (**sF**) and (**sH**) as shown.

Seat 1 wooden dowel (**F**) per panel into hole in panels (**sG**) as shown.

Seat 4 wooden dowels (**F**) into holes in back panel (**bL**) as shown.

Step 30.

Seat 11 cam dowels (**W**) into holes in end panel (**eB**) as shown.

Step 31.

Attach end panel (**eB**) to back panel (**bL**) and panels (**sF**), (**sG**), (**sH**), using cam dowels (**W**) (in **blue**) and wooden dowels (**F**) (in **orange**) in positions as shown.

Do **not** use power tools with cam dowel (**W**) or cam lock (**H**)

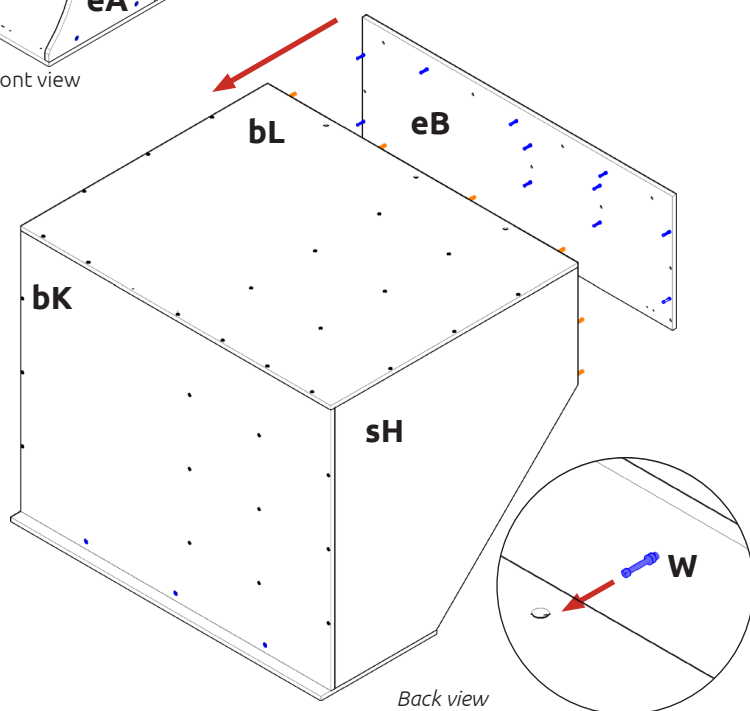

Step 32.

Insert 3 cam locks (**H**) into holes in back panel (**bL**) and 2 cam locks (**H**) per panel in panels (**sF**), (**sG**), (**sH**).

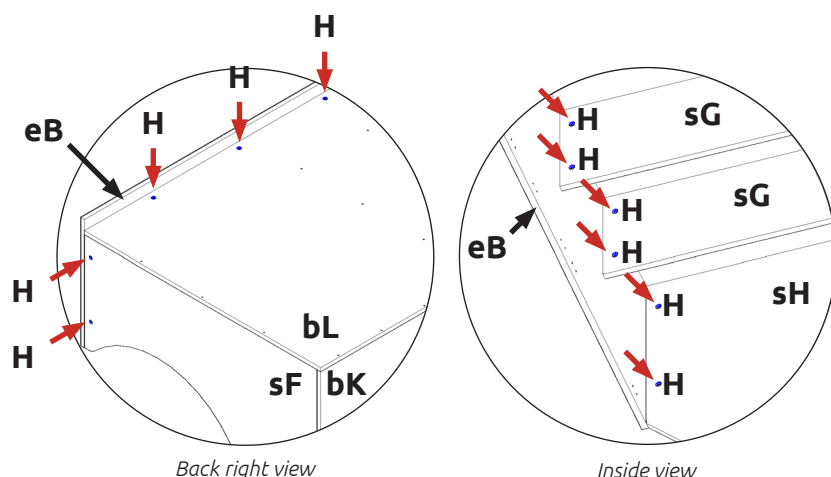

Step 33.

Hand tighten all cam locks (**H**). This will expand cam dowels (**W**) and tighten the unit together.

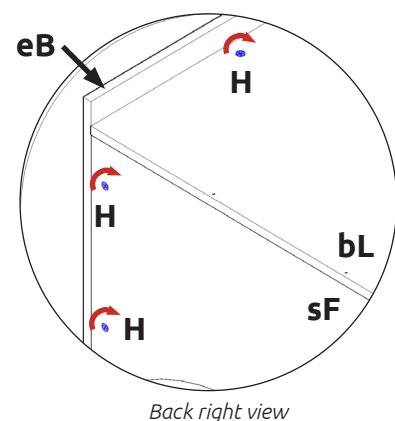

TOWER UNIT

2070 & 2250 Diagonal Corner Office Assembly Guide

Step 34.

Make sure bottom unit is attached to walls.
Place top unit on bottom unit, ensure end panel **(eA)** is flush with end panel **(eC)** and end panel **(eB)** is flush with end panel **(eD)**.

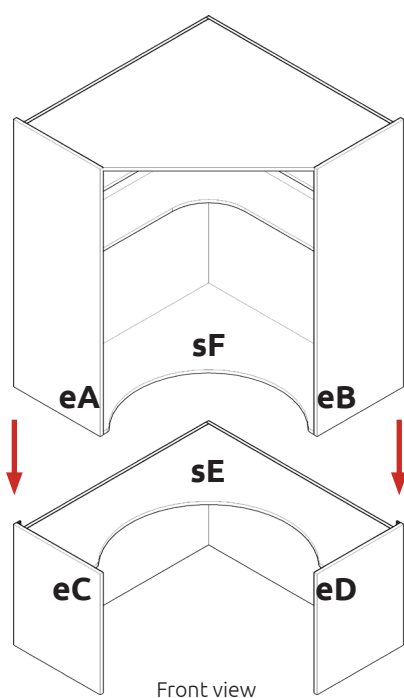

Step 35.

Secure top unit to bottom unit, using 10 x 30mm screws **(K)** as shown. Screw through panel **(sE)**.



DO NOT screw through panel **(sF)**.

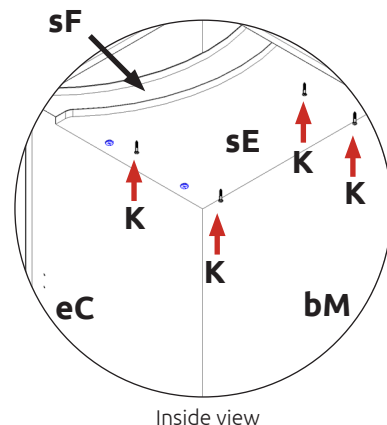

Inside view

Step 36.

Once top and bottom units are connected, secure top unit to wall, using L brackets LGE. Use 2 x 15mm screws **(L)** to secure each of the L brackets LGE to the end panel at either side. Then screw through into the wall as shown.

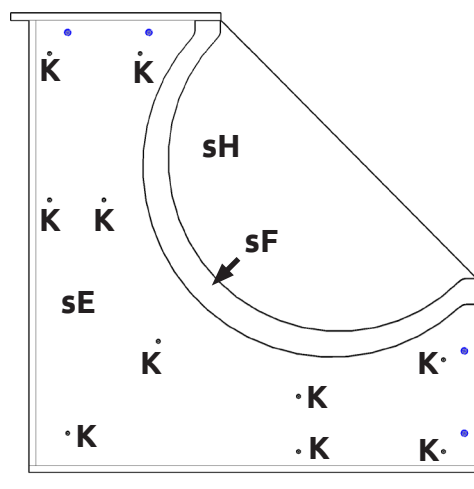

View From Underside

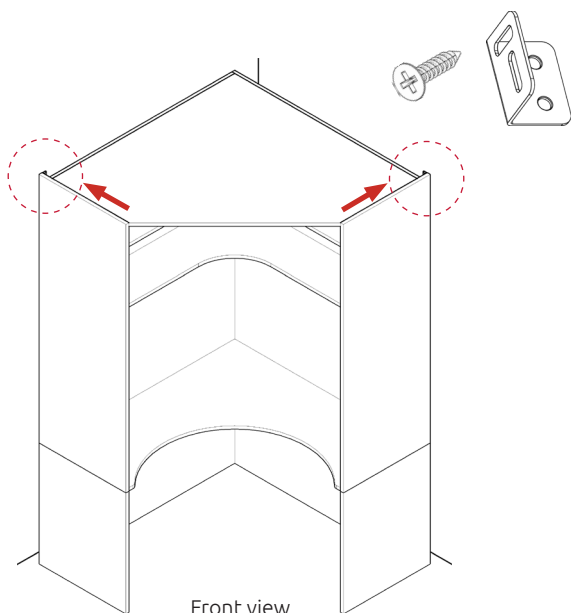

Screws for fixing to walls are not provided as these vary depending on your wall material and construction. Ensure appropriate fixings for wall constructions are used.

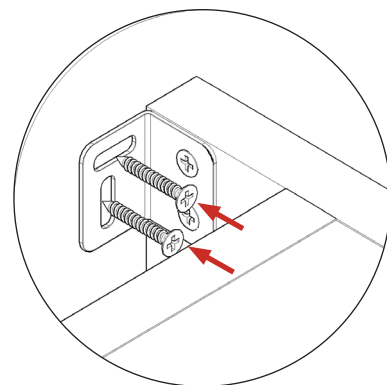
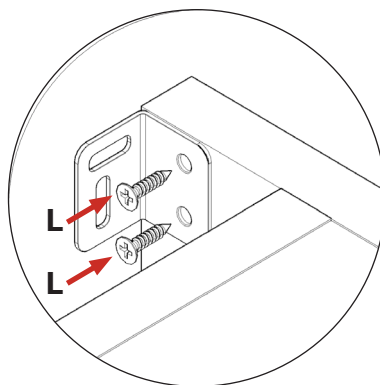

Step 37.

Attach hinge plates to the inside face of end panels on the left side (**eA**) and (**eC**) and end panels on the right side (**eB**) and (**eD**) to suit as shown.

Hinge side to be mounted in accordance to customer specific kitchen plan.

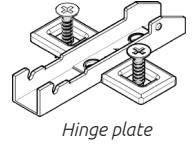
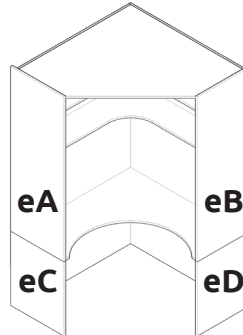

**2070mm unit
50/50 Door and 1 Door
HINGE POSITION**

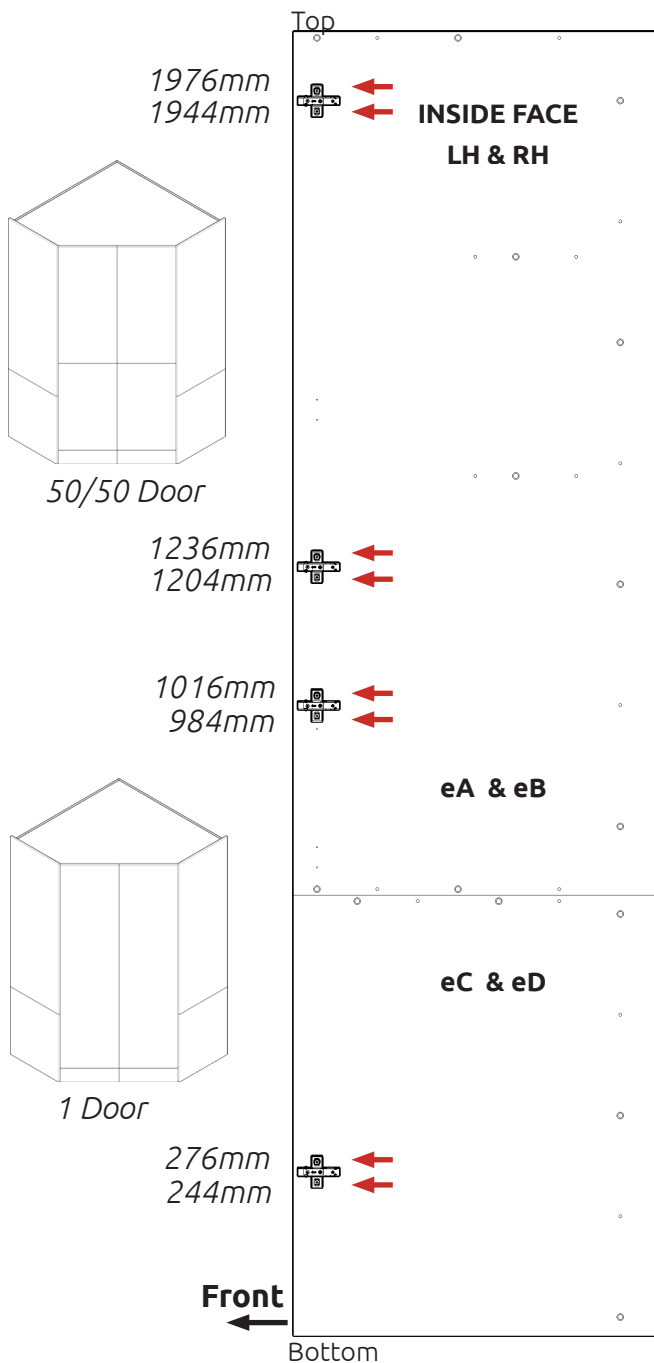

**2070mm unit
70/30 Door
HINGE POSITION**

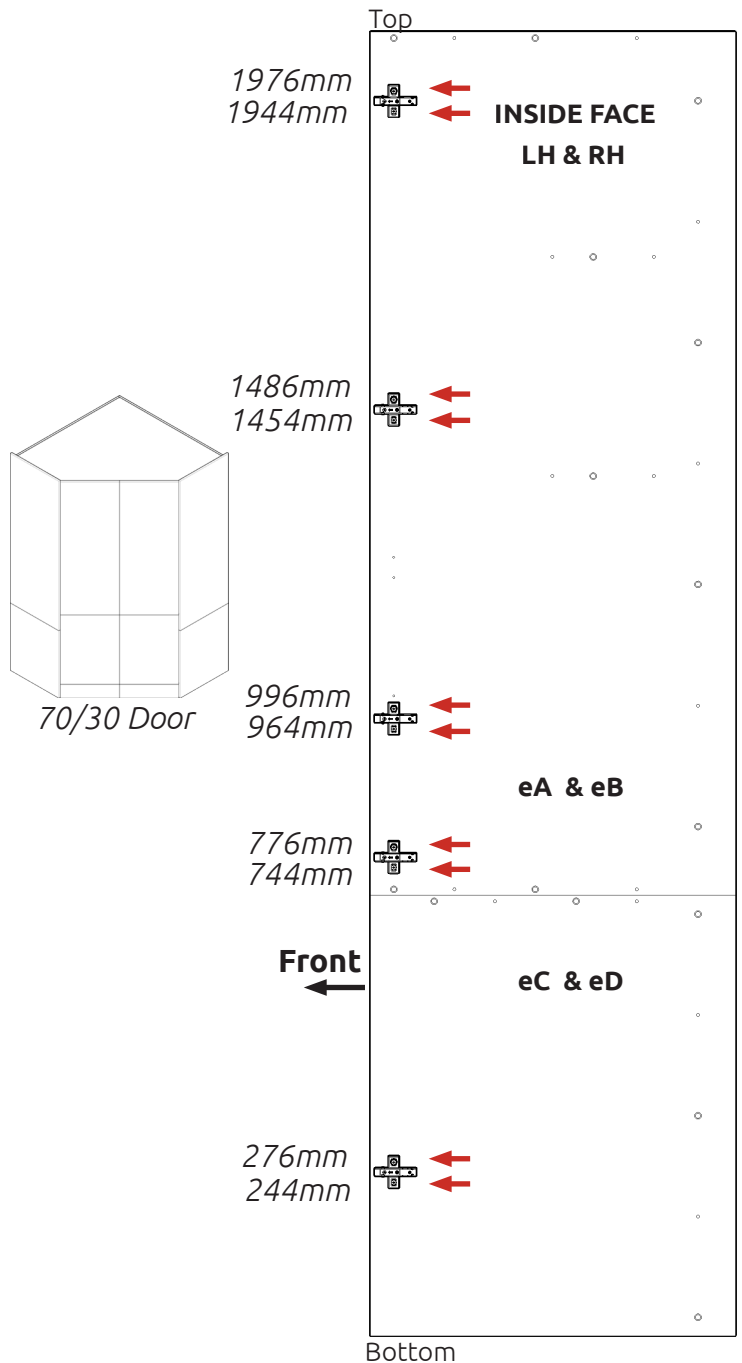

TOWER UNIT

2070 & 2250 Diagonal Corner Office Assembly Guide

Step 37.

Attach hinge plates to the inside face of end panels on the left side (**eA**) and (**eC**) and onto end panels on the right side (**eB**) and (**eD**) to suit as shown.

Hinge side to be mounted in accordance to customer specific kitchen plan.

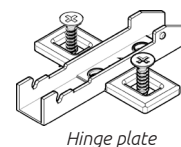
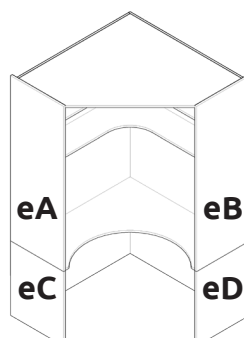

2250mm unit 50/50 Door HINGE POSITION

2250mm unit 70/30 Door HINGE POSITION

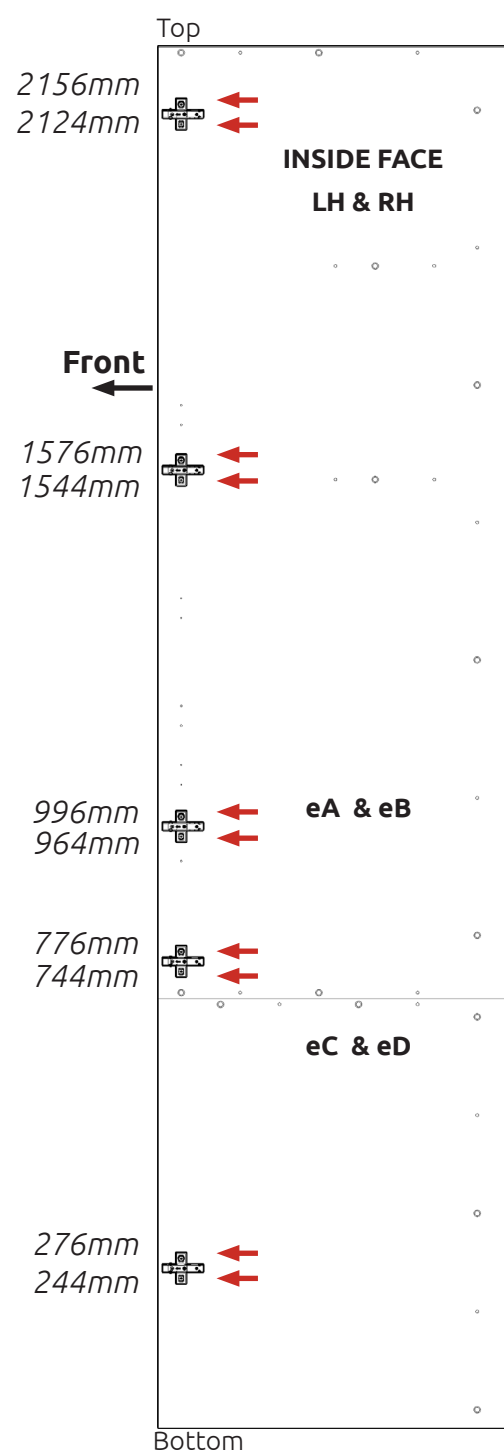
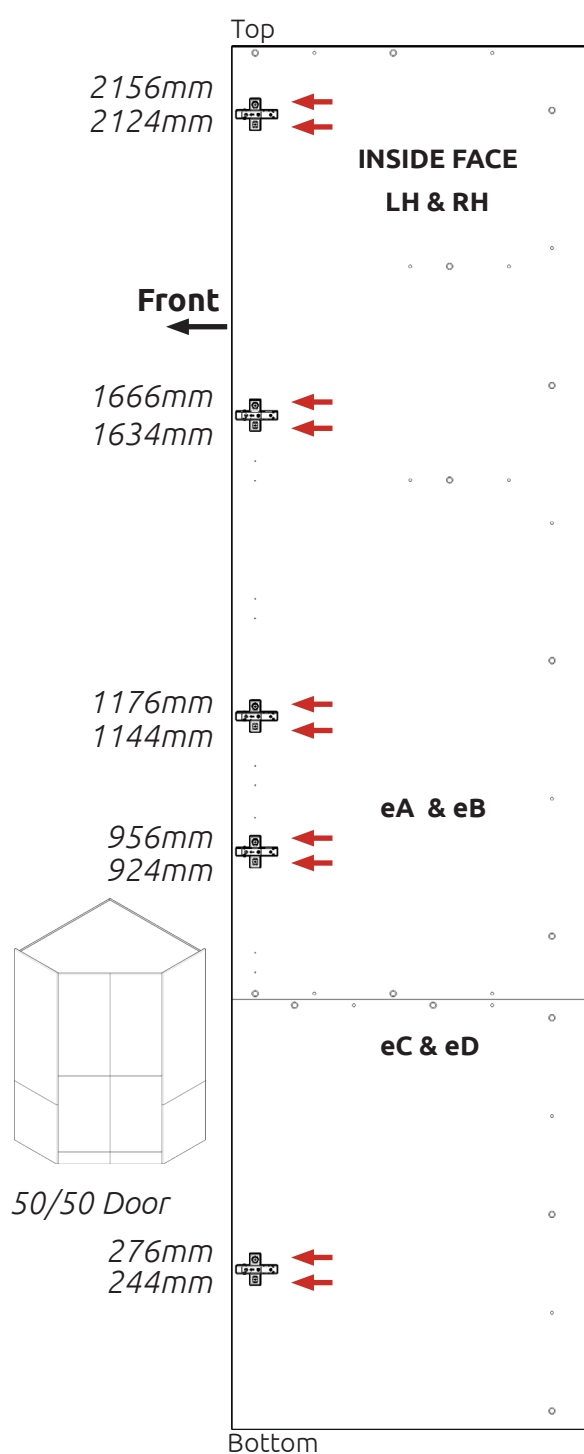

Step 37.

Attach hinge plates to the inside face of end panels on the left side (**eA**) and (**eC**) and onto end panels on the right side (**eB**) and (**eD**) to suit as shown.

Hinge side to be mounted in accordance to customer specific kitchen plan.

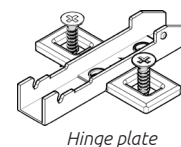
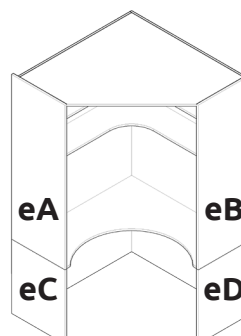

2250mm unit 1 Door HINGE POSITION

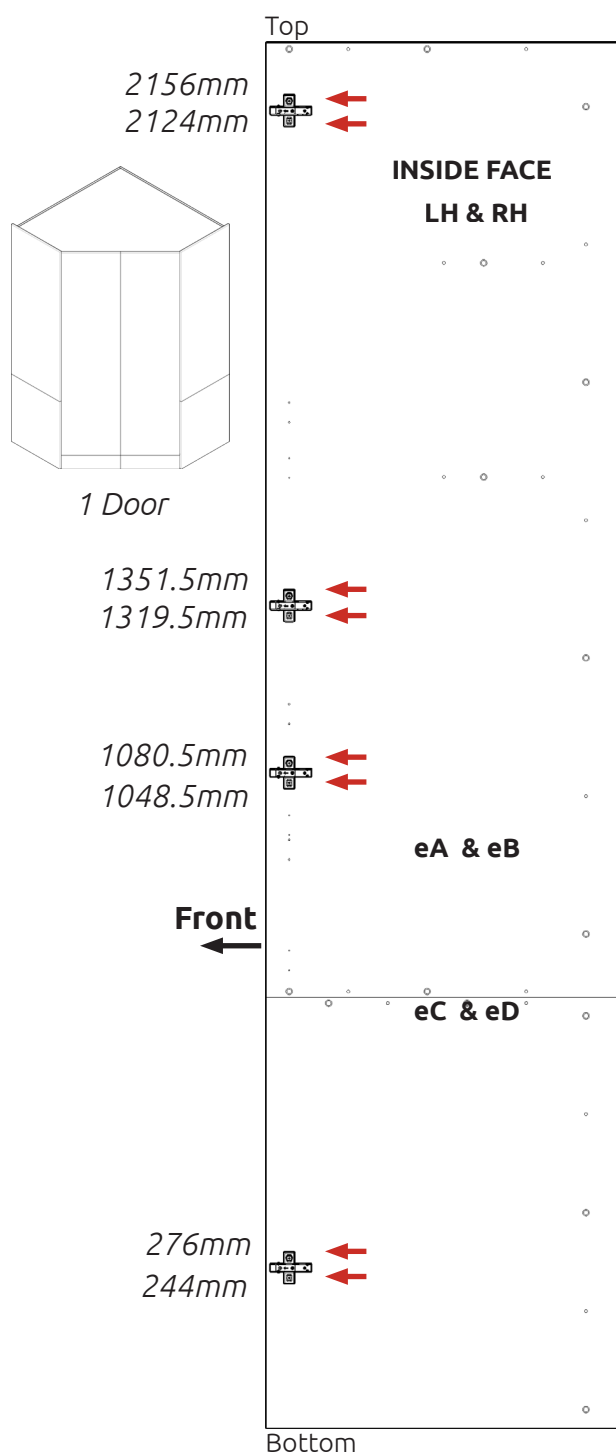

TOWER UNIT

2070 & 2250 Diagonal Corner Office Assembly Guide

Door Frontal Fixing (Where Applicable)

Grass Hinge

Doors supplied in accordance to customer specific kitchen plan

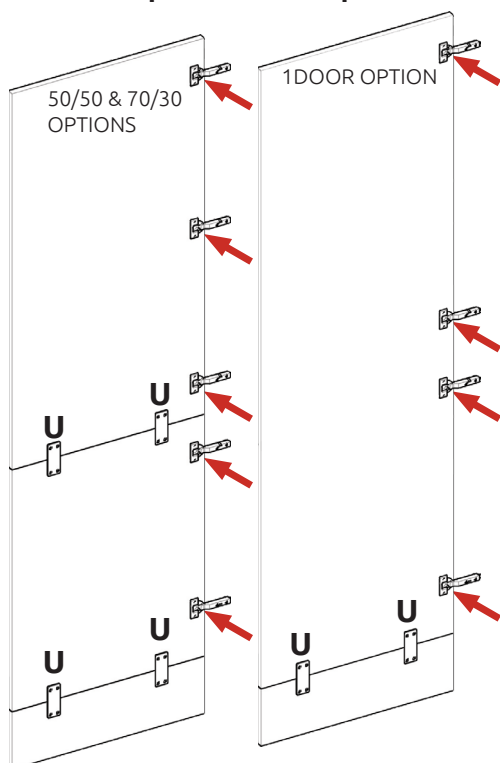

Step 1.

Insert hinges into hinge holes provided, in accordance with customer specific kitchen plan.

Step 2.

Secure hinges with the 2 x screws already located in the hinges.

Step 3. (Where applicable)

Align doors to join together using 2 x fixing plates to the back of both frontals. Ensure a 4mm gap is maintained between each frontal. Screw in place using 4 x 15mm screws per fixing plate.

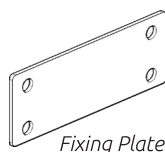

Fixing Plate

Step 4.

Attach the door to unit, clip hinge onto hinge plate and click to secure.

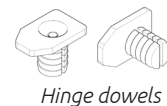

Hinge dowels

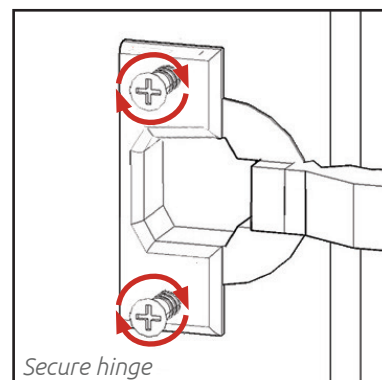

Secure hinge

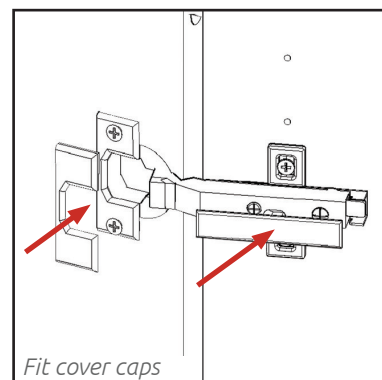

Fit cover caps

FRONTAL HINGE ADJUSTMENT

To **adjust** hinge using a screw driver, tighten or loosen as required at points **1** & **2**.
Point **1** - In - Out
Point **2** - Left - Right

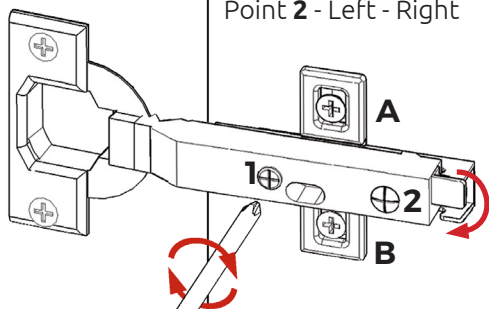

To **Move** the hinge up/down, loosen screws **A** + **B**, manoeuvre the door, then re-tighten the screws

To **Release** door pull catch as shown, to release hinge from the hinge plate.

View from Inside of Unit

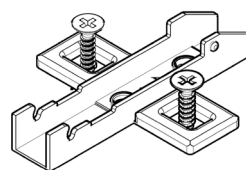

Hinge Plate

Step 5.

Adjust hinge to suit. As shown on the left.

Step 6.

Fit cover caps to hinge. Adjust soft-close to suit.

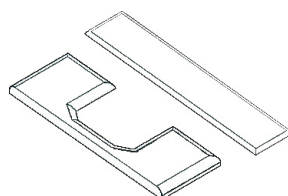

Hinge cover caps

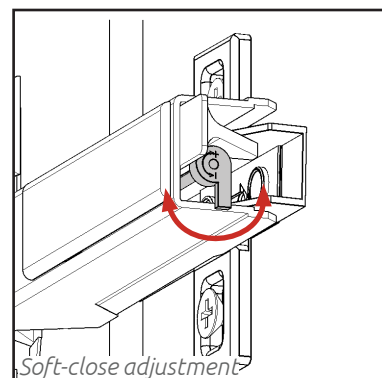

Soft-close adjustment

The top and bottom hinges **MUST** be adjusted to the **SAME STRENGTH**.

Door Frontal Fixing (Where Applicable)

Titus Hinge

Doors supplied in accordance to customer specific kitchen plan

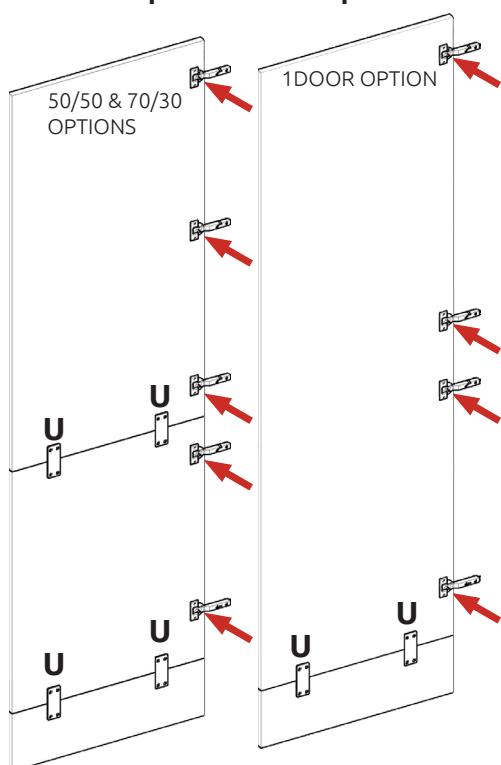

Step 1.

Insert hinges into hinge holes provided, in accordance with customer specific kitchen plan.

Step 2.

Secure hinges with the 2 x screws already located in the hinges.

Step 3. (Where applicable)

Align doors to join together using 2 x fixing plates to the back of both frontals. Ensure a 4mm gap is maintained between each frontal. Screw in place using 4 x 15mm screws per fixing plate.

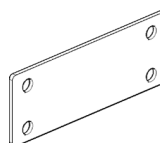

Step 5.

Attach the door to unit, clip hinge onto hinge plate and click to secure.



Hinge dowels

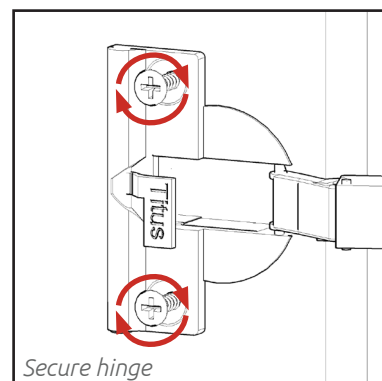

Secure hinge

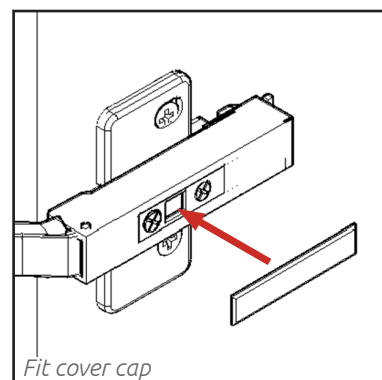

Fit cover cap

FRONTAL HINGE ADJUSTMENT

To **adjust** hinge using a screw driver, tighten or loosen as required at points **1 & 2**.
Point **1** - In - Out
Point **2** - Left - Right

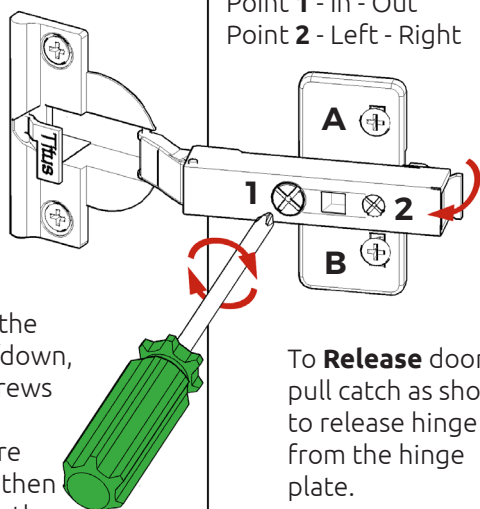

To **Move** the hinge up/down, loosen screws **A + B**, manoeuvre the door, then re-tighten the screws

To **Release** door pull catch as shown, to release hinge from the hinge plate.

View from Inside of Unit

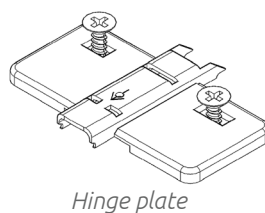

Hinge plate

Step 6.

Adjust hinge to suit. As shown on the left.

Step 7.

Fit cover cap to hinge. Adjust softclose to suit.

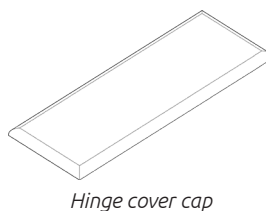

Hinge cover cap

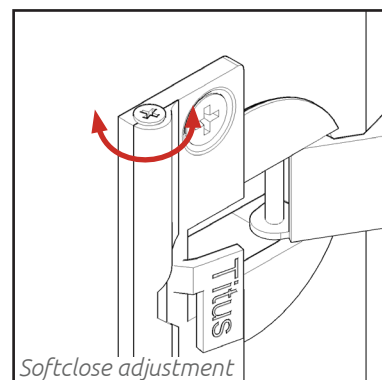

Softclose adjustment

The top and bottom hinges **MUST** be adjusted to the **SAME STRENGTH**.

