

**2070 - 2250**

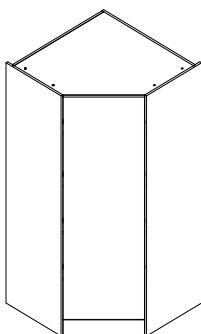

*1 Door*

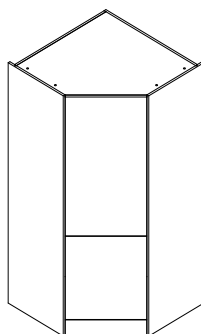

*70/30 Door*

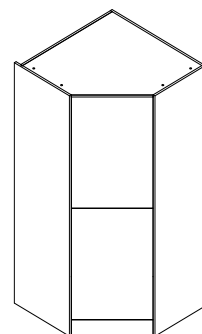

*50/50 Door*



### BEFORE YOU START

INSTALLATION SHOULD BE PERFORMED BY A COMPETENT PERSON ONLY.

THIS PRODUCT COULD BE DANGEROUS IF INCORRECTLY INSTALLED



Screws and fixings for attaching to walls are not provided as these vary depending on materials and construction. Ensure appropriate fixings for wall are used.

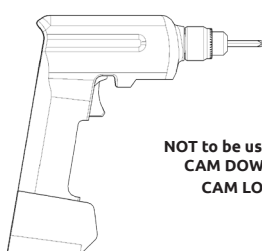
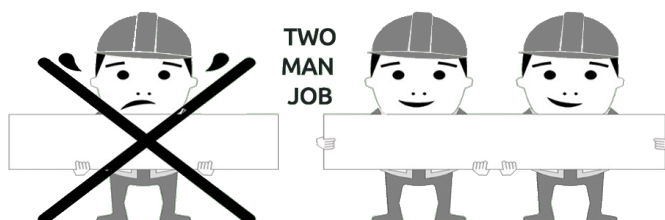

NOT to be used with  
CAM DOWEL &  
CAM LOCK

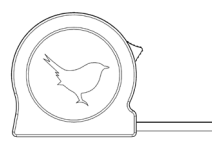
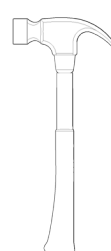

2070 & 2250 Walk In Tower Assembly Guide

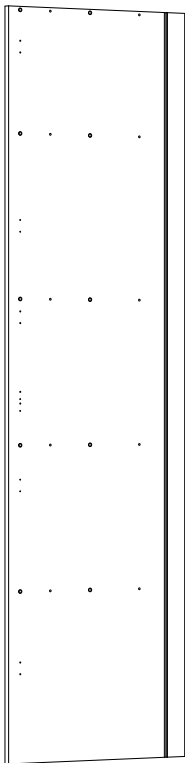

Panel A  
x1 End Panel  
Left Hand

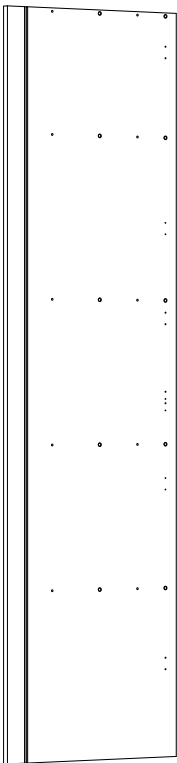

Panel B  
x1 End Panel  
Right Hand

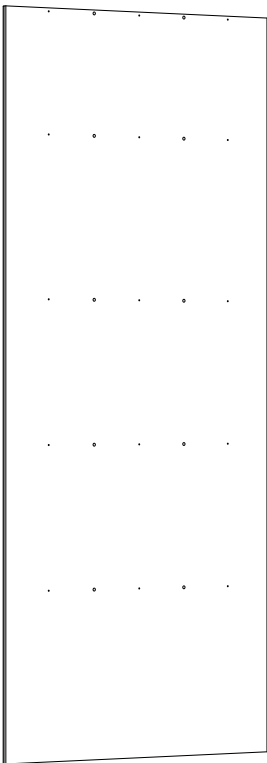

Panel C  
x1 Back Panel  
Left Hand

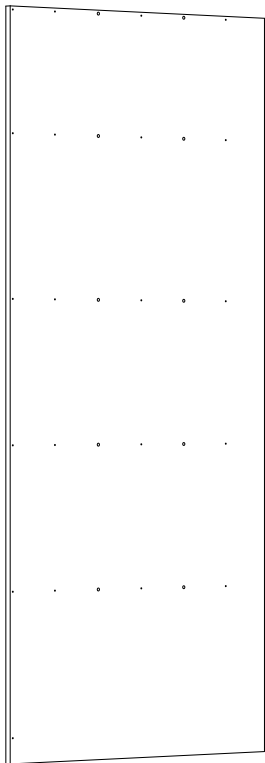

Panel D  
x1 Back Panel  
Right Hand

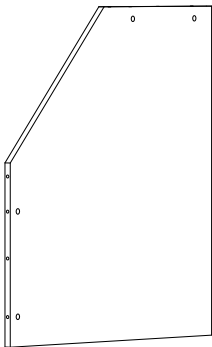

Panel sE  
x1 Top Panel

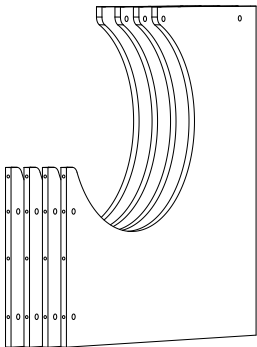

Panel sM  
x4 Fixed Shelf

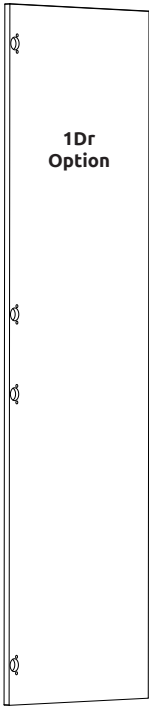
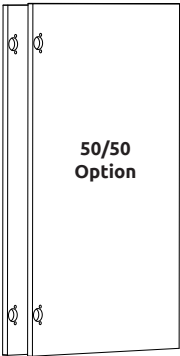
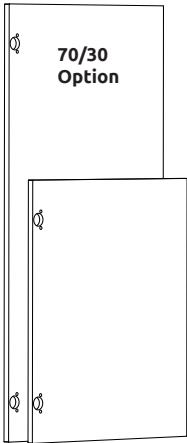

Frontals  
70/30, 50/50 or 1Dr  
(Frontals and Plinth Packed Separately)

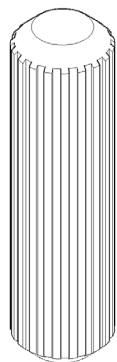

**(F) x40**  
Wooden Dowel

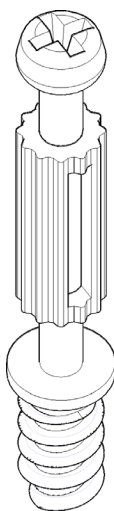

**(W) x20**  
Cam Dowel

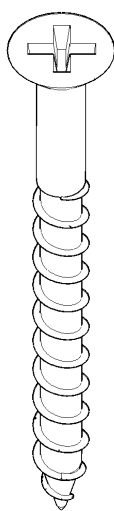

**(K) x36**  
45mm Screws

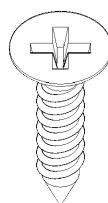

**(L) x12**  
15mm Screws

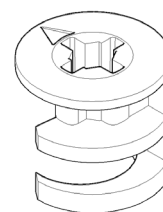

**(H) x20**  
Cam Lock

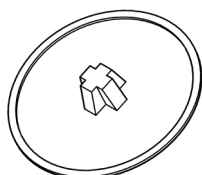

**(M) x8**  
Cover Cap

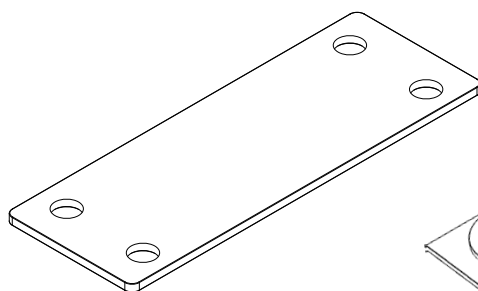

**Fixing Plate (U)**  
x4

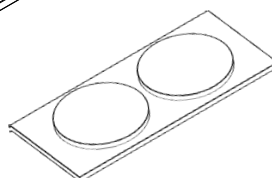

**Door Buffer**  
x1

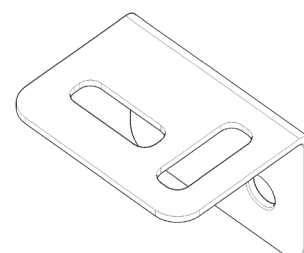

**L Bracket LGE**  
x4

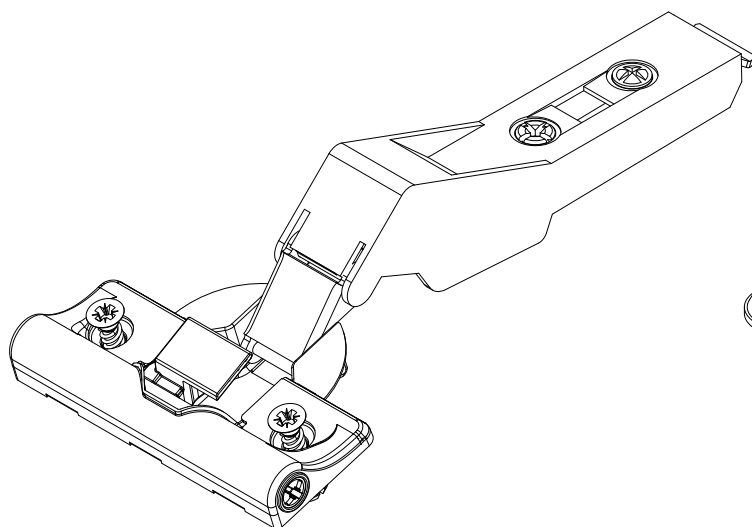

**Hinge**  
Inc Screws

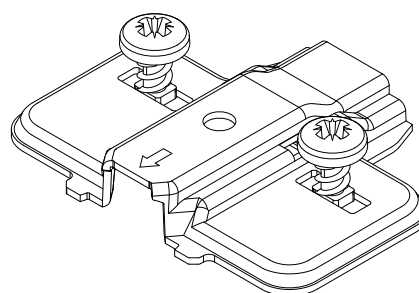

**Hinge Mounting Plate**  
Inc Screws

### Step 1.

Seat cam dowel **(w)** into holes in end panel **(A)** as shown.

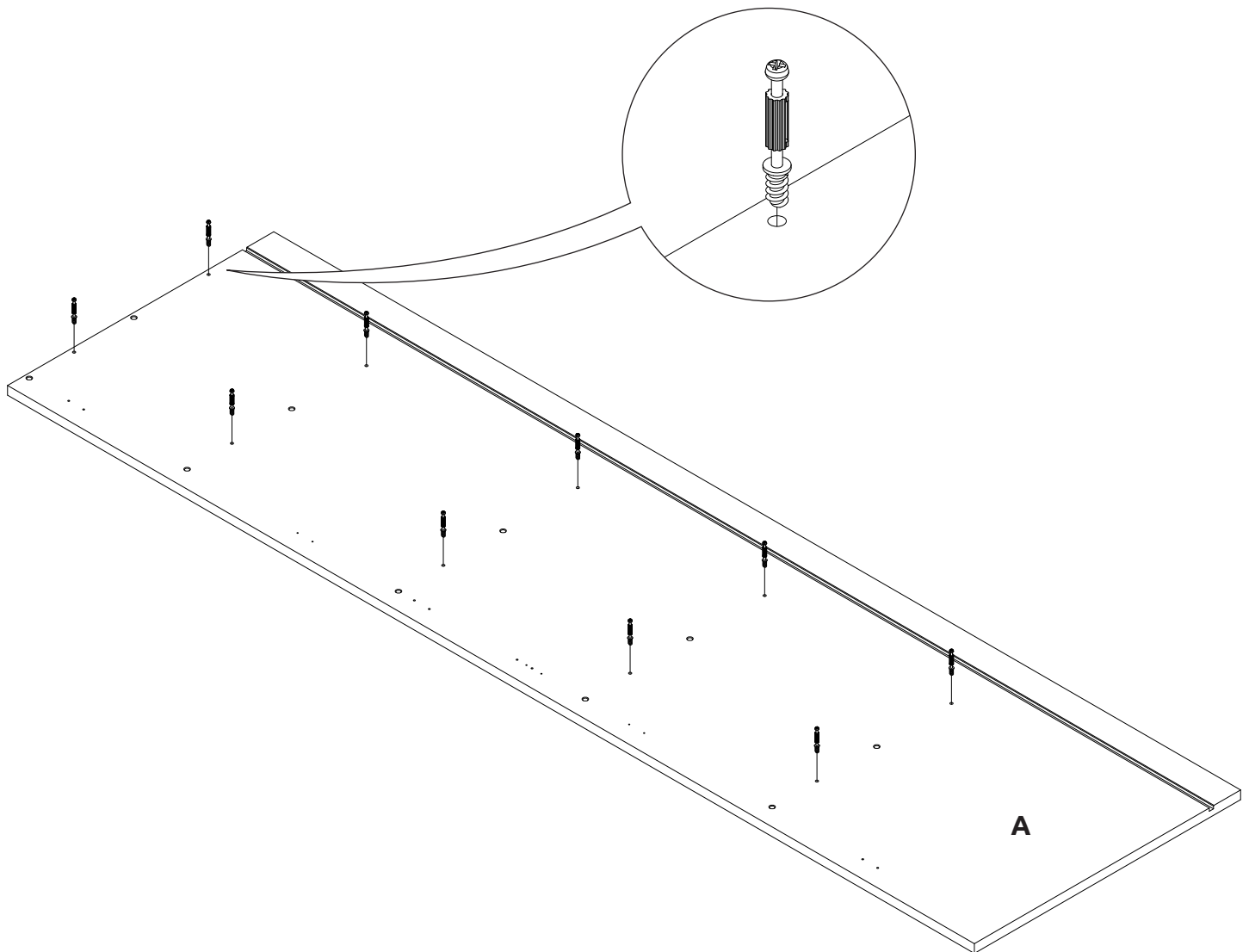
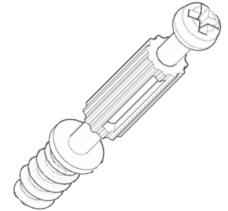

### Step 2.

Seat dowel **(F)** into holes in end panel **(A)** as shown.

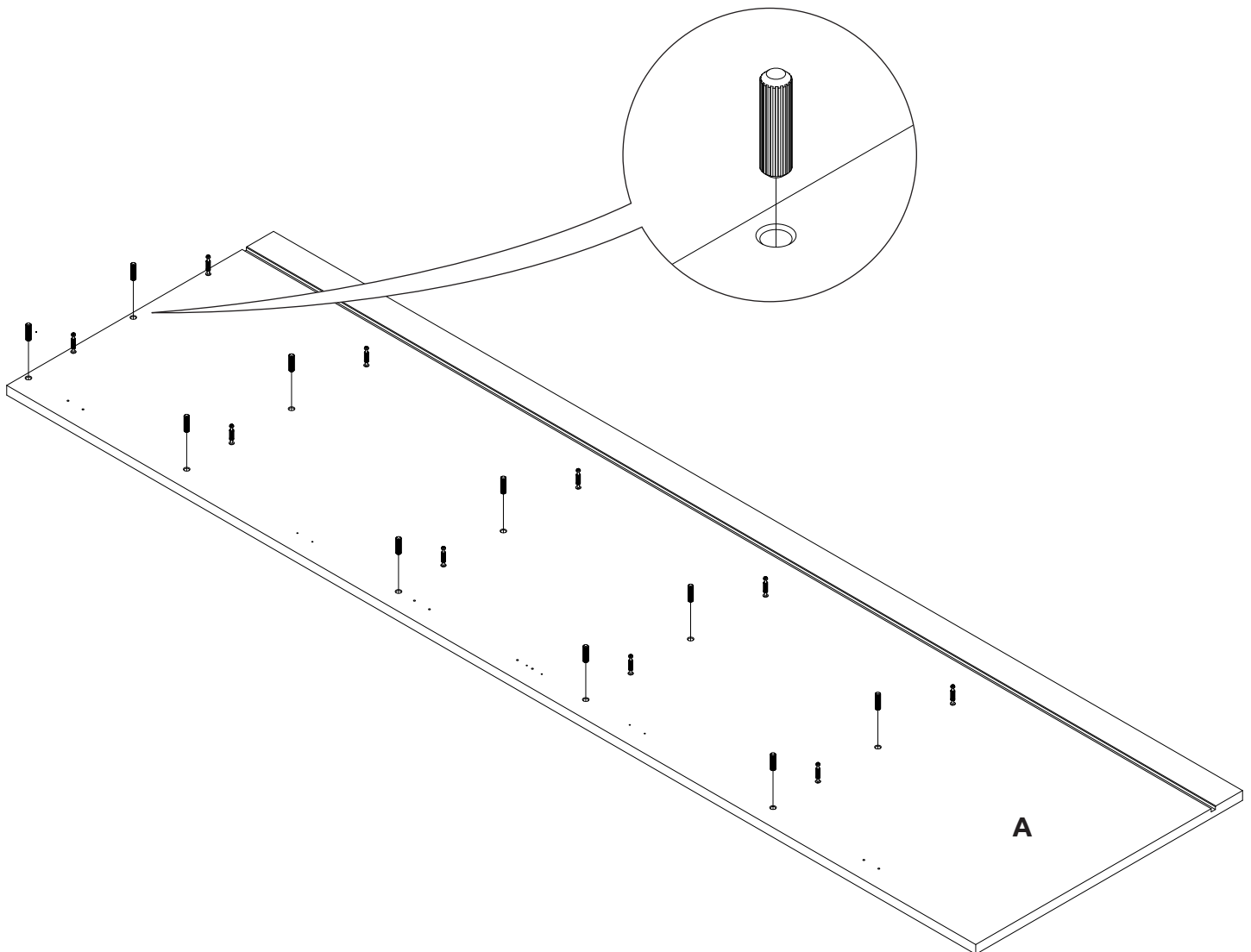
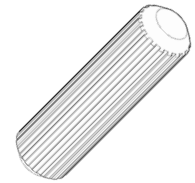

## 2070 & 2250 Walk In Tower Assembly Guide

### Step 3.

Attach panels (**sM**) and (**sE**) to end panel (**A**), using cam dowel (**W**) and dowels (**F**) in positions as shown. Panel (**sE**) cam holes to face the outside of the unit. Panels (**sM**) cam holes to face downwards.

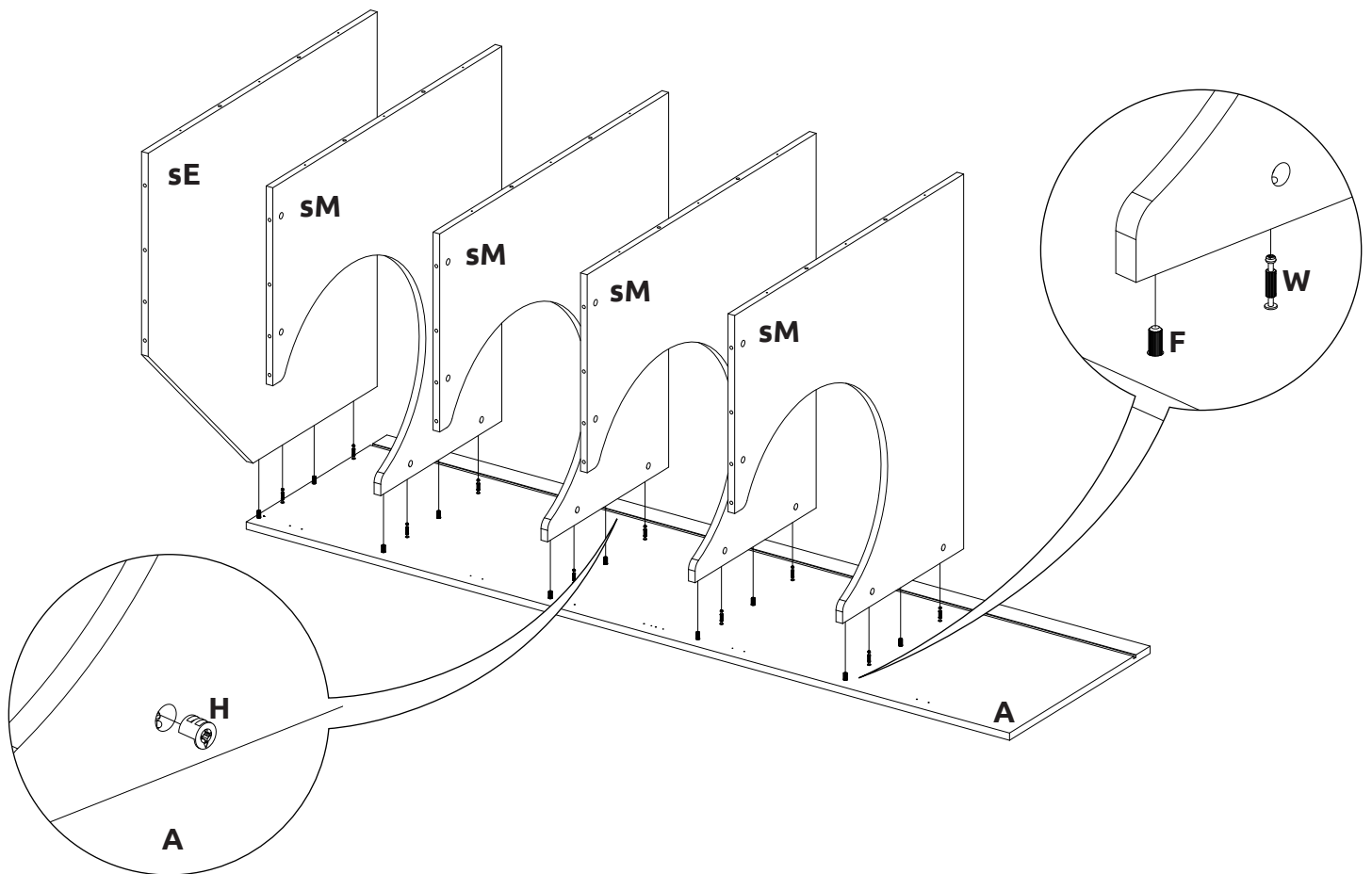

### Step 4.

Insert cam locks (**H**). **Do NOT** tighten until Step 7.

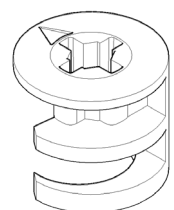

### Step 5.

Seat 20 x dowels **(F)** into holes in panels **(sM)** and **(sE)** as shown.

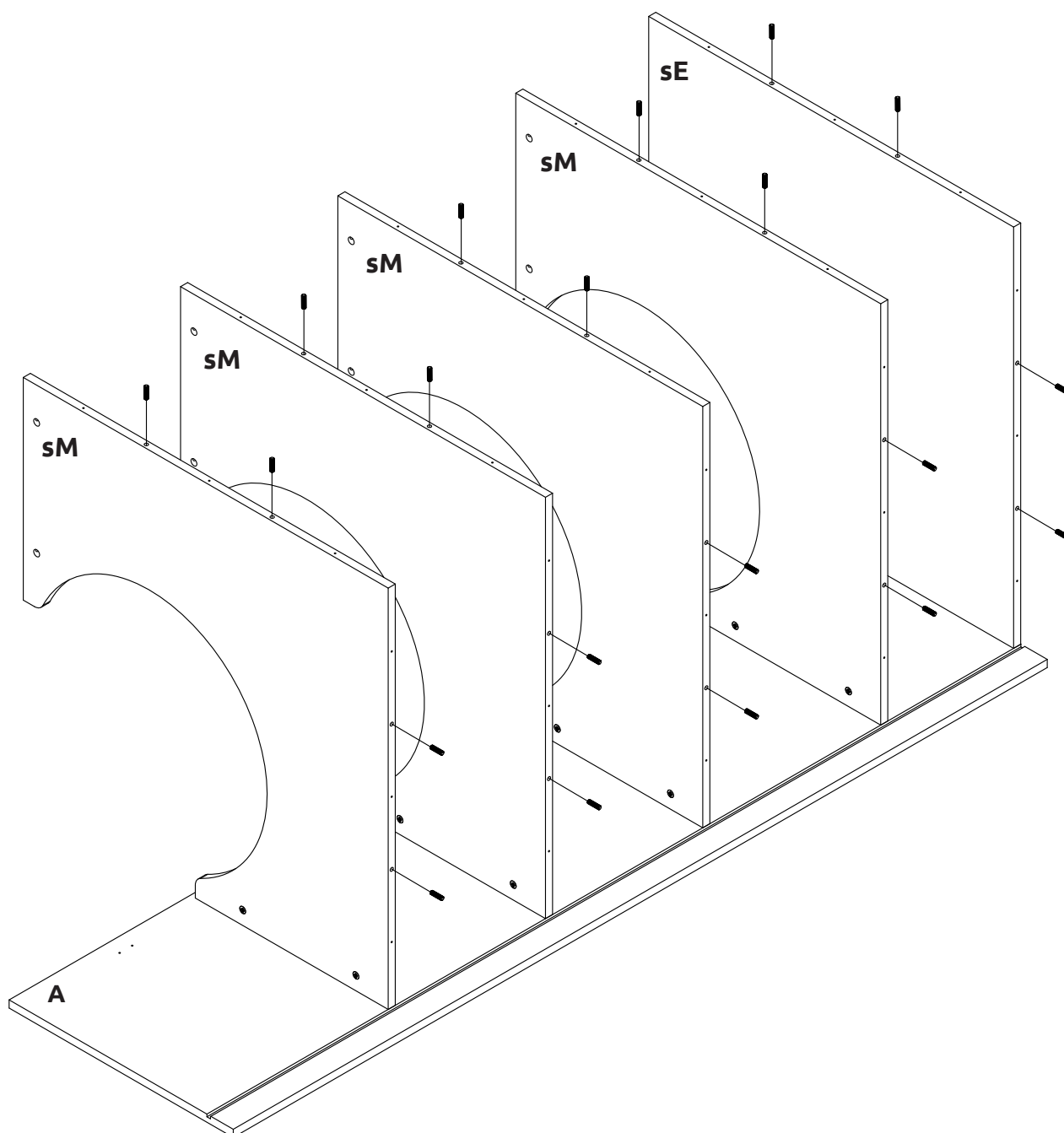



### Step 6.

Slide back panel (C) into groove of end panel (A). Also insert dowels (F) from panels (sM) and (sE) into the required holes in back panel (C).

Once back panel (C) is in position, ensure the panel is flush & square with bottom of end panel (A) and secure in place with 15 x 45mm screws (K) through panel (C) into panels (sM) and (sE).

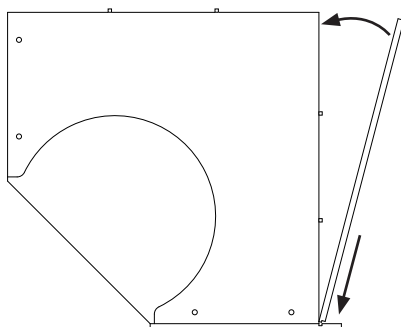

*View from underside*

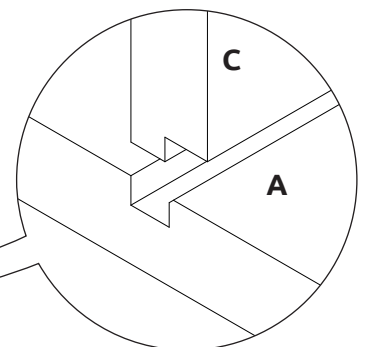
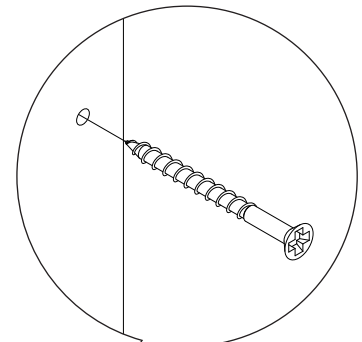
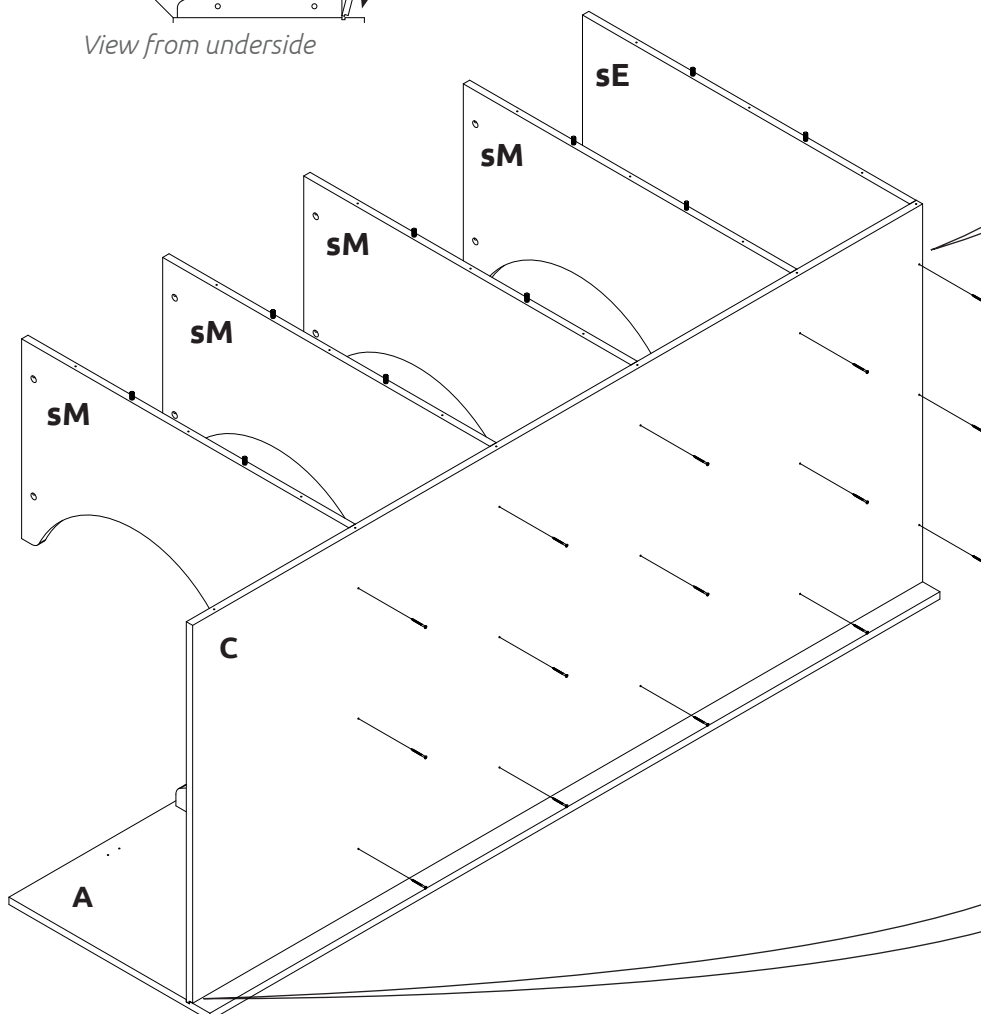

### Step 7.

Hand tighten all cam locks **(H)**, this will expand cam dowels **(W)** and tighten the unit together.

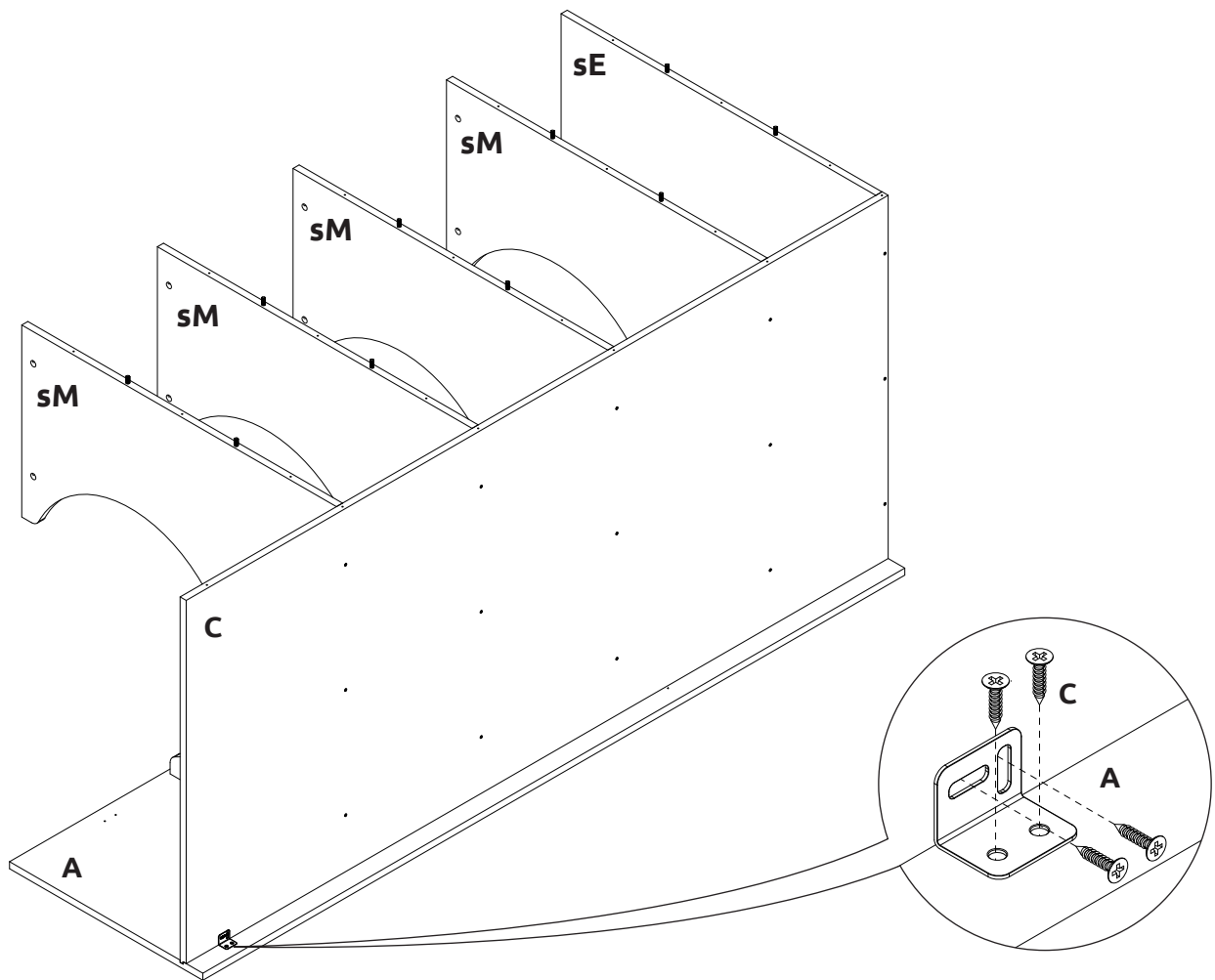
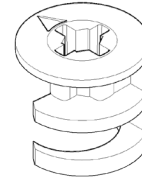

### Step 8.

Secure back panel **(C)** to end panel **(A)** at the bottom using 1 x L bracket LGE as shown. Secure the L Bracket LGE in place with 4 x 15mm screws **(L)**.

### Step 9.

Seat cam dowel **(W)** into holes in end panel **(B)** as shown.

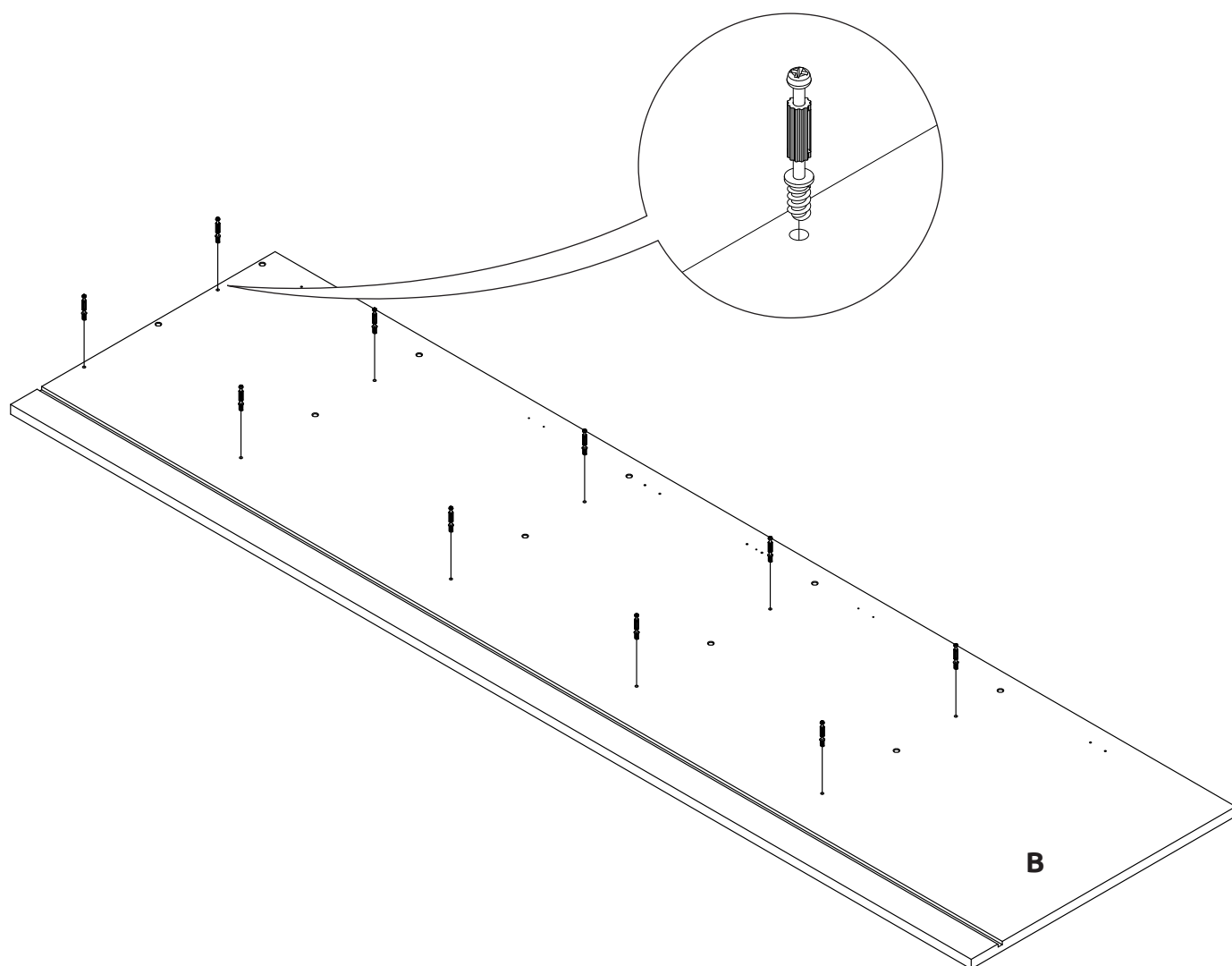
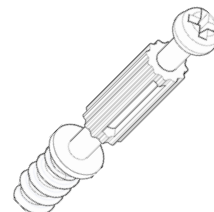

**Step 10.**

Seat dowel **(F)** into holes in end panel **(B)** as shown.

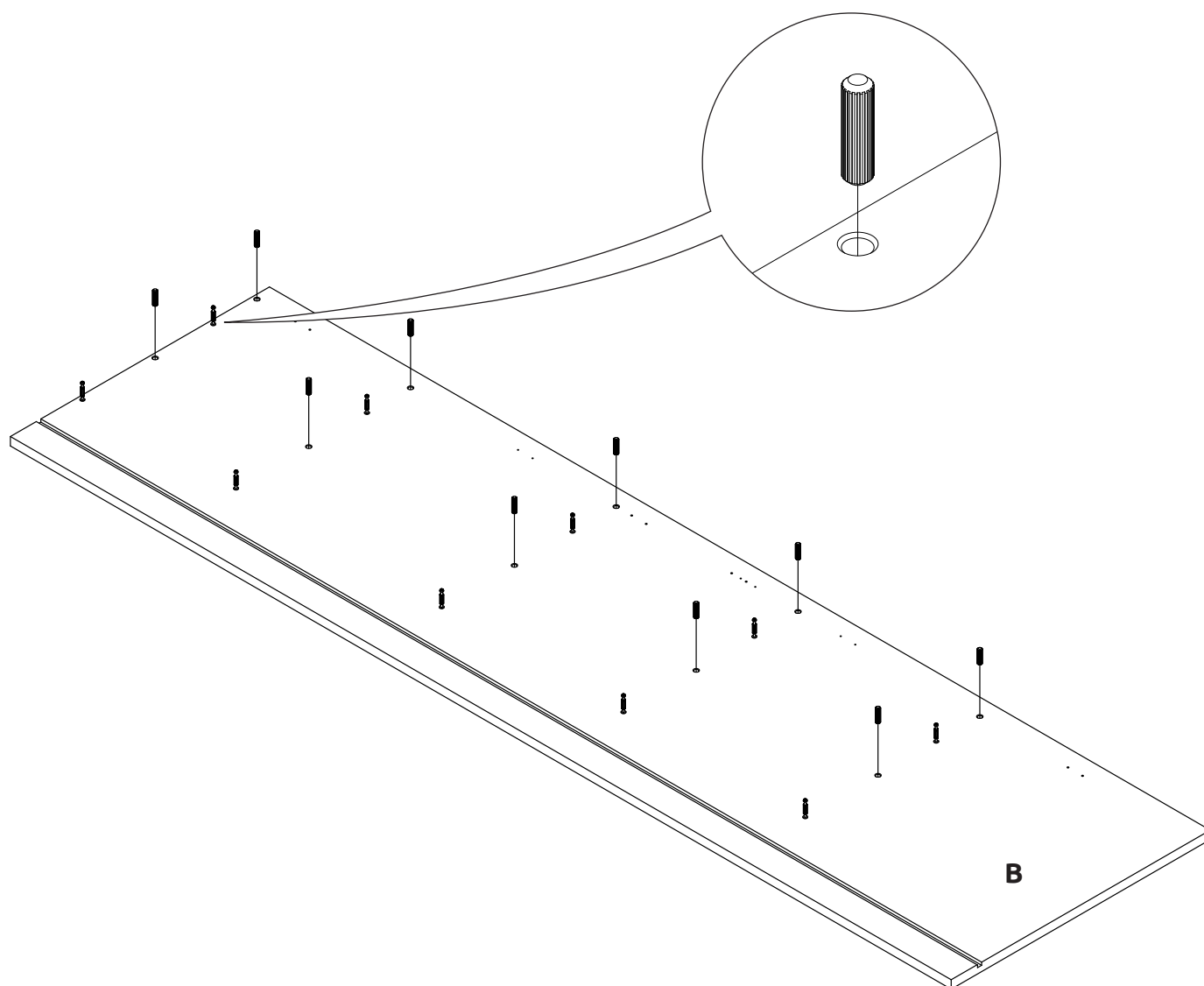

### Step 11.

Attach end panel **(B)** to panels **(sM)** and **(sE)** using cam dowel **(W)** and dowels **(F)** in positions as shown.

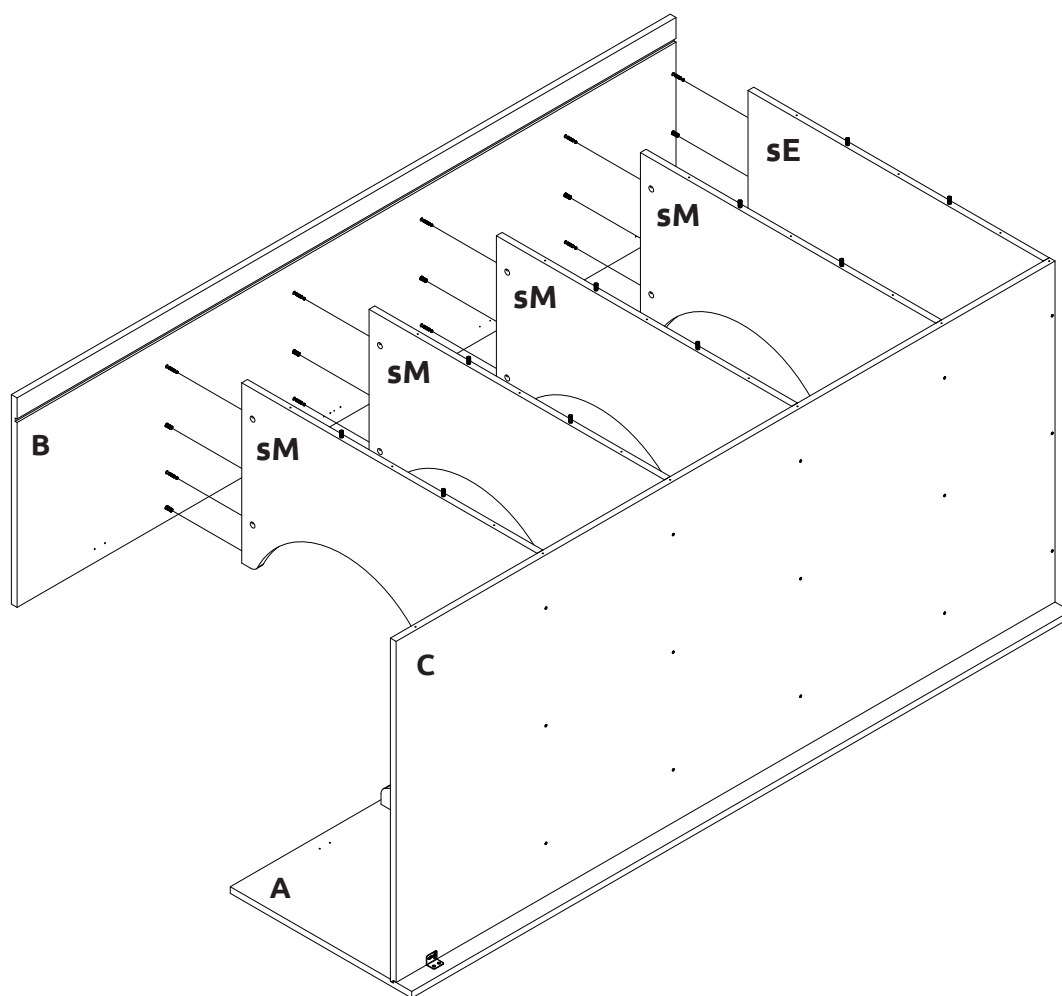

### Step 12.

Insert cam locks **(H)**. **Do NOT** tighten until Step 17.

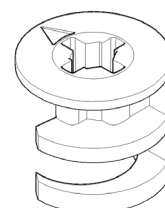

### Step 13.

Slide back panel **(D)** into groove of end panel **(B)**. Also insert dowels **(F)** from panels **(sM)** and **(sE)** into the required holes in back panel **(D)**.

Once back panel **(D)** is in position, ensure the panel is flush & square with bottom of end panel **(B)** and secure in place with 21 x 45mm screws **(K)** through panel **(D)** into panels **(sM)** and **(sE)**.

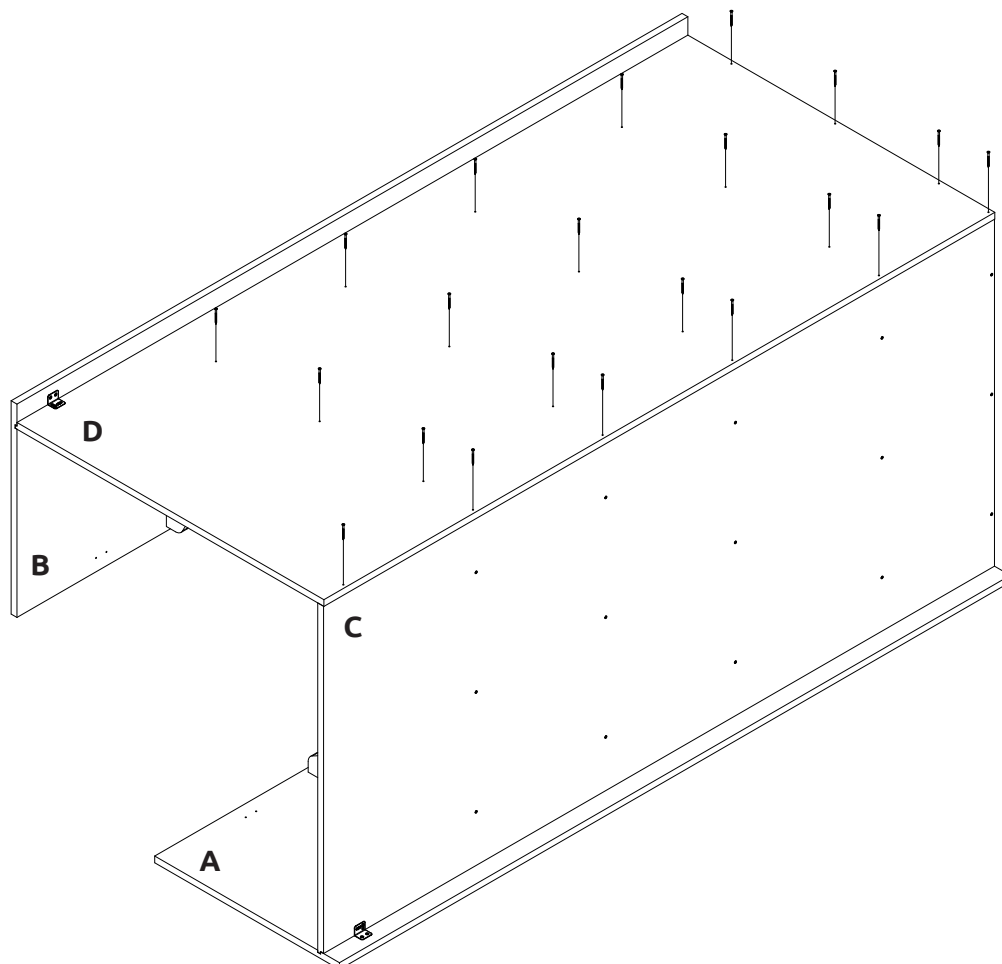
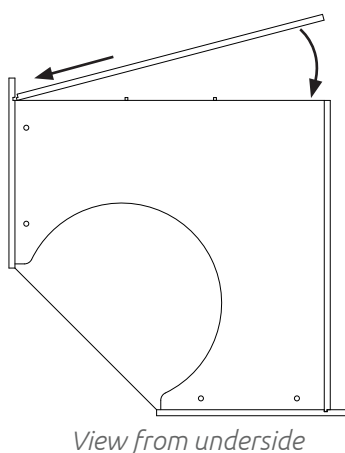
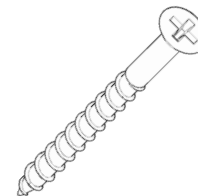

### Step 14.

Secure back panel **(D)** to end panel **(B)** at the bottom using 1 x L bracket LGE as shown. Secure the L Bracket LGE in place with 4 x 15mm screws **(L)**.

## 2070 & 2250 Walk In Tower Assembly Guide

### Step 15.

Hand tighten all cam locks **(H)**, this will expand cam dowels **(W)** and tighten the unit together.

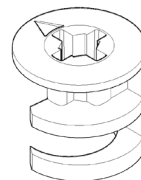

### Step 15.

Ensure that the tower is positioned correctly and level. Secure the tower to the wall using 2 x L brackets LGE. Use 2 x 15mm screws **(L)** provided to secure each of the L brackets LGE to the top, rear of the unit at either side. Then screw through the bracket into the wall using an appropriately size screw as shown.

**Screws not provided.**

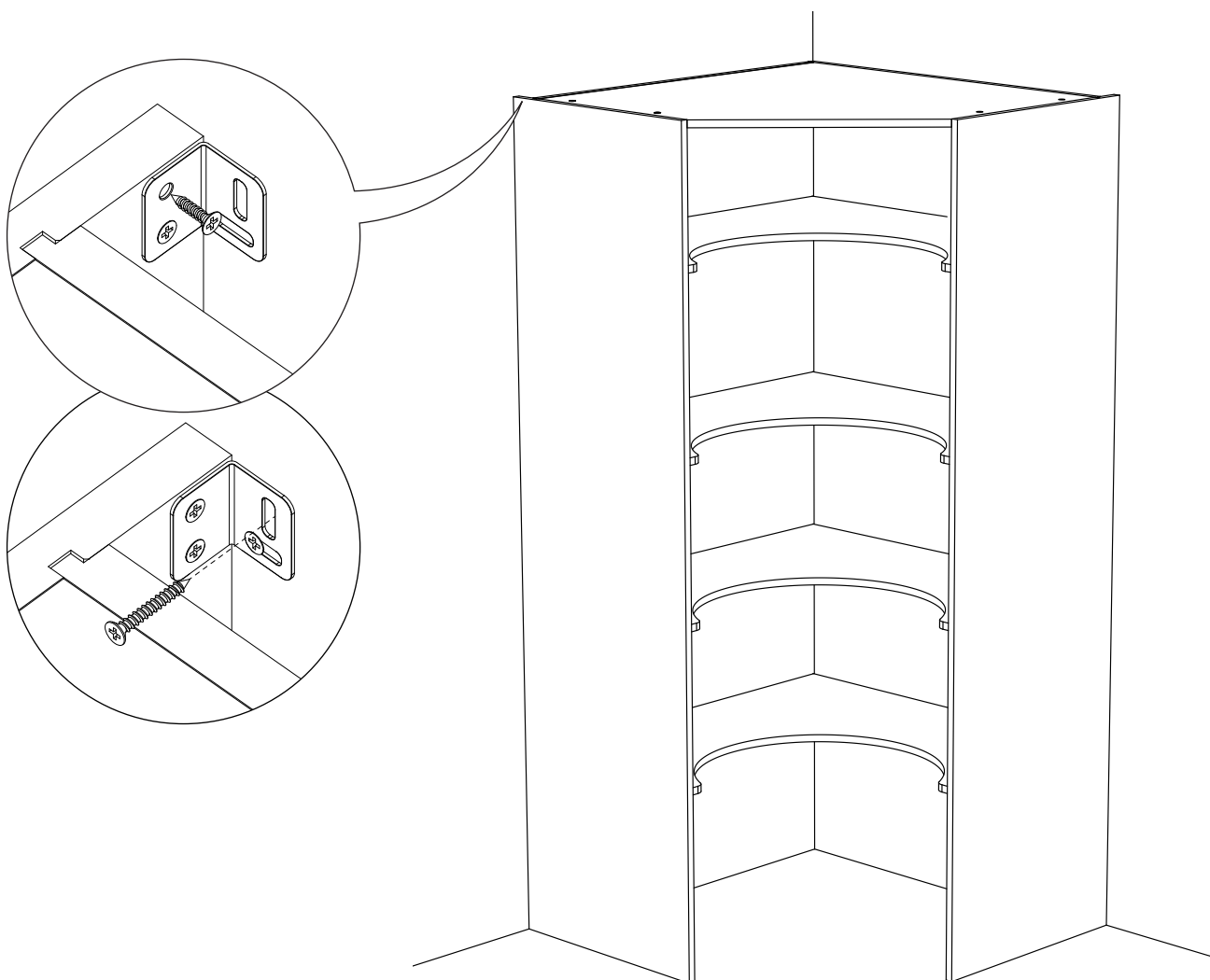

## 2070 & 2250 Walk In Tower Assembly Guide

### 2070

#### Step 19.

Attach hinge plates onto end panel **(A)** or **(B)** to suit as shown using screws already positioned within the hinge plate. **Hinge side or sides to be mounted in accordance to Customer Specific Kitchen Plan.**

2070 - 70/30  
HINGE POSITION

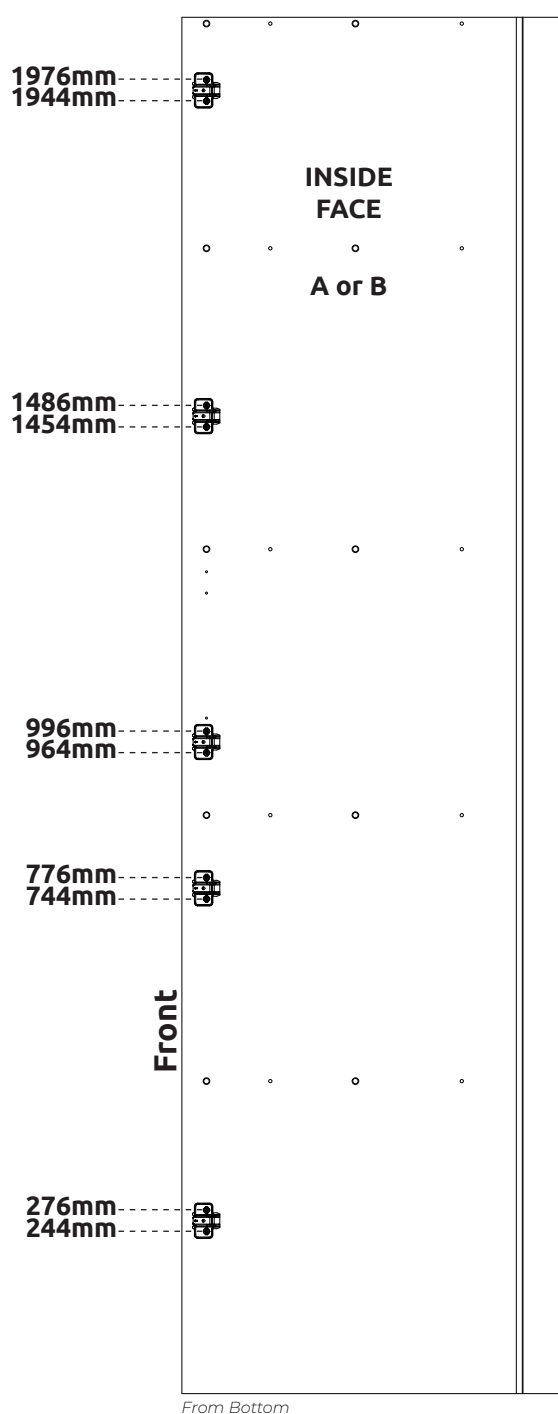

From Bottom

2070 - 50/50 & 1 Dr  
HINGE POSITION

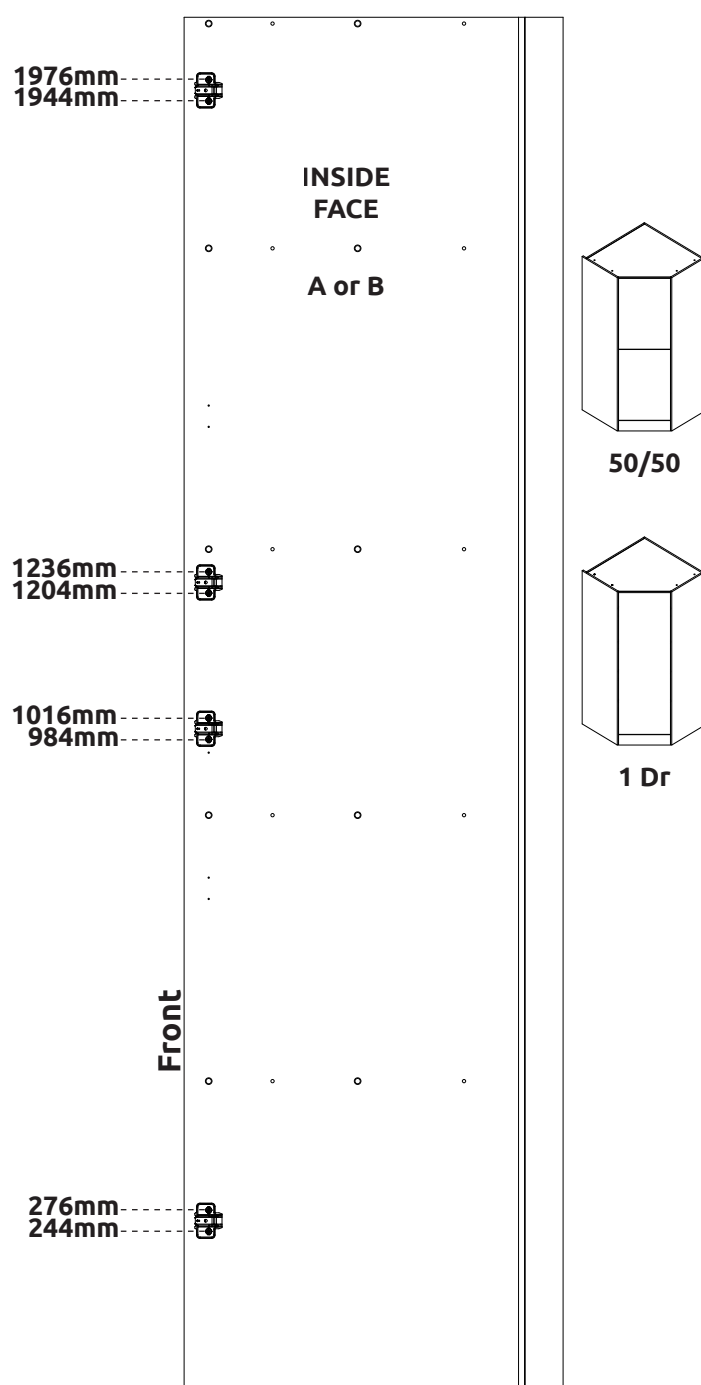

From Bottom



## 2070 & 2250 Walk In Tower Assembly Guide

### 2250

#### Step 19.

Attach hinge plates onto end panel (A) or (B) to suit as shown using screws already positioned within the hinge plate. **Hinge side or sides to be mounted in accordance to Customer Specific Kitchen Plan.**

#### 2250 - 70/30 HINGE POSITION

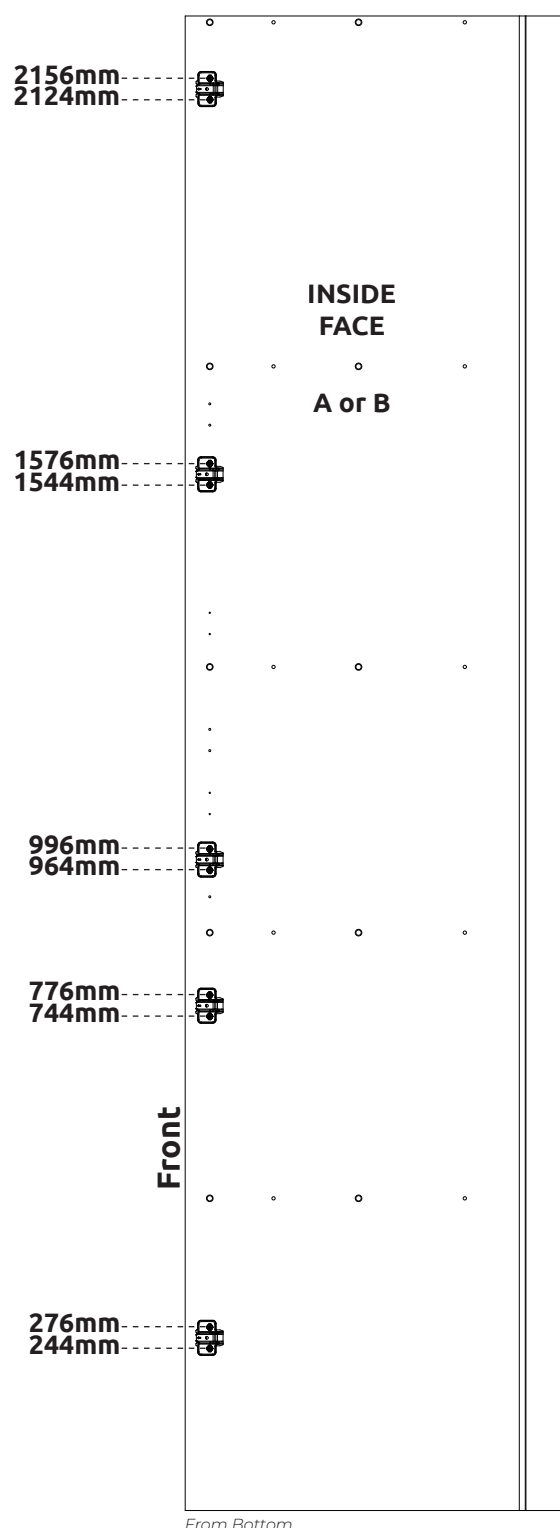

From Bottom

#### 2250 - 50/50 HINGE POSITION

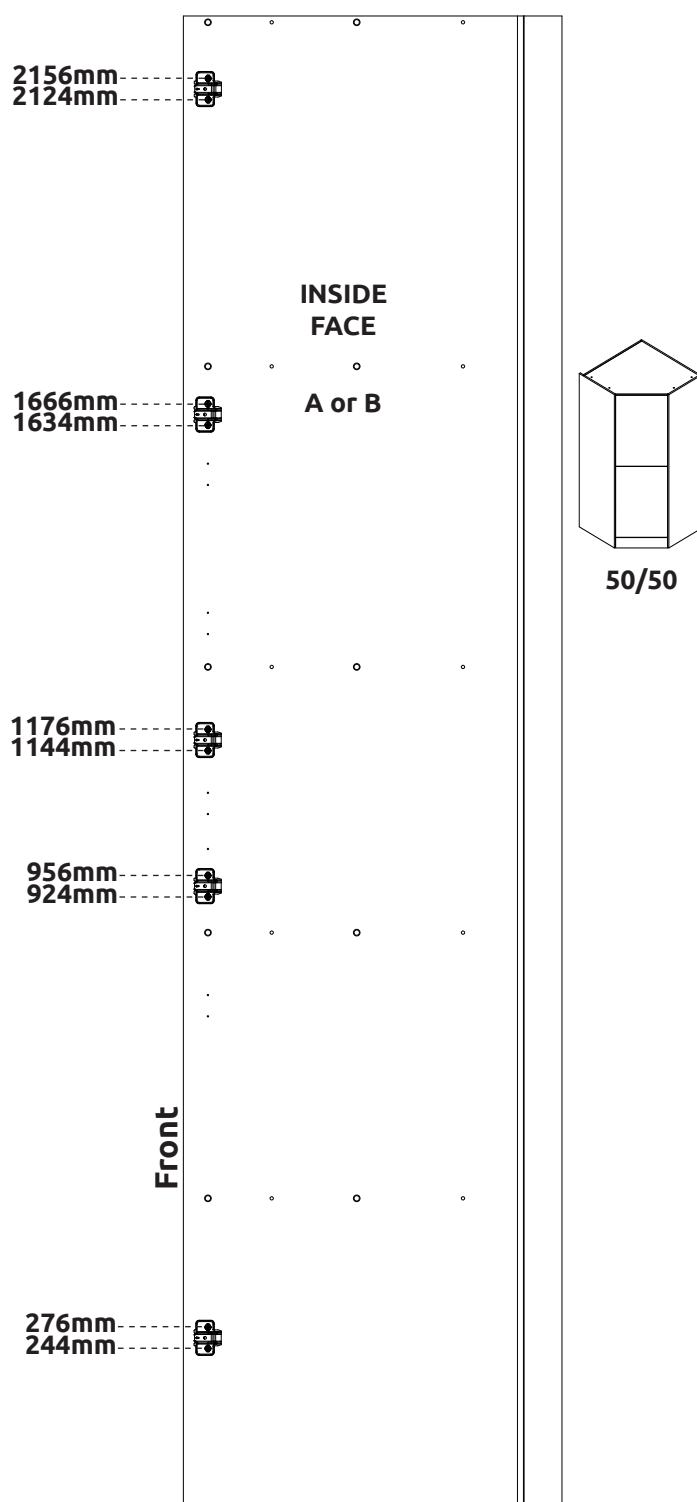

From Bottom

## 2070 & 2250 Walk In Tower Assembly Guide

### 2250

#### Step 19.

Attach hinge plates onto end panel (A) or (B) to suit as shown using screws already positioned within the hinge plate. **Hinge side or sides to be mounted in accordance to Customer Specific Kitchen Plan.**

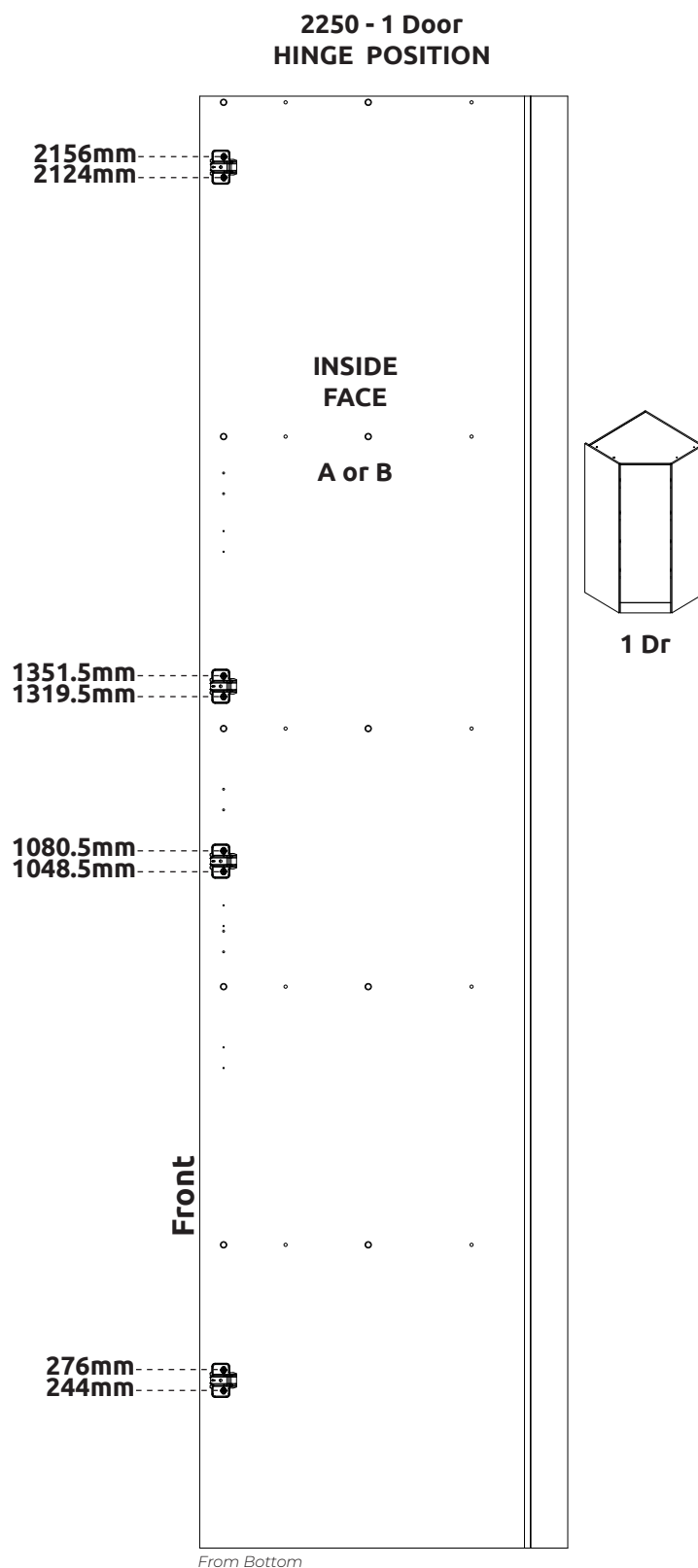

### Hinge Attachment and Adjustment

Doors supplied in accordance to customer specific kitchen plan

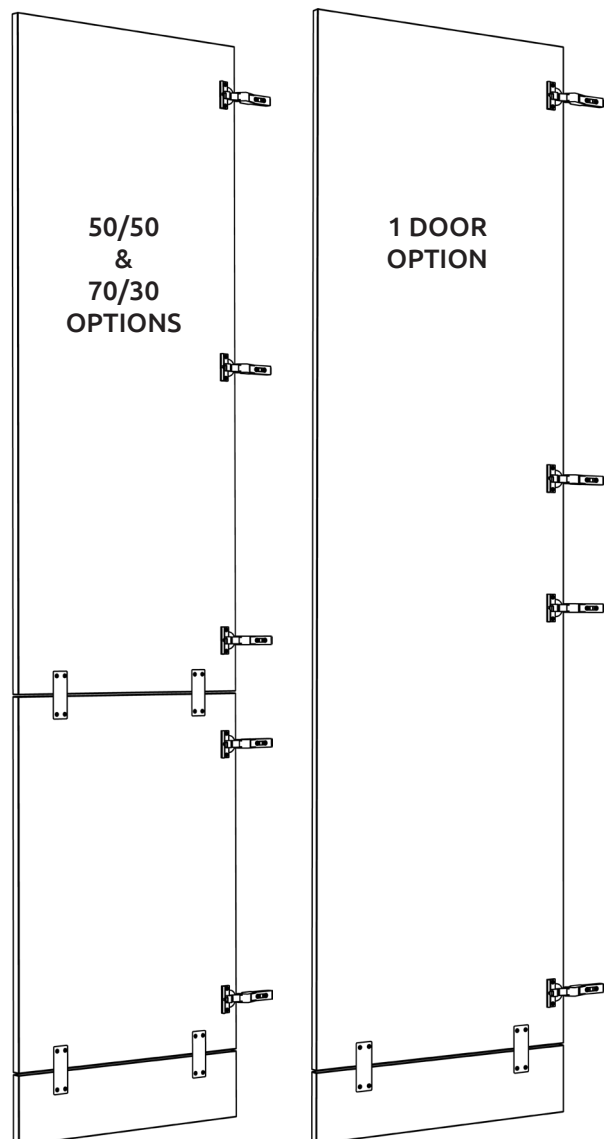

#### Step 1.

Insert hinges into frontal hinge holes provided, secure hinges with the 2 x screws and hinge dowels already located in the hinges.

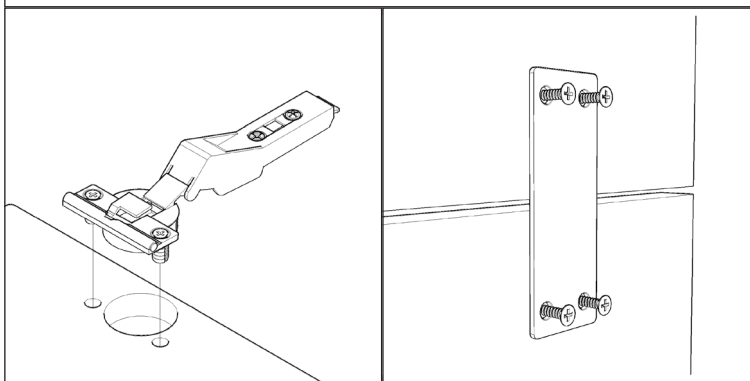

#### Step 2. (Where applicable)

Align frontals and join together using 2 x fixing plates to the back of both frontals. Ensure a 4mm gap is maintained between each frontal. Screw in place using 4 x 15mm screws (L) per fixing plate.

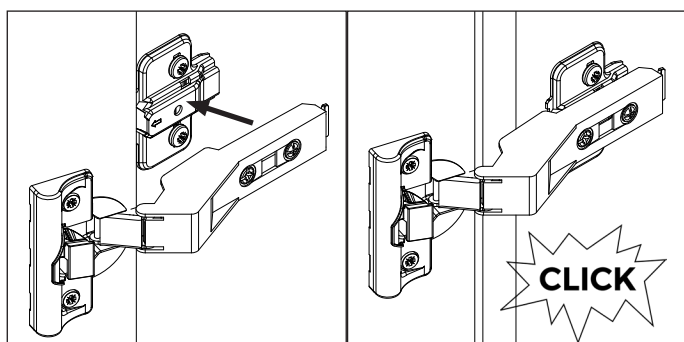
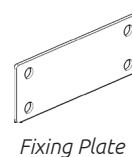

#### Step 3.

Attach the door to unit, clip hinges onto hinge plates and click to secure.

### Step 4.

Adjust hinges to suit, using the highlighted screws shown.

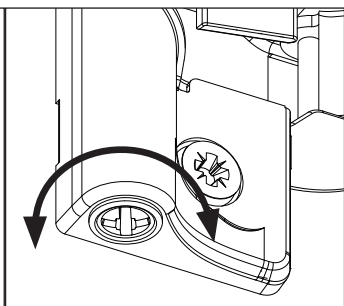
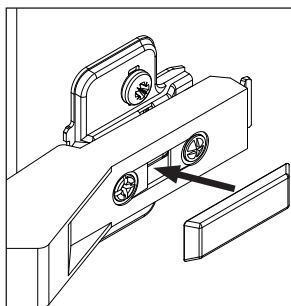
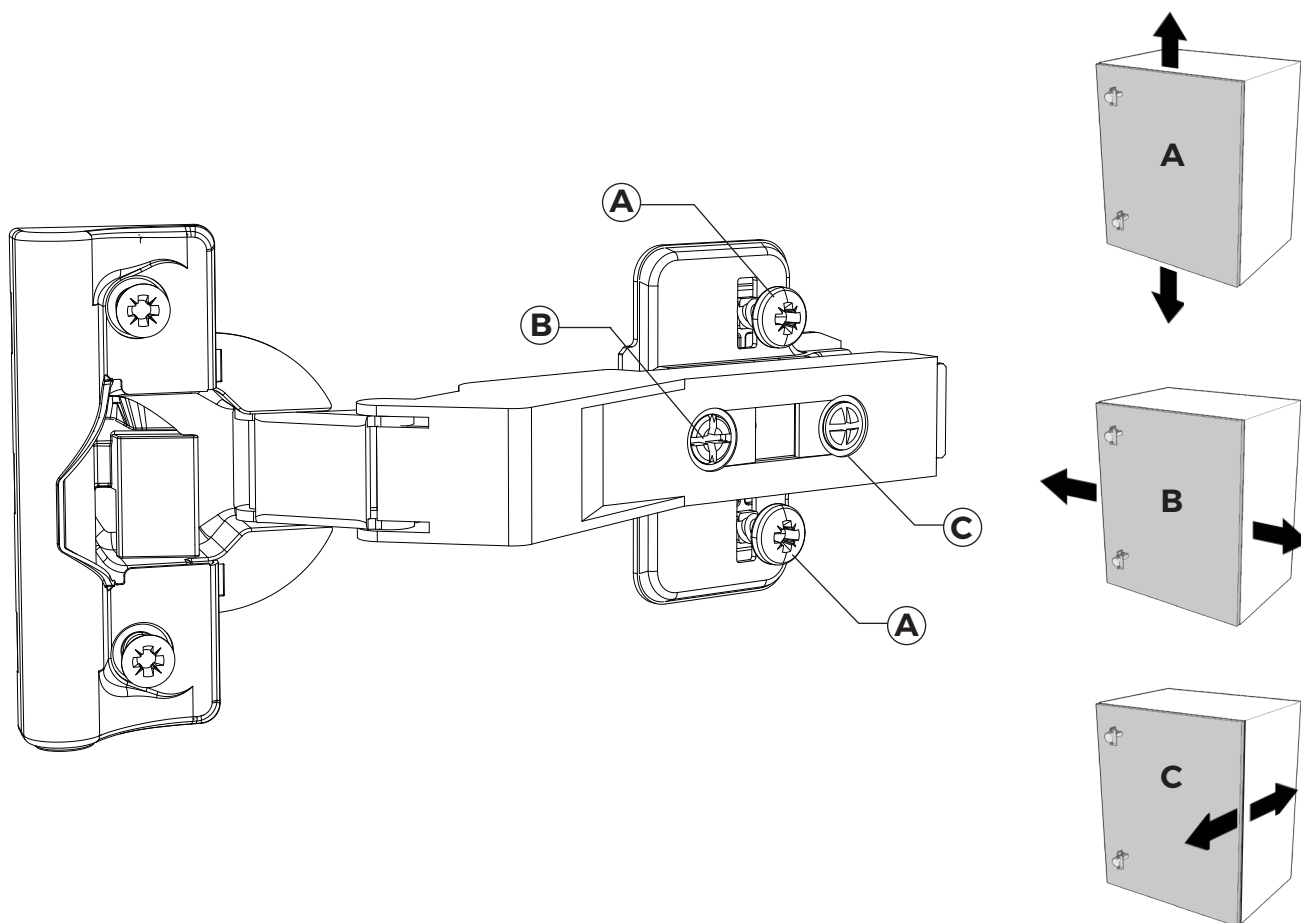

### Step 5.

Fit cover caps to hinges and adjust soft-close to suit.



The top and bottom hinges **MUST** be adjusted to the **SAME STRENGTH**.