

### Step 1.

Discard original hinge dowels and replace with new ones provided. Insert hinges into frontal hinge holes provided, secure hinges with the 2 x screws already located in the hinges.

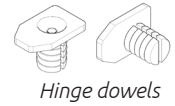

Hinge dowels

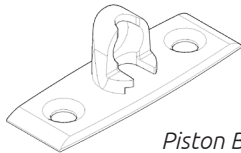

Piston Bracket

### Step 2.

Secure piston brackets with 2 x 15mm screws into position as shown, using pilot holes on the frontal as a guide.

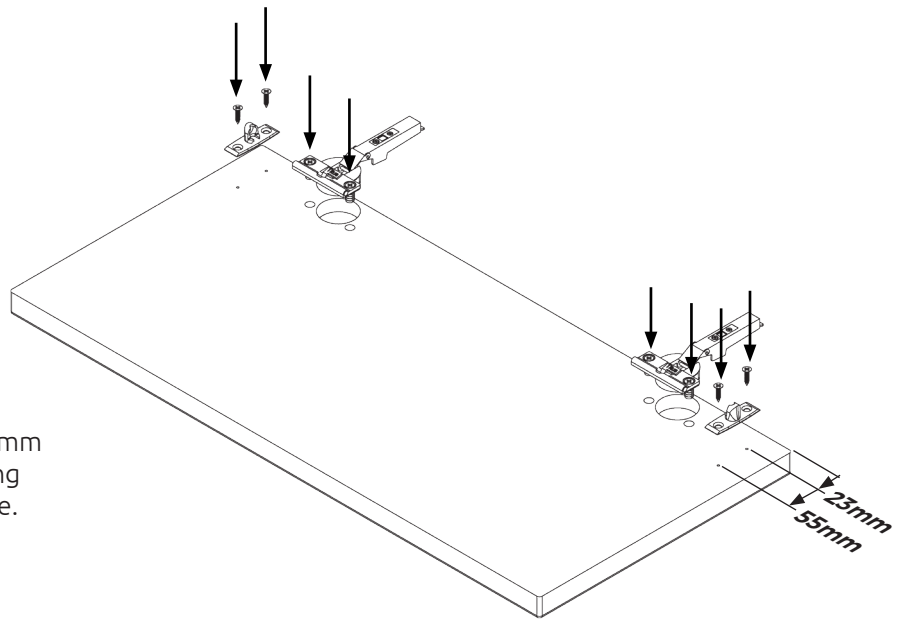

### Step 3.

Clip hinges onto hinge mounting plates on the unit and click to secure.

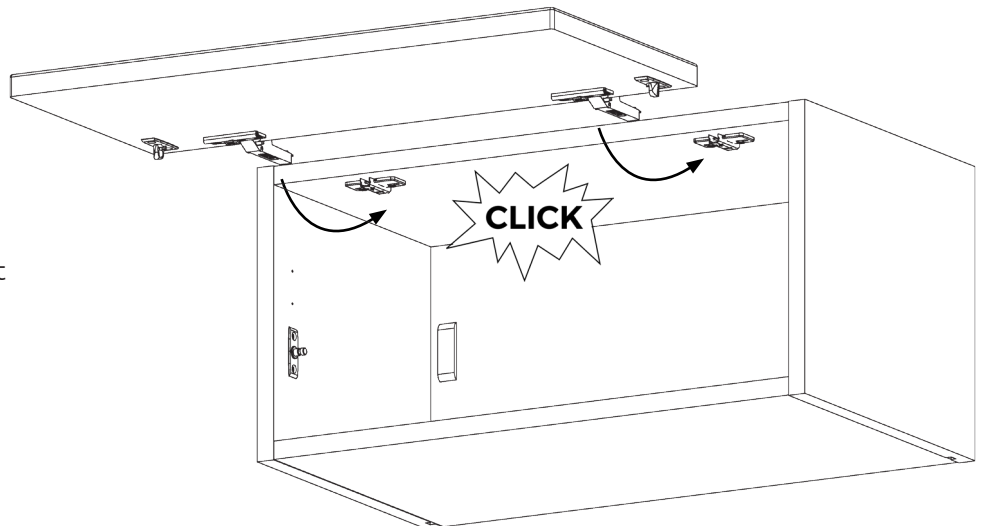

## 284 Bridging Replacement Frontal Guide

### Step 4.

Adjust hinges to suit, using the highlighted screw(s) shown.

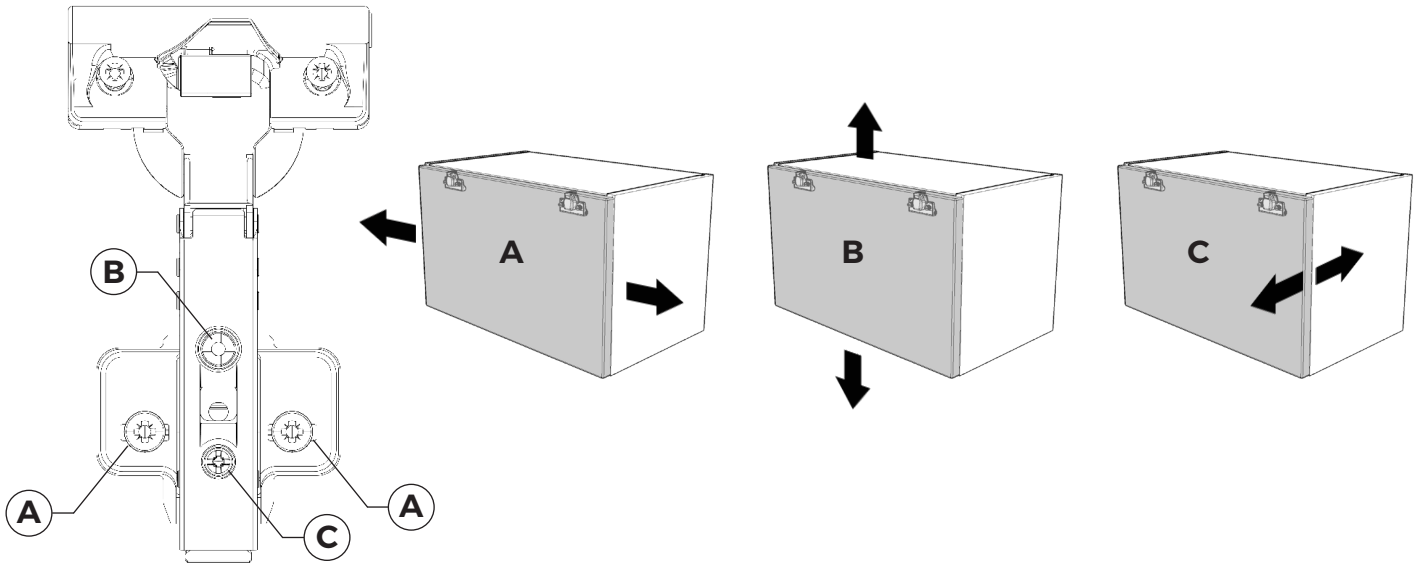

### Step 5.

Clip piston onto piston mounting plates on the unit and frontal.

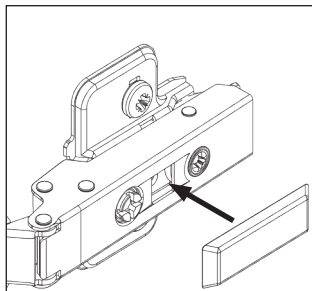
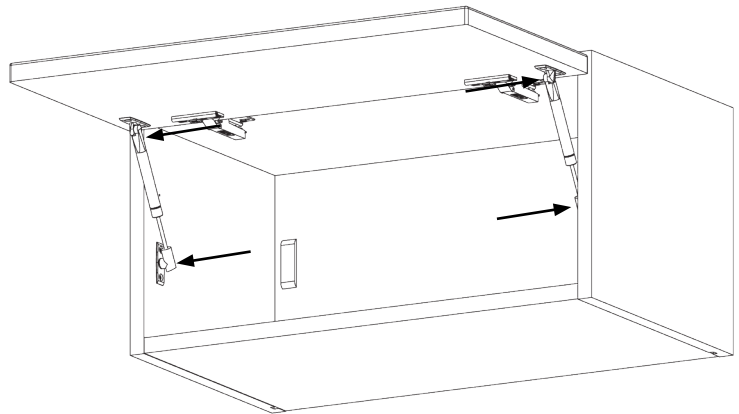

### Step 6.

Fit cover caps to hinges and adjust soft-close to suit.

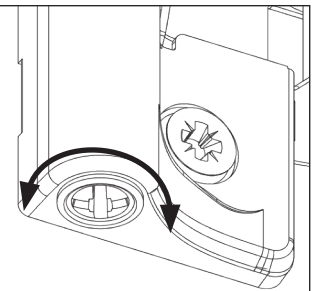

The top and bottom hinges **MUST** be adjusted to the **SAME STRENGTH**.