

Drawer units shown for illustrative purposes only.

CONTENTS	
1	Grass Drawer Box Removal
2	Grass Drawer Box Insertion
3	Grass Standard Drawer
4	Grass Deep Drawer
5 - 6	Grass Glass Drawer
7	TM Drawer Box Removal
8	TM Drawer Insertion
9	TM Standard Drawer
10	TM Mid & Deep Drawer
11	TM Mid & Deep Glass Drawer
12	TM Drawer Adjustment
13	TM Drawer Side Cover Cap

GRASS DRAWER BOX REMOVAL



Removing a drawer is the same process for Standard, Mid, Deep and Glass Drawers.

Step 1.

Open the drawer that is required to be removed.
Pull out the drawer until the runners are at full extension.

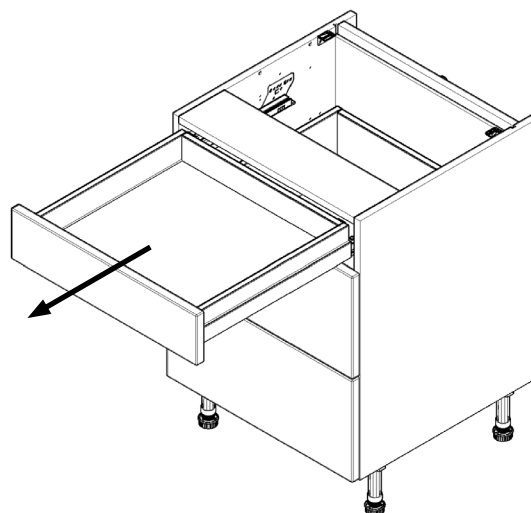

Step 2.

In one smooth motion, lift the front of the drawer, this will disconnect the runner from the connectors on the base of the drawer.
Once properly separated a click will be heard and the drawer will be separate from the runner.

If this motion is not done with enough force then the drawer may need to be lifted again.

Be careful not to lift the runners whilst lifting the drawer.

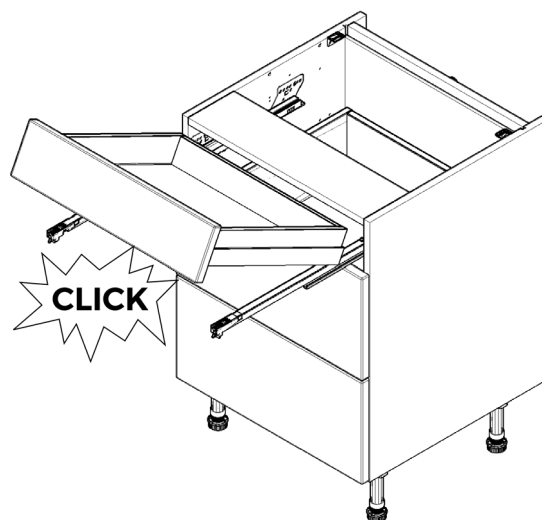

Step 3.

The drawer can now be safely removed from the unit.
Do not damage the unit in the process.

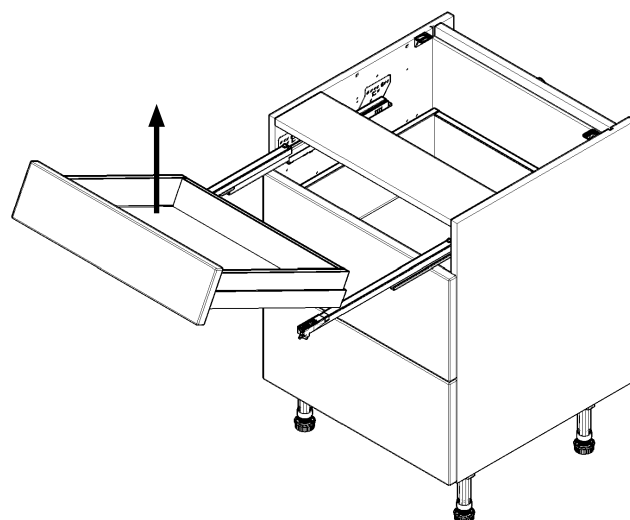

GRASS DRAWER BOX INSTALLATION



Installing a drawer is the same process for Standard, Mid, Deep and Glass Drawers.

Step 1.

Fully extend the drawer runners out of the unit (for the drawer you are inserting).

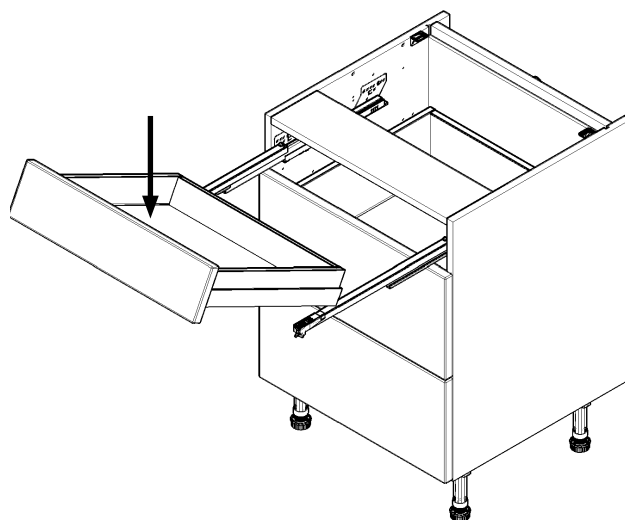

Step 2.

Place the drawer onto the runners, making sure that the groove of the drawer sides and the runner mechanism are aligned.

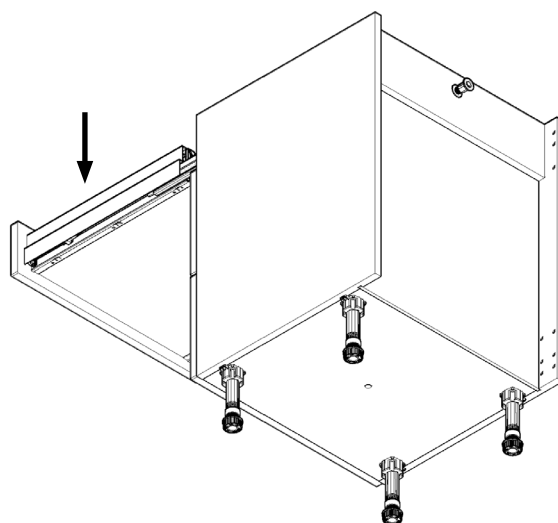

Step 3.

Pull forward the protruding lips on the ends of the runners until a click is heard. Once the click is heard the drawer is properly located and secured to the runner.

Push the drawer back into the Unit.

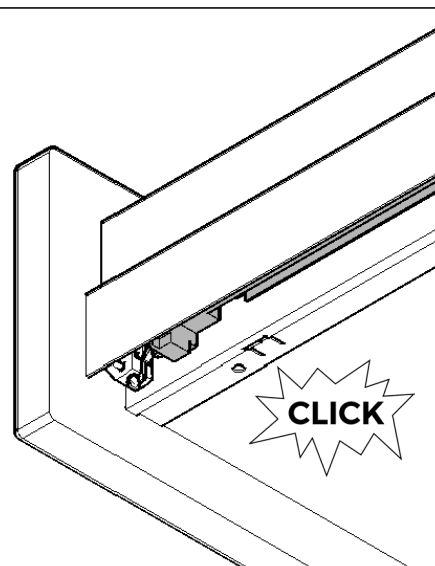
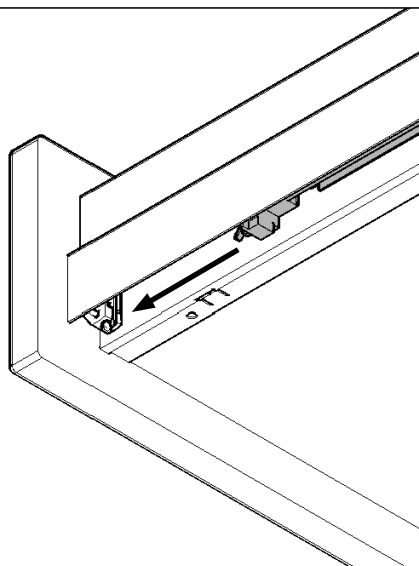

GRASS STANDARD DRAWER

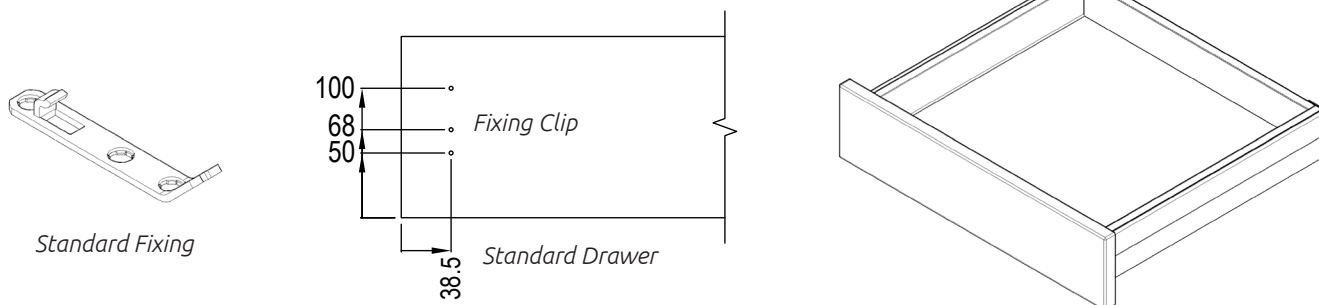

Step 1.

Attach the frontal fixings to the drawer frontal using 3 x 15mm screws per bracket using the screw hole positions as shown on both sides.

Step 2.

Attach the drawer front by pushing the frontal onto the sides, aligning the mechanism with the fixings.

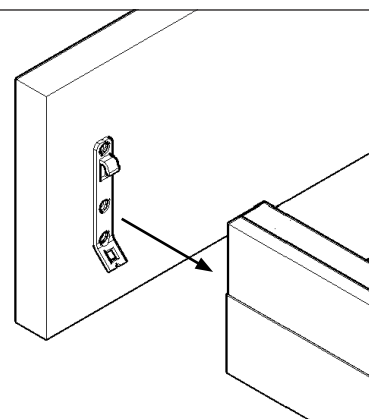
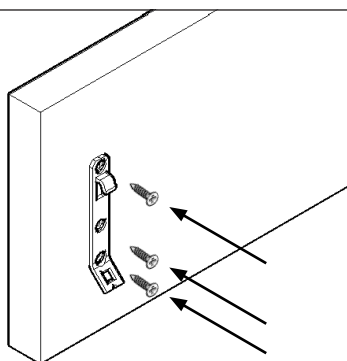

Step 3.

Loosen top screw. Turn the bottom screw to adjust drawer frontal height, once in desired position re-tighten the top screw.

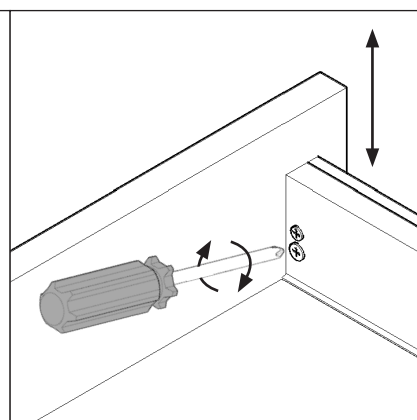

Step 4.

Press in the fixing clips half way, located at the bottom of the frontal on **both sides** of the drawer. Adjust the position of the drawer frontal, left or right. Release the frontal fixing clips on both sides of the drawer to secure the frontal in the new position.

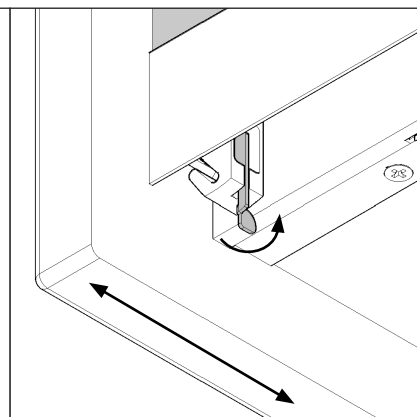

Step 5.

Fit drawer cover caps over drawer side adjustment screws.



Drawer Frontal Replacement Guide

GRASS DEEP DRAWER

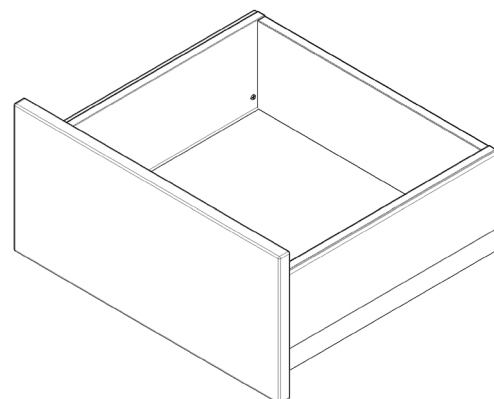
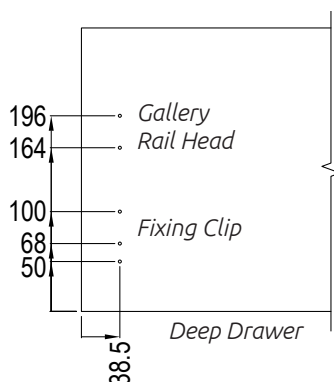
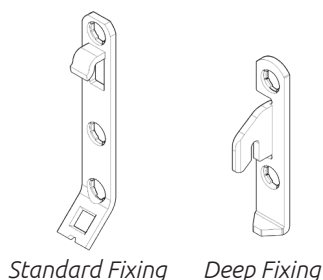

Step 1.

Attach the frontal fixings standard and deep to the draw frontal using 5 x 15mm screws using the screw hole positions as shown on both sides.

Step 2.

Attach the drawer front by pushing the frontal onto the sides, aligning the mechanism with the fixings.

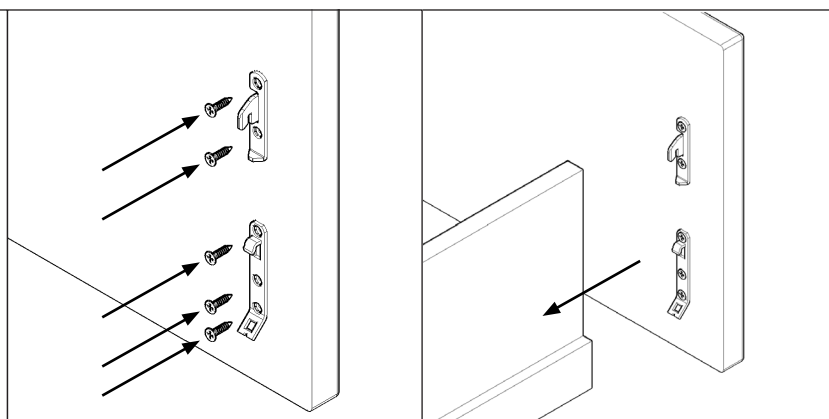

Step 3.

Loosen top two screws at the front of the drawer. Turn the bottom screw to adjust frontal height, once in desired position re-tighten the top screws.

Turn the screw at the back of the drawer to adjust rear elevation of the drawer.

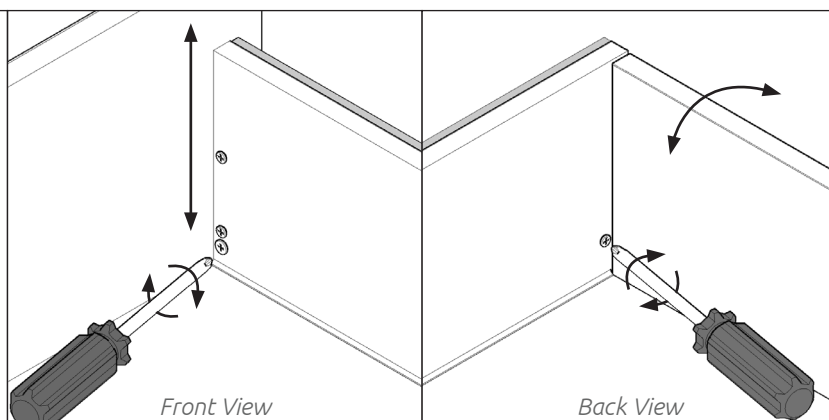

Step 4.

Press in the fixing clips half way, located at the bottom of the frontal on **both sides** of the drawer. Adjust the position of the drawer frontal, left or right. Release the frontal fixing clips on both sides of the drawer to secure the frontal in the new position.

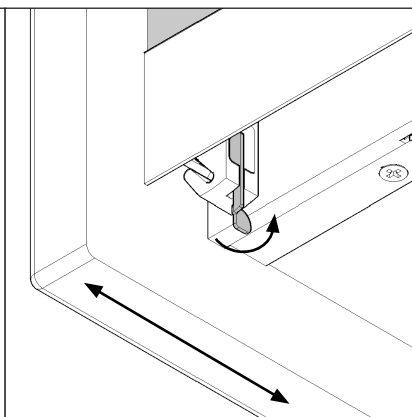

Step 5.

Fit drawer cover caps over drawer side adjustment screws.



GRASS GLASS DRAWER

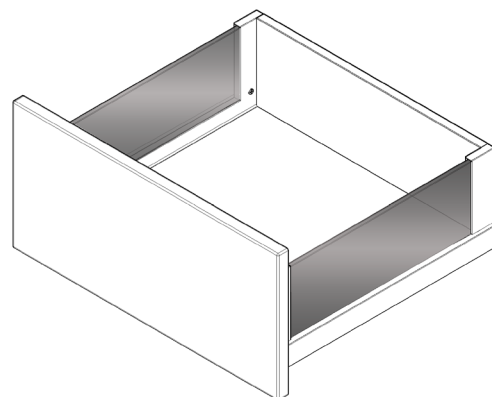
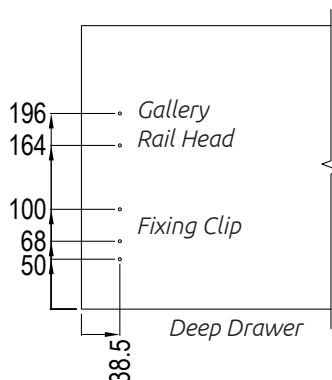
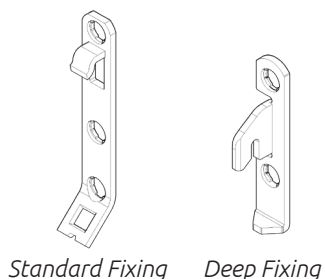

Step 1.

Attach the frontal fixings standard and deep to the draw frontal using 5 x 15mm screws using the screw hole positions as shown on both sides.

Step 2.

Attach the drawer front by pushing the frontal onto the sides, aligning the mechanism with the fixings.

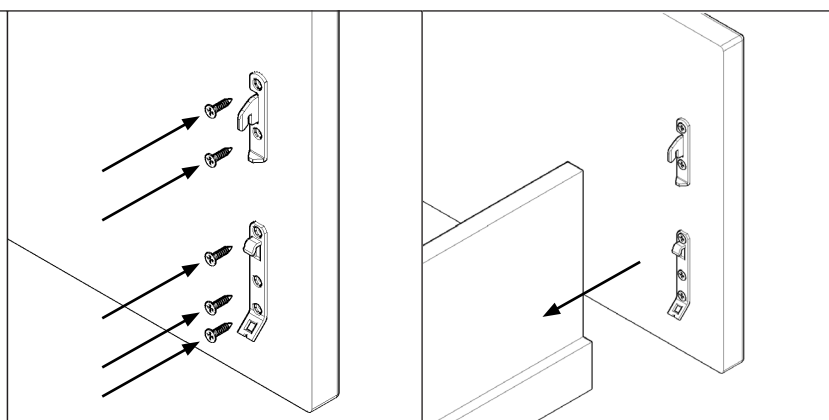

Step 3. Glass Panel Attachment

Push the button in on the back of the drawer side. Slide the glass panel into the opening at the back of the drawer side. Push the glass panel forwards into the opening at the front until you hear a click.

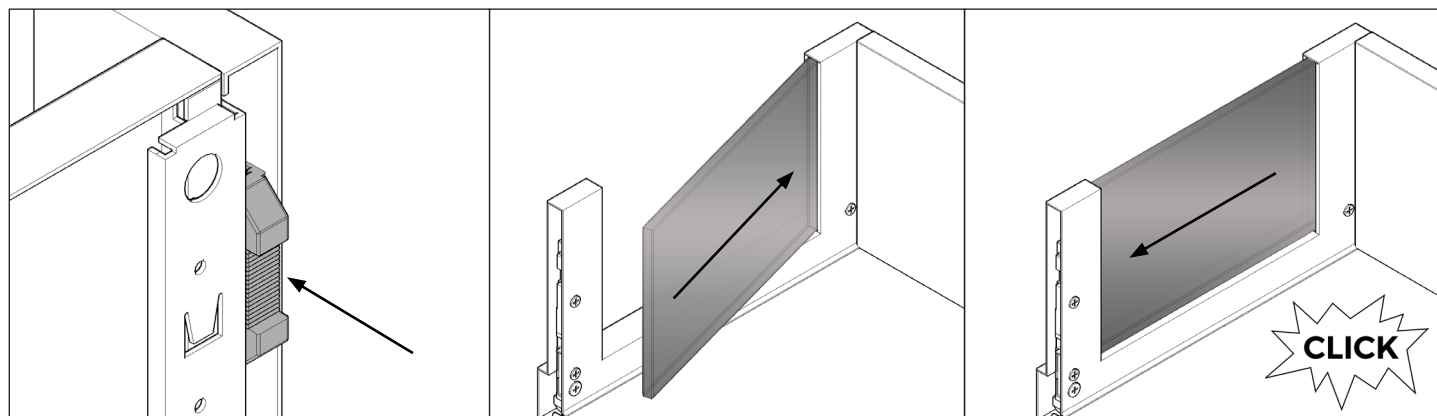

Drawer Frontal Replacement Guide

Step 4.

Loosen top two screws at the front of the drawer. Turn the bottom screw to adjust frontal height, once in desired position re-tighten the top screws.

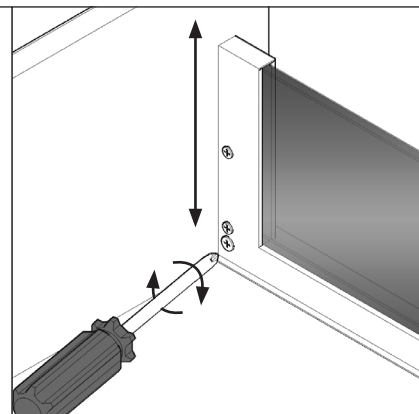

Step 5.

Turn the screw at the back of the drawer to adjust rear elevation of the drawer.

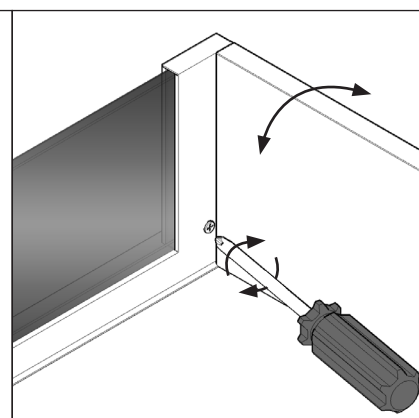

Step 6.

Press in the fixing clips half way, located at the bottom of the frontal on **both sides** of the drawer. Adjust the position of the drawer frontal, left or right. Release the frontal fixing clips on both sides of the drawer to secure the frontal in the new position.

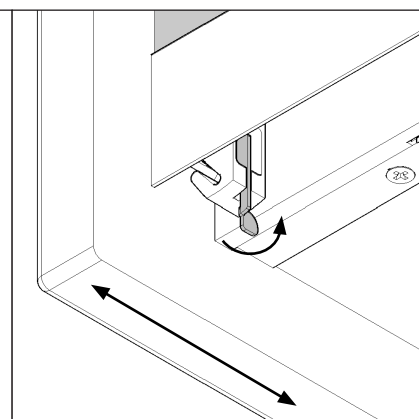

Step 7.

Fit drawer cover caps over drawer side adjustment screws.

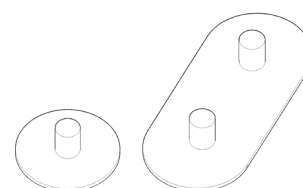

Cover caps

TM DRAWER BOX REMOVAL



Removing a drawer is the same process for Standard, Mid, Deep and Glass Drawers.

Step 1.

Open the drawer that is required to be removed.
Pull out the drawer until the runners are at full extension.

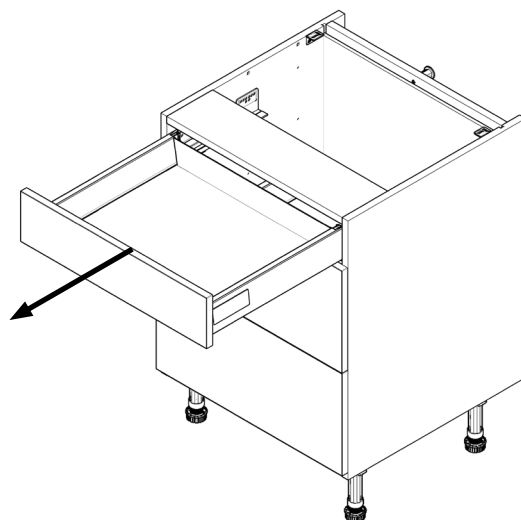

Step 2.

In one smooth motion, lift the front of the drawer, this will disconnect the runner from the connectors on the base of the drawer.
Once properly separated a click will be heard and the drawer will be separate from the runner.

If this motion is not done with enough force then the drawer may need to be lifted again.

Be careful not to lift the runners whilst lifting the drawer.

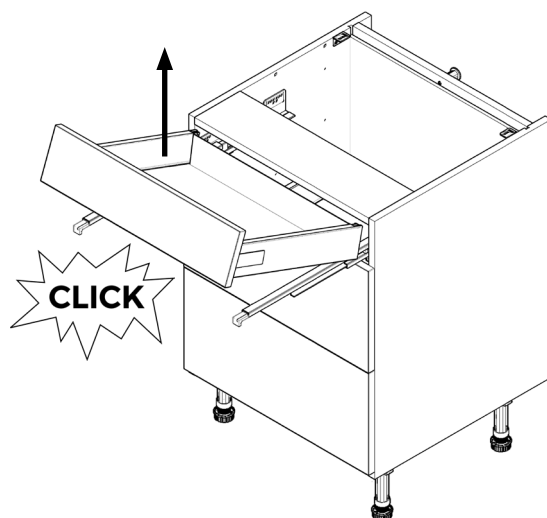

Step 3.

The drawer can now be safely removed from the unit.
Do not damage the unit in the process.

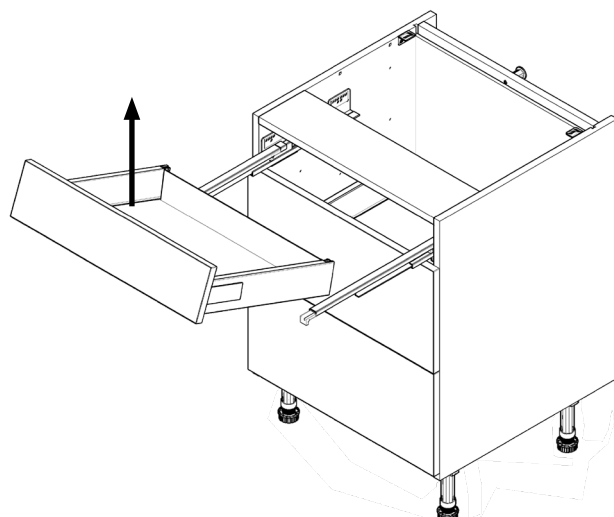

TM DRAWER BOX INSTALLATION



Installing a drawer is the same process for Standard, Mid, Deep and Glass Drawers.

Step 1.

Fully extend the drawer runners out of the unit (for the drawer you are inserting).

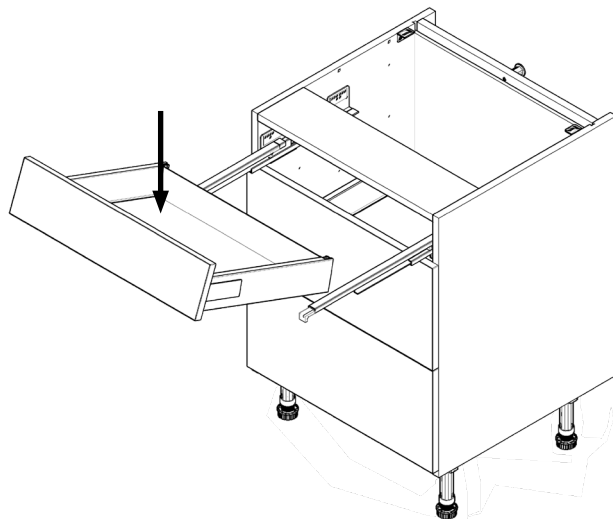

Step 2.

Place the drawer onto the runners, making sure that the groove of the drawer sides and the runner mechanism are aligned.

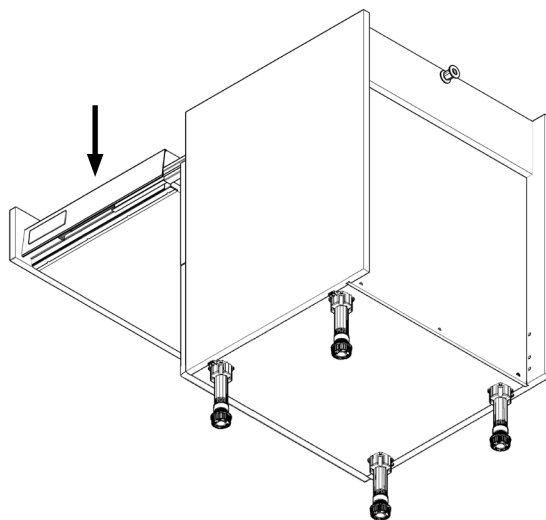

Step 3.

Pull forward the protruding lips on the ends of the runners until a click is heard. Once the click is heard the drawer is properly located and secured to the runner.

Push the drawer back into the Unit.

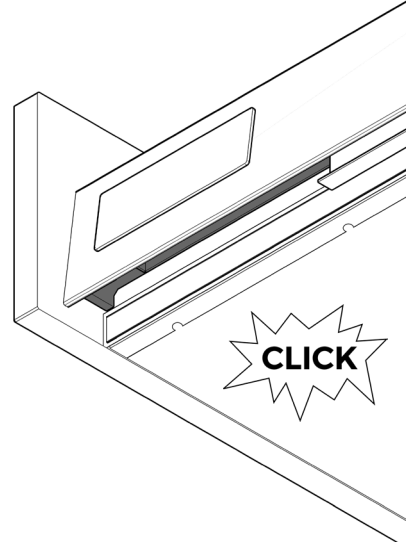
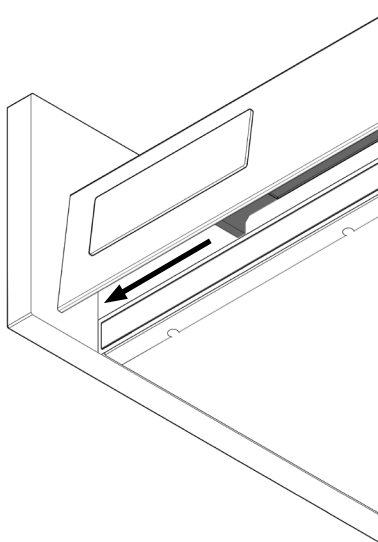

TM STANDARD DRAWER

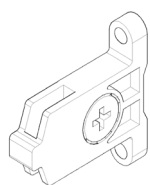

Drawer Side
Fixing Clip

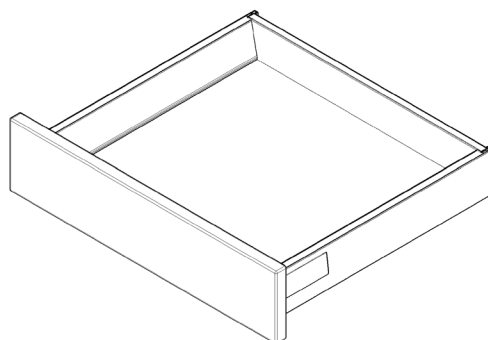
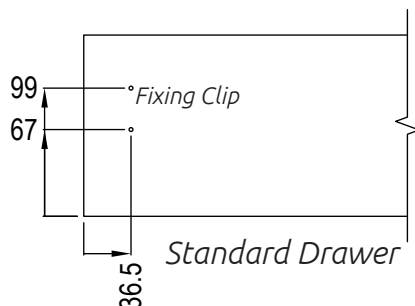

Step 1.

Secure drawer side fixing clips using 2 x 21mm screws in pilot holes provided as shown on both sides.

Step 2.

Push fit drawer side fixing clips onto drawer side.

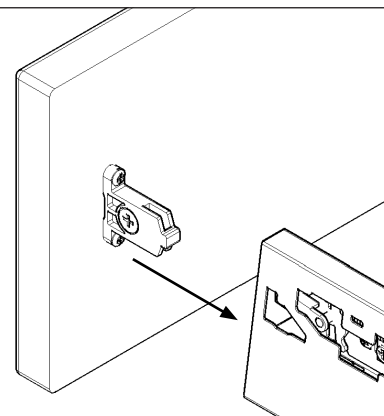
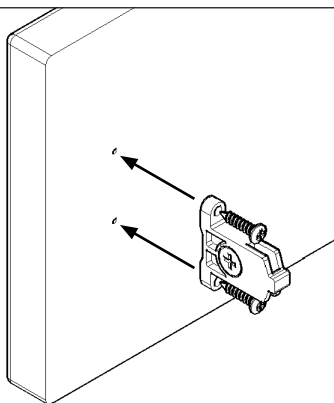

Step 3.

Drawer frontal adjustment - See **page 12** for details.

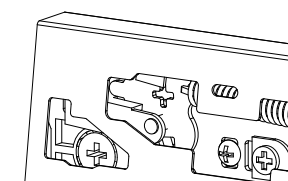

Step 4.

Fit drawer cover caps over drawer side adjustment. See **page 13** for more details.

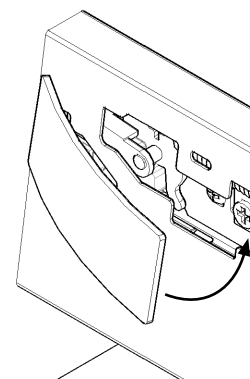

Drawer Frontal Replacement Guide

TM MID AND DEEP DRAWER

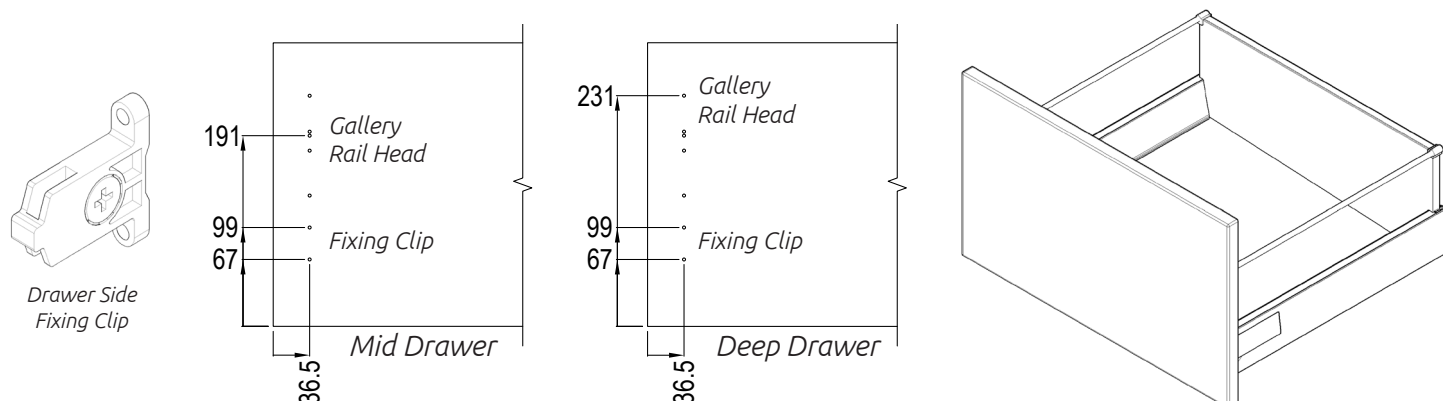

Step 1.

Secure gallery rail head fixings using 1 x 15mm screw in the top pilot hole and secure drawer side fixing clips using 2 x 21mm screws in the bottom 2 pilot holes provided as shown on both sides.

Step 2.

Push fit drawer side fixing clips onto drawer side.

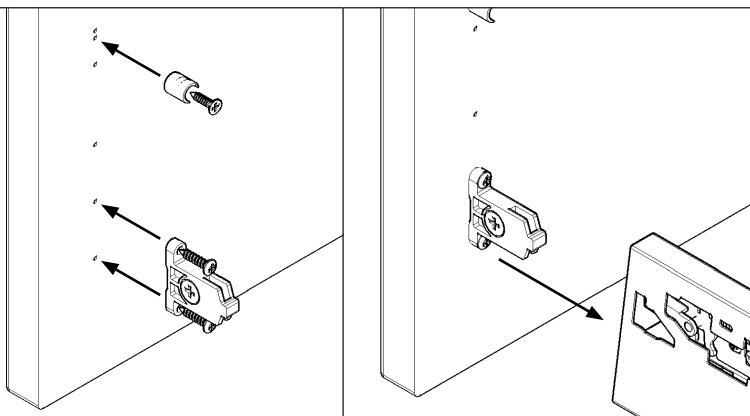

Step 3.

A. Clip gallery rail into the top corners of the metal back panel.

B. Locate front end of the gallery rail into the opening of the gallery head fixing clip, which is secured to the frontal as shown.

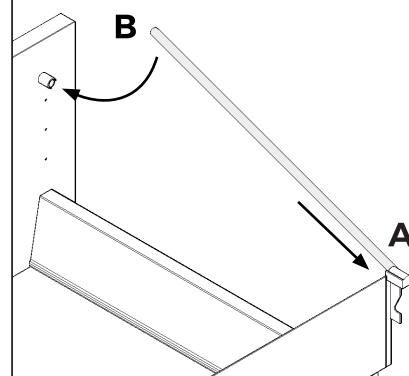

Step 4.

Drawer frontal adjustment - See **page 12** for details.

Step 5.

Fit drawer cover caps over drawer side adjustment. See **page 13** for more details.

Drawer Frontal Replacement Guide

TM MID AND DEEP GLASS DRAWER

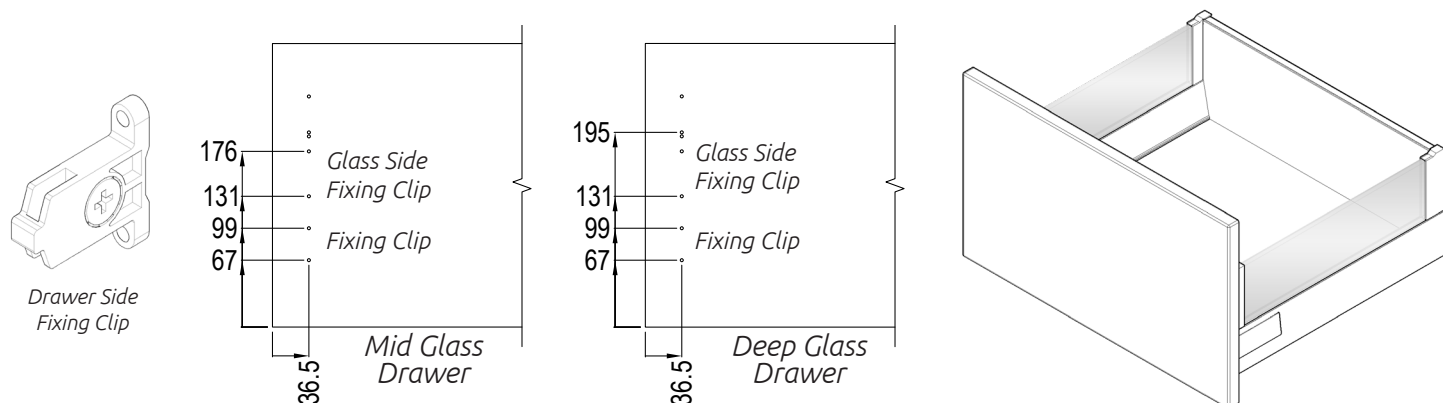

Step 1.

Secure glass side fixing clips using 2 x 15mm screws in the top 2 pilot holes and secure drawer side fixing clips using 2 x 21mm screws in the bottom 2 pilot holes provided as shown on both sides.

Step 2.

Push fit drawer side fixing clips onto drawer side.

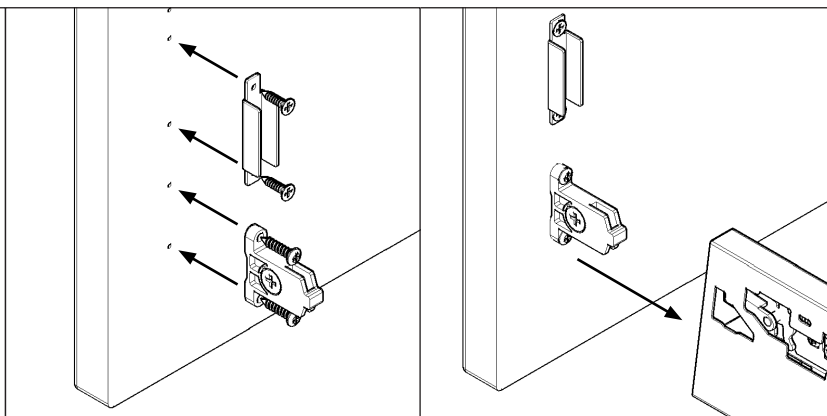

Step 3.

Fit the glass sides with end caps attached. Use the groove on the front end cap as a guide to slide into place onto frontal glass fixing clip, and into metal back as shown. Depress the rear end clip release catch and lift to remove the side.

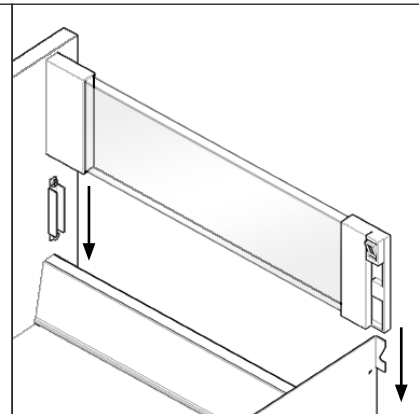
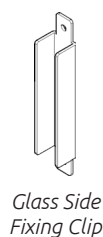

Step 4.

Drawer frontal adjustment - See **page 12** for details.

Step 5.

Fit drawer cover caps over drawer side adjustment. See **page 13** for more details.

TM DRAWER ADJUSTMENT

Left and Right Adjustment

Turn the screw shown to **adjust** the drawer frontal **left & right**.
Repeat on both sides.

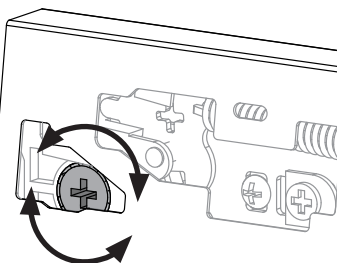

Up & Down Adjustment

Turn the screw shown to **adjust** the drawer frontal **up & down**.
Repeat on both sides.

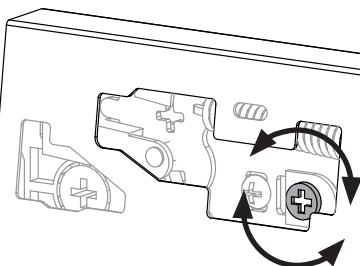

Lock Position

Tighten the screw shown to **lock** the drawer frontal in position.
Repeat on both sides.

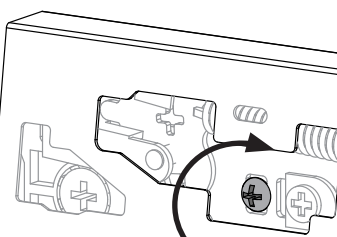

Remove Frontal

To remove the frontal, release the fixing clip by turning the locking plate screw shown.
Repeat on both sides.

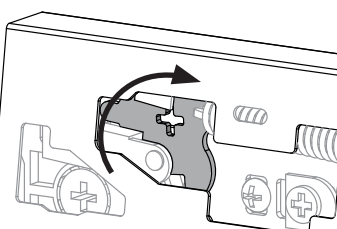

TM DRAWER SIDE COVER CAPS

Step 1

Fit drawer cover caps over drawer side adjustment. Position the edge closest to the frontal first.

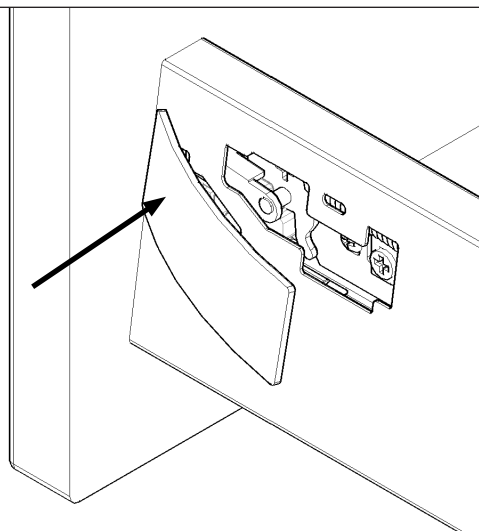
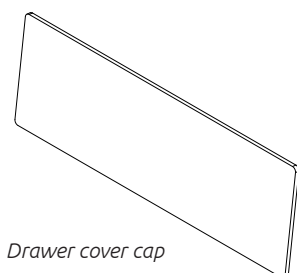

Step 2

Position the far side edge into place.

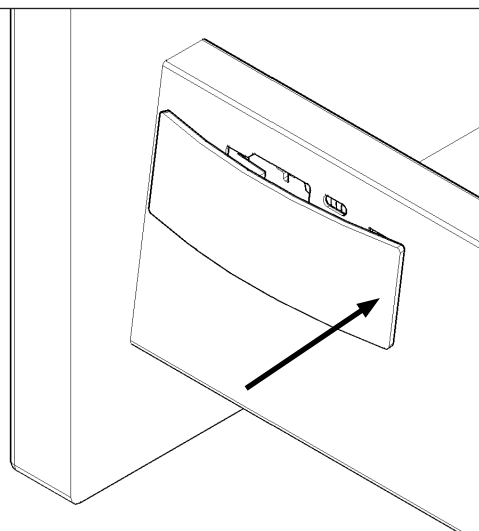

Step 3

Press the cover cap against the drawer side to secure it in place. Repeat on the opposite side.

