

1 Door

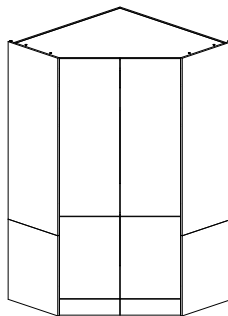

70/30 Door

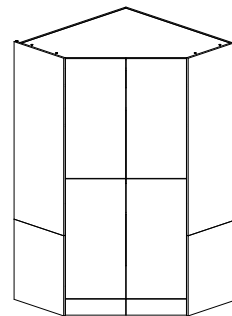

50/50 Door



BEFORE YOU START

**INSTALLATION SHOULD BE PERFORMED BY A COMPETENT PERSON ONLY.
THIS PRODUCT COULD BE DANGEROUS IF INCORRECTLY INSTALLED**



Screws and fixings for attaching to walls are not provided as these vary depending on materials and construction. Ensure appropriate fixings for wall are used.

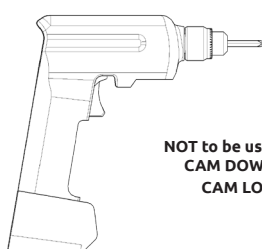
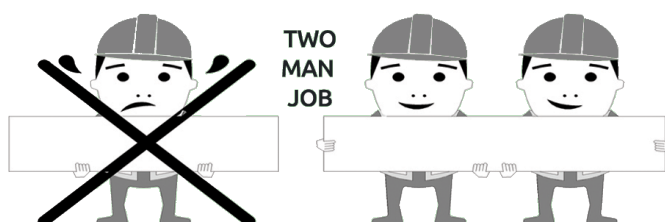

NOT to be used with
CAM DOWEL &
CAM LOCK

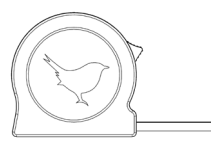
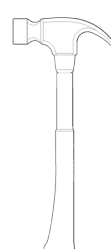

2070 & 2250 Diagonal Corner Office Assembly Guide

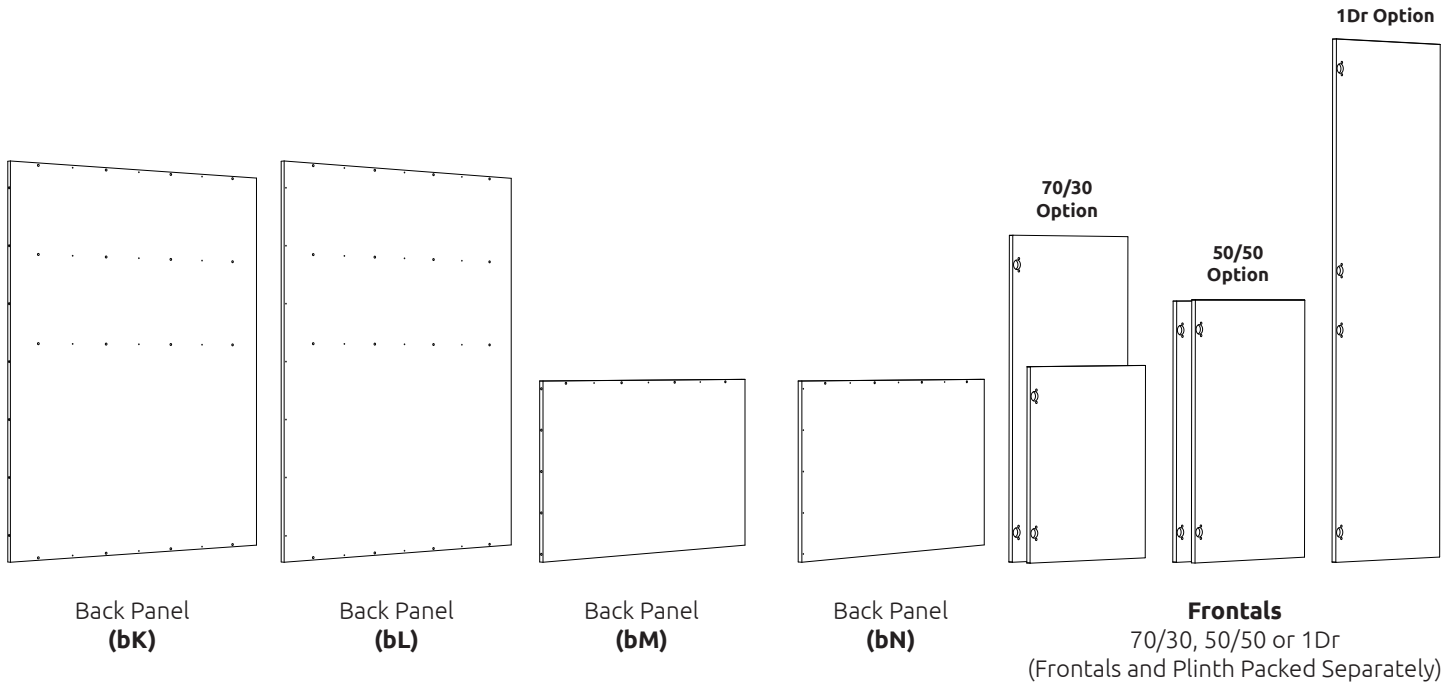
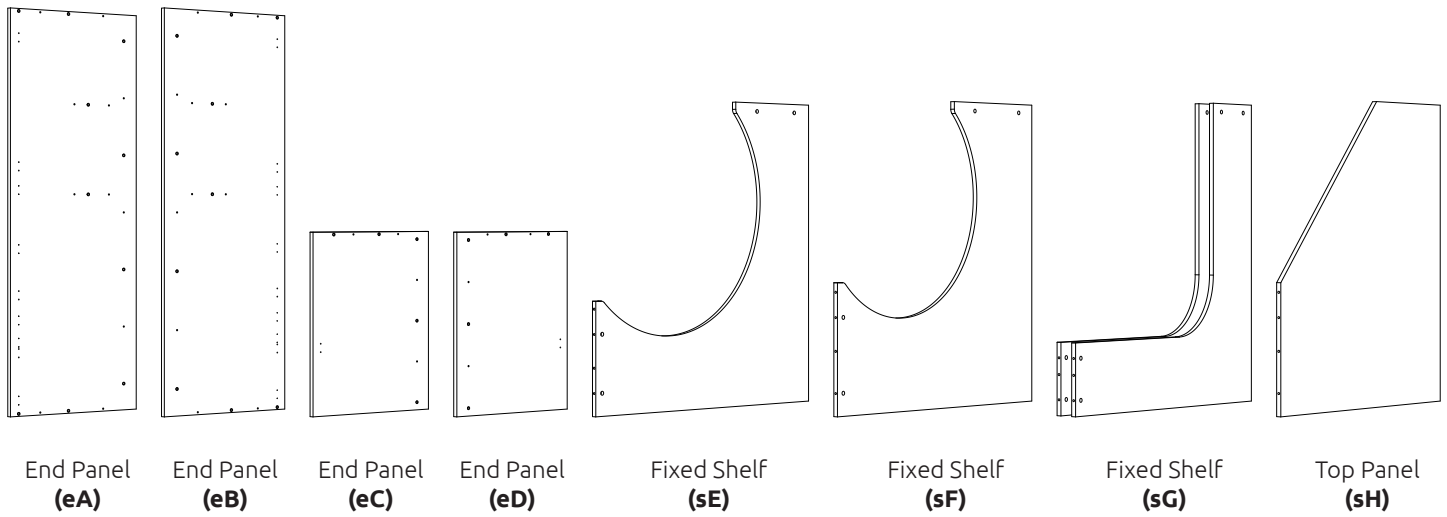

2070 & 2250 Diagonal Corner Office Assembly Guide

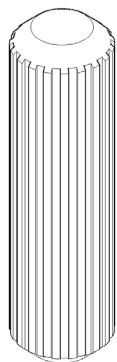

(F) x70
Wooden Dowel

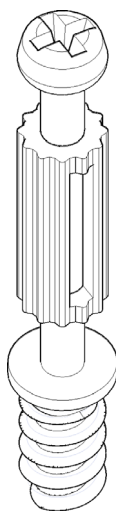

(W) x30
Cam Dowel

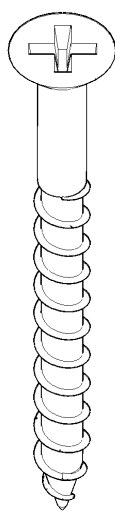

(P) x42
45mm Screws

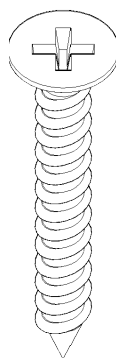

(K) x16
30mm Screws

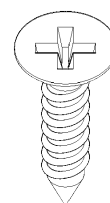

(L) x40
15mm Screws

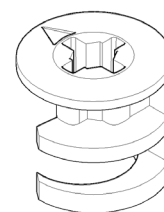

(H) x30
Cam Lock

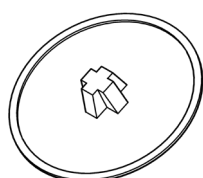

(M) x4
Cover Cap

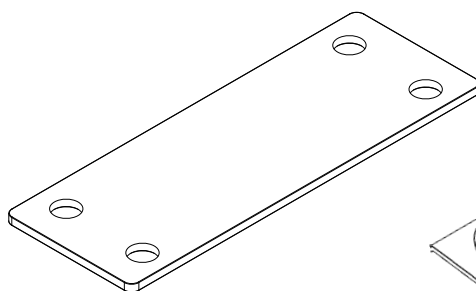

Fixing Plate (U)
x4

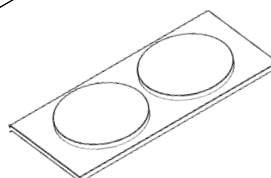

Door Buffer
x1

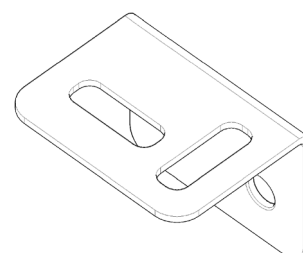

L Bracket LGE
x4

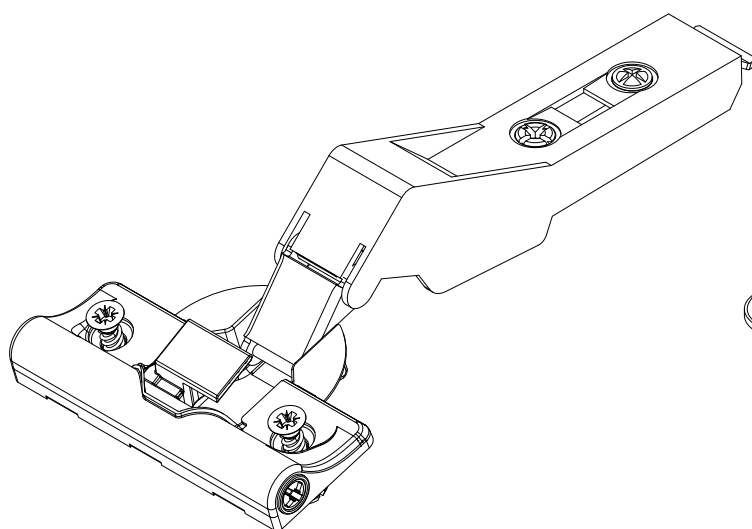

Hinge
Inc Screws

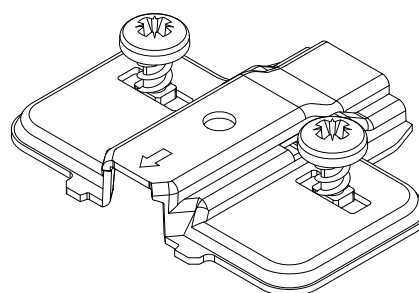

Hinge Mounting Plate
Inc Screws

2070 & 2250 Diagonal Corner Office Assembly Guide

Step 1.

Seat 4 cam dowels **(W)** into holes in end panel **(eC)** as shown.

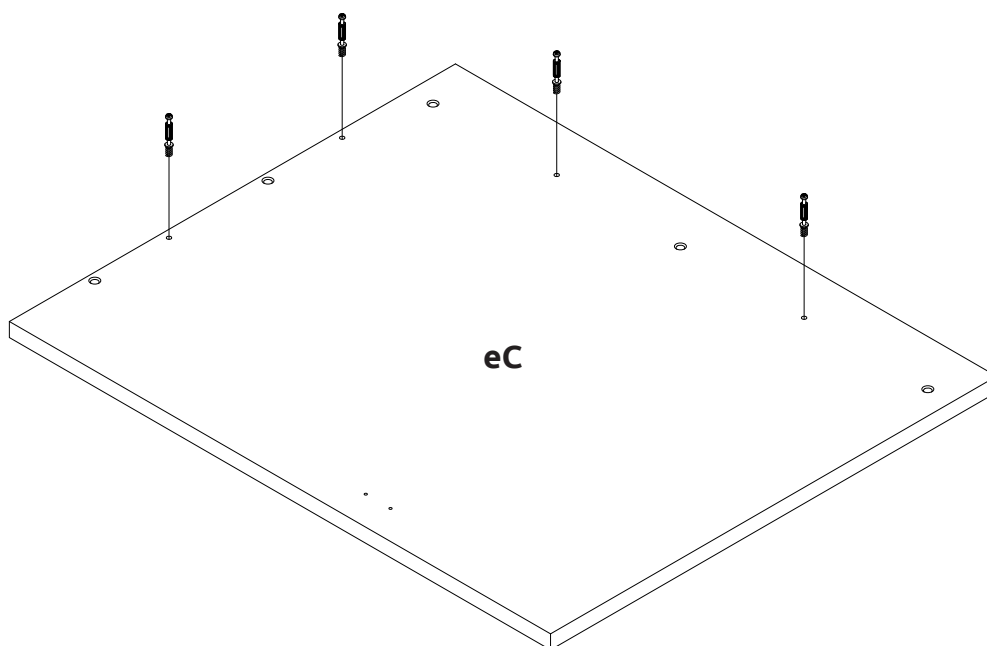
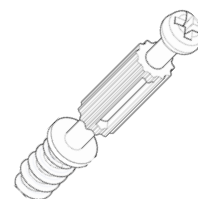

Step 2.

Seat 2 wooden dowels **(F)** into holes in panel **(sE)** as shown.

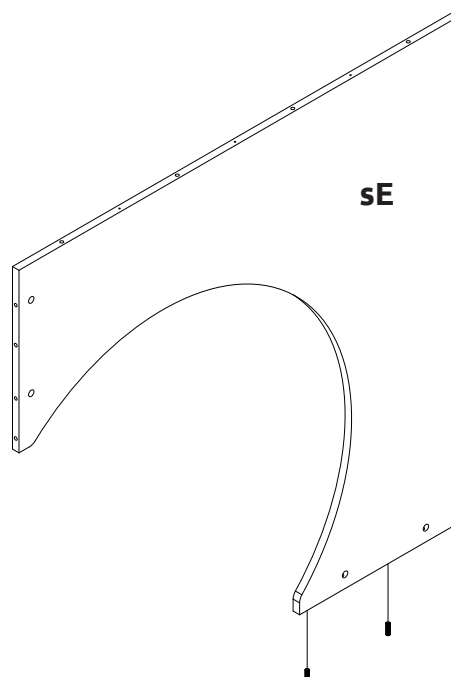

2070 & 2250 Diagonal Corner Office Assembly Guide

Step 3.

Attach panel **(sE)** to end panel **(eC)**, using cam dowels **(W)** and wooden dowels **(F)** in positions as shown.

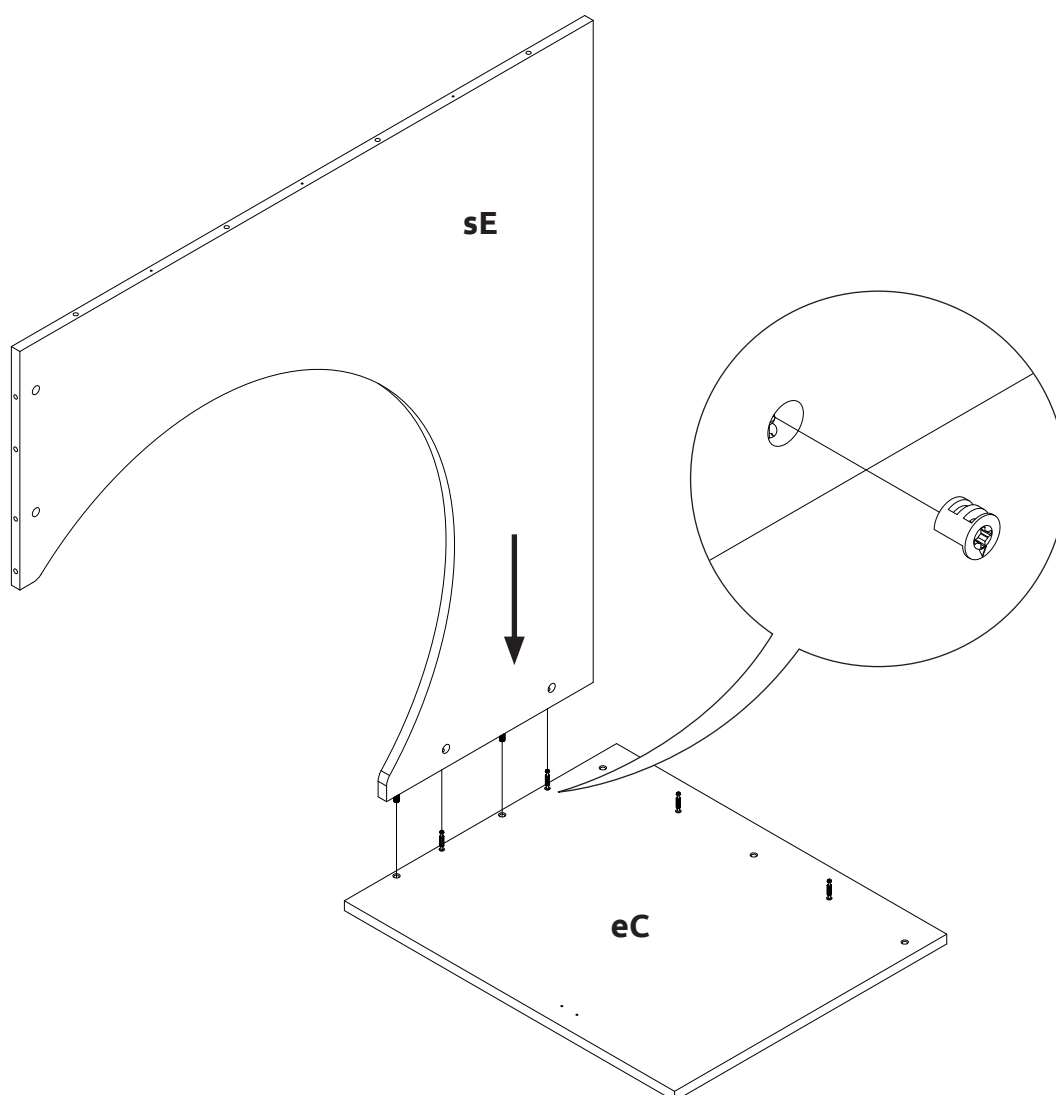
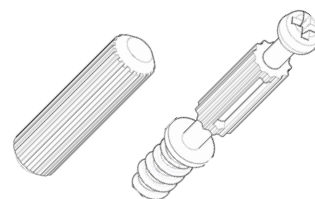

Step 4.

Insert 2 cam locks **(H)** into holes in panel **(sE)** as shown.
Do NOT tighten until step 13.

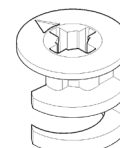

2070 & 2250 Diagonal Corner Office Assembly Guide

Step 5.

Seat 8 wooden dowels **(F)** into holes in panel **(sE)** and 3 wooden dowels **(F)** into holes in end panel **(eC)** as shown.

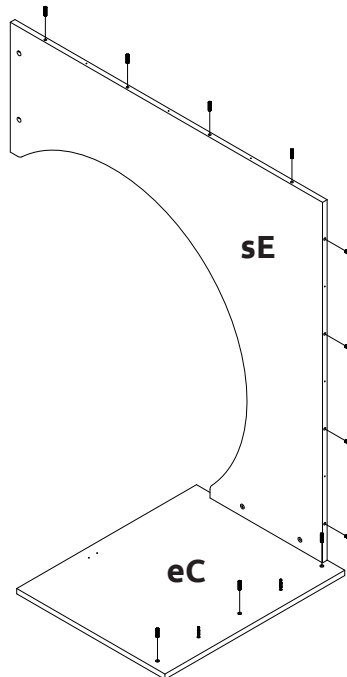

Step 6.

Attach back panel **(bM)** to end panel **(eC)** and panel **(sE)**, using cam dowels **(W)** and wooden dowels **(F)** in positions as shown.

Once back panel **(bM)** is in position, ensure it is flush & square with bottom of end panel **(eC)**.

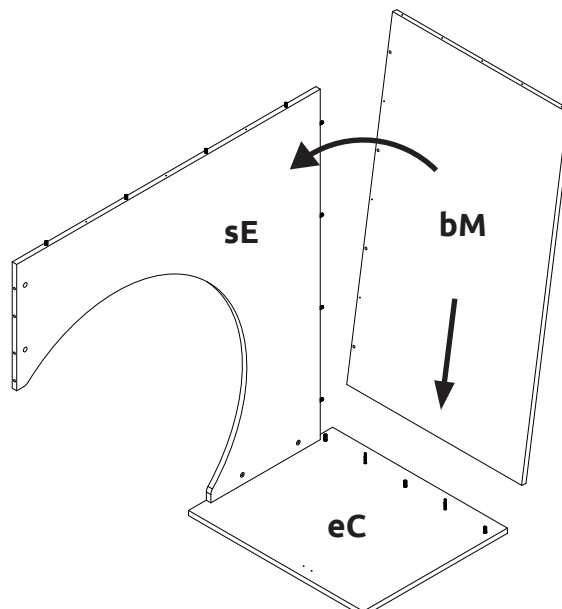

2070 & 2250 Diagonal Corner Office Assembly Guide

Step 7.

Secure back panels (**bM**) to panel (**sE**), using 3 x 45mm screws (**P**) as shown.

Step 8.

Insert 2 cam locks (**H**) into holes in back panel (**bM**) as shown.
Do **NOT** tighten until step 13.

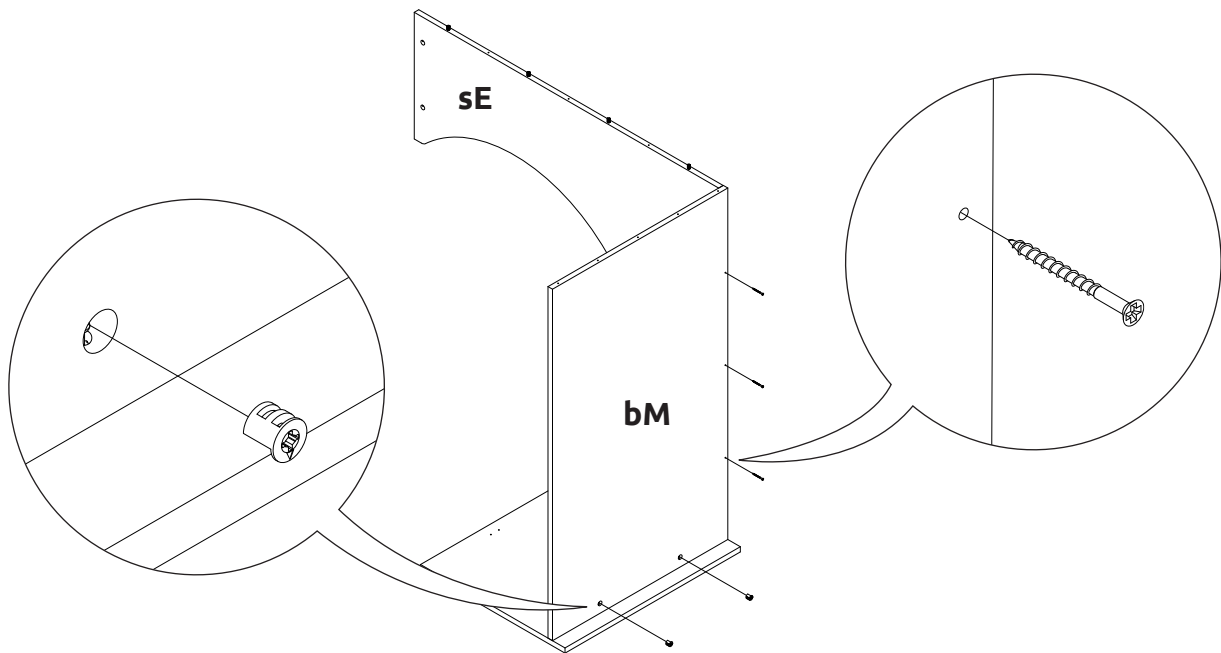

Step 9.

Position back panel (**bN**) onto the wooden dowels (**F**) in panel (**sE**).
Secure back panel (**bN**) to panels (**sE**) and (**bM**), using 8 x 45mm screws (**P**).

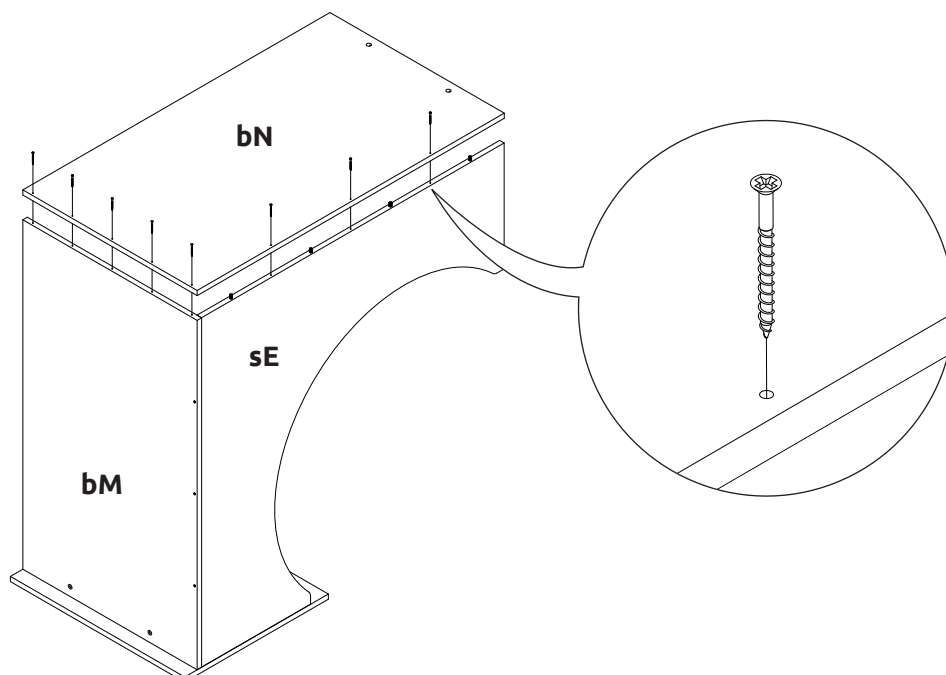

2070 & 2250 Diagonal Corner Office Assembly Guide

Step 10.

Seat 2 wooden dowels **(F)** into holes in panel **(sE)** and 3 wooden dowels **(F)** into holes in back panel **(bN)** as shown.

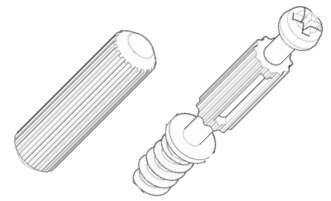

Step 11.

Seat 4 cam dowels **(W)** into holes in end panel **(eD)** as shown.

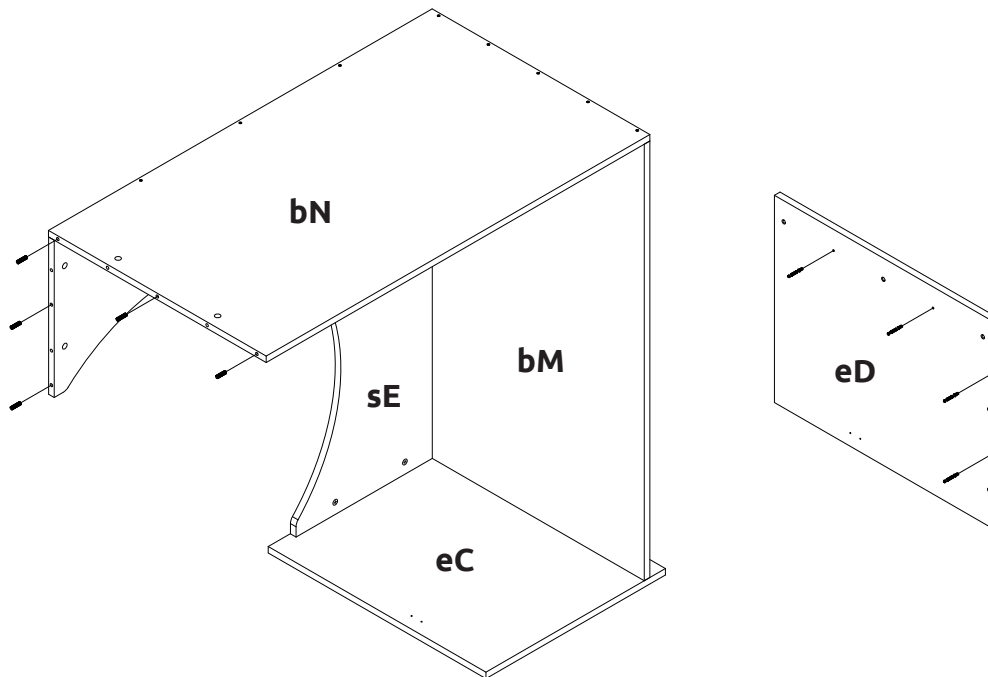

Step 12

Attach end panel **(eD)** to back panel **(bN)** and panel **(sE)**, using cam dowels **(W)** and wooden dowels **(F)** in positions as shown.

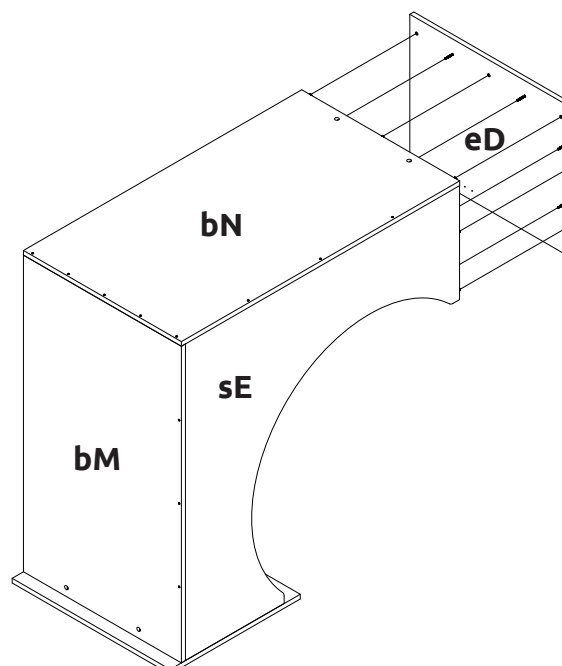

2070 & 2250 Diagonal Corner Office Assembly Guide

Step 13.

Insert 2 cam locks **(H)** per panel into holes in back panel **(bN)** and in panel **(sE)** as shown.
Hand tighten all cam locks **(H)**, this will expand cam dowels **(W)** and tighten the unit together.

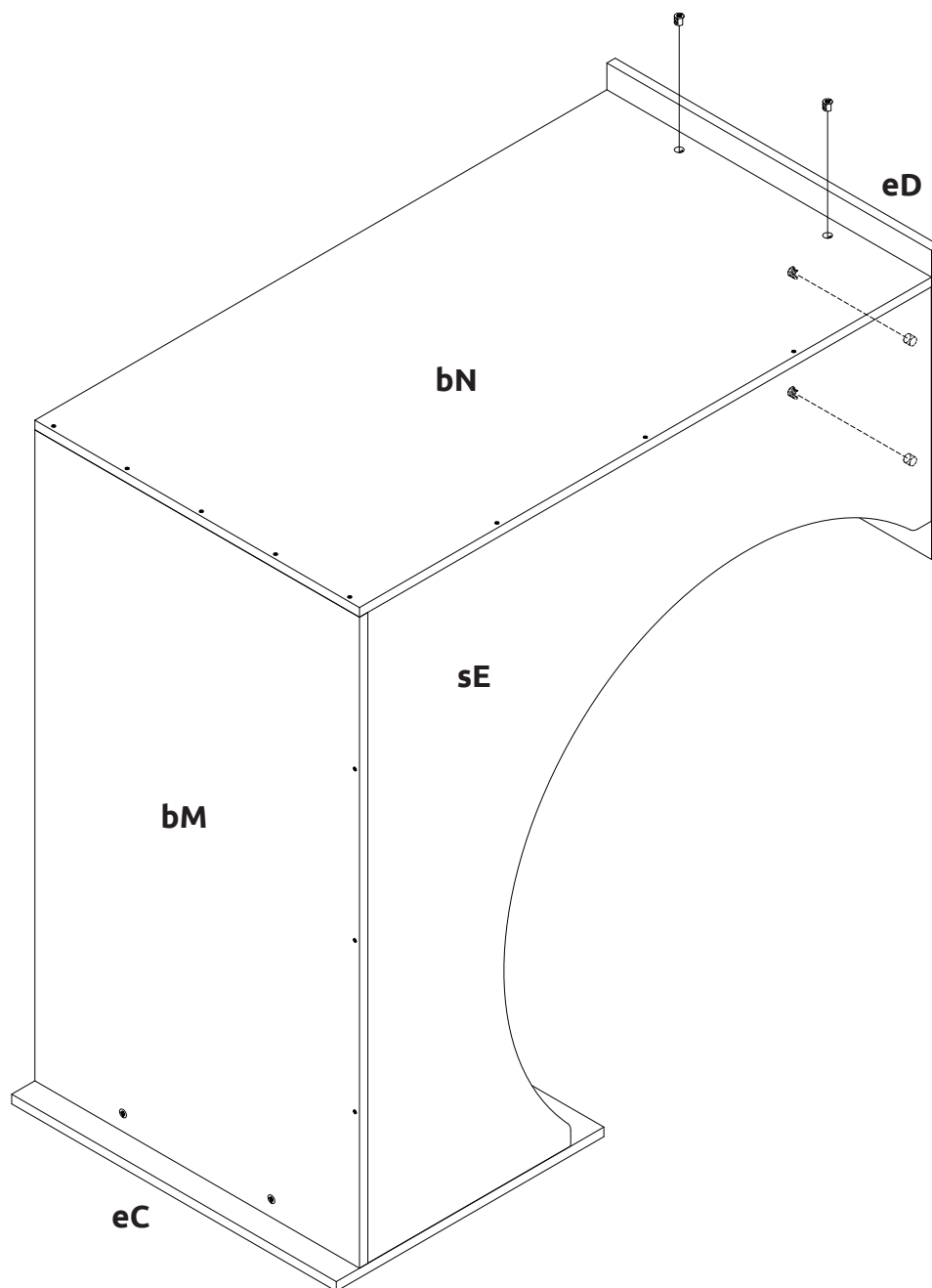
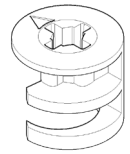

2070 & 2250 Diagonal Corner Office Assembly Guide

Step 14.

Ensure the unit is positioned correctly and level. Secure the unit to wall, using **L brackets LGE**.

Use 2 x 15mm screws (**L**) to secure each of the **L brackets LGE** to the end panel at either side. Then screw through into the wall as shown.

Screws for securing to walls are not provided.

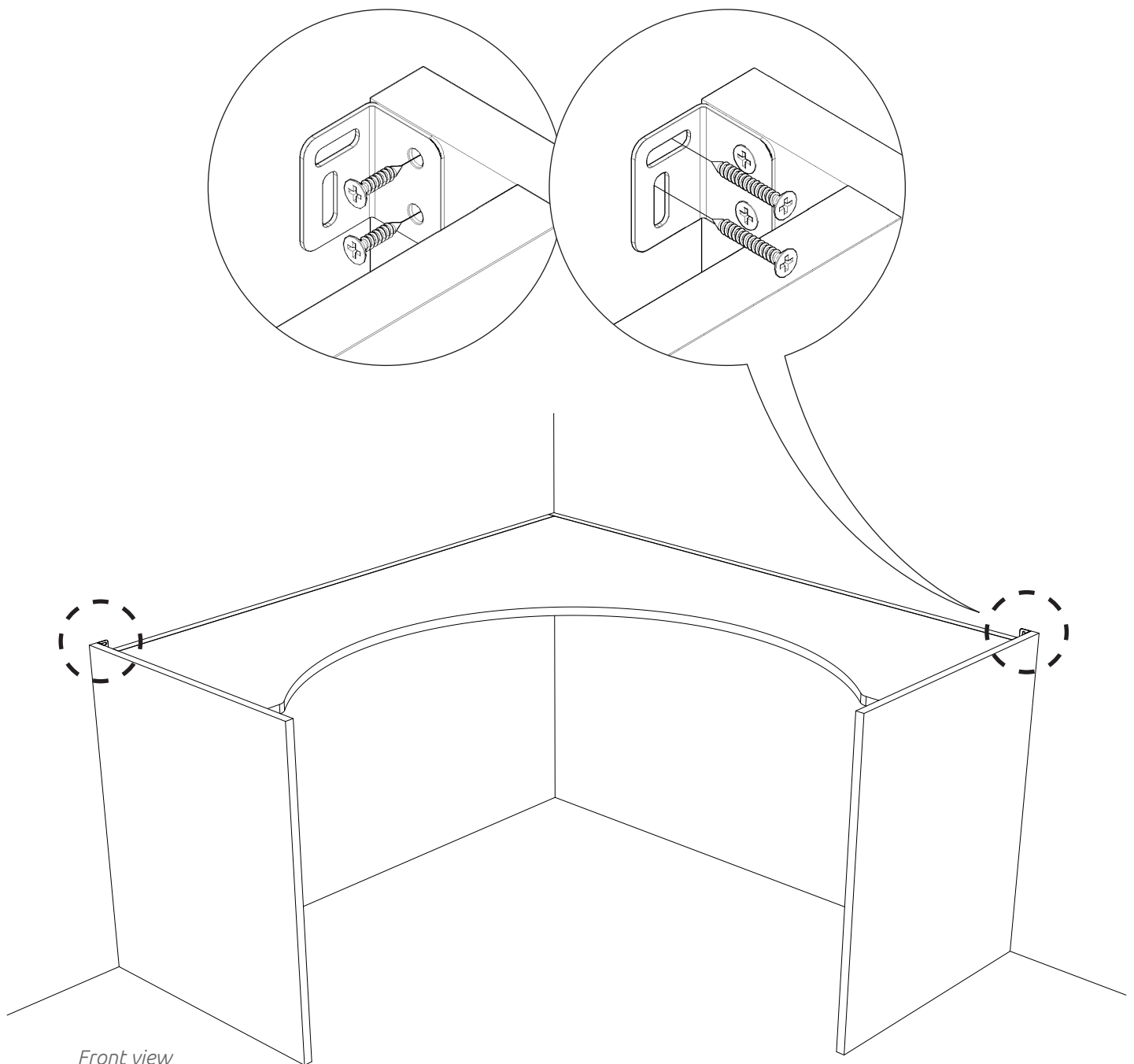
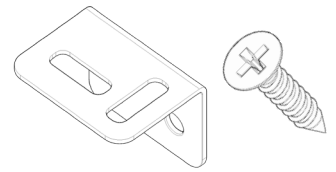

Front view

2070 & 2250 Diagonal Corner Office Assembly Guide

Step 15.

Seat 11 cam dowels (**W**) into holes in end panel (**eA**) as shown.

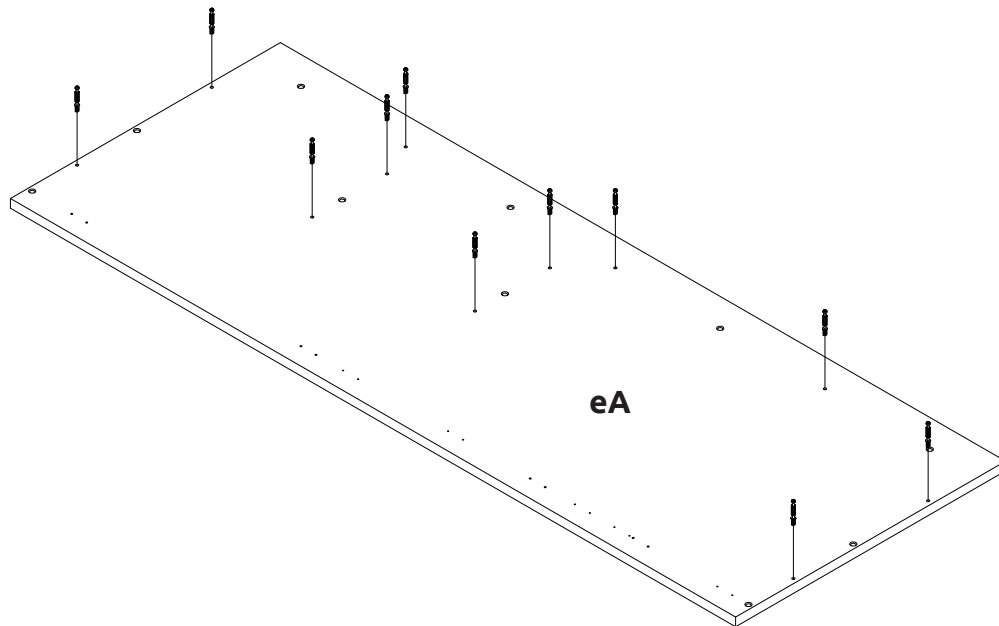
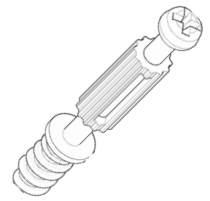

Step 16.

Seat 2 wooden dowels (**F**) per panel into holes in panels (**sH**) and (**sF**) as shown.
Seat 1 wooden dowel (**F**) per panel into hole in panels (**sG**) as shown.

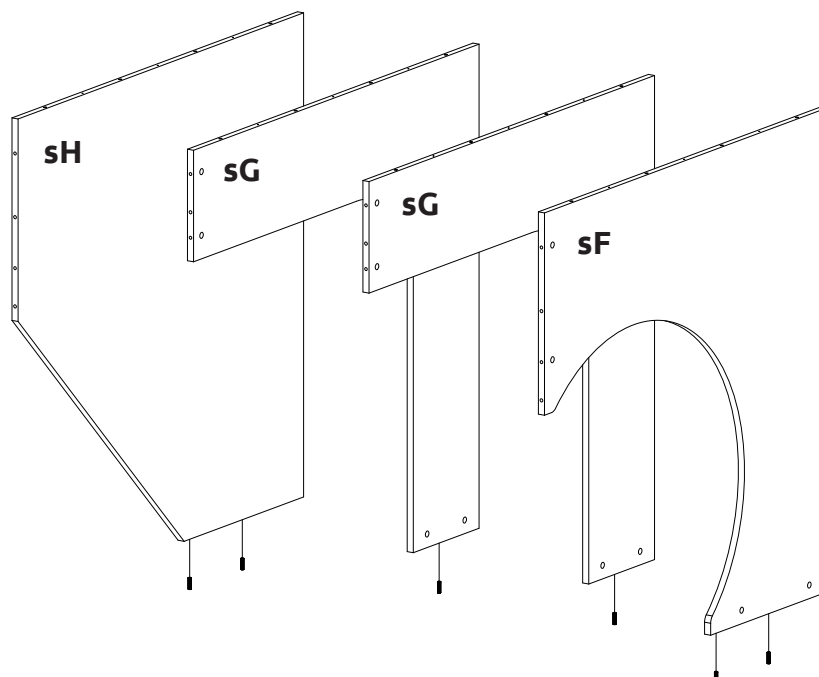

2070 & 2250 Diagonal Corner Office Assembly Guide

Step 17.

Attach panels **(sH)**, **(sG)**, **(sF)**, to end panel **(eA)**, using cam dowels **(W)** and wooden dowels **(F)** in positions as shown.

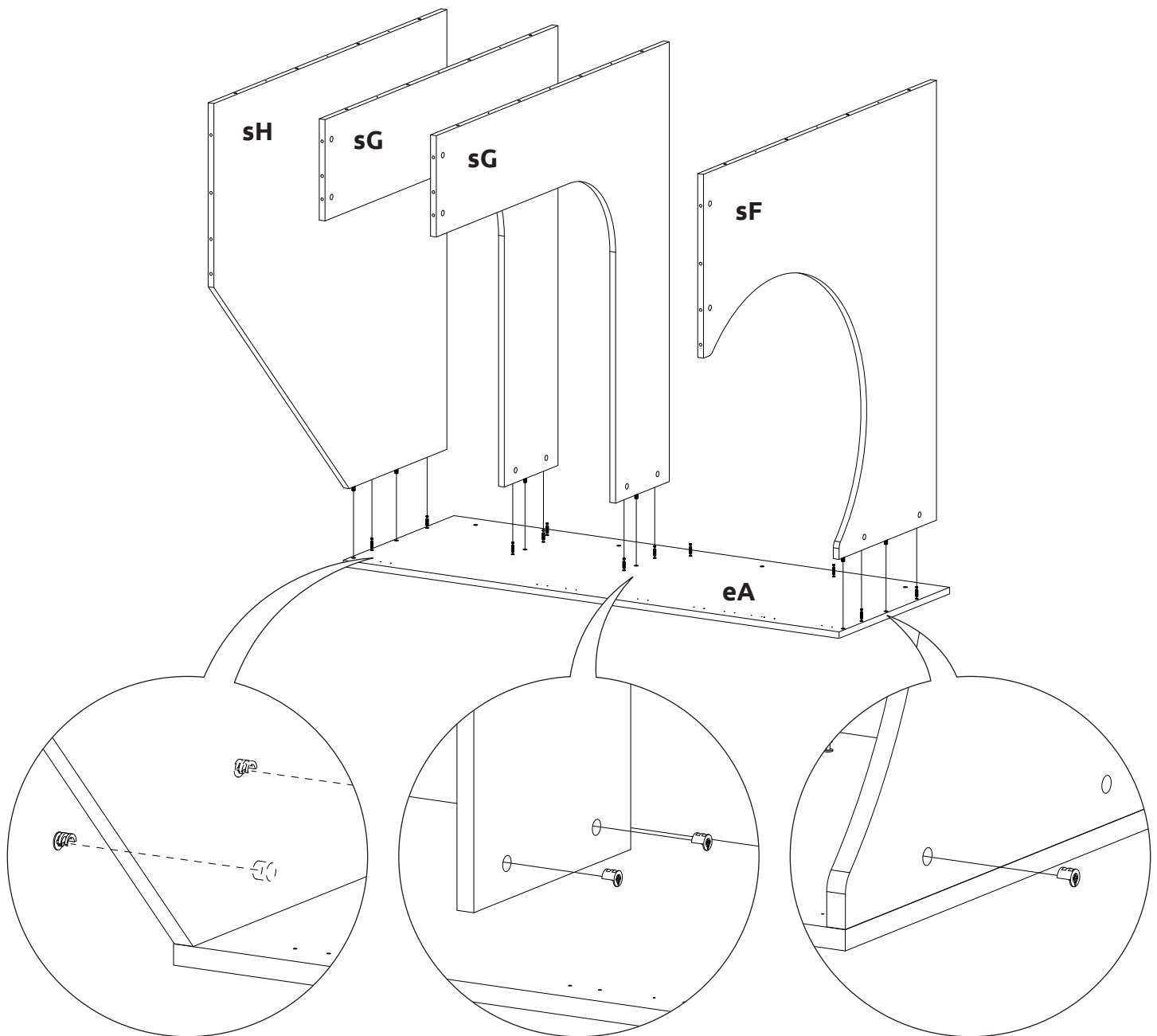

Step 18.

Insert 2 cam locks **(H)** per panel into holes in panels **(sH)**, **(sG)** and **(sF)** as shown. Do **NOT** tighten until step 26.

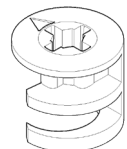

2070 & 2250 Diagonal Corner Office Assembly Guide

Step 18.

Seat 8 wooden dowels (**F**) per panel into holes in panels (**sF**), (**sG**) and (**sH**) and 4 wooden dowels (**F**) into holes in end panel (**eA**) as shown.

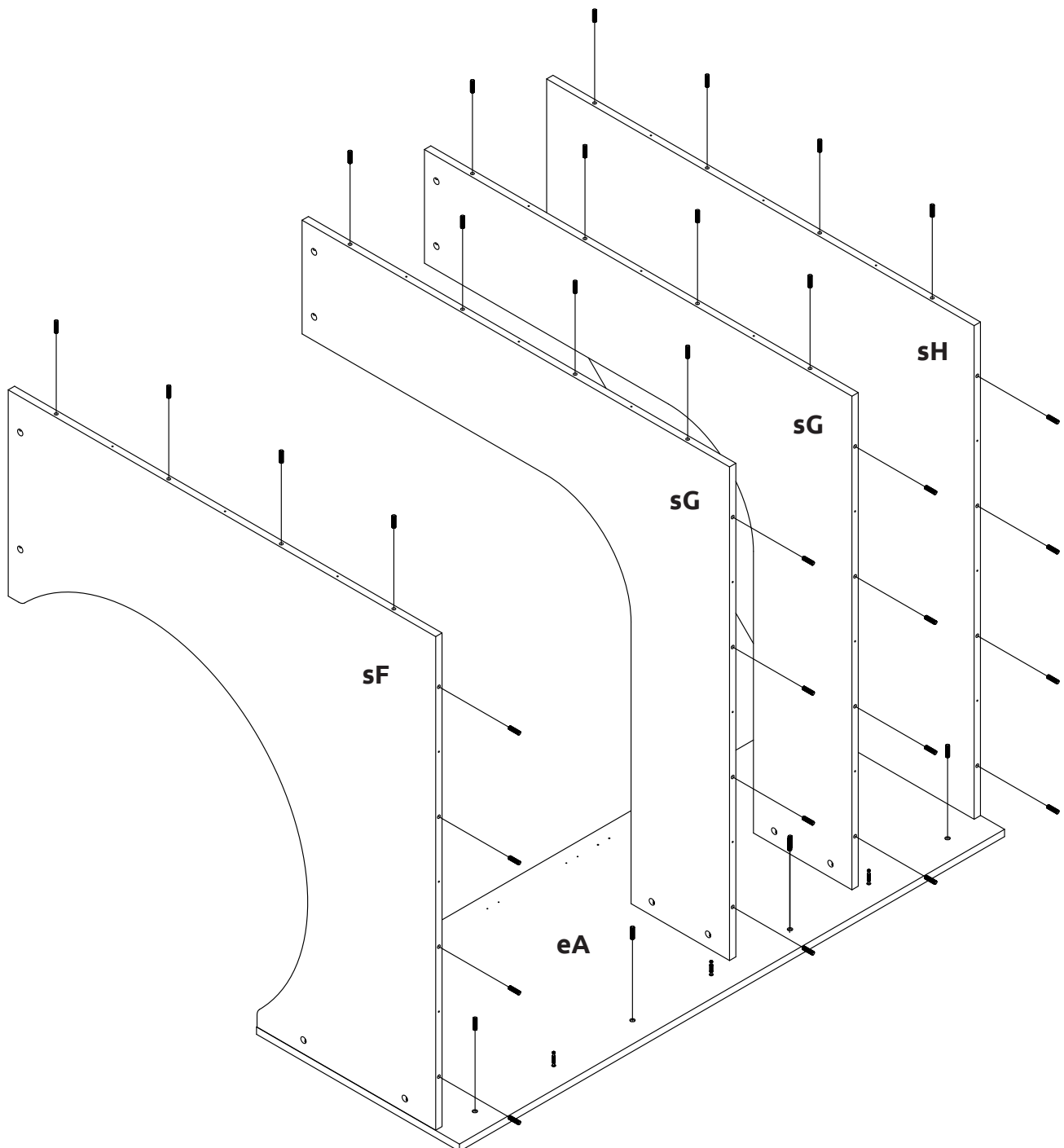

2070 & 2250 Diagonal Corner Office Assembly Guide

Step 19.

Attach back panel (**bK**) to end panel (**eA**) and panels (**sF**), (**sG**), (**sH**), using cam dowels (**W**) and wooden dowels (**F**) in positions as shown.

Once back panel (**bK**) is in position, ensure it is flush & square with bottom of end panel (**eA**).

Secure back panel (**bK**) to panels (**sF**), (**sG**), (**sH**), using 12 x 45mm screws (**P**).

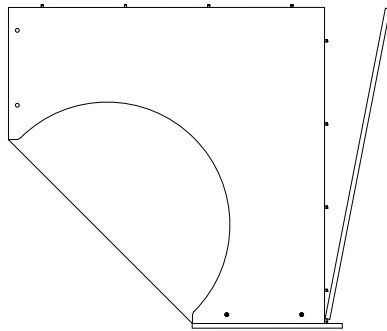

View from underside

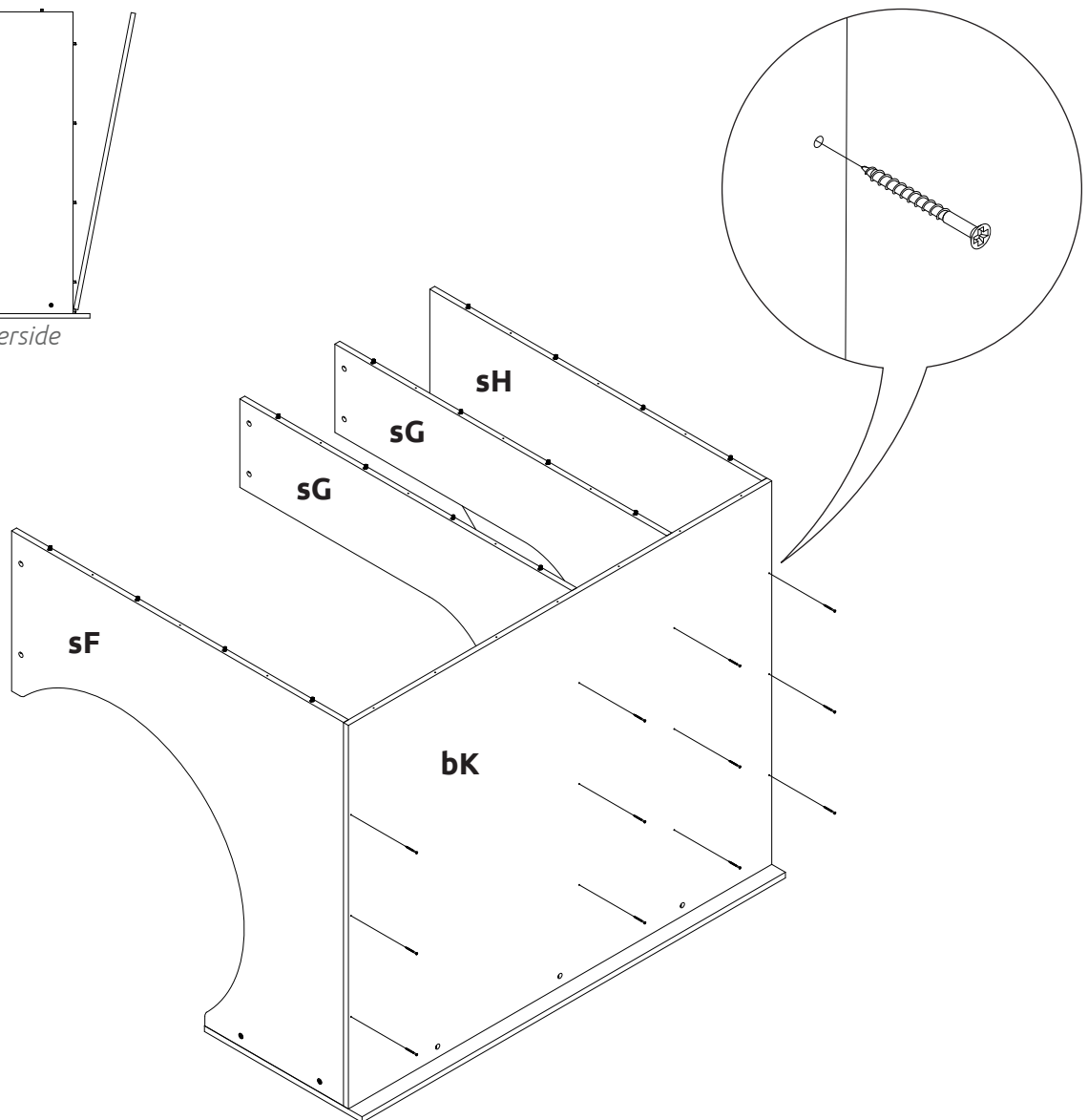

Step 20

Insert 3 cam locks (**H**) into holes in back panel (**bK**) as shown.

DO NOT tighten until step 26.

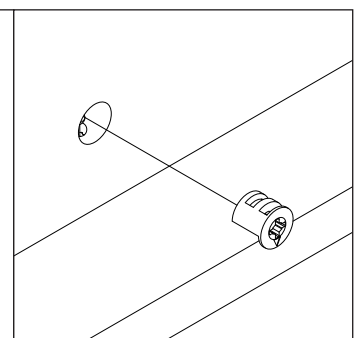

2070 & 2250 Diagonal Corner Office Assembly Guide

Step 21.

Attach back panel (**bL**) using wooden dowels (**F**) already positioned in panels (**sF**), (**sG**), (**sH**) as shown.

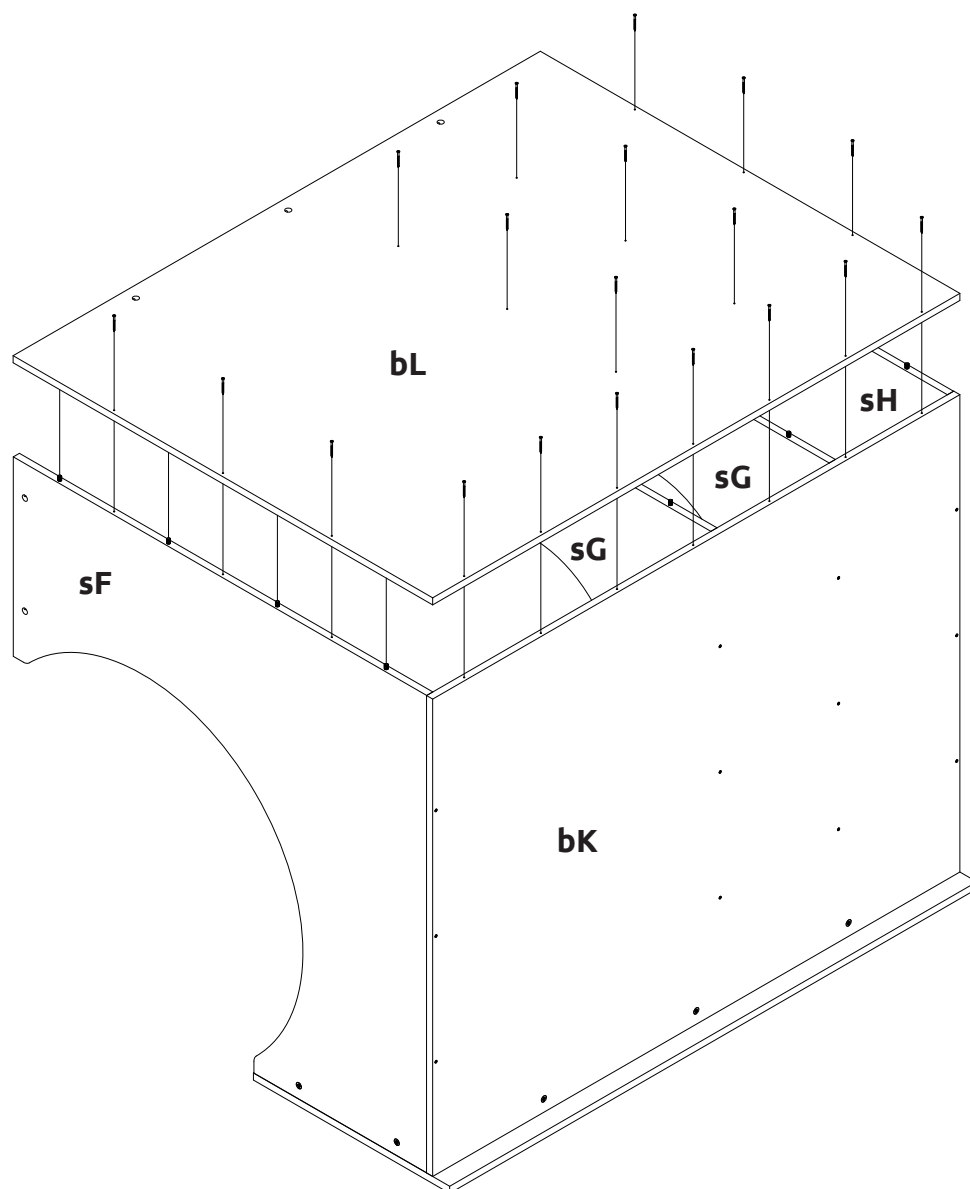

Step 22.

Secure back panel (**bL**) to back panel (**bK**) and panels (**sF**), (**sG**) and (**sH**), using 19 x 45mm screws (**P**) as shown.



2070 & 2250 Diagonal Corner Office Assembly Guide

Step 23.

Seat 2 wooden dowels (**F**) per panel into holes in panels (**sF**) and (**sH**) as shown.

Seat 1 wooden dowel (**F**) per panel into hole in panels (**sG**) as shown.

Seat 4 wooden dowels (**F**) into holes in back panel (**bL**) as shown.

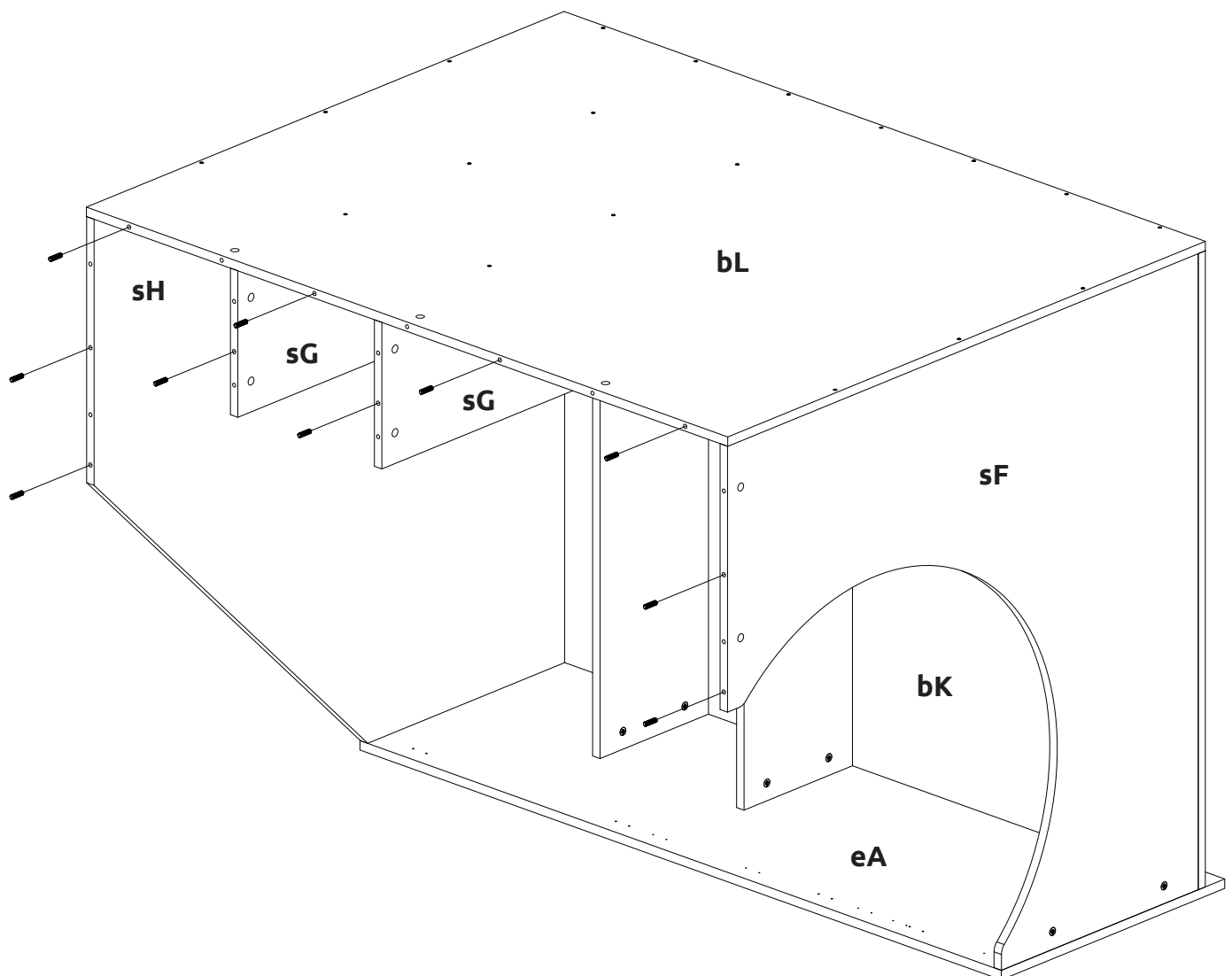

2070 & 2250 Diagonal Corner Office Assembly Guide

Step 24.

Seat 11 cam dowels **(W)** into holes in end panel **(eB)** as shown.

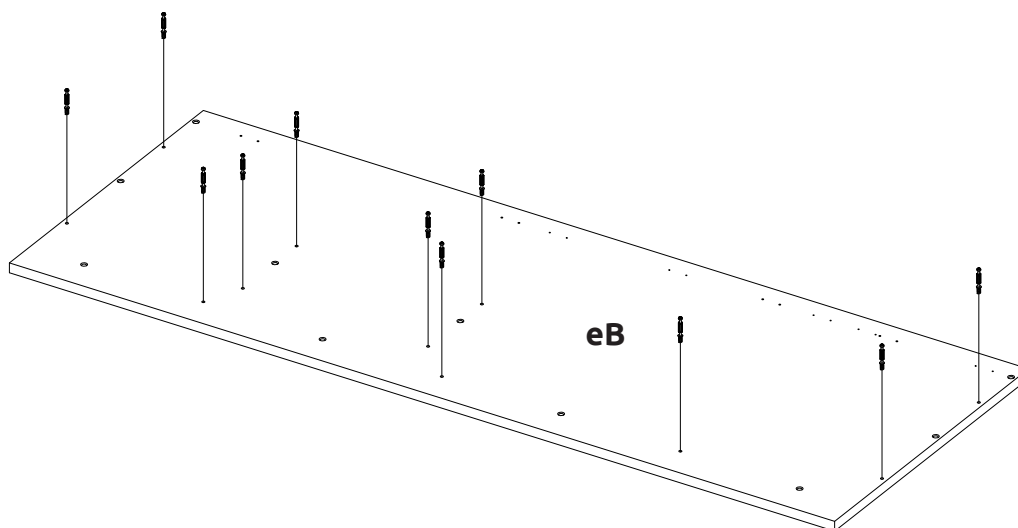
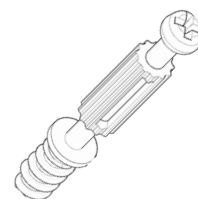

Step 25.

Attach end panel **(eB)** to back panel **(bL)** and panels **(sH)**, **(sG)**, **(sF)**, using cam dowels **(W)** and wooden dowels **(F)** in positions as shown.

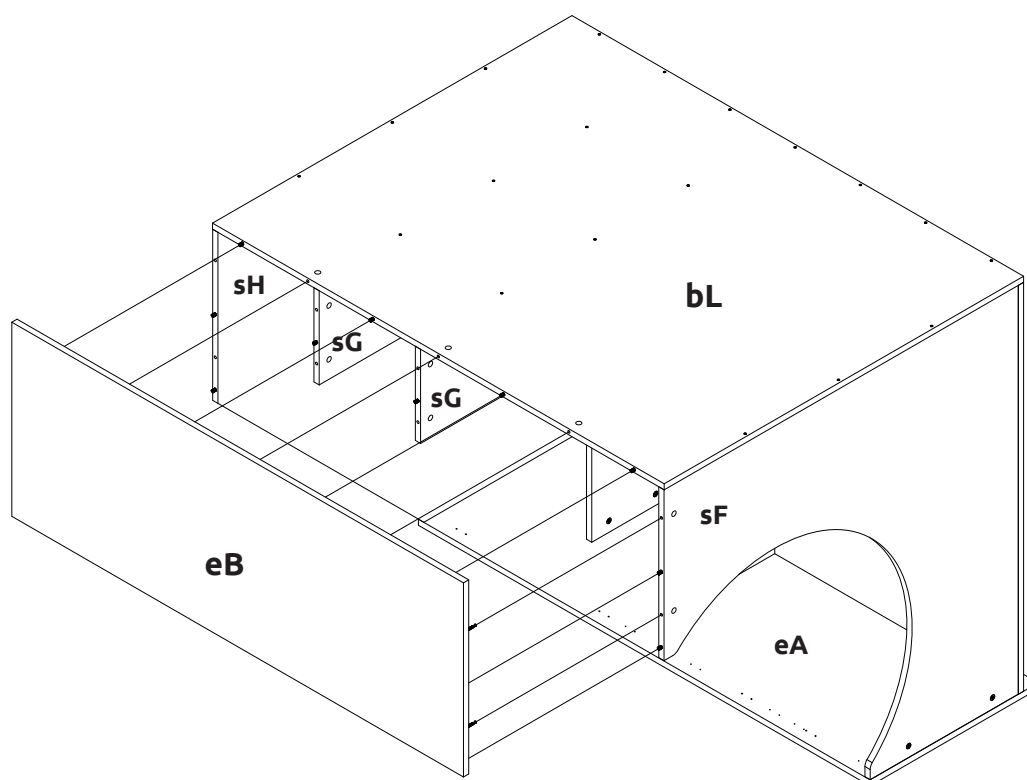

2070 & 2250 Diagonal Corner Office Assembly Guide

Step 26.

Insert 3 cam locks **(H)** into holes in back panel **(bL)** and 2 cam locks **(H)** per panel in panels **(sH)**, **(sG)**, **(sF)**.

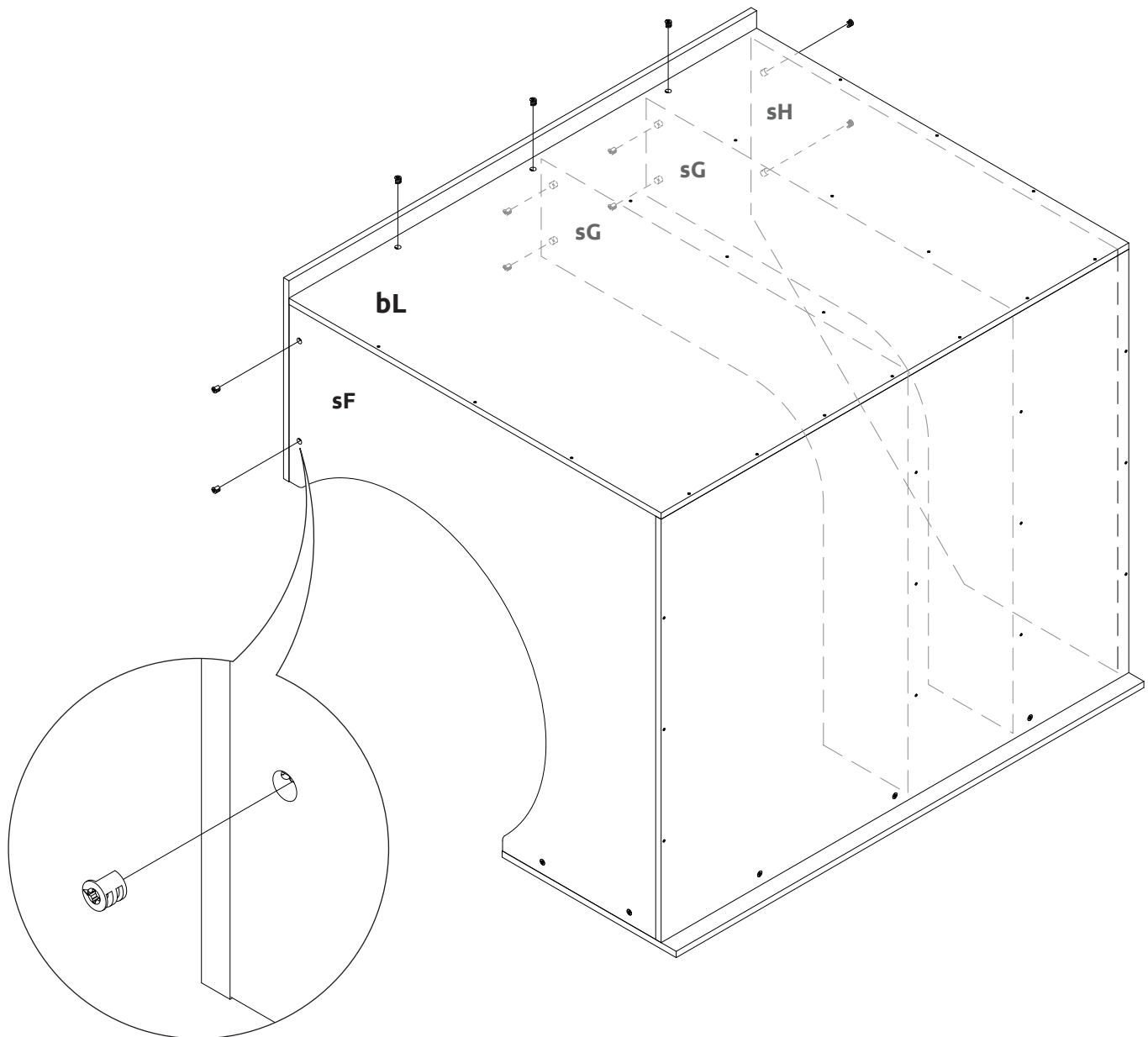
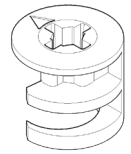

Step 26.

Hand tighten all cam locks **(H)**. This will expand cam dowels **(W)** and tighten the unit together.

2070 & 2250 Diagonal Corner Office Assembly Guide

Step 27.

Make sure the bottom unit is secured to the walls before positioning the top unit. Place the top unit on the bottom unit, ensure end panels **(eA)** and **(eB)** are flush with end panel **(eC)** and **(eD)**.

Secure top unit to bottom unit, using 10 x 30mm screws **(K)** as shown.

Screw up through panel **(sE)** in to panel **(sF)**.

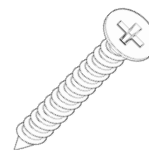

Do not screw down through panel (sF).

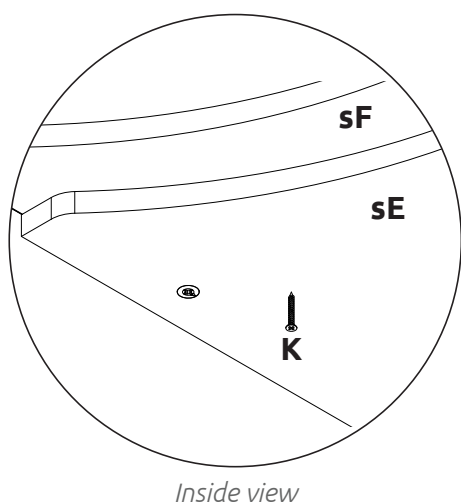
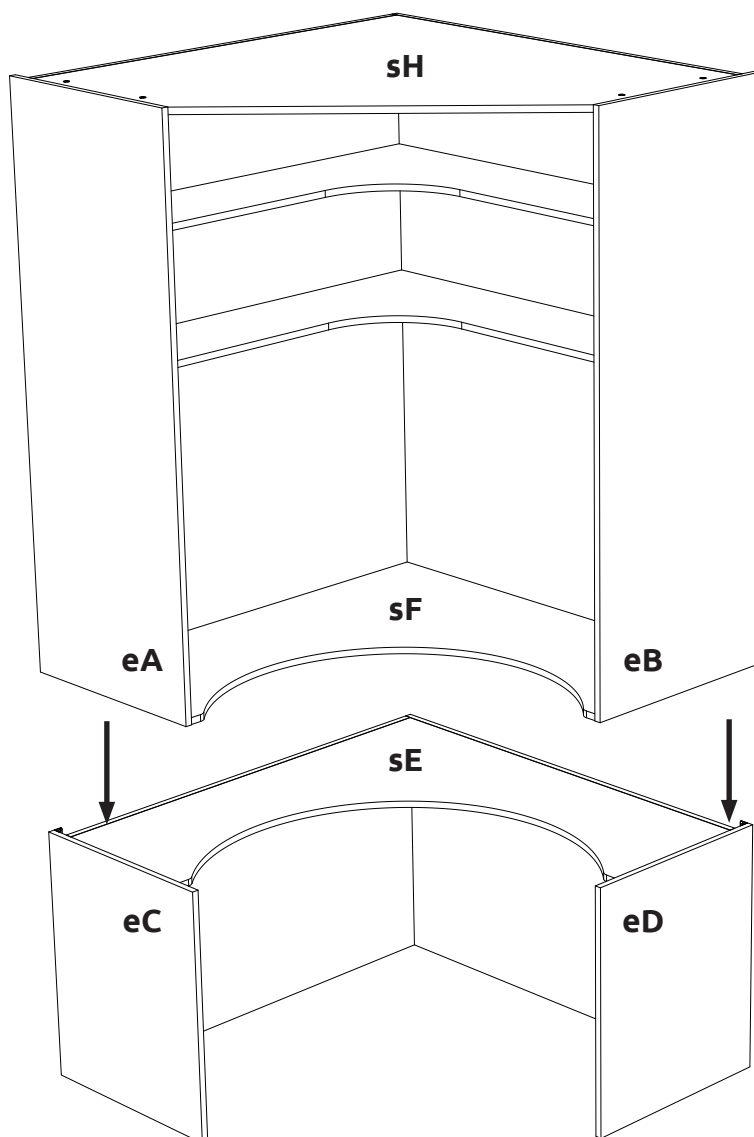
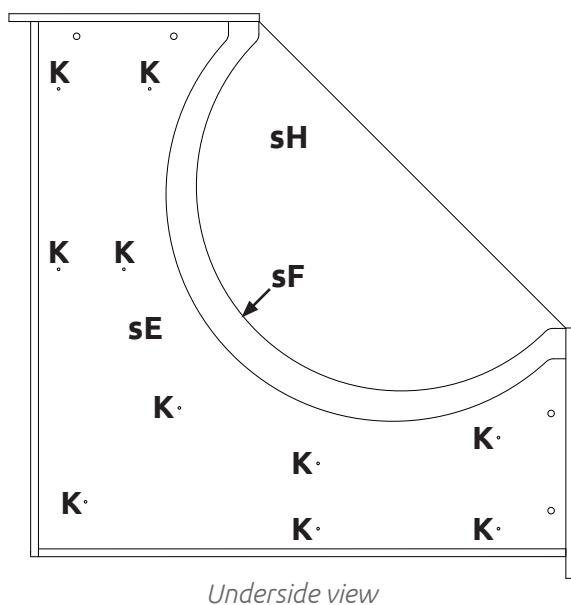

2070 & 2250 Diagonal Corner Office Assembly Guide

Step 14.

Once top and bottom units are connected. Secure the unit to wall, using **L brackets LGE**.

Use 2 x 15mm screws (**L**) to secure each of the **L brackets LGE** to the end panel at either side. Then screw through into the wall as shown.

Screws for securing to walls are not provided.

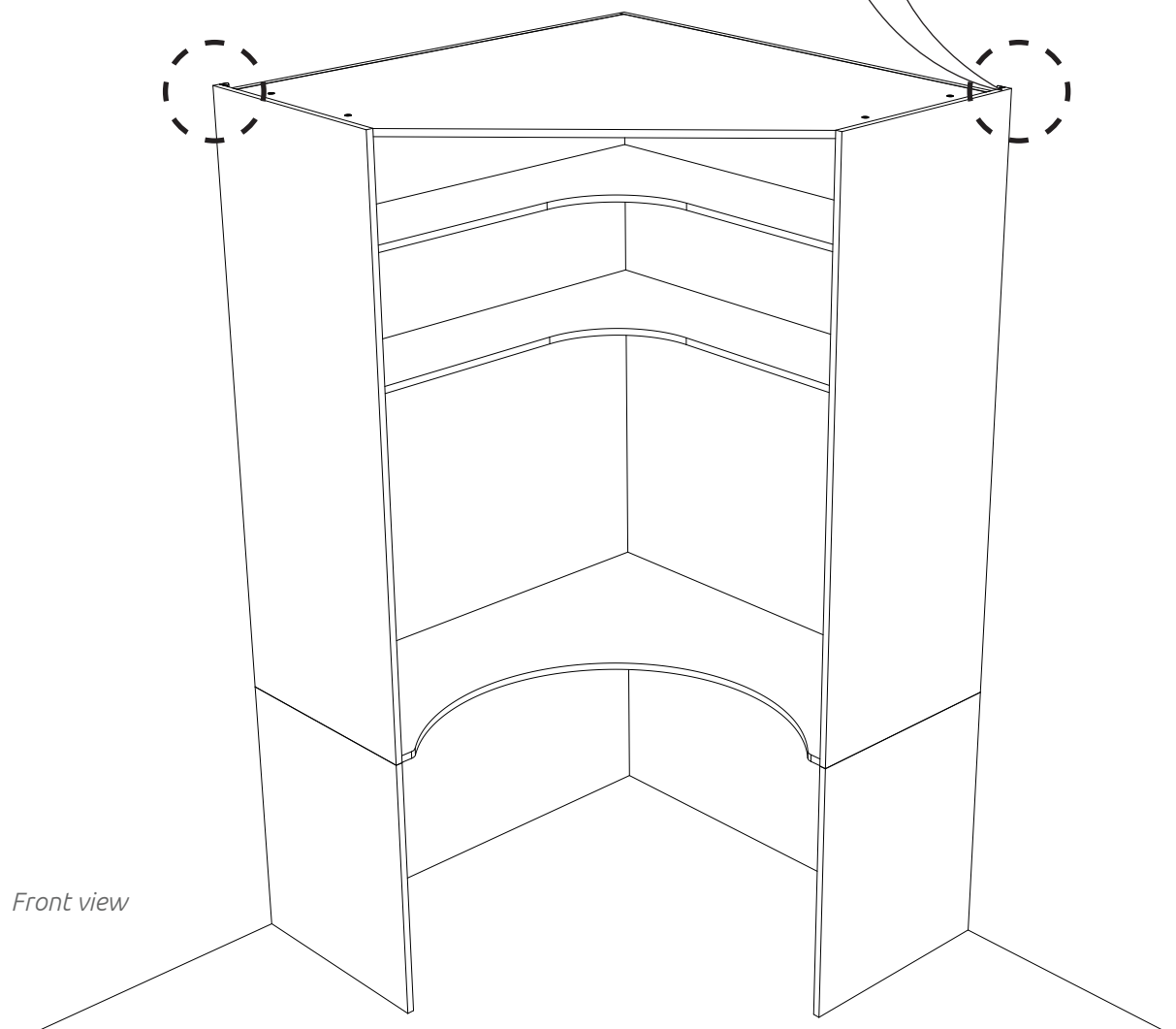
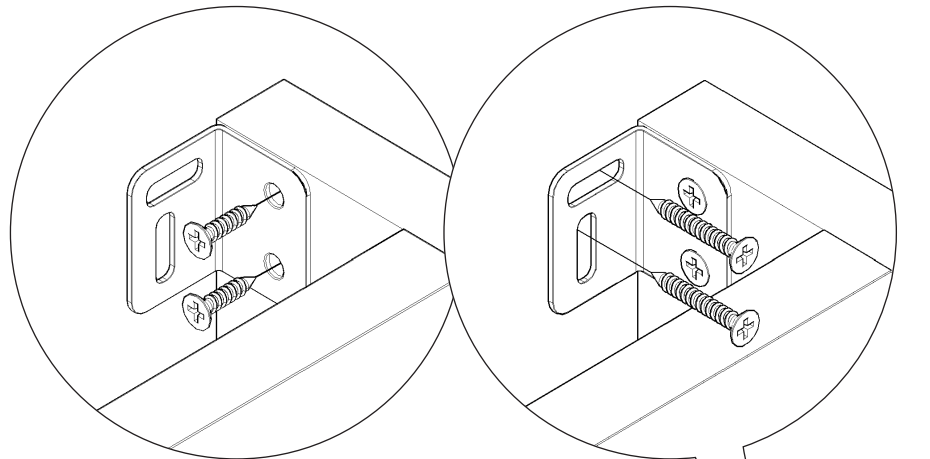
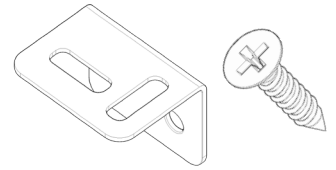

Front view

2070 & 2250 Diagonal Corner Office Assembly Guide

2250

Step 19.

Attach hinge plates onto end panel (A) or (B) to suit as shown using screws already positioned within the hinge plate. **Hinge side or sides to be mounted in accordance to Customer Specific Kitchen Plan.**

2070 - 70/30
HINGE POSITION

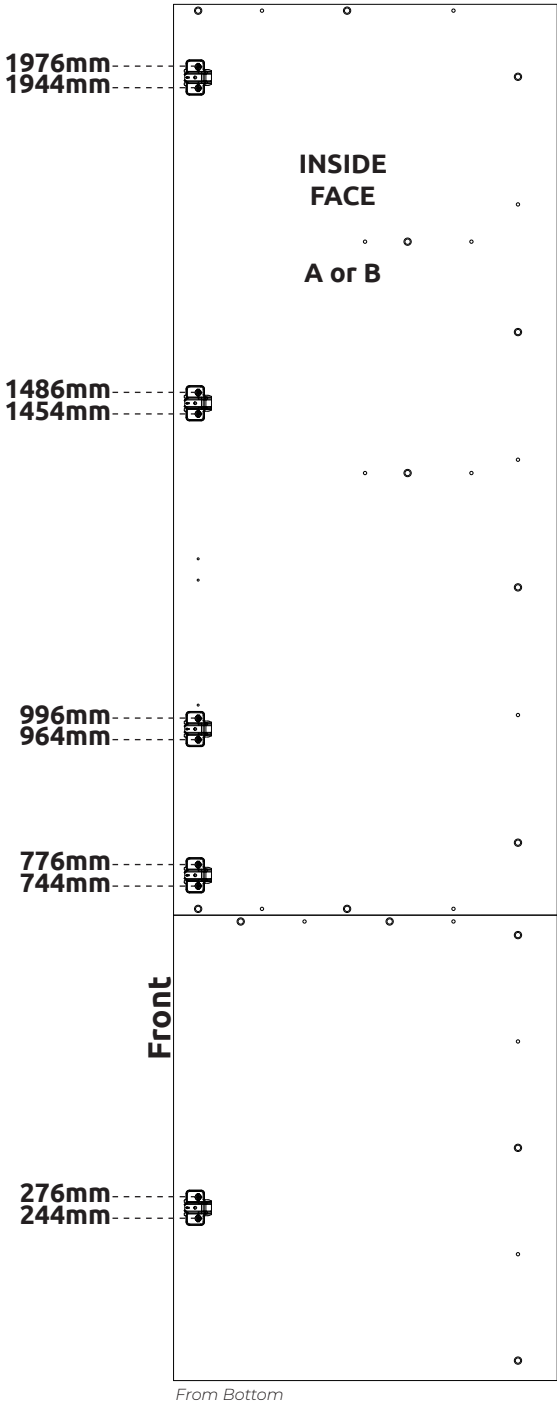

2070 - 50/50 & 1 Dr
HINGE POSITION

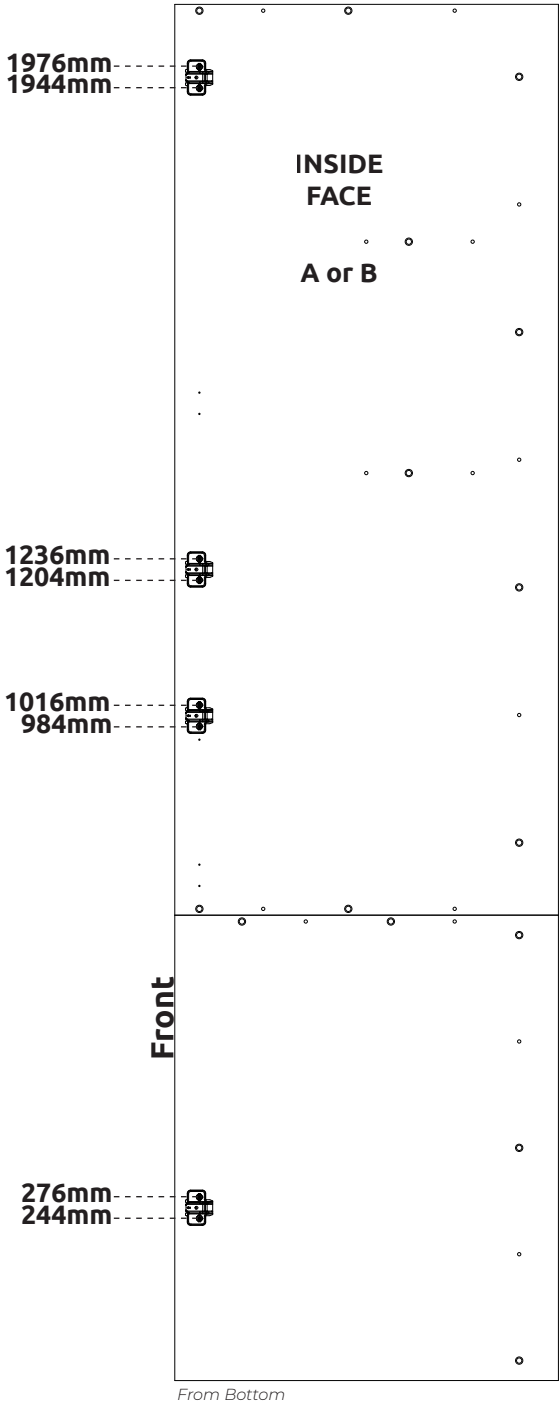

2070 & 2250 Diagonal Corner Office Assembly Guide

2250

Step 19.

Attach hinge plates onto end panel (A) or (B) to suit as shown using screws already positioned within the hinge plate. **Hinge side or sides to be mounted in accordance to Customer Specific Kitchen Plan.**

2250 - 70/30
HINGE POSITION

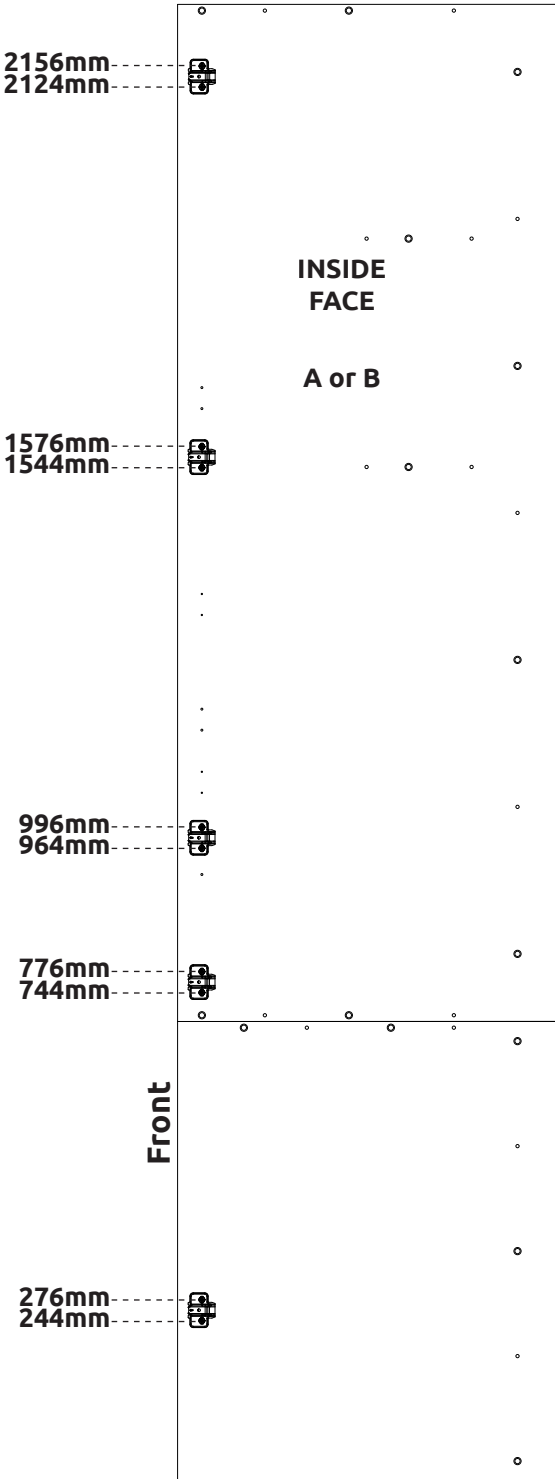

2250 - 50/50
HINGE POSITION

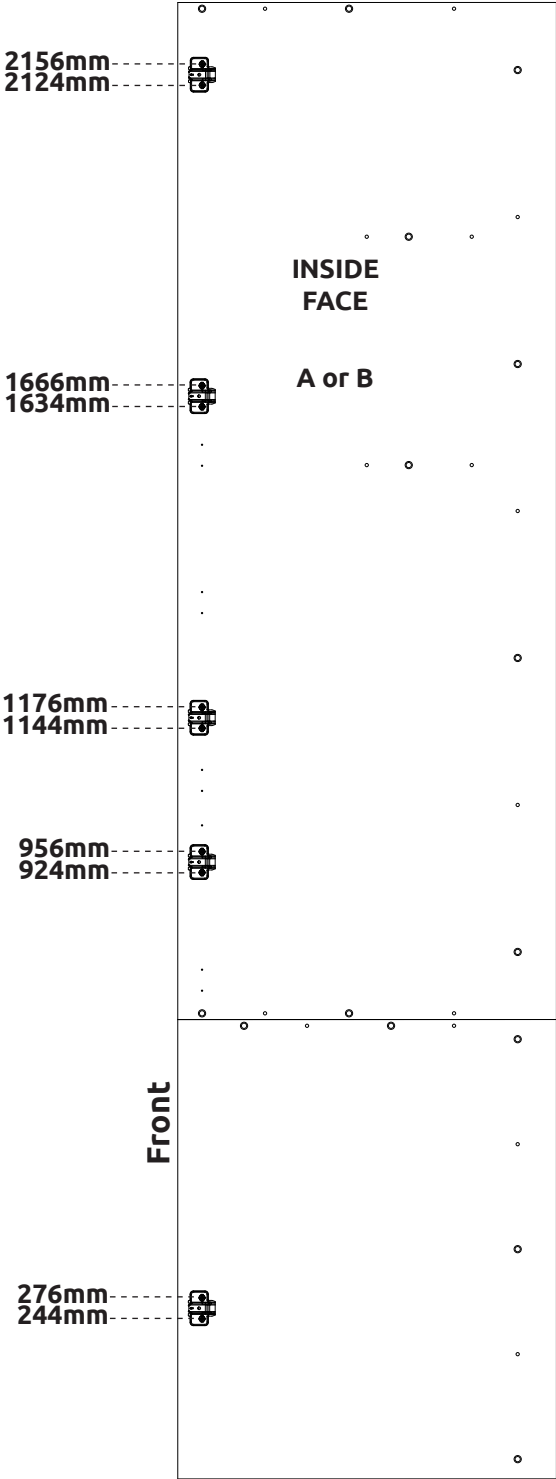

2250

Step 19.

Attach hinge plates onto end panel (A) or (B) to suit as shown using screws already positioned within the hinge plate. **Hinge side or sides to be mounted in accordance to Customer Specific Kitchen Plan.**

2250 - 1 Door
HINGE POSITION

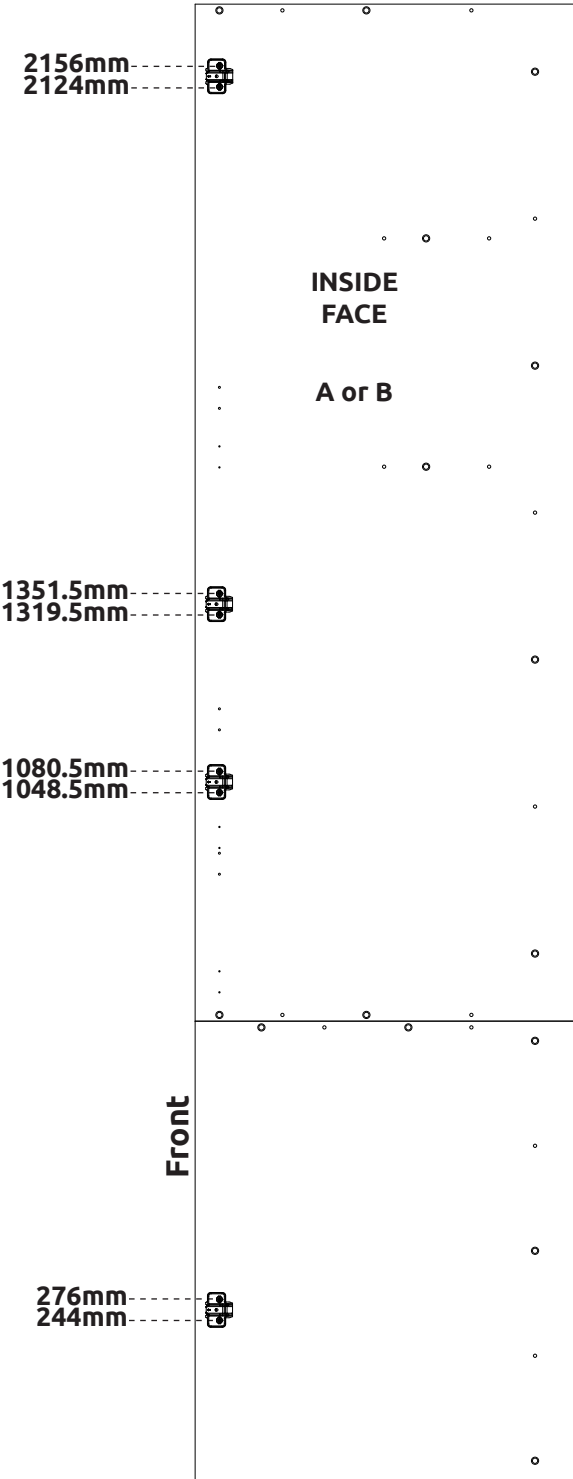

2070 & 2250 Diagonal Corner Office Assembly Guide

Hinge Attachment and Adjustment

Doors supplied in accordance to customer specific kitchen plan

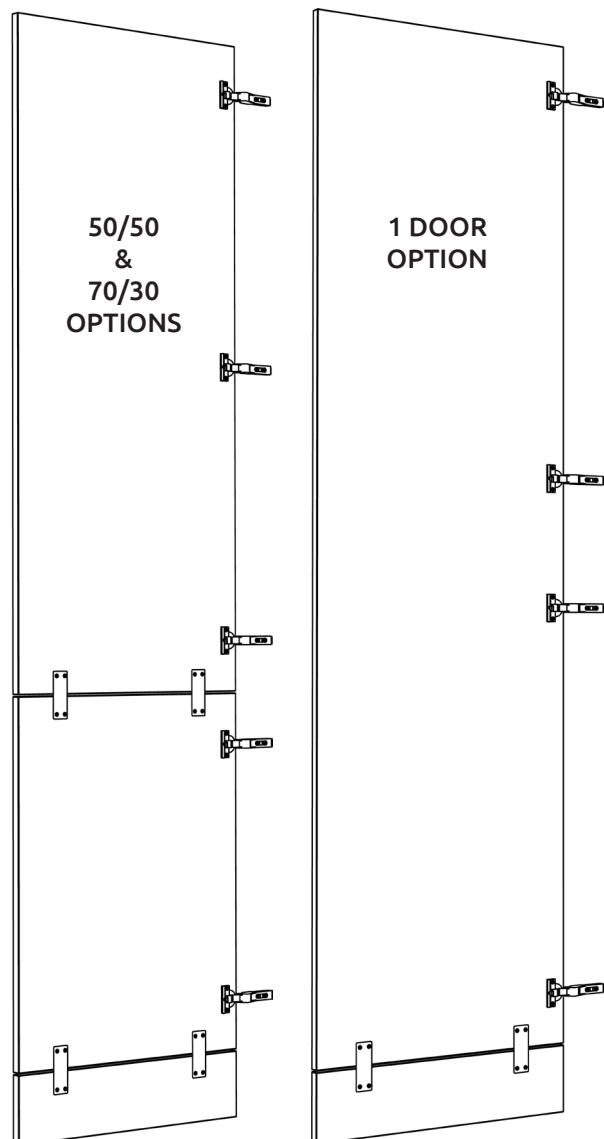

Step 1.

Insert hinges into frontal hinge holes provided, secure hinges with the 2 x screws and hinge dowels already located in the hinges.

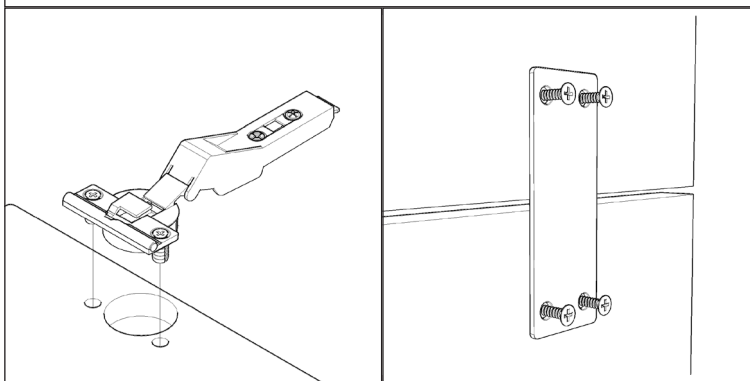
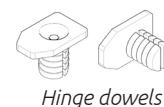

Step 2.

Align frontals and join together using 2 x fixing plates to the back of both frontals. Ensure a 4mm gap is maintained between each frontal. Screw in place using 4 x 15mm screws (L) per fixing plate.

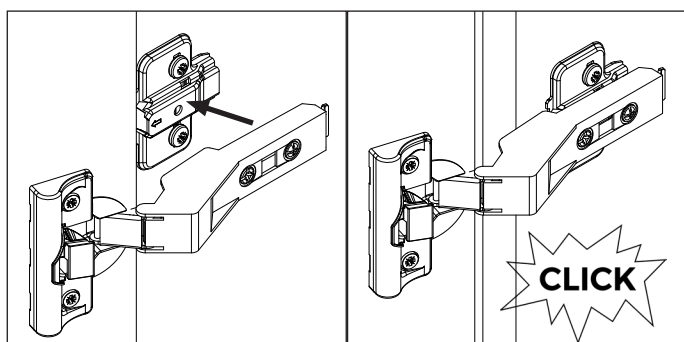
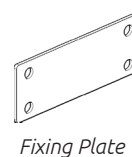

Step 3.

Attach the door to unit, clip hinges onto hinge plates and click to secure.

2070 & 2250 Diagonal Corner Office Assembly Guide

Step 4.

Adjust hinges to suit, using the highlighted screws shown.

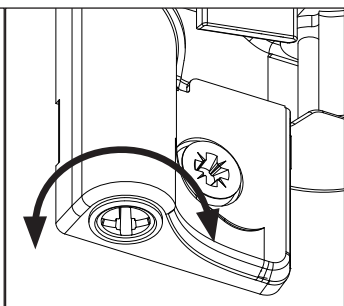
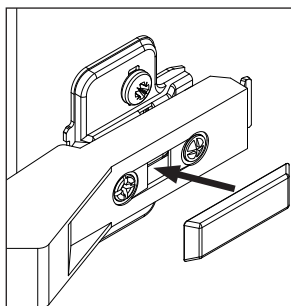
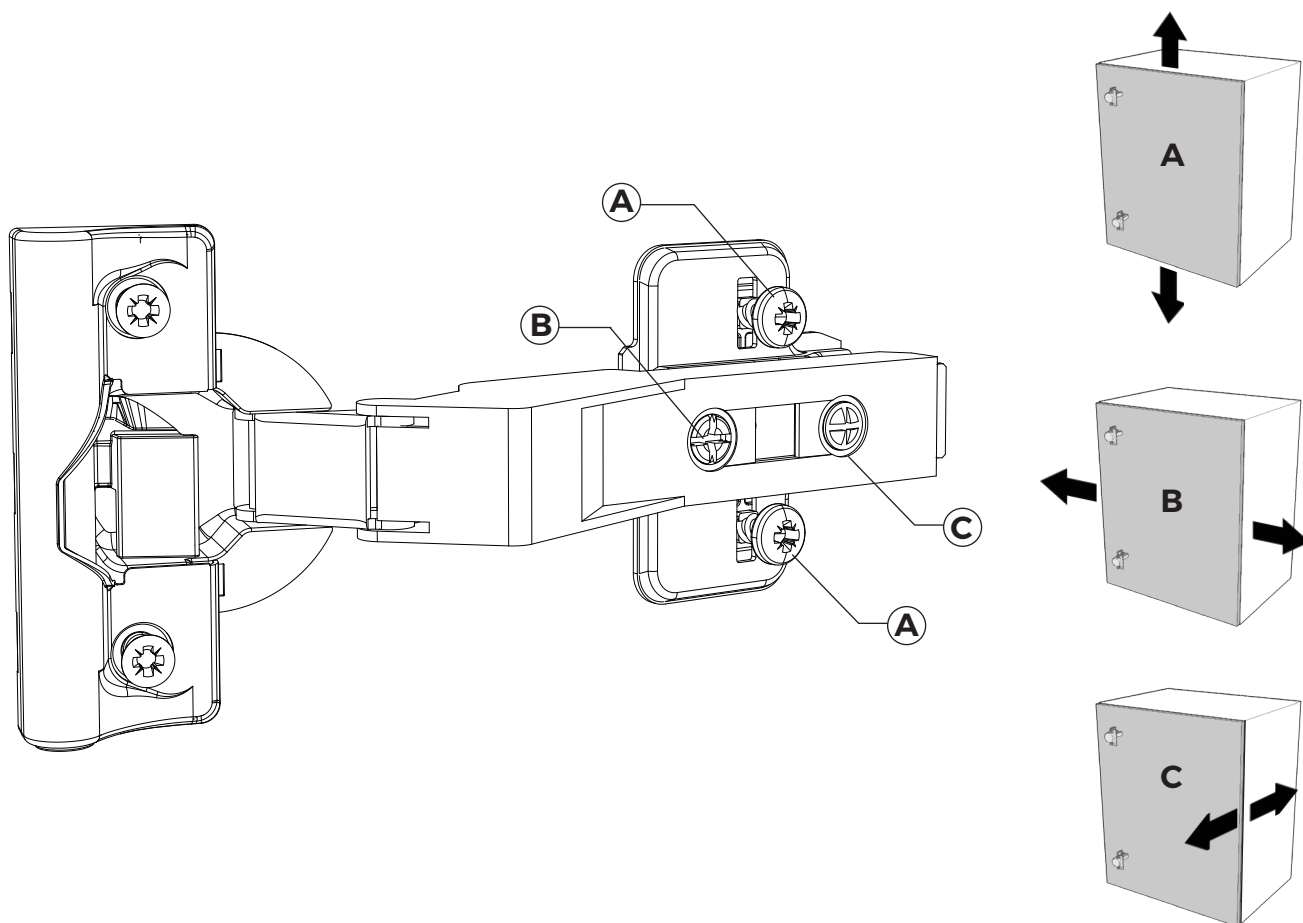

Step 5.

Fit cover caps to hinges and adjust soft-close to suit.



The top and bottom hinges **MUST** be adjusted to the **SAME STRENGTH**.