

WALL UNIT

700 - 800 Tall 2 Door

Assembly Guide

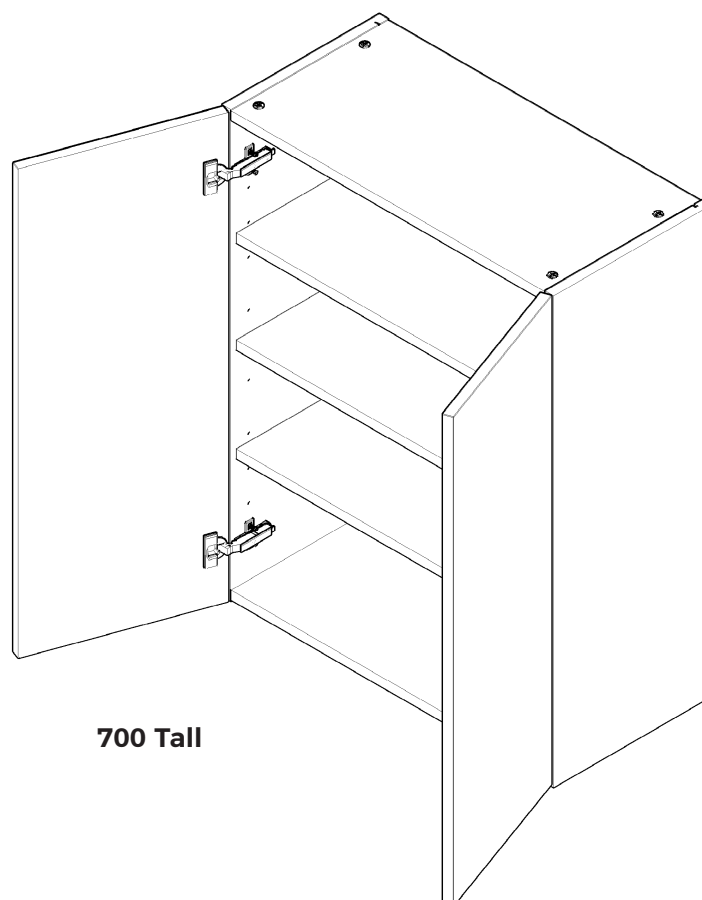

700 Tall

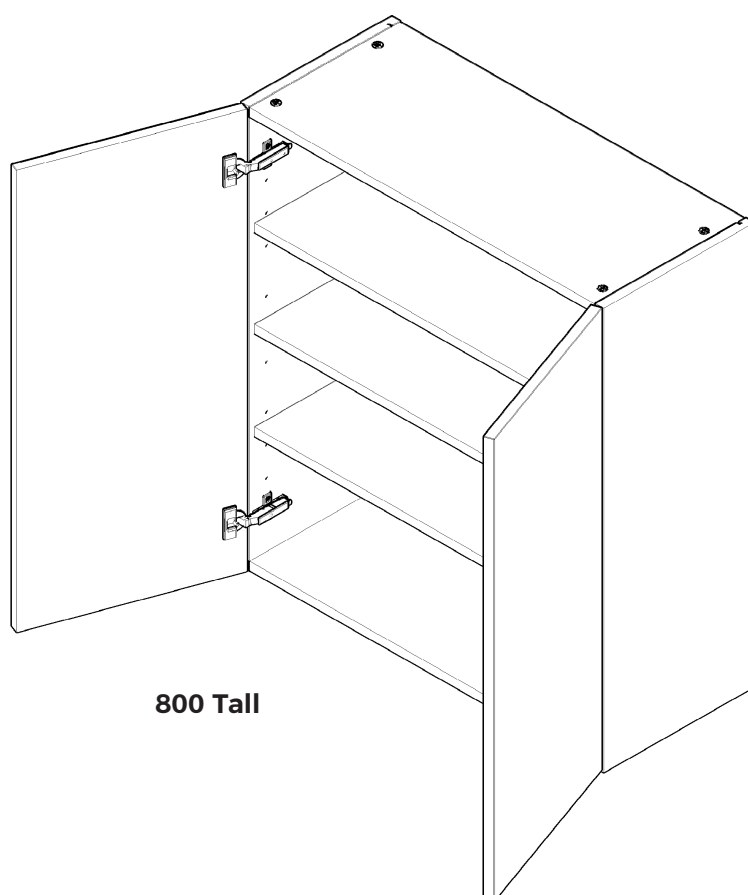

800 Tall

wren
KITCHENS

WALL UNIT

700 - 800 Tall 2 Door

Assembly Guide

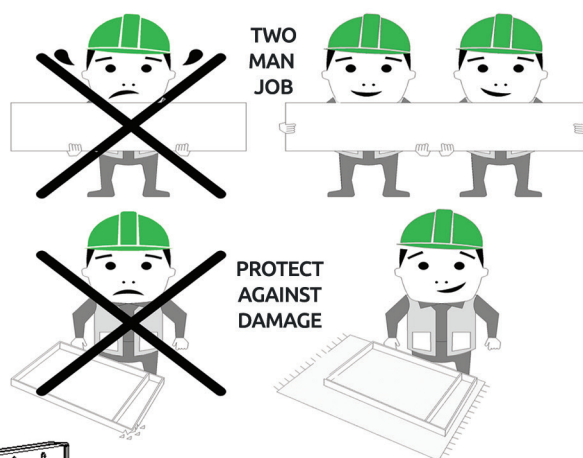

BEFORE YOU START

INSTALLATION
SHOULD BE
PERFORMED BY A
COMPETENT
PERSON ONLY.

THIS PRODUCT COULD
BE DANGEROUS
IF INCORRECTLY
INSTALLED

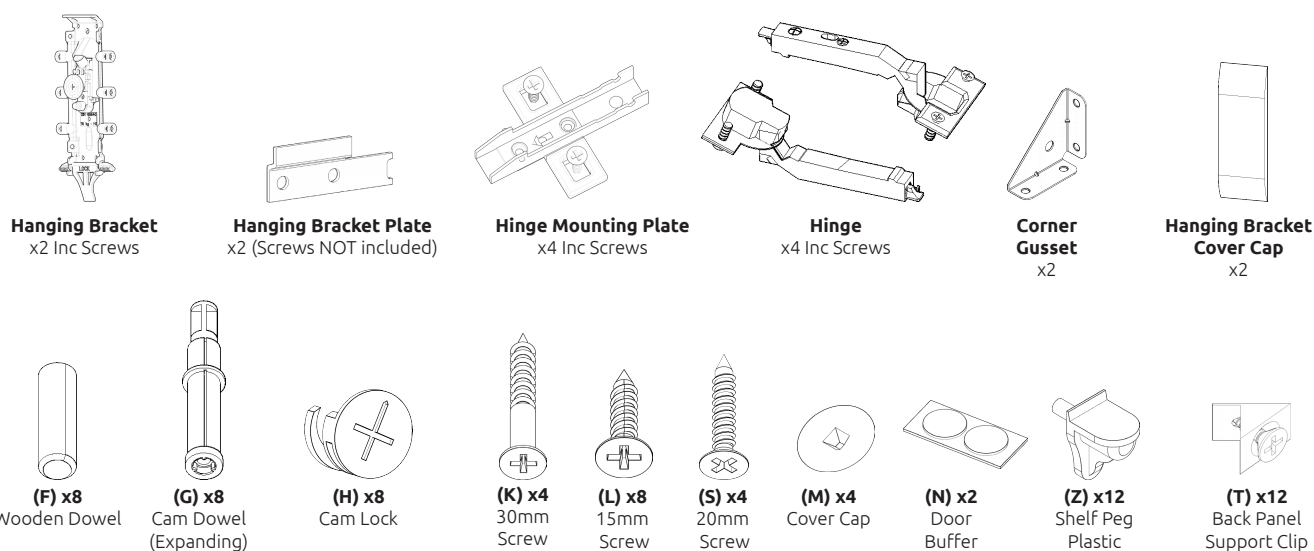
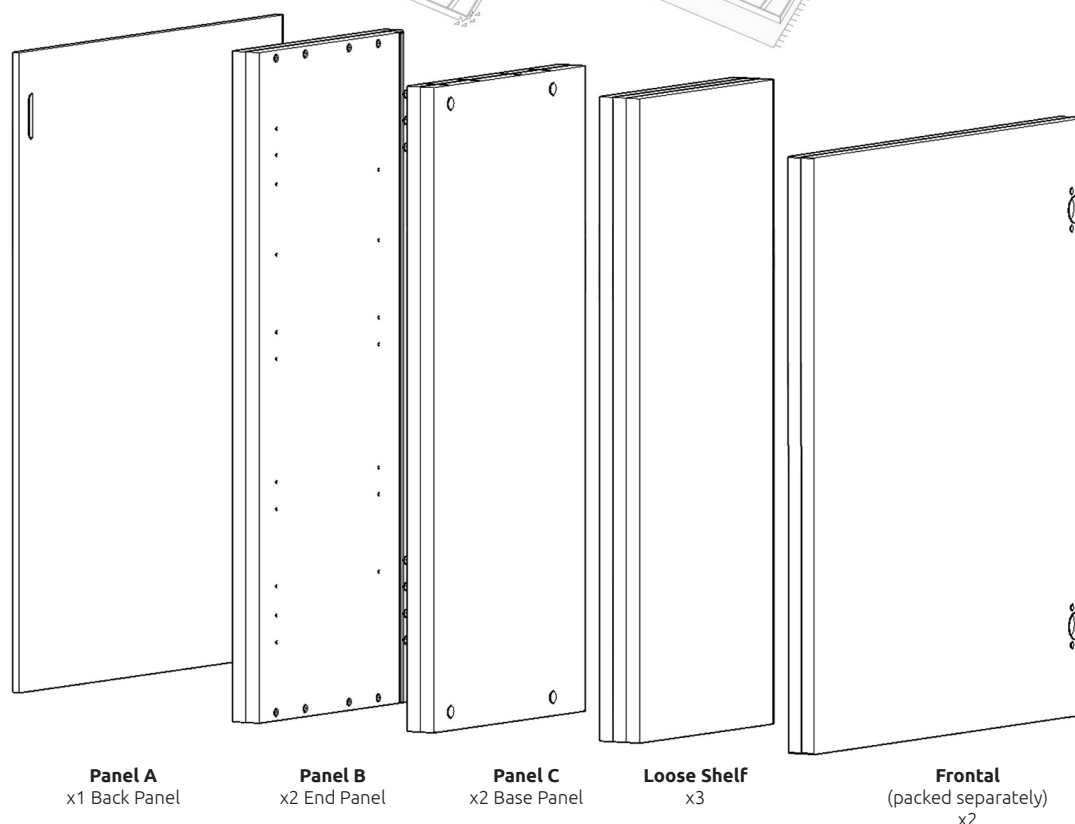

REQUIRED TOOLS

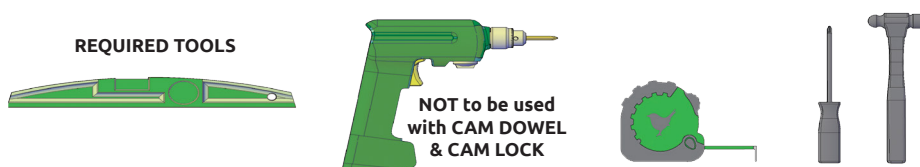

WALL UNIT

700 - 800 Tall 2 Door

Assembly Guide

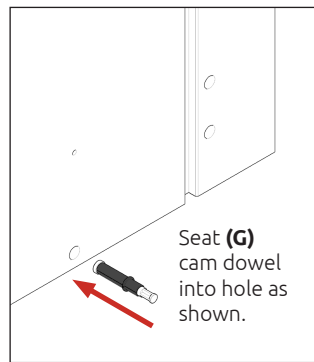

Step 1.
Seat dowel (F) into holes in end panel (B) as shown.

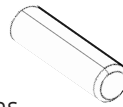

Step 2.
Seat cam dowel (G) into holes in end panel (B) as shown.

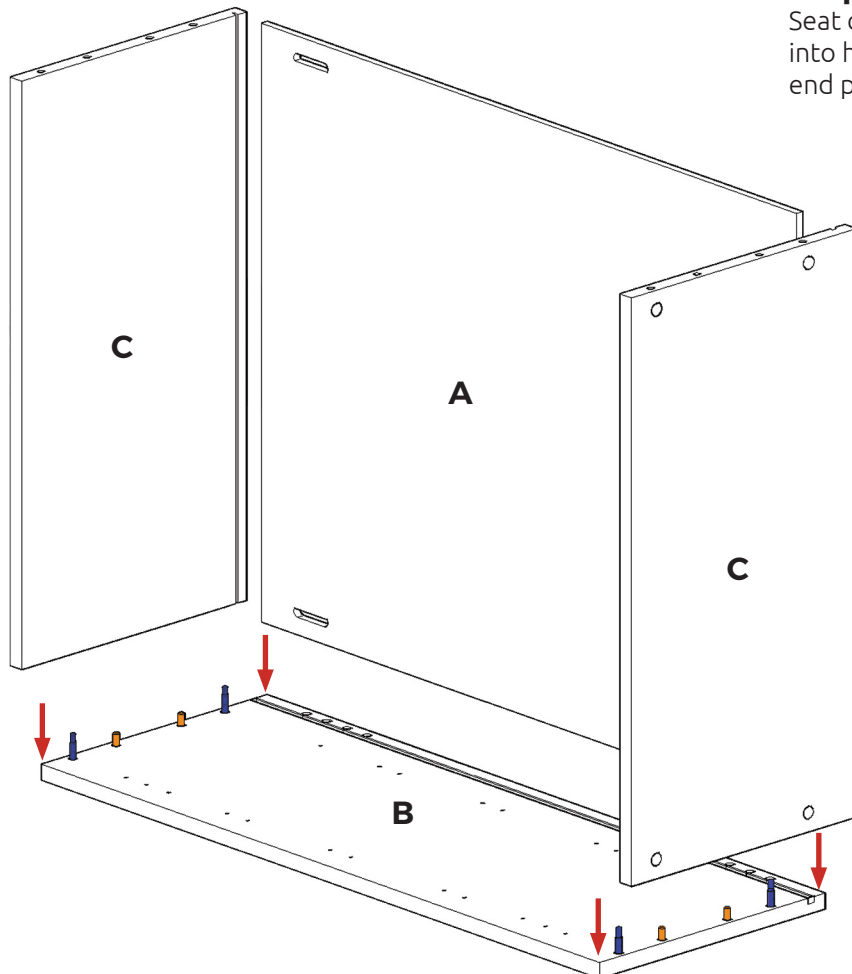
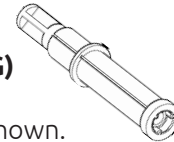

Step 3.
Carcass Construction
Attach panels x2 (C) to panel (B), using cam dowels (G) & cam locks (H) (in blue), and also using dowels (F) (in orange) in positions as shown.

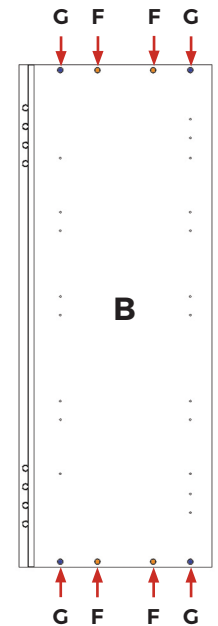

Dowel (F) & Cam Dowel (G) location detail

Step 4.
Slide panel (A) into the groove of panels (B) and x2 (C).



All **Cam Locks (H)** are to be positioned facing the outside of the unit carcass, for ease of tightening.

Do **not** use power tools with cam dowel (G) or cam lock (H)

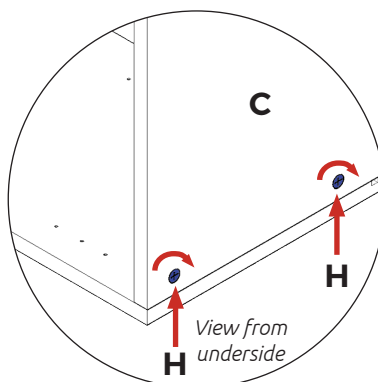
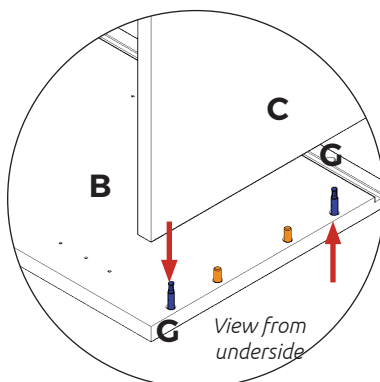

Step 5.

Insert cam lock (H). Hand tighten all cam locks (H), this will expand the cam dowels (G) and tighten the unit together.



WALL UNIT

700 - 800 Tall 2 Door

Assembly Guide

Step 6.

Seat dowel (F) into holes in both panels (B) as shown.



Step 7.

Seat cam dowel (G) into holes in both end panels (B) as shown.

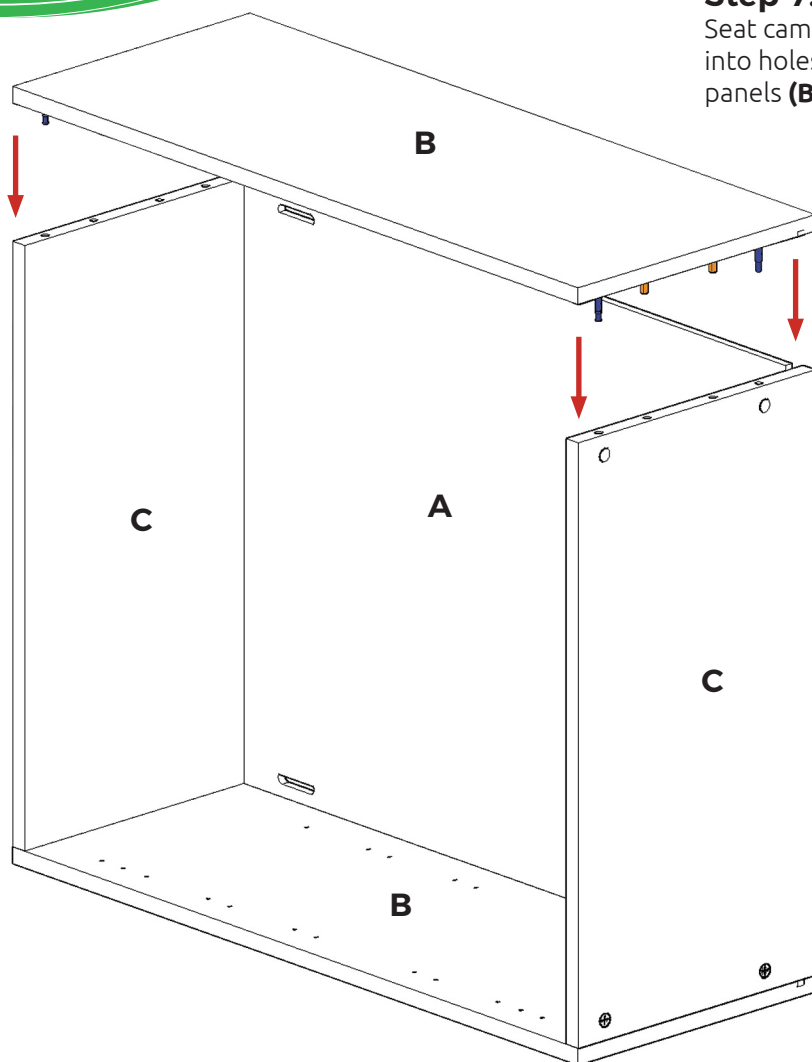
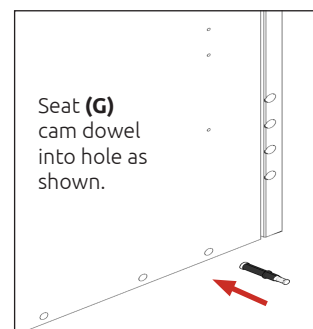
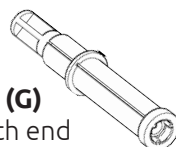

Step 8.

Carcass Construction
Attach panel (B) to panels (C) using cam dowels (G) & cam lock (H) (in blue) and also using dowels (F) (in orange) in positions as shown. Ensure panel (A) is seated into the groove of panel (B).

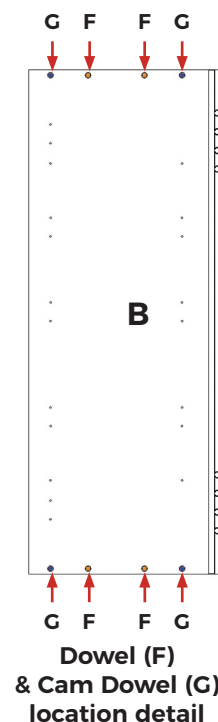

All **Cam Locks (H)** are to be positioned facing the outside of the unit carcass, for ease of tightening.

Do **not** use power tools with cam dowel (G) or cam lock (H)

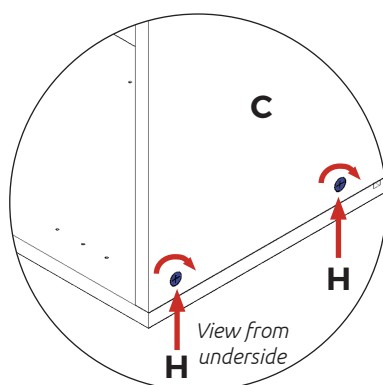
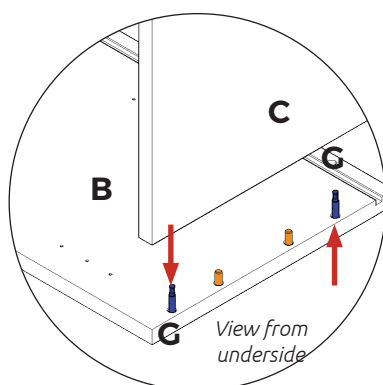

Step 9.

Insert cam lock (H). Hand tighten all cam locks (H), this will expand the cam dowels (G) and tighten the unit together.



WALL UNIT

700 - 800 Tall 2 Door

Assembly Guide

Step 10.

Ensure carcass is square.

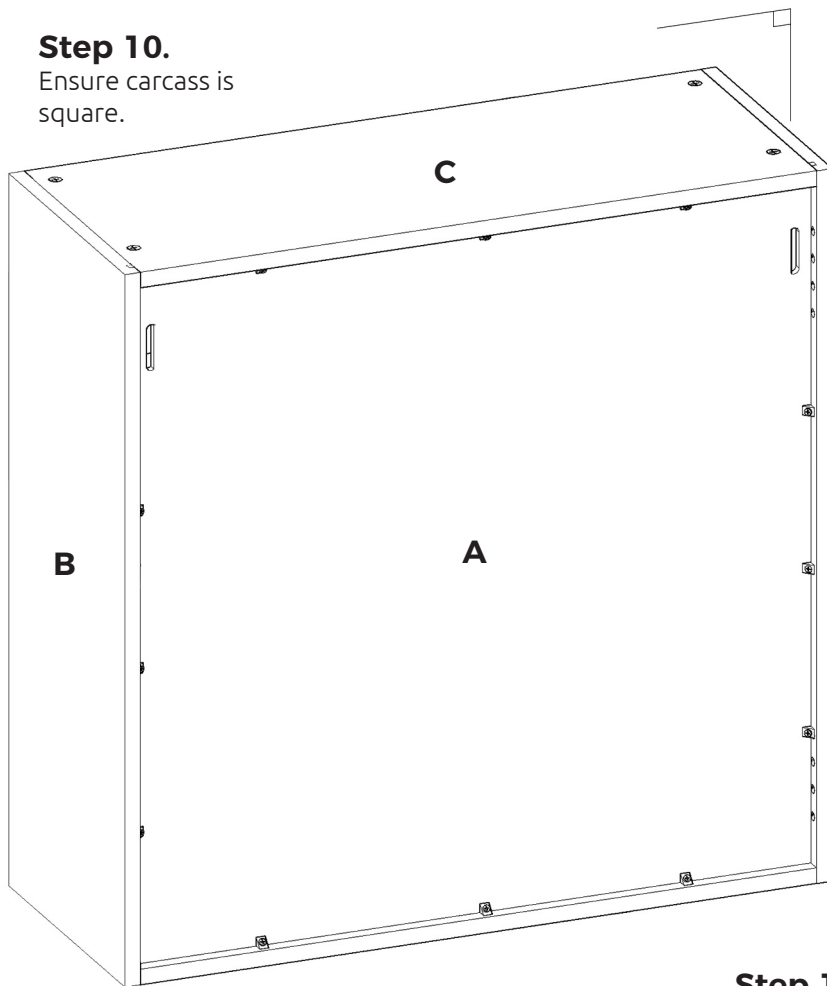

Step 11.

Slide the back panel clips (T) into the groove of both panels (B) & (C)s. The back panel clips (T) should be evenly spaced as shown and positioned to allow the hanging bracket and corner gussets to be fitted. Once in place, tighten screw.

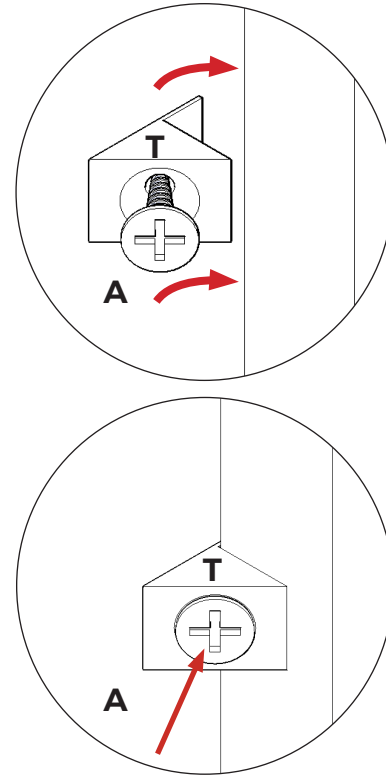

Step 12.

Hinge Mounting Plates
Attach hinge mounting plates onto both end panels (B) in locations shown using screws (L) which are already positioned within the hinge plates.

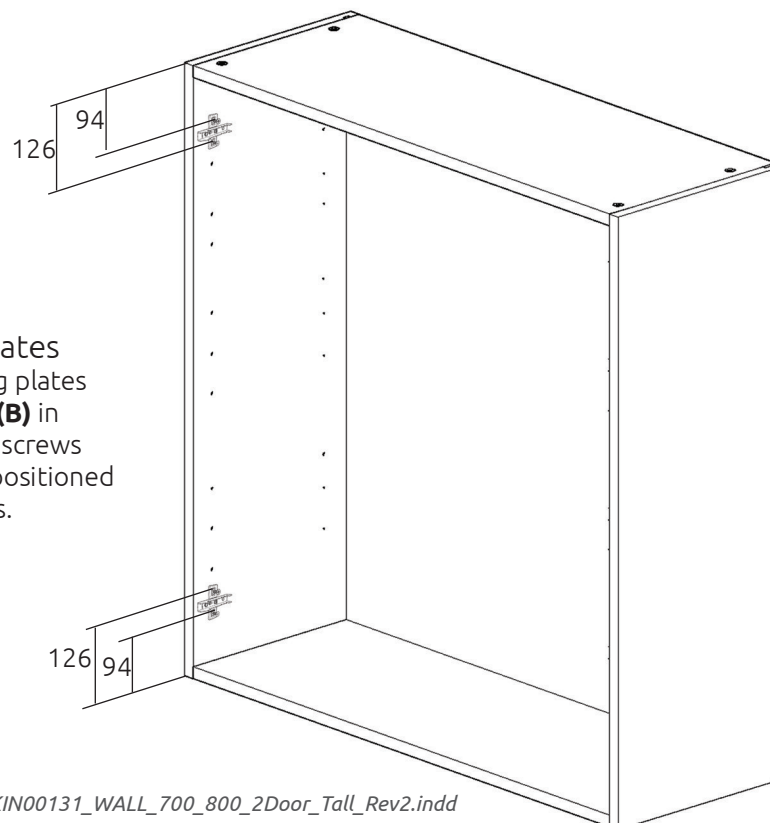

WALL UNIT

700 - 800 Tall 2 Door

Assembly Guide

Step 13.

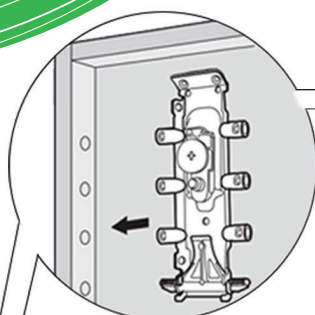

Step 13a.
Insert Hanging
Bracket into pre-drilled
holes

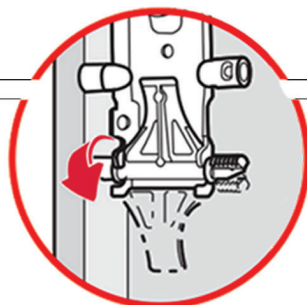

Step 13b.
Rotate locking
lever 180 degrees

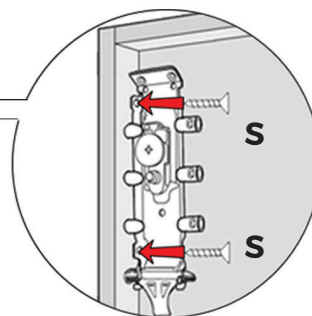

Step 13c.
Secure with provided
2 x 20mm screws (**S**) per bracket

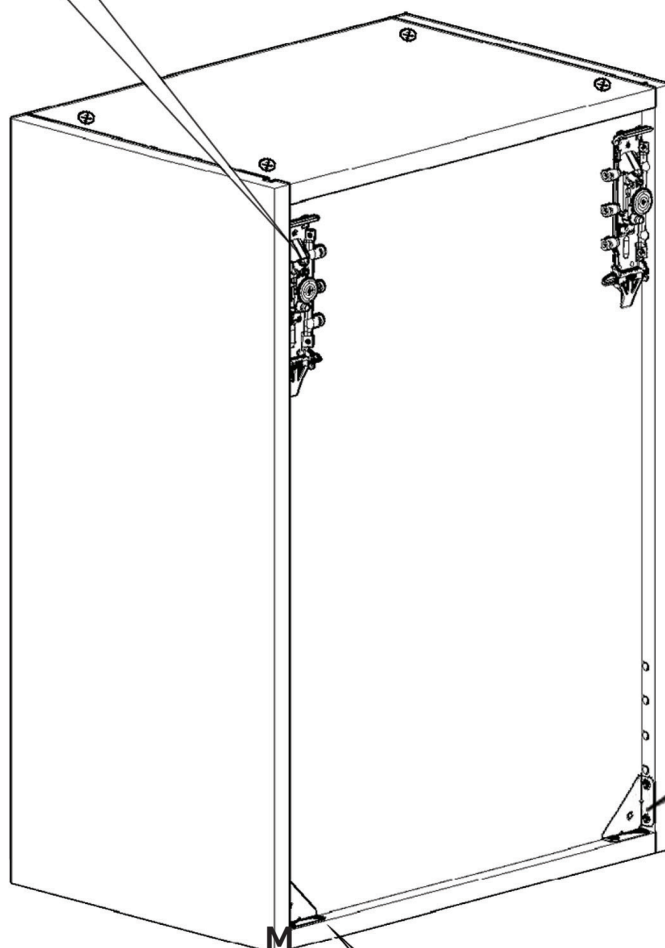

Step 14.

Secure corner gussets to the bottom left and right hand side of the wall unit using 4 x 15mm screws (**L**) per plate.

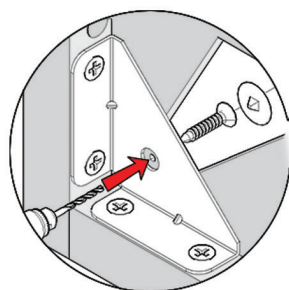
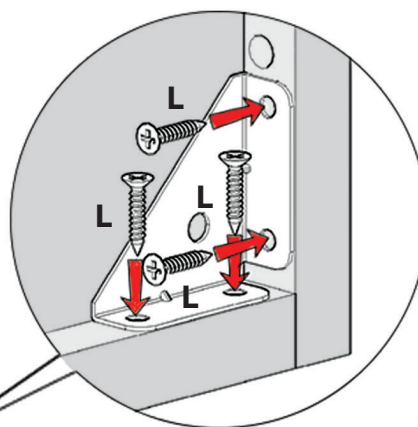

Step 15.

Drill a small pilot hole through the centre of the corner gussets. Use this hole at the end of the process to screw through and into the wall. Cover the screw heads using the cover caps (**M**) provided. **Screws for fixing to walls are not provided as these vary depending on your wall material and construction. Ensure appropriate fixings for wall constructions are used.**

WALL UNIT

700 - 800 Tall 2 Door

Assembly Guide

Step 16.

Measure appropriately and attach the 2 x hanging bracket plates onto the wall screwing through the provided holes into your wall. Screws for fixing to walls are not provided as these vary depending on your wall material and construction.

Ensure appropriate fixings for wall construction are used. Hang the cabinet using the brackets to hook onto the plate as shown below.

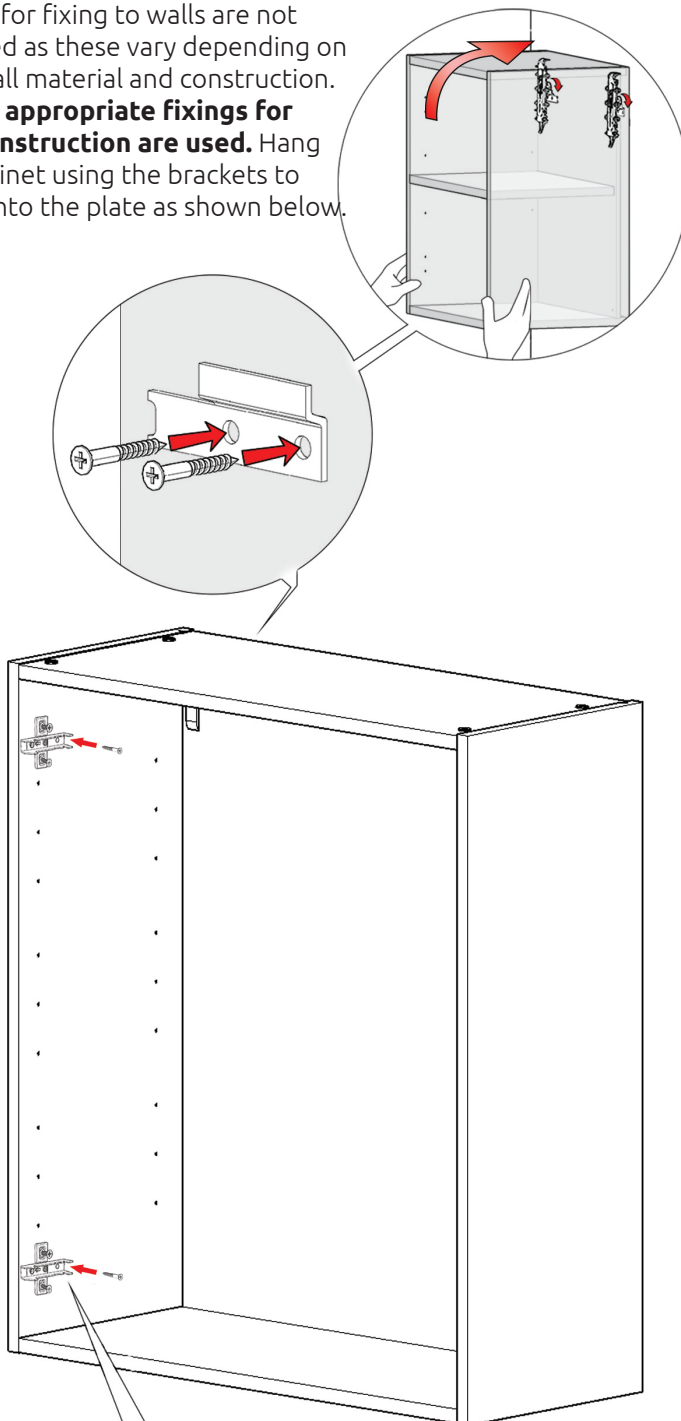

Step 17a.

Rotate the screw clockwise to move the cabinet up. Anti-clockwise for down.

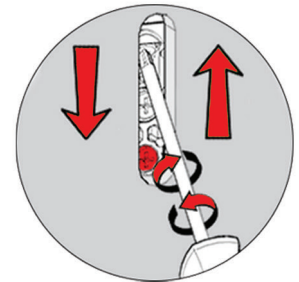

Step 17b.

Adjust the depth using centre screw.

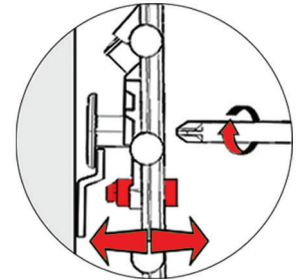

Step 17c.

Screw the red screw until it touches the plate to lock in position.

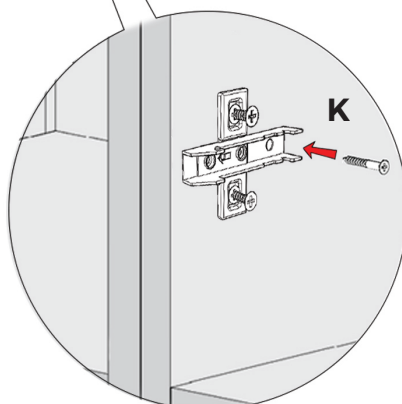
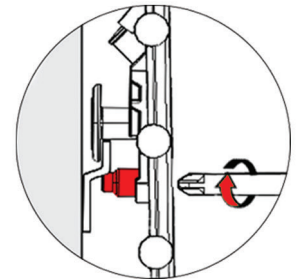

Step 18.

Screw into any side units using the provided 2x 30mm screws (**K**) to secure the unit. Screw just to the rear of the hinge plate then place a cover cap on the head to conceal it.

WALL UNIT

700 - 800 Tall 2 Door

Assembly Guide

Step 19.

Insert hinge in top & bottom holes as shown.

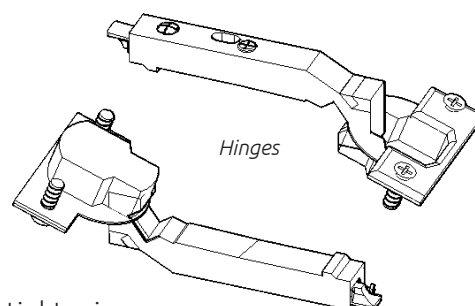

Step 20.

Secure hinges by tightening 2 x screws with hinge dowels attached. These are already positioned within the hinges.

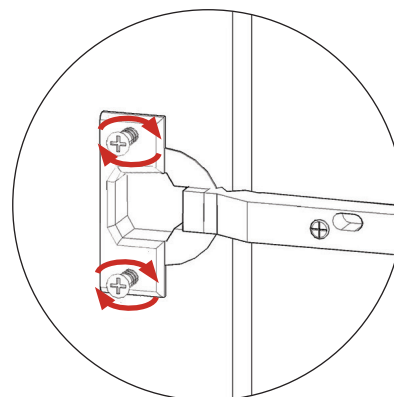

Step 21.

Attach the door to unit where required.

To attach door clip hinge onto hinge plate and click to secure.

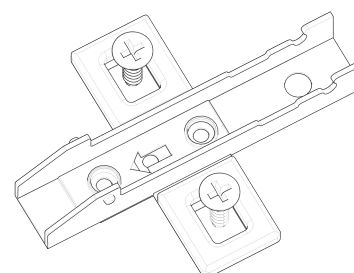

Hinge Plates

Hinge Cover Caps

Step 23.

Fit cover caps to hinge.

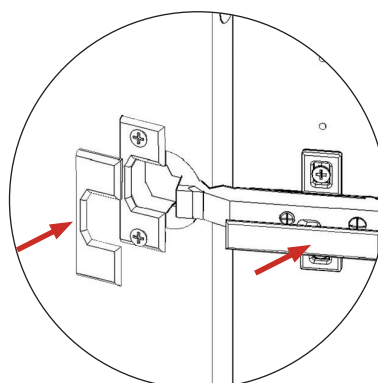
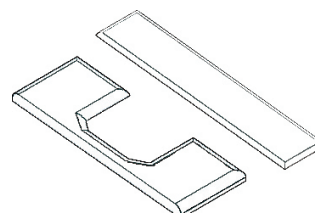

Step 22.

Adjust hinge to suit. As shown below.

FRONTAL HINGE ADJUSTMENT

To adjust hinge using a screw driver, tighten or loosen as required at points 1 & 2.
Point 1 - left - right
Point 2 - side - side

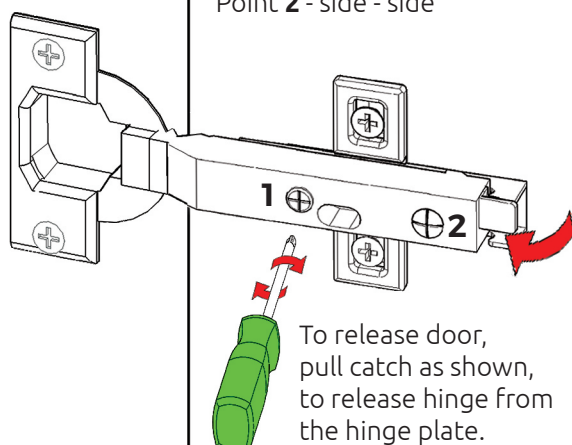

To release door, pull catch as shown, to release hinge from the hinge plate.

View from Inside of Carcass