

**Piston Lift**

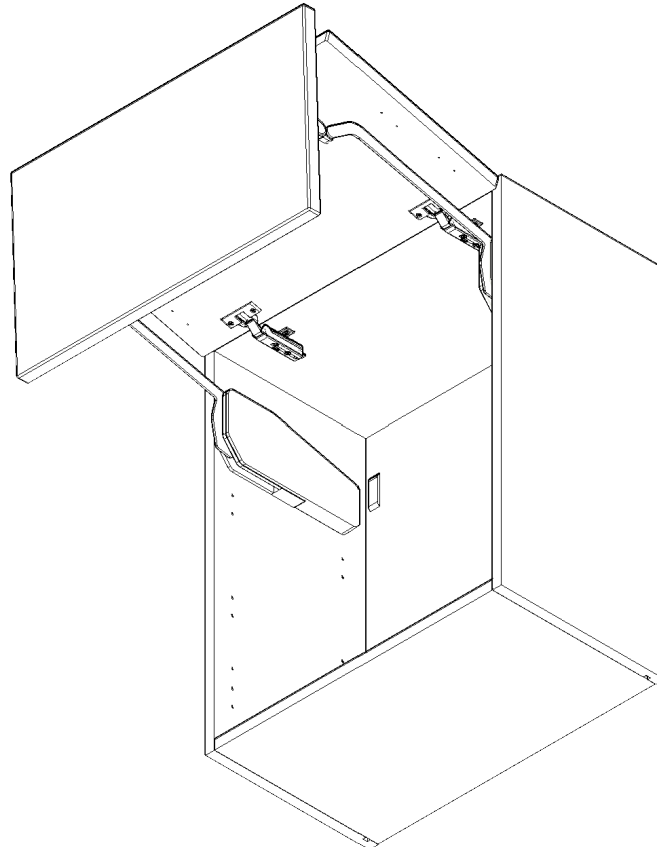

**BiFold Lift**

### PISTON LIFT

#### Step 1.

Secure piston brackets with 2 x 15mm screws into position as shown, using pilot holes on the frontal as a guide.

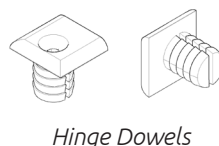
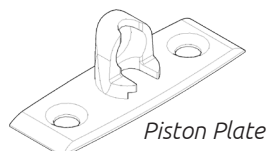

**COMPATIBLE UNITS**  
360 Wall  
720 Microwave  
900 Microwave  
Tower Units

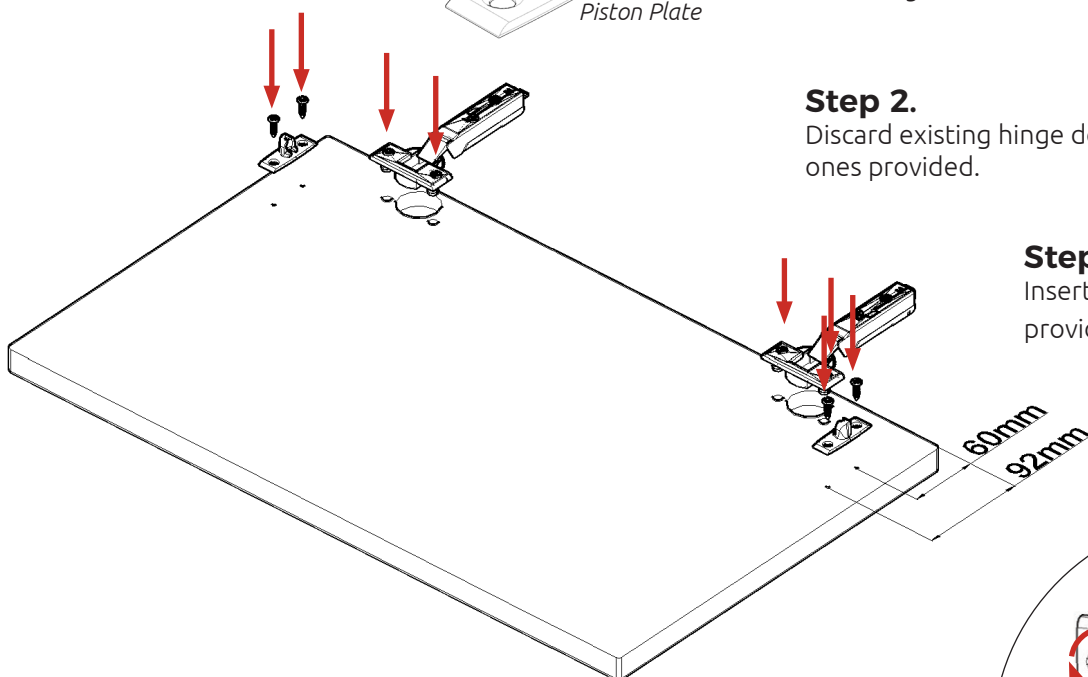

#### Step 2.

Discard existing hinge dowels and replace with new ones provided.

#### Step 3.

Insert hinges into hinge holes provided.

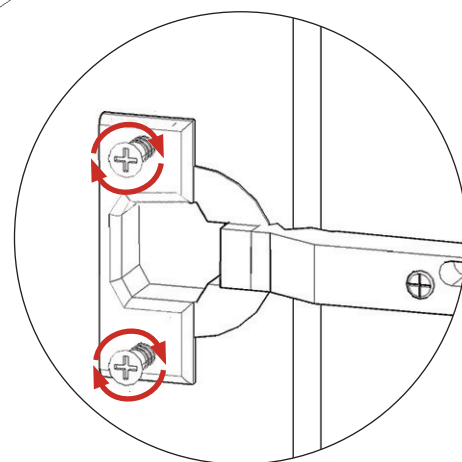

#### Step 4.

Secure hinges with the 2 x original screws.

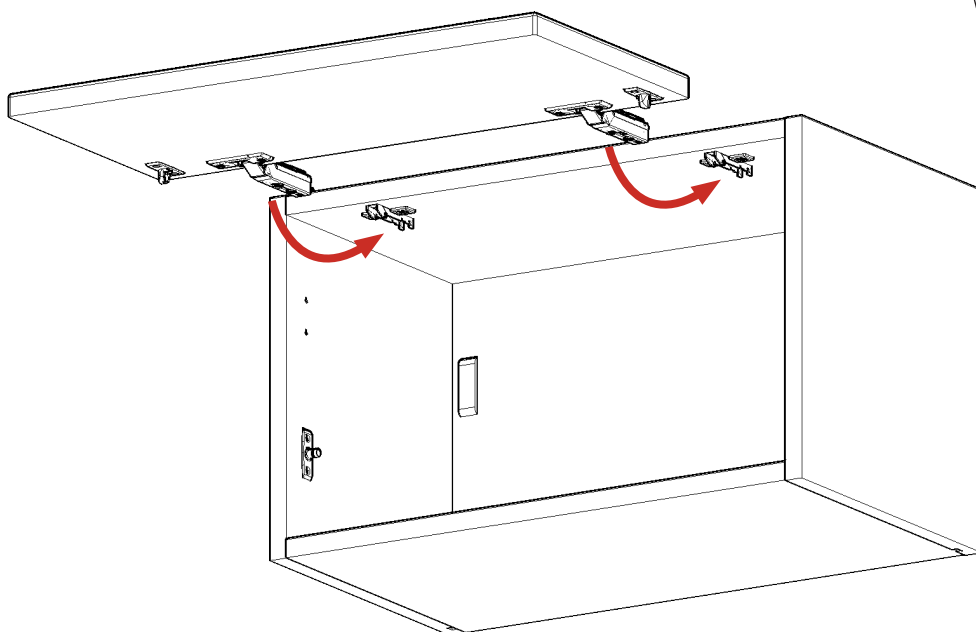

#### Step 5.

Clip hinges onto hinge mounting plates on the unit.

## **INFINITY + HINGE ADJUSTMENT** **(WHERE APPLICABLE)**

### **Step 6.**

Adjust hinges to suit. As shown below.

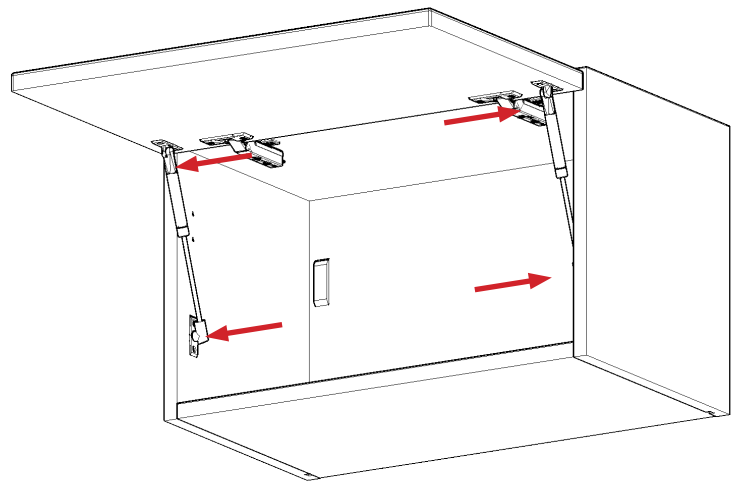
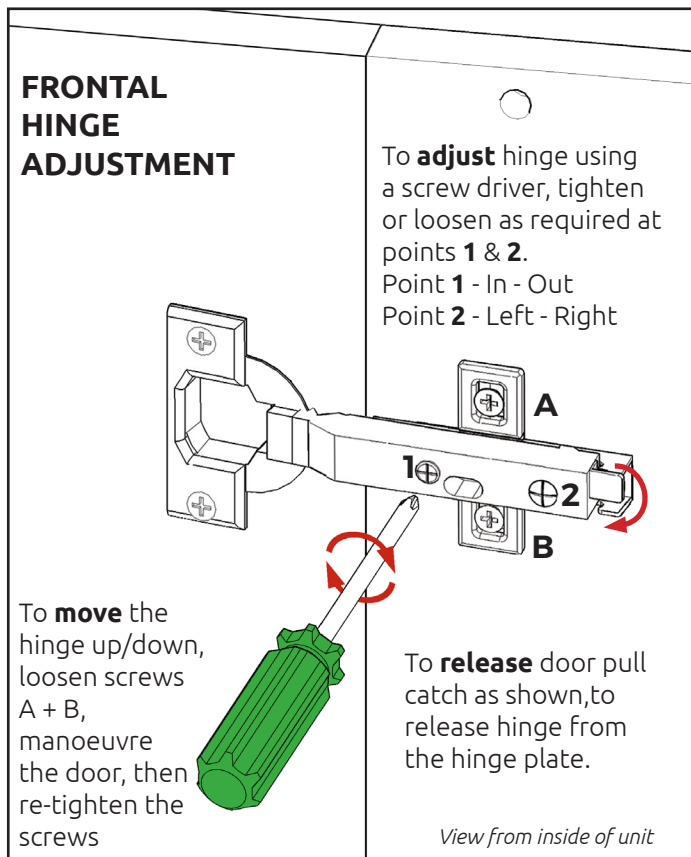

### **Step 7.**

Clip piston onto piston mounting plates on the unit and frontal.

### **Step 8.**

Fit cover caps to hinges. Adjust softclose to suit.

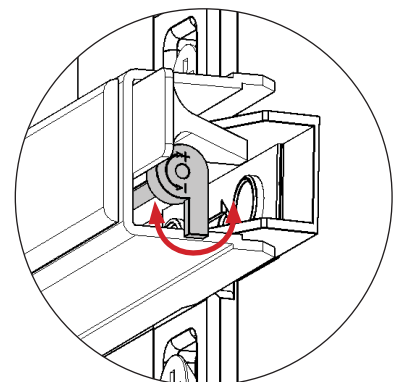
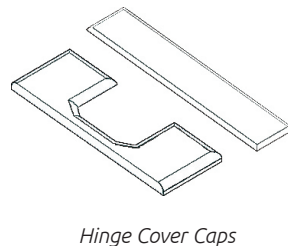
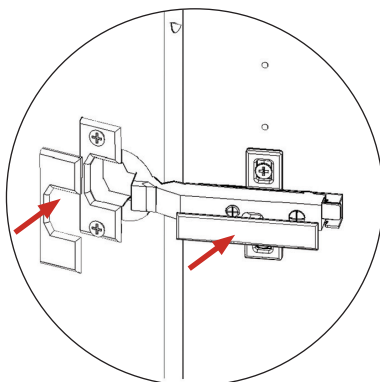

Both hinges **MUST** be adjusted to the **SAME STRENGTH**.

### INFINITY HINGE ADJUSTMENT (WHERE APPLICABLE)

#### Step 6.

Adjust hinges to suit. As shown below.

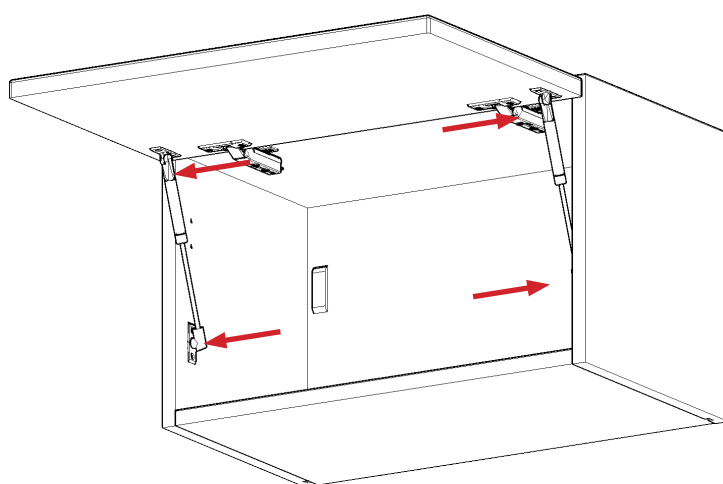
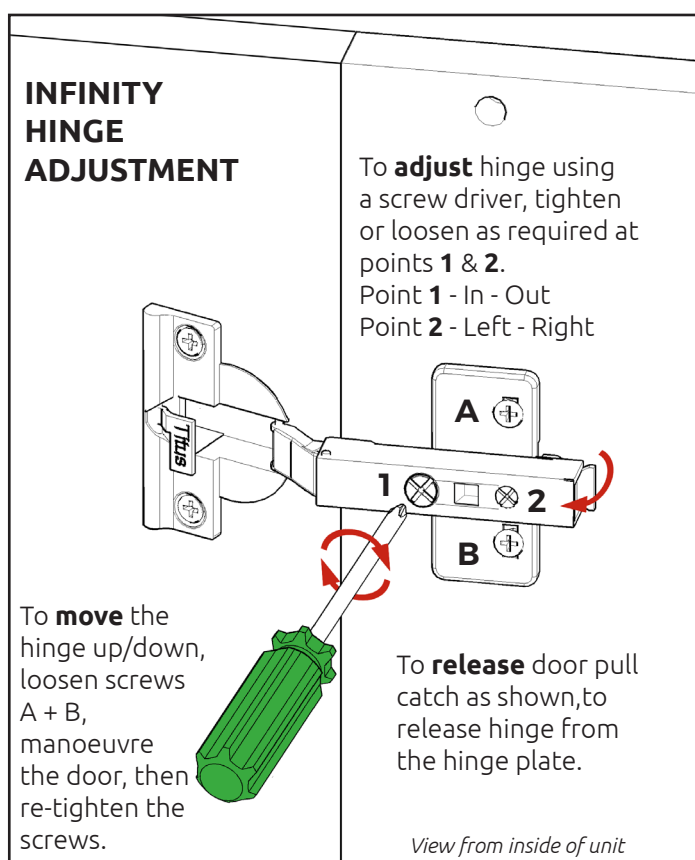

#### Step 7.

Clip piston onto piston mounting plates on the unit and frontal.

#### Step 8.

Fit cover cap to hinges. Adjust softclose to suit.

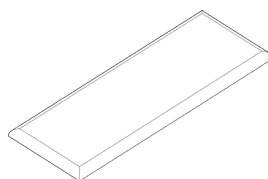
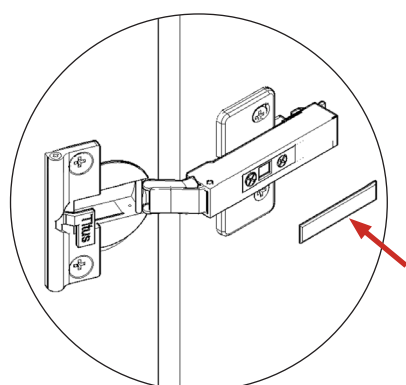

Hinge Cover Caps

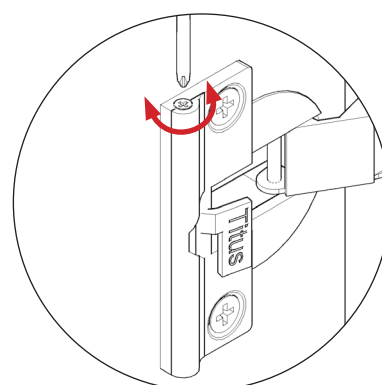

Both hinges **MUST** be adjusted to the **SAME STRENGTH**.

## BIFOLD LIFT

### Step 1.

Line up and insert 3 x mechanism pins into holes provided as shown.

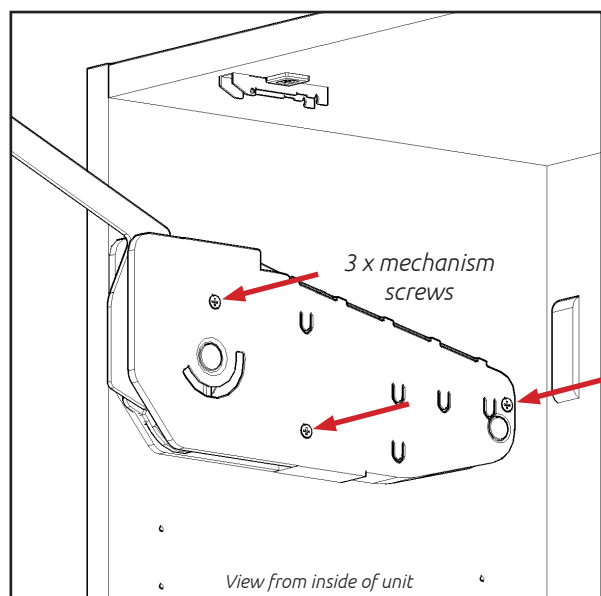
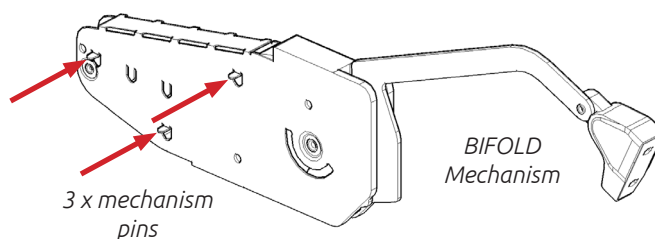
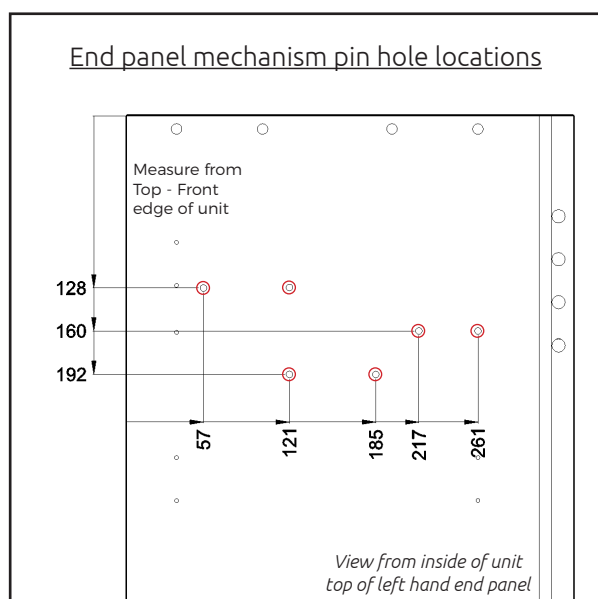

### Step 2.

Tighten 3 x screws on each BiFold mechanism into the unit. These are already positioned within the mechanism.

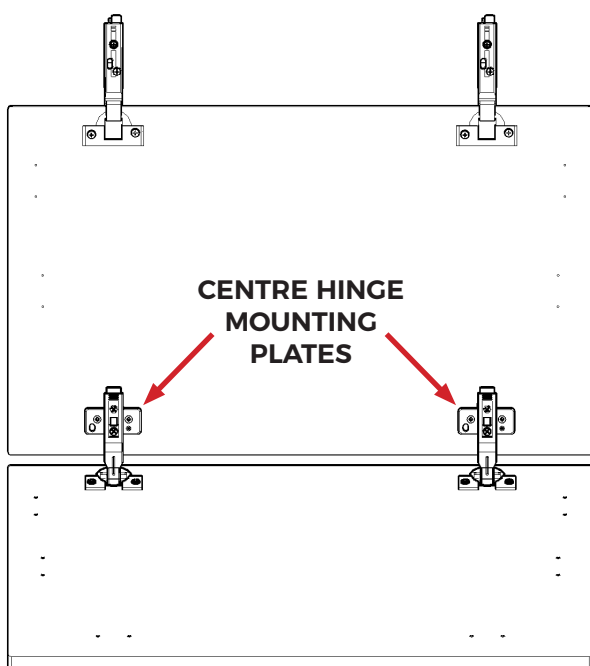

### Step 3.

Discard existing hinge dowels and replace with new ones provided.

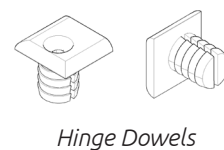

### Step 4.

Insert top hinges into hinge holes provided on one frontal. On the same frontal, fix centre hinge mounting plates as shown.

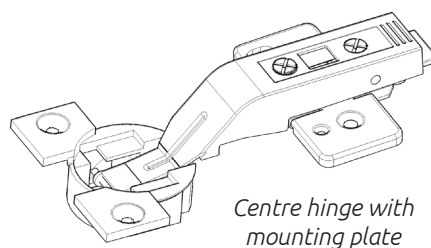

### Step 5.

Insert centre hinges into hinge holes provided on the second frontal. Secure all hinges with 2 x original screws per hinge.

### Step 6.

Attach frontals together, clip centre hinge into hinge mounting plate & click to secure.

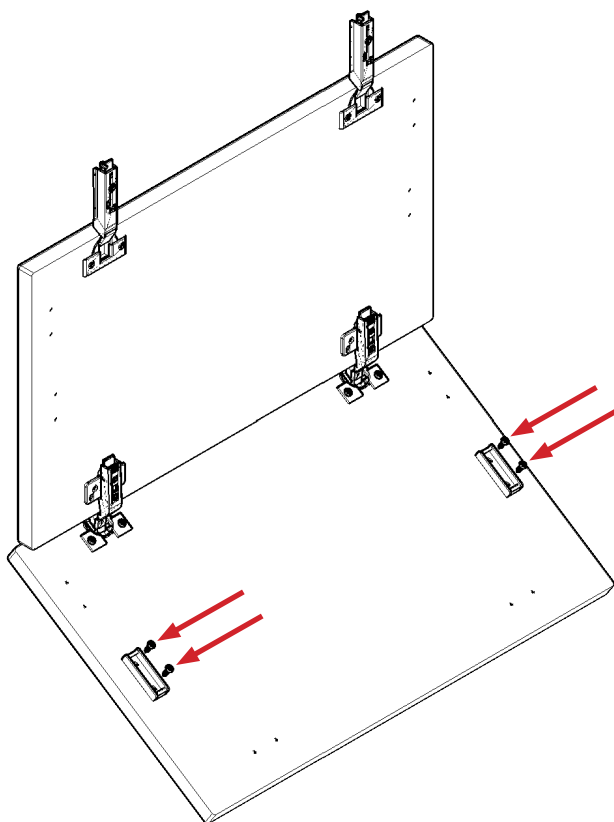

### Step 7.

Secure BiFold arm clip to the frontal location as shown, with 2 x 15mm screws per clip.

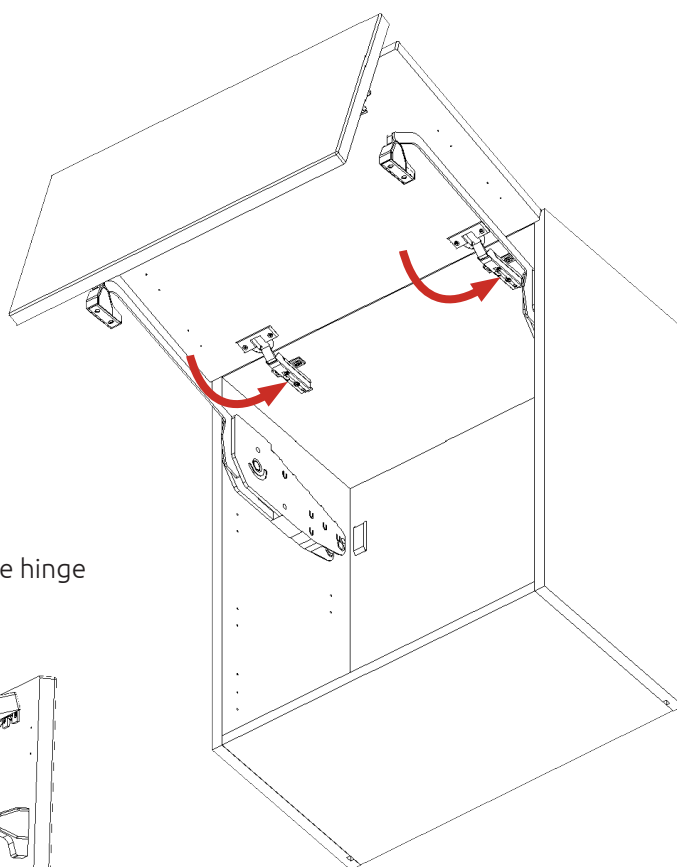

### Step 8.

Attach frontals to the unit. Clip hinges onto the hinge plates and click to secure.

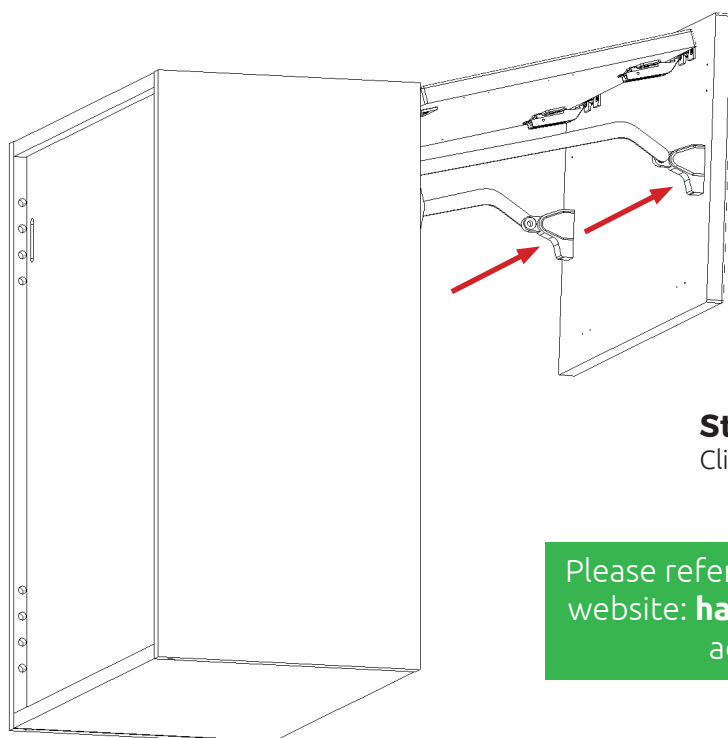

### Step 9.

Clip arms onto BiFold arm clips.

Please refer to **lift hinge instructions** provided or visit website: [hafele.com/external/free](https://hafele.com/external/free) for further frontal adjustment information if required

## **INFINITY + HINGE ADJUSTMENT** **(WHERE APPLICABLE)**

### **Step 10.**

Adjust hinges to suit. As shown below.

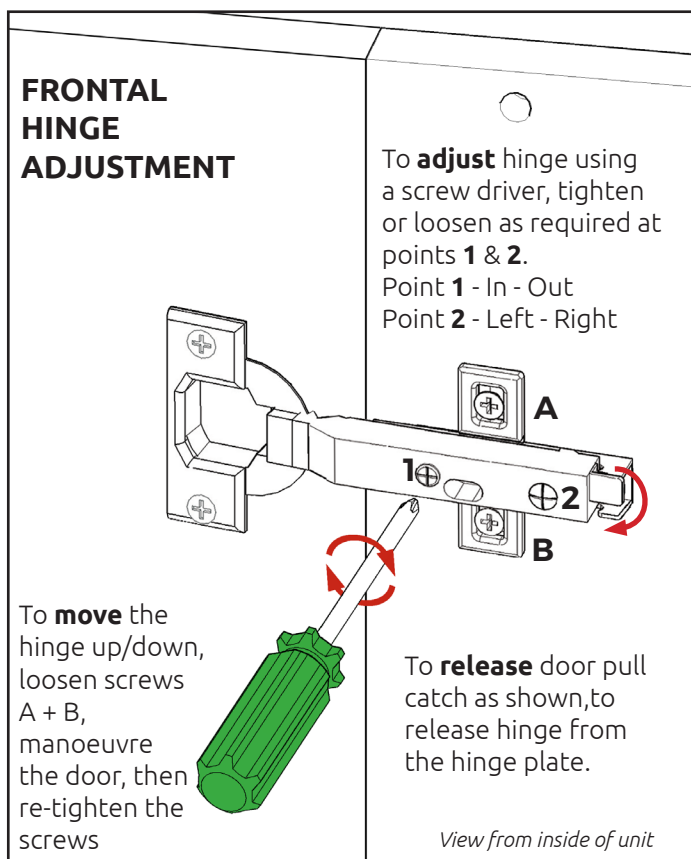

### **Step 11.**

Fit cover caps to hinges. Adjust softclose to suit.

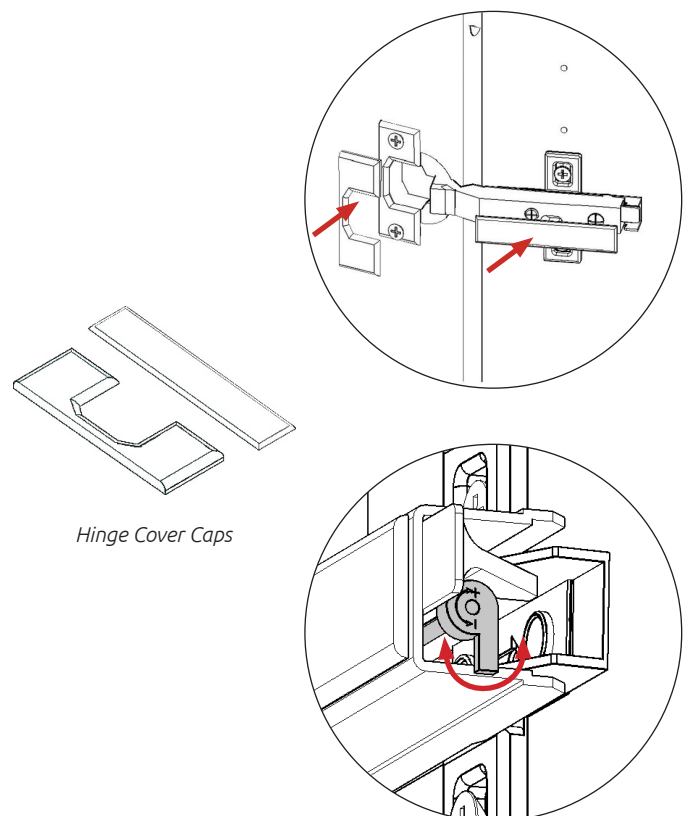

Both hinges **MUST** be adjusted to the **SAME STRENGTH**.

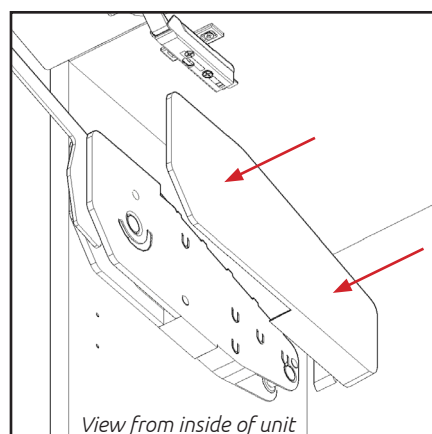

### **Step 12.**

Fit covers to lift mechanisms.

### **INFINITY HINGE ADJUSTMENT** **(WHERE APPLICABLE)**

#### **Step 10.**

Adjust hinges to suit. As shown below.

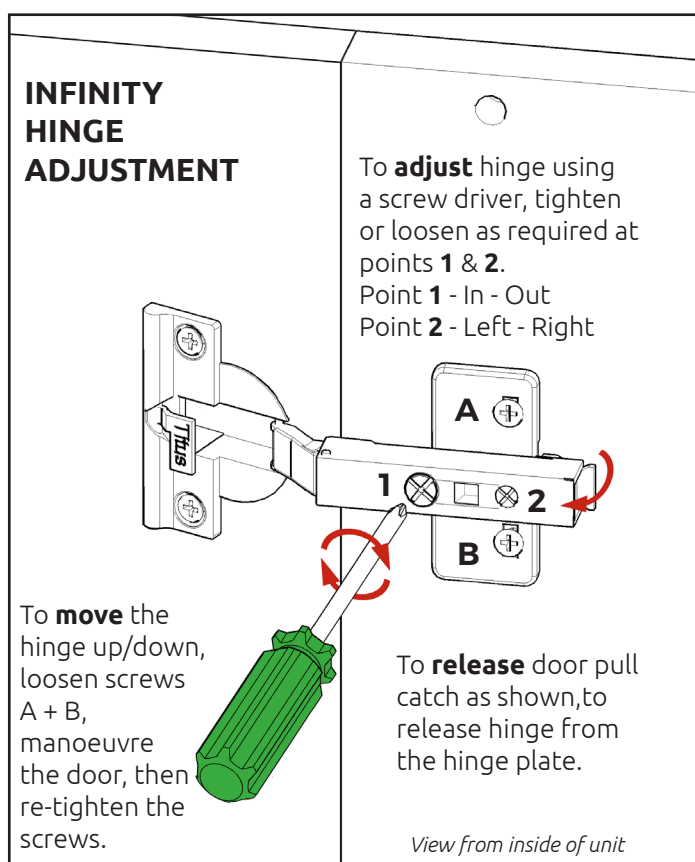

#### **Step 11.**

Fit cover caps to hinges. Adjust softclose to suit.

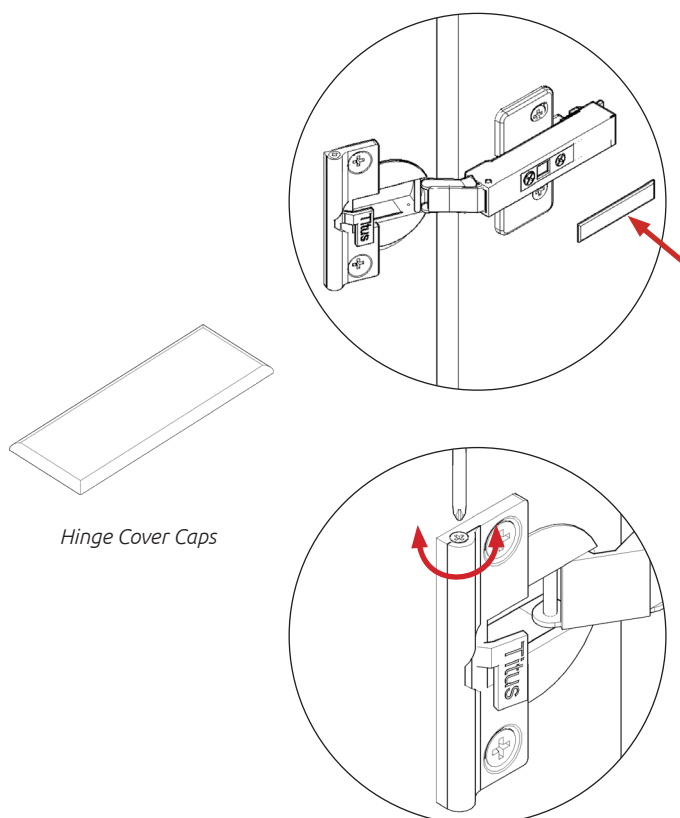

Both hinges **MUST** be adjusted to the **SAME STRENGTH**.

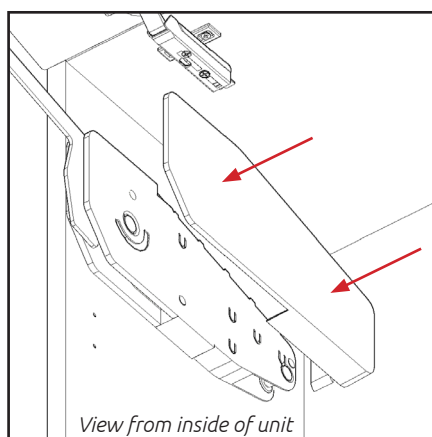

#### **Step 12.**

Fit covers to lift mechanisms.