

DRAWER REMOVAL/ INSERTION

Guide

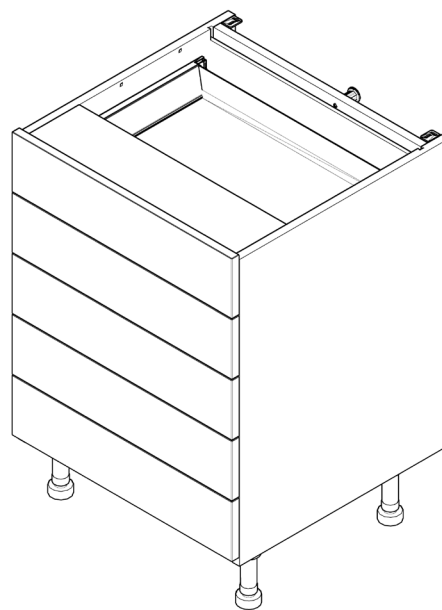
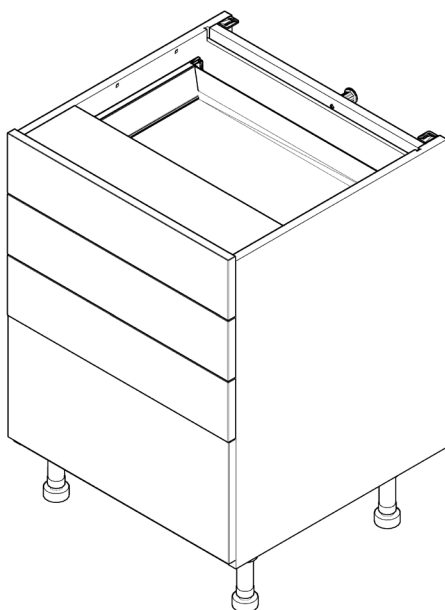
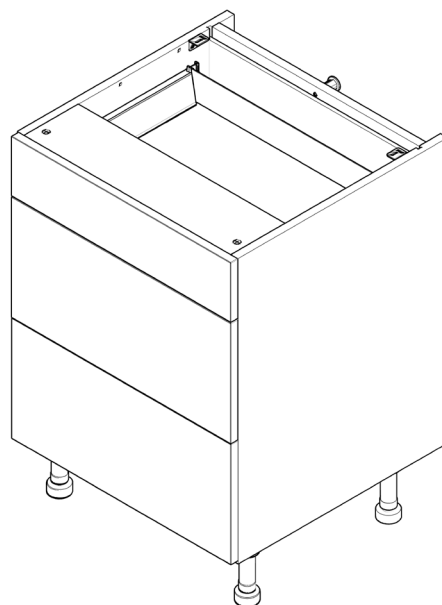
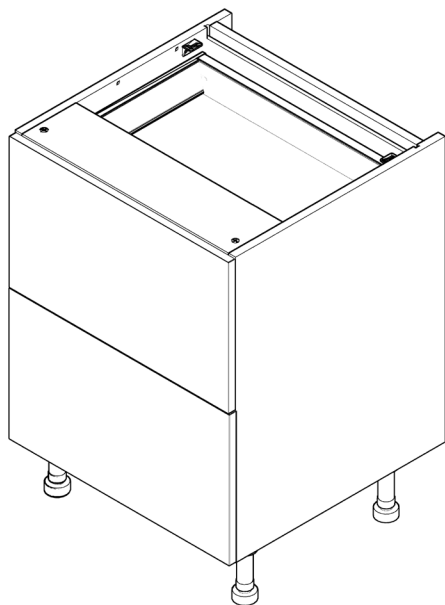

wren
KITCHENS

DRAWER REMOVAL

Guide

DRAWER REMOVAL

Step 1.

Open the drawer that is required to be removed.
Pull out the drawer until the runners are at maximum extension.

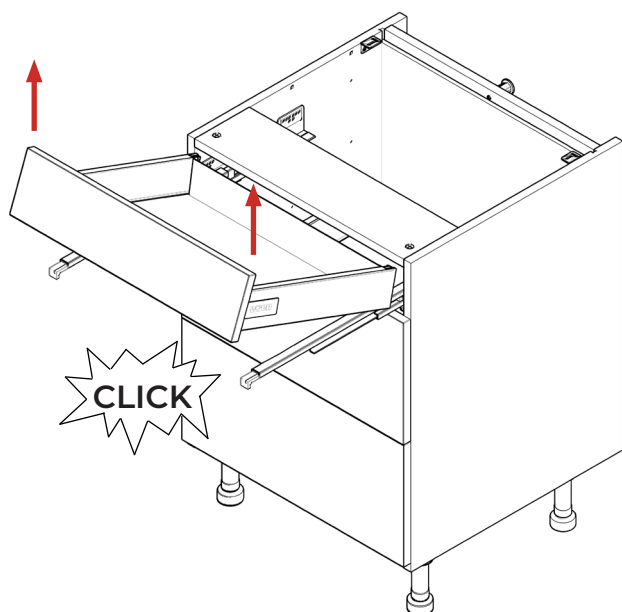
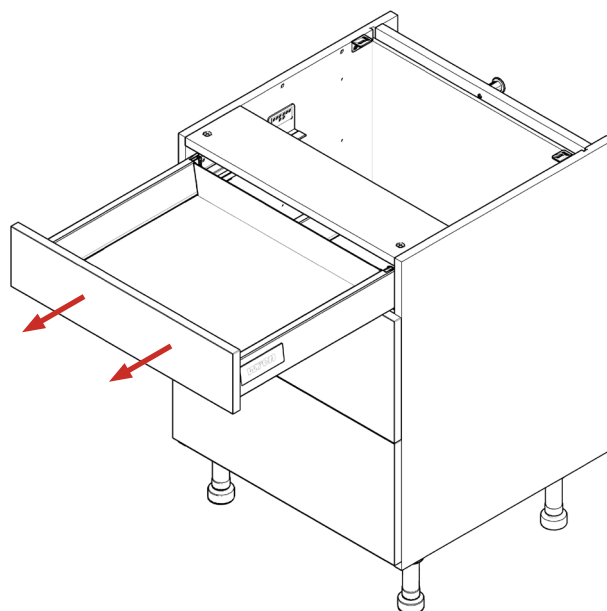

Step 2.

In one smooth motion, lift the front of the drawer, this will disconnect the runner from the connectors on the base of the drawer.
Once properly separated a click will be heard and the drawer will be separate from the runner.

If this motion is not done with enough force then the drawer may need to be lifted again. Be careful not to lift the runners whilst lifting the drawer.

Step 3.

The drawer is free to remove from the unit.
Simply remove the loose drawer from the unit, making sure not to damage the unit in the process.

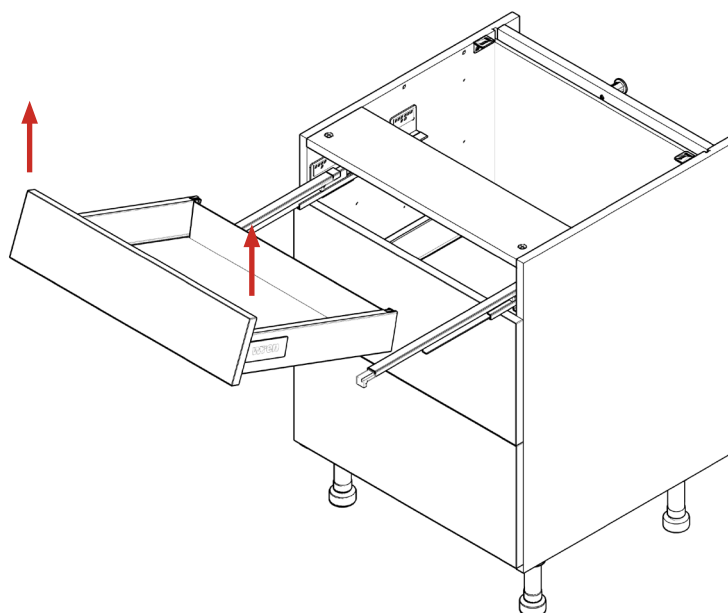

DRAWER INSERTION

DRAWER INSERTION

Guide

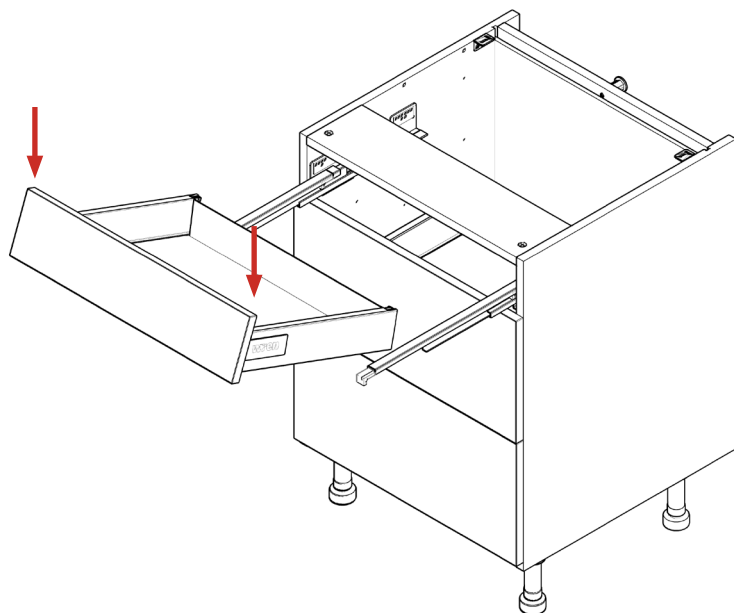

Step 1.

Fully extend the drawer runners out of the unit. (for the drawer you are inserting)

Step 2.

Place the drawer onto the runners, making sure that the groove of the drawer sides and the runner mechanism are aligned.

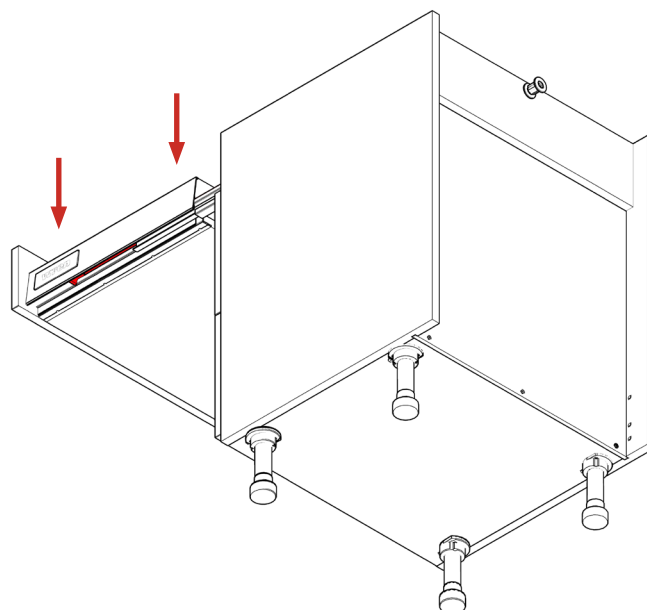

Step 3.

Once the drawer is placed onto the runners, pull forward the protruding lips on the ends of the runners until a click is heard. Once the click is heard the drawer is properly located and secured to the runner.

Push the drawer back into the Unit.

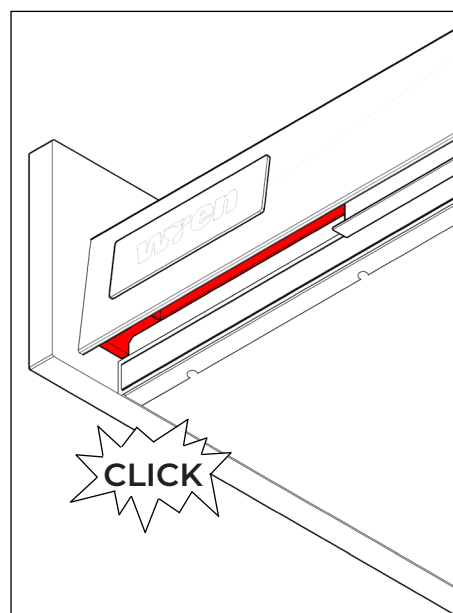
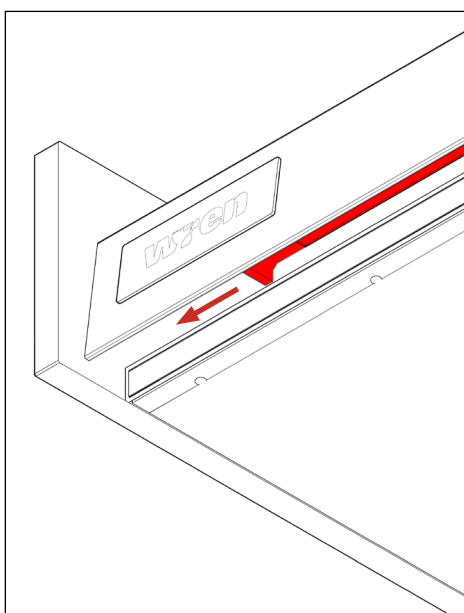

DRAWER SINGLE

Adjustment Guide

SINGLE DRAWER

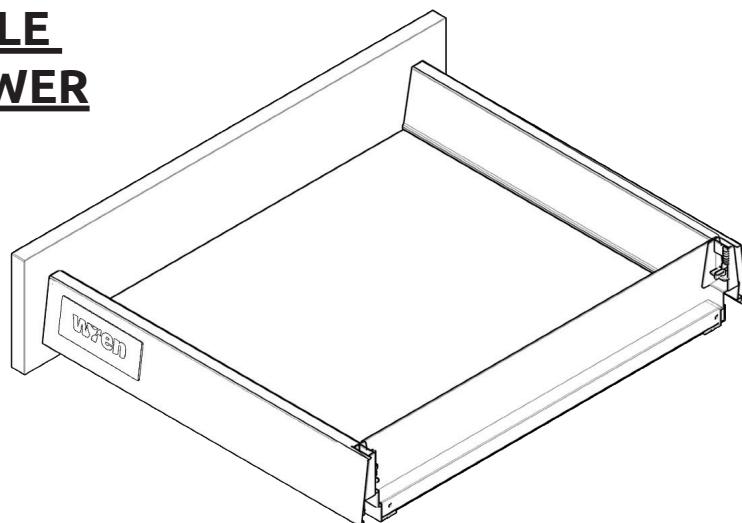
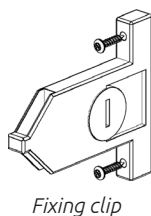

Step 1.

Secure drawer side fixing clips using 2 x 21mm screws per clip using the predrilled holes.

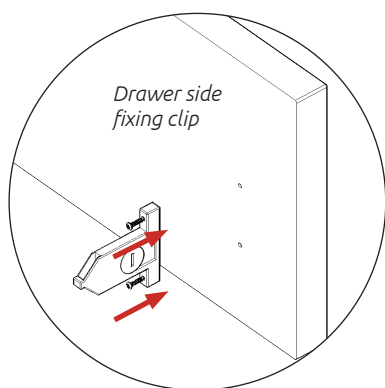

DRAWER FRONTAL ADJUSTMENT

View on side of drawer side

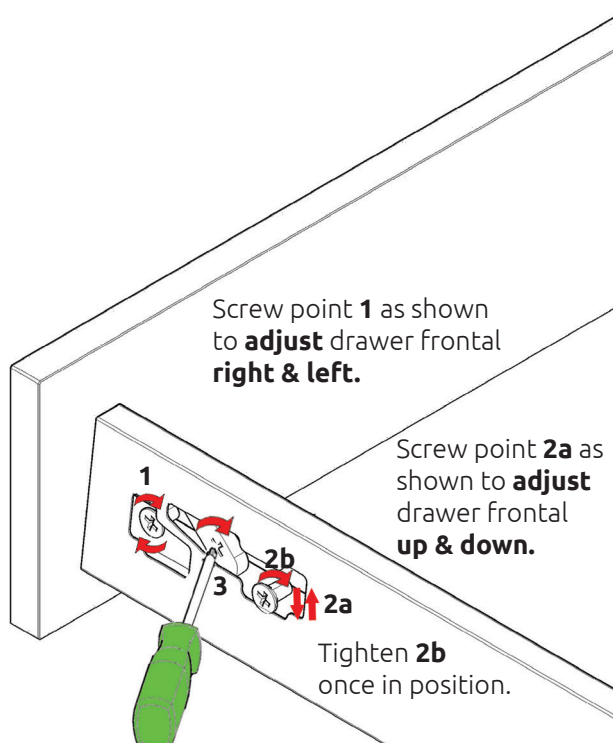

Step 2.

Push fit drawer side fixing clips onto drawer side.

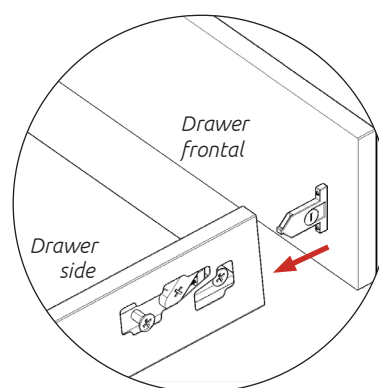

Step 3.

Fit drawer cover caps over drawer side adjustment.

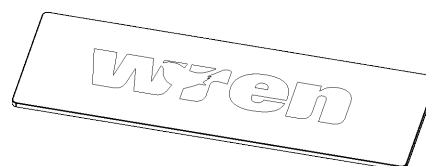

DRAWER DEEP

Adjustment Guide

DEEP DRAWER

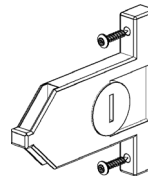
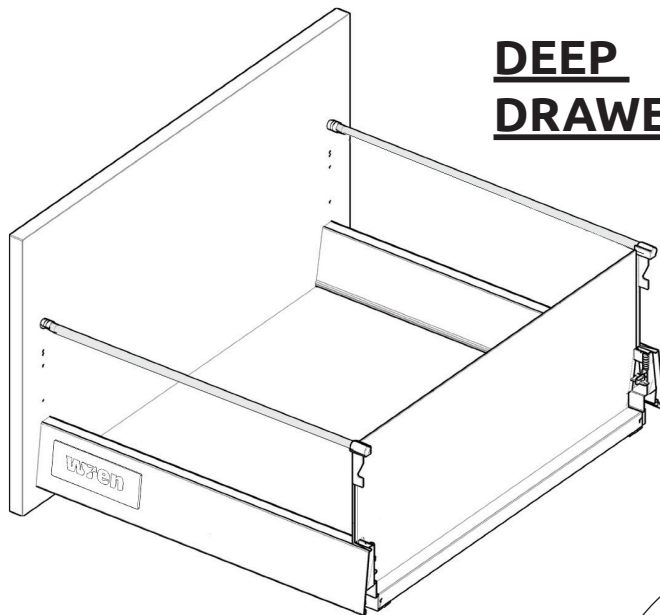

Fixing clip

Step 1.

Secure gallery head fixing clips using 1 x 15mm screw and secure drawer side fixing clips using 2 x 21mm screws located with the predrilled holes.

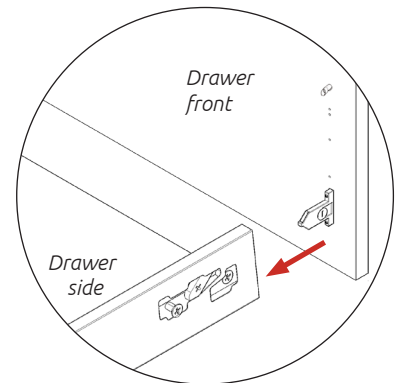
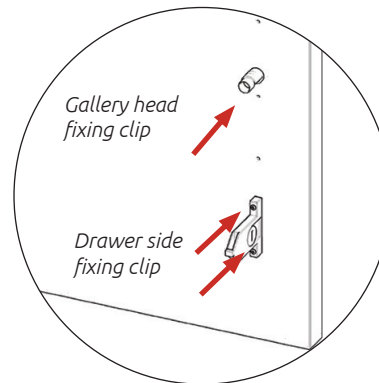
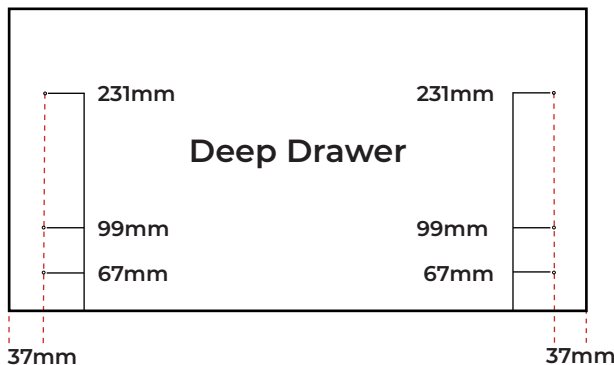

Step 2.

Push fit drawer fixing clips onto drawer sides.

Step 3.

A. Clip gallery rail into the top corners of the metal back panel.

B. Locate front end of the gallery rail into the opening of the gallery head fixing clip, which is secured to the frontal as shown.

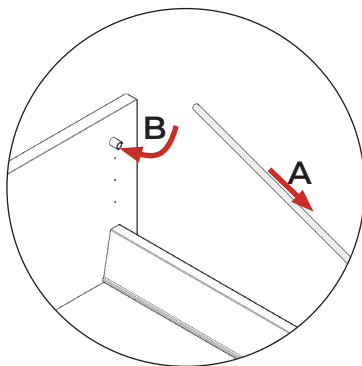

Step 4.

Fit drawer cover caps over drawer side adjustment.



Drawer Cover Cap

DRAWER FRONTAL ADJUSTMENT

View on side of drawer side

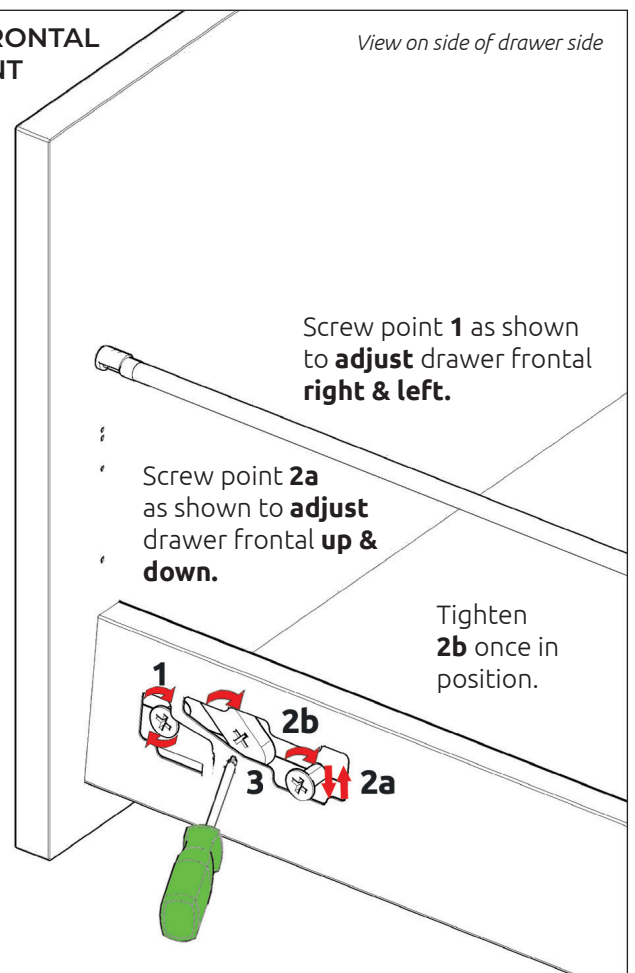

Screw point **1** as shown to **adjust** drawer frontal **right & left**.

Screw point **2a** as shown to **adjust** drawer frontal **up & down**.

Tighten **2b** once in position.

Releasing fixing clip. Screw point **3** whilst applying downward pressure as shown to release.

DRAWER GLASS DEEP

Guide

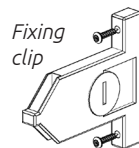

Step 1.

Secure glass side fixing clips using 2 x 15mm screws.
Secure drawer side fixing clips using 2 x 21mm screws in pilot holes provided as shown below.

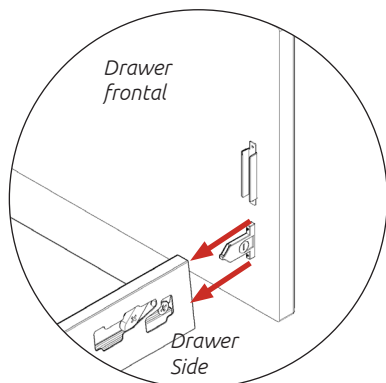
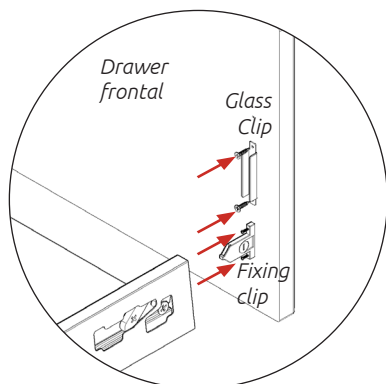
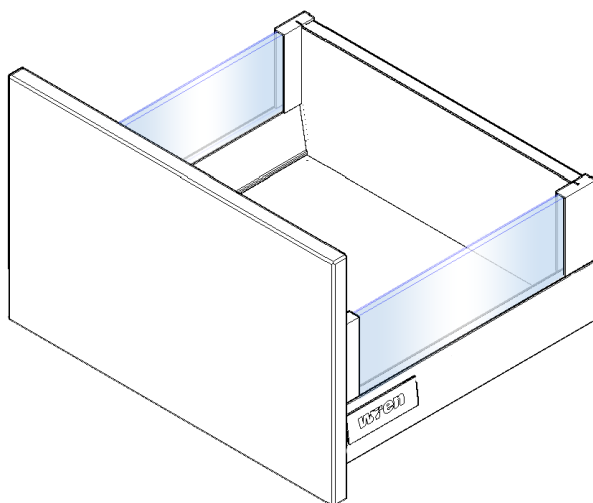

Step 2.

Push fit drawer side fixing clips onto drawer side.

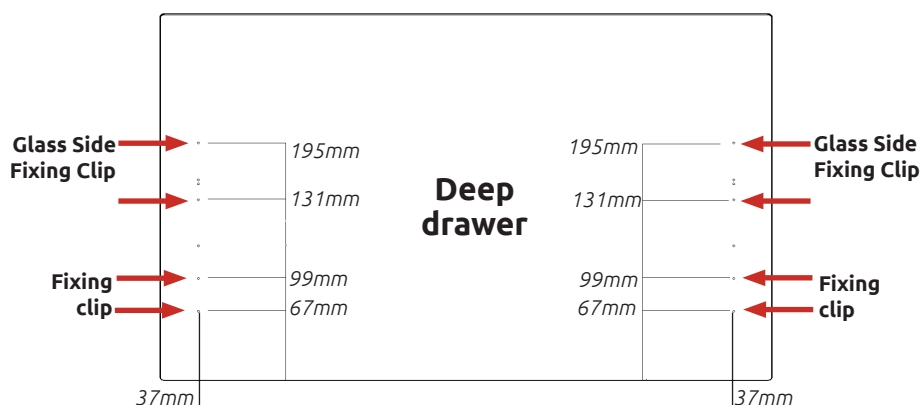

Step 3.

Fit glass sides with end caps attached.
Use the groove on the front end cap as a guide to slide into place onto frontal glass fixing clip, and into metal back as shown.

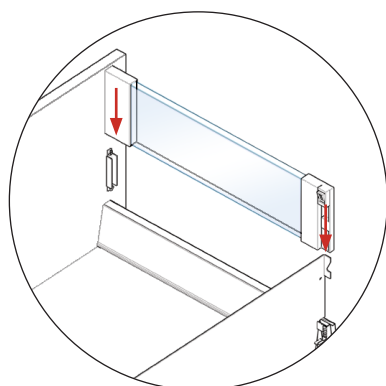

Rear end clip release catch, depress & lift to remove side.



Step 4.

Fit drawer cover caps over drawer side adjustment.

Drawer Frontal Adjustment

Screw point **1** as shown to adjust drawer frontal right & left.

Screw point **2a** as shown to adjust drawer frontal up & down.

Tighten **2b** once in position.

Releasing fixing clip. Screw point **3** whilst applying downward pressure as shown to release.

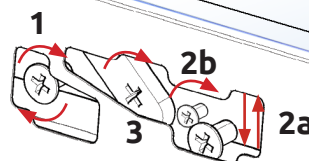

View on side of drawer side

DRAWER GLASS MID

For use with 2 + 1 Internal Unit

Guide

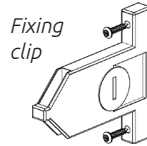
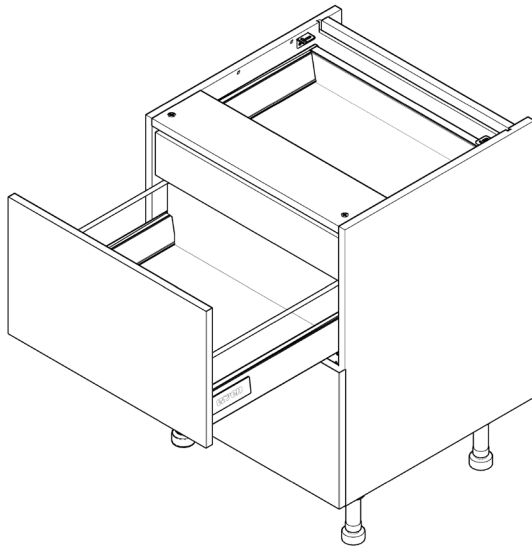

Step 1.

Secure gallery head fixing clips using 1 x 15mm screw. Secure drawer side fixing clips using 2 x 21mm screws in pilot holes provided as shown below.

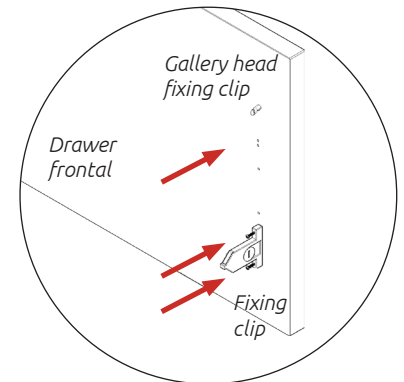

Step 2.

Push fit drawer fixing clips onto drawer side.

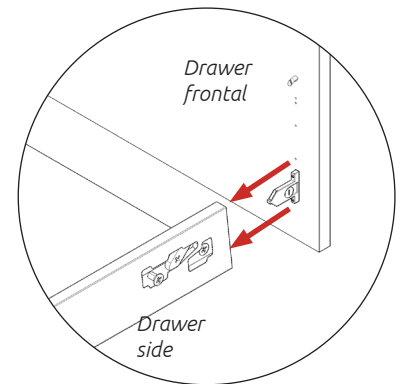
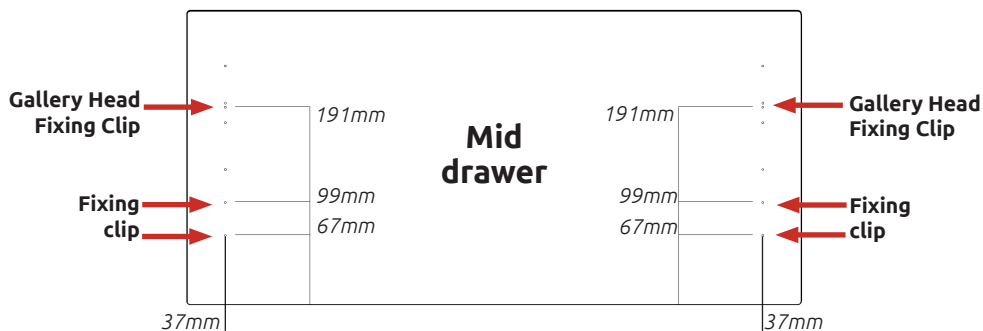

Drawer Frontal Adjustment

Screw point **1** as shown to adjust drawer frontal right & left.

Screw point **2a** as shown to adjust drawer frontal up & down.

Tighten **2b** once in position.

Releasing fixing clip. Screw point **3** whilst applying downward pressure as shown to release.

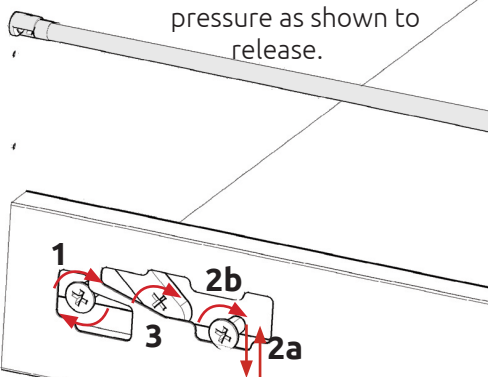

View on side of drawer side

Step 3.

1. Clip gallery rail into the top corners of metal back panel.
2. Locate front end of the gallery rail into the opening of the gallery head fixing clip, which is secured to the frontal as shown.

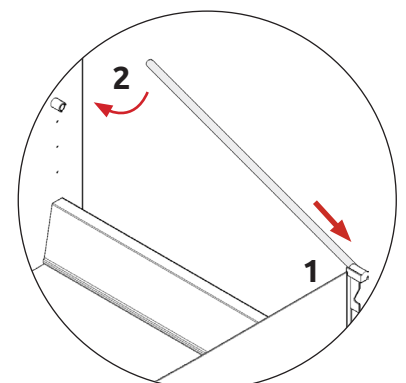

Drawer Cover Cap



Step 4.

Fit Drawer Cover Caps over drawer side adjustment.

DRAWER GLASS MID

For use with 2 + 1 Internal Unit

Guide

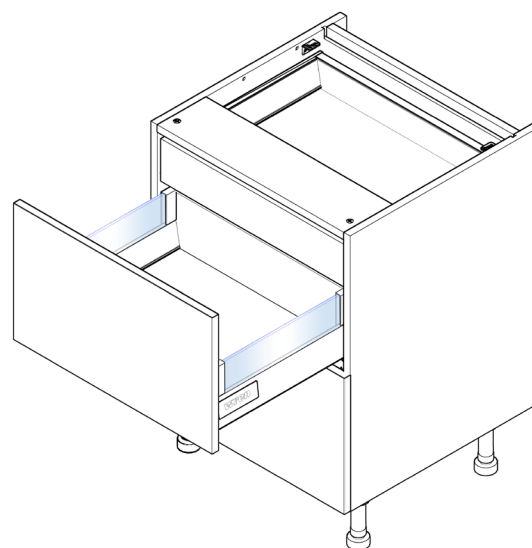
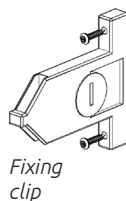

Step 1.

Secure glass side fixing clips using 2 x 15mm screws, secure drawer side fixing clips using 2 x 21mm screws in pilot holes provided as shown below.

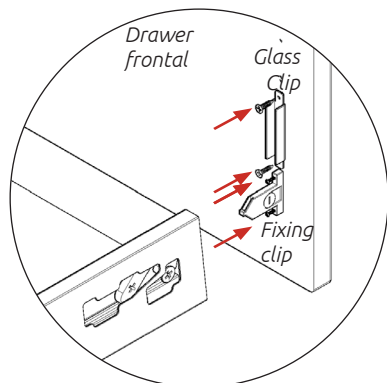

Step 2.

Push fit drawer fixing clips onto drawer side

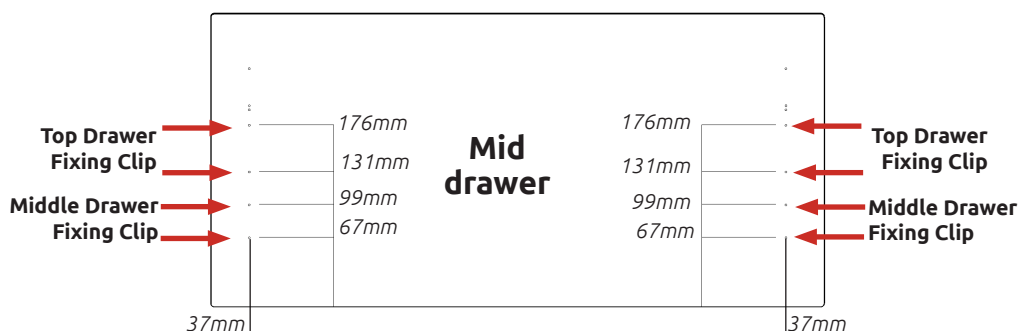
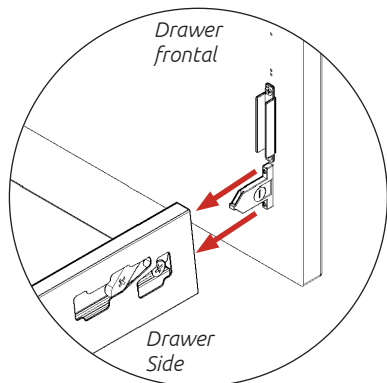

Drawer Frontal Adjustment

Screw point **1** as shown to adjust drawer frontal right & left.

Screw point **2a** as shown to adjust drawer frontal up & down.

Tighten **2b** once in position.

Releasing fixing clip. Screw point **3** whilst applying downward pressure as shown to release.

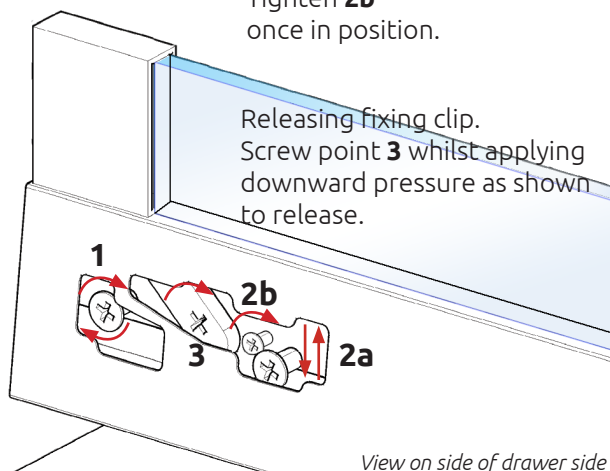

Step 3.

Fit Glass Sides with End Caps attached. Use the groove on the front End Cap as guide to slide into place onto Frontal Glass Fixing Clip, and into Metal Back as shown.

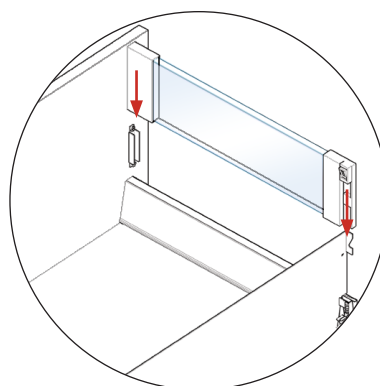

Rear End Clip release catch, depress & lift to remove side.



Step 4.

Fit Drawer Cover Caps over drawer side adjustment.