

7 Shelf Robe

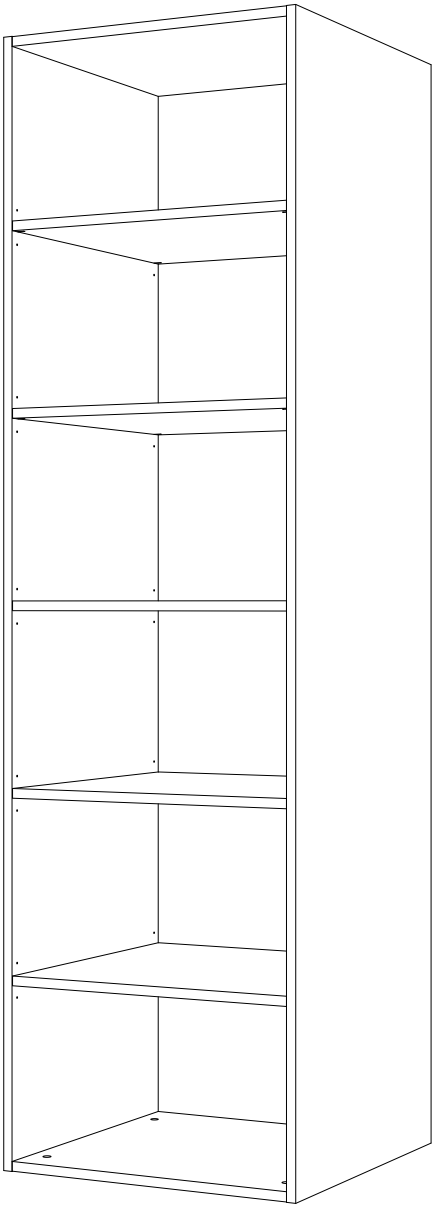

5 Shelf Robe



### BEFORE YOU START

**THIS PRODUCT MUST BE SECURED TO THE WALL**

INSTALLATION SHOULD BE PERFORMED BY A COMPETENT PERSON ONLY.

THIS PRODUCT COULD BE DANGEROUS IF INCORRECTLY INSTALLED

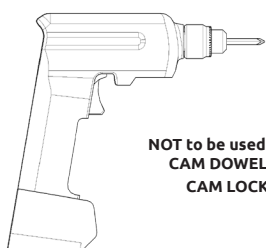
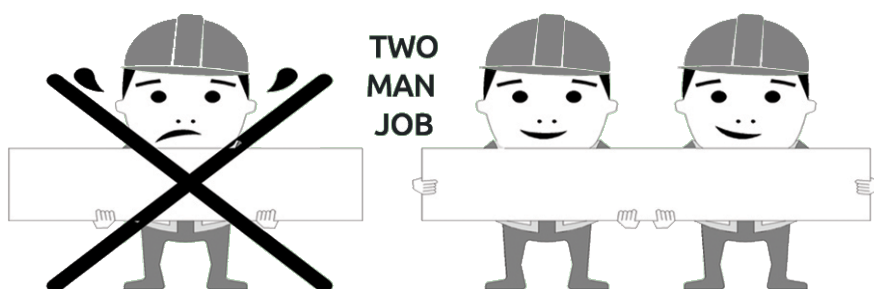

NOT to be used with  
CAM DOWEL &  
CAM LOCK

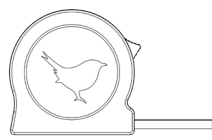
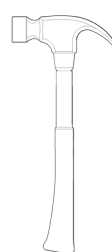

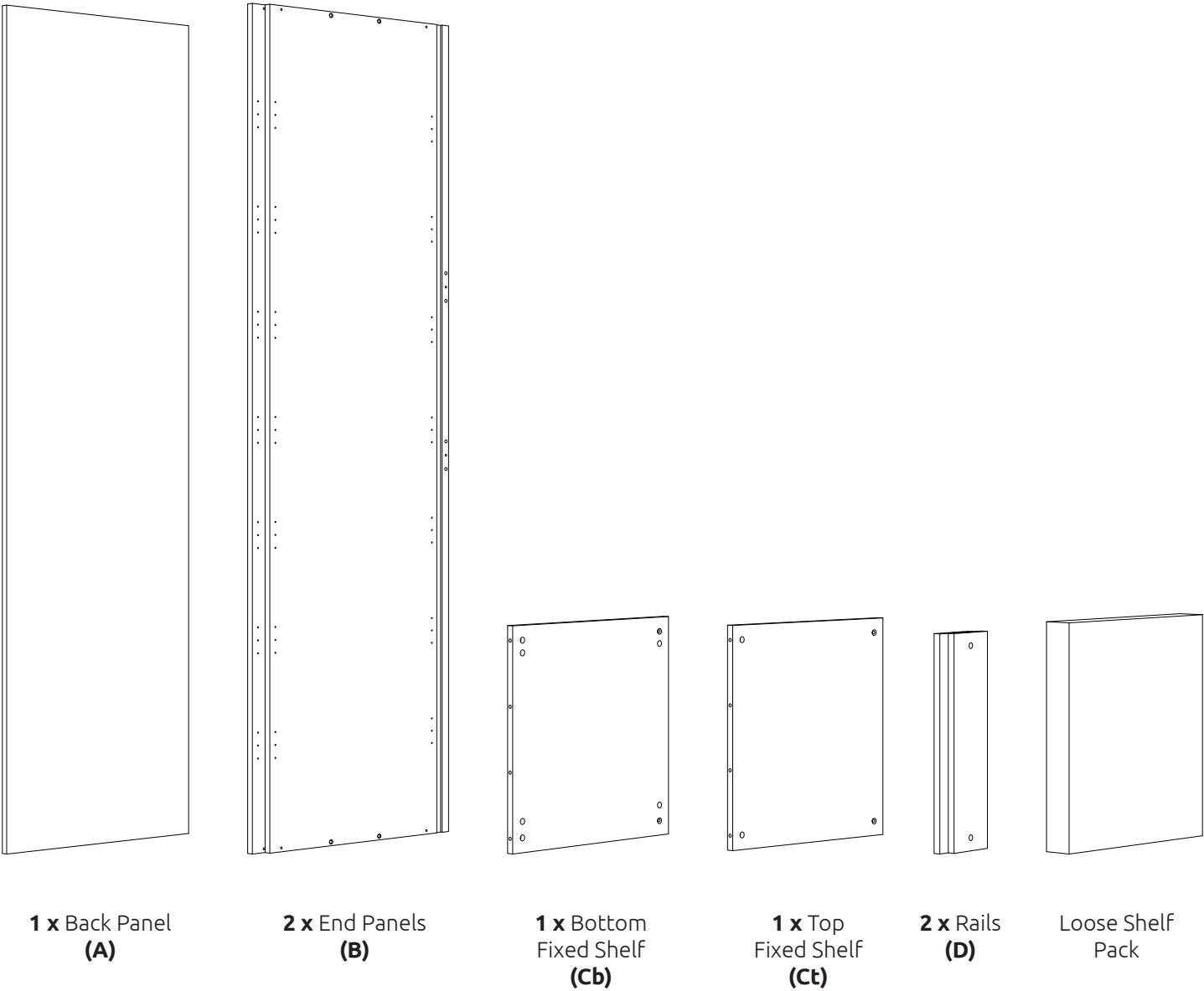

Throughout this instruction the full depth 7 shelf feature robe will be used for reference only

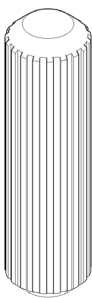

**(F) x16**  
Wooden Dowel

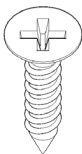

**(L) x10**  
15mm Screw

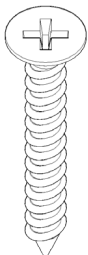

**(K) x6**  
30mm Screw

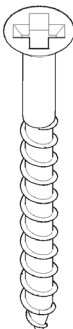

**(P) x6**  
45mm Screw

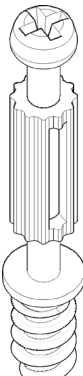

**(W) x12**  
Cam Dowel

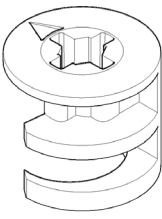

**(H) x12**  
Cam Lock



**(LL) x5**  
15mm Cover Cap

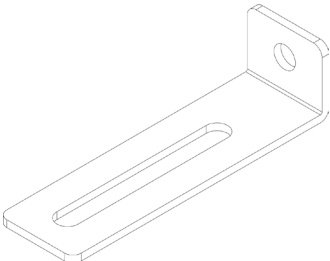

**x2**  
Anti Tipping  
Bracket

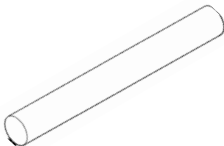

**x28**  
Loose Shelf Peg

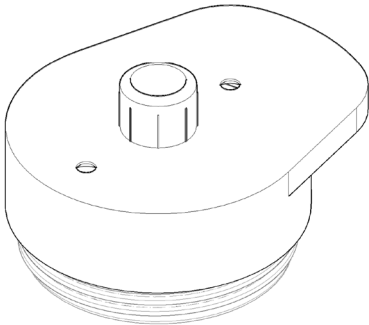

**Robe  
Legs**

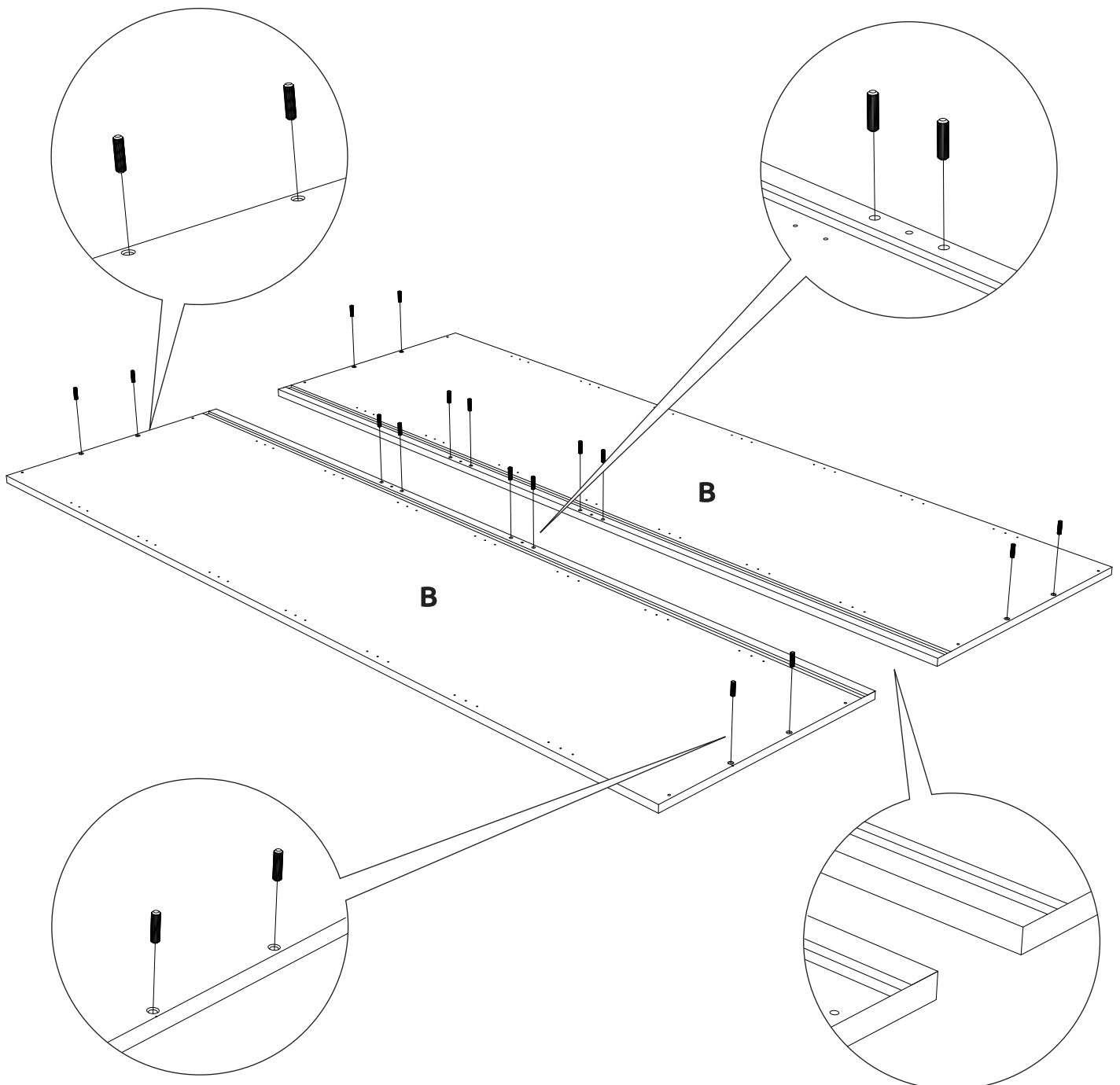
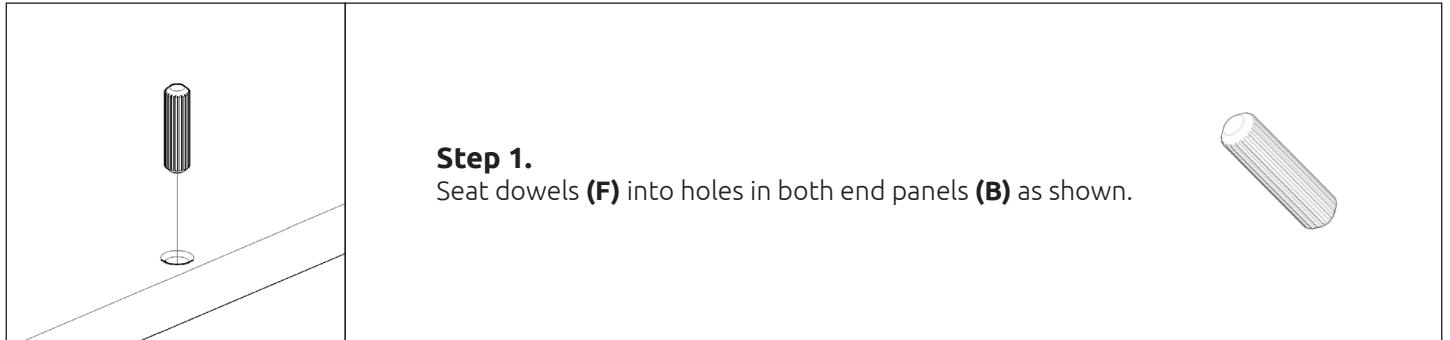

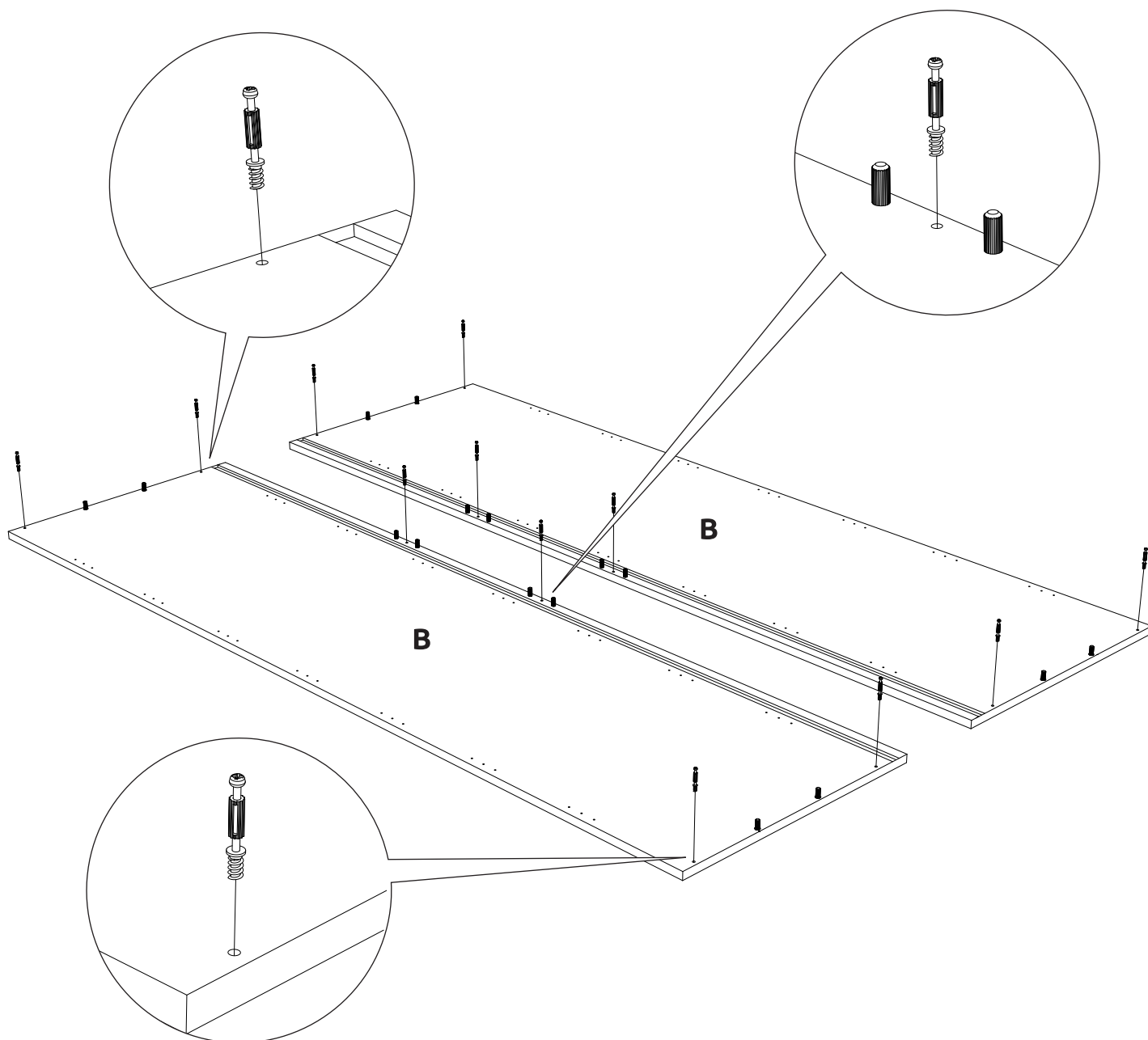
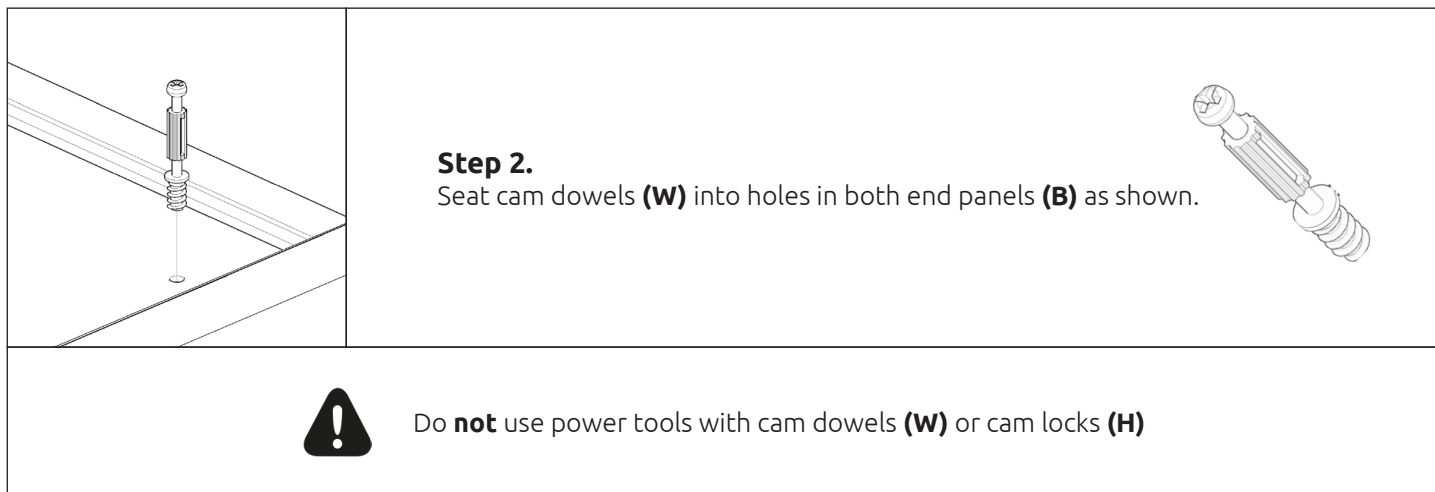

### Step 3.

Attach panels **(Ct)**, **(Cb)** & **(D)** to panel **(B)**, using cam dowels **(W)**, and also using wooden dowels **(F)** in positions as shown.



All cam locks **(H)** are to be positioned facing the outside of the unit, for ease of tightening.

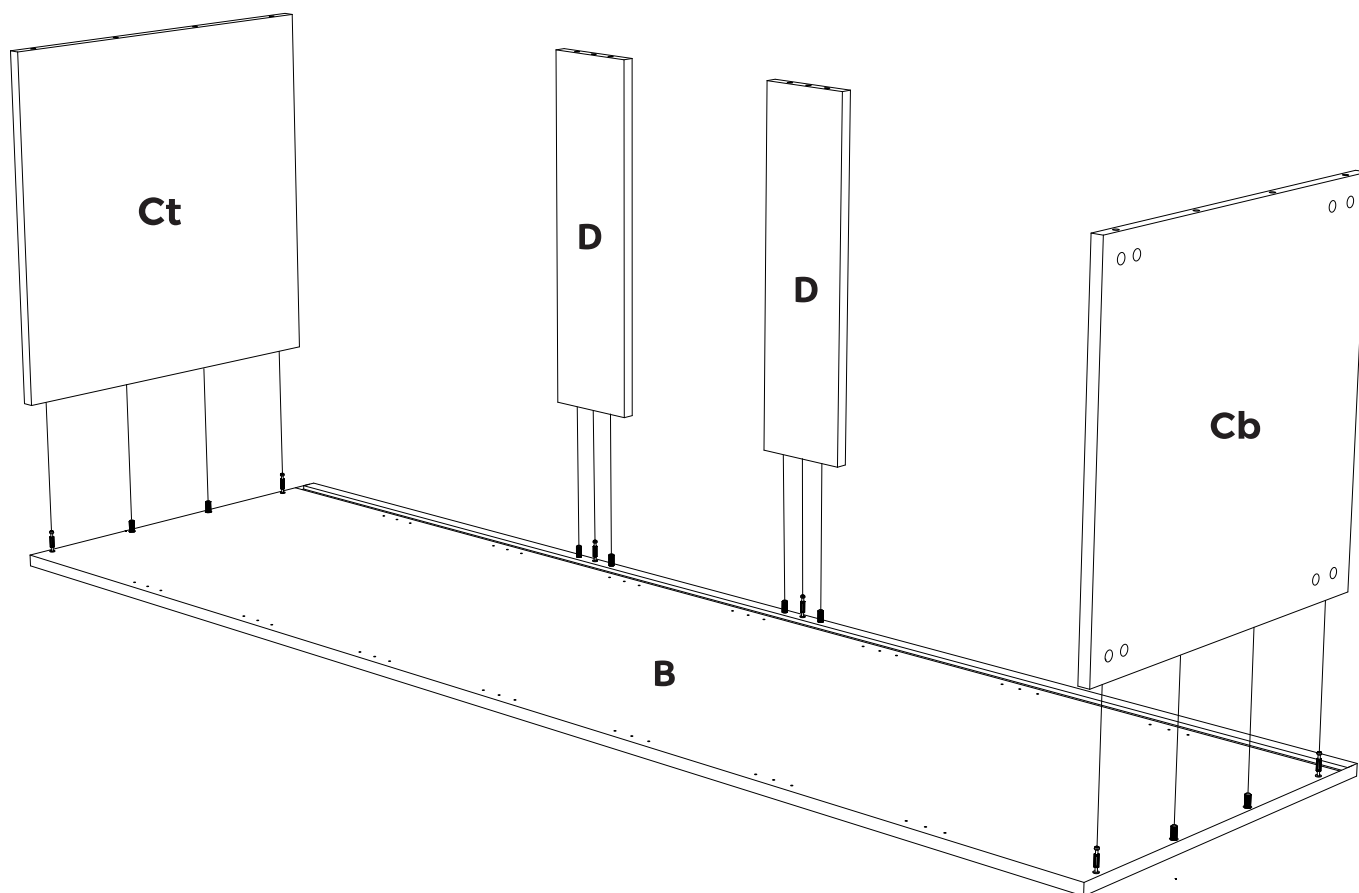

### Step 4.

Slide back panel **(A)** into groove of end panel **(B)**.

Ensure the back is in-line with top and bottom fixed shelves.

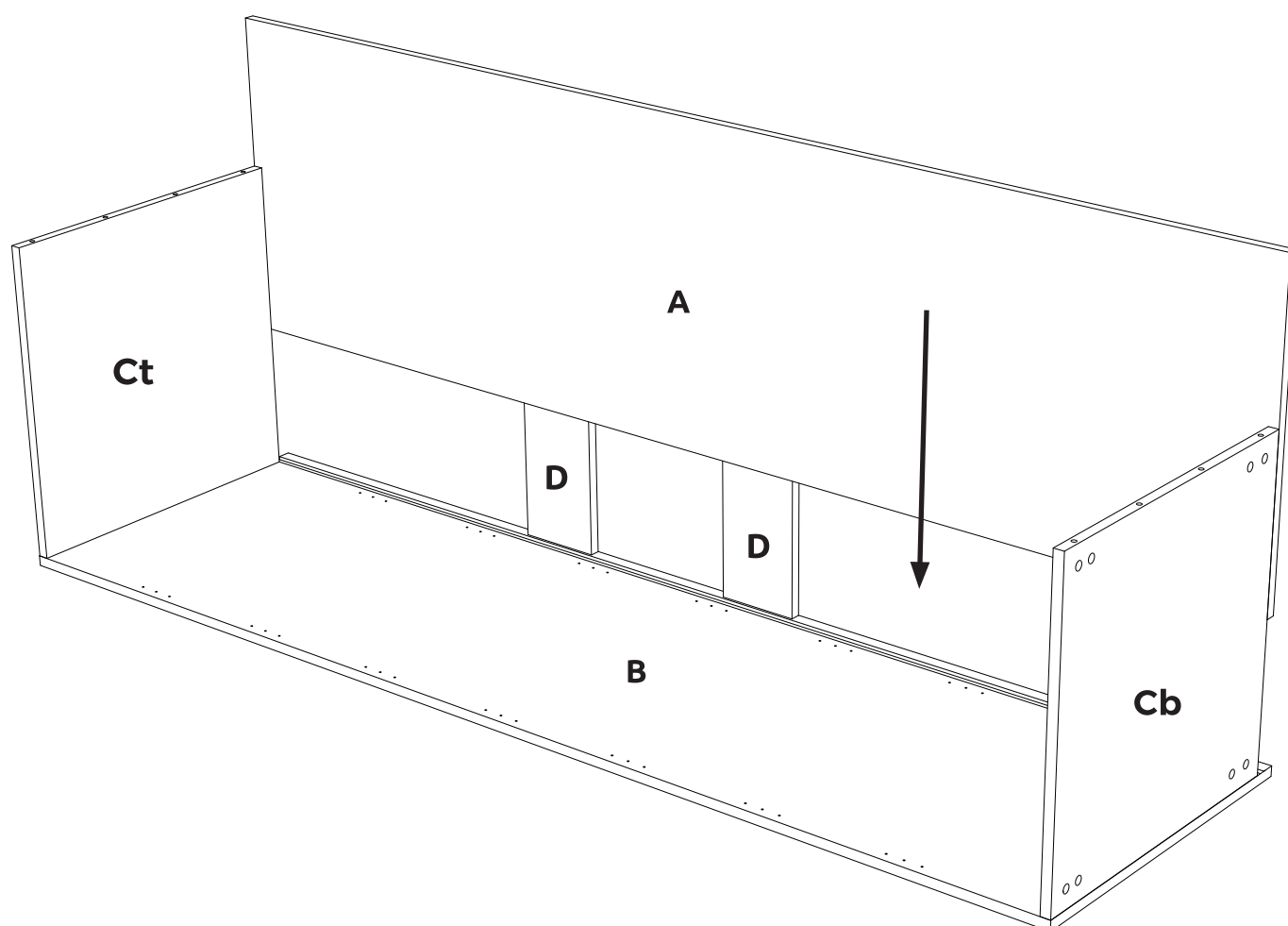



### Step 5.

Attach panel **(B)** to panels **(Ct)**, **(Cb)** & **(D)**, using cam dowels **(W)**, and also using dowels **(F)** in positions as shown.

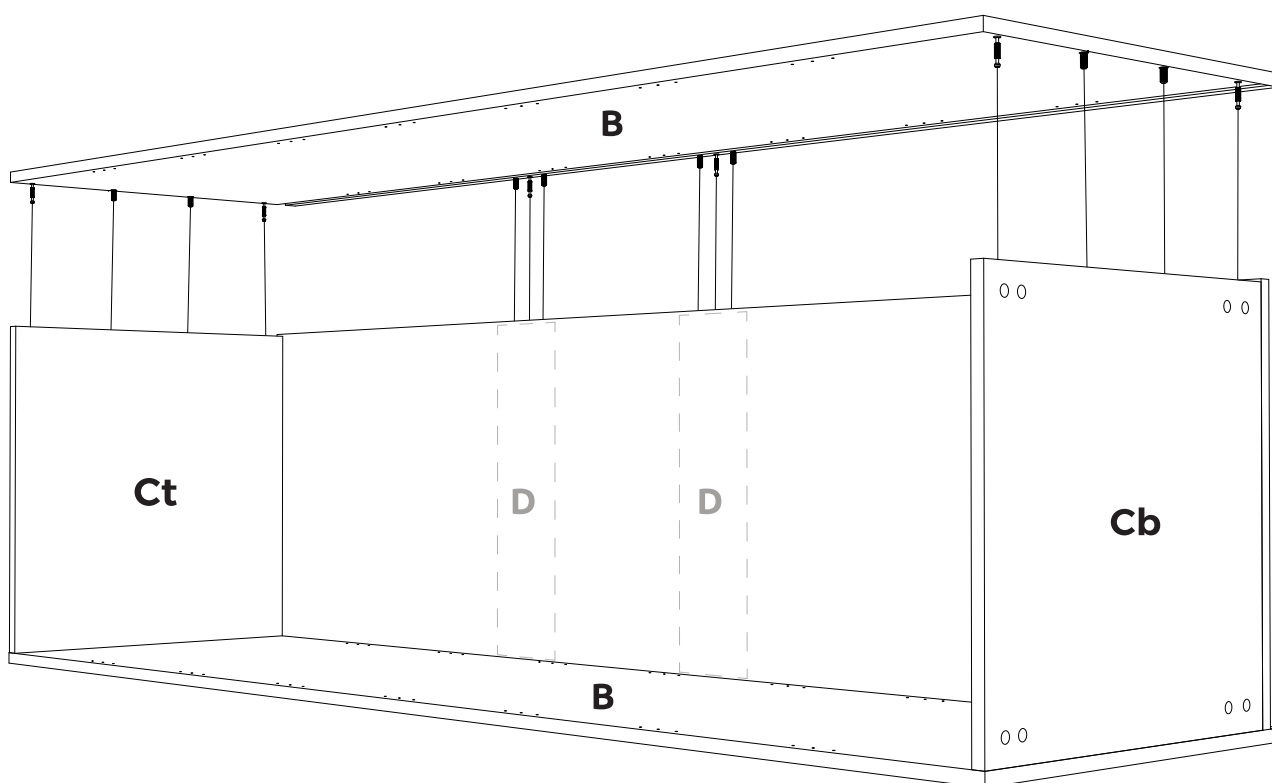

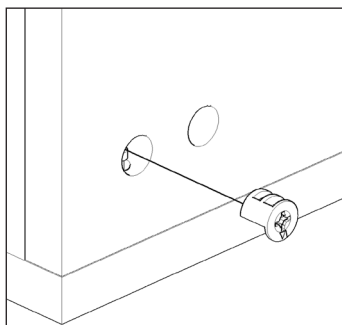

### Step 6.

Insert cam locks **(H)** and hand tighten, this will tighten the unit together.

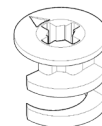

Do **not** use power tools with cam dowels **(W)**

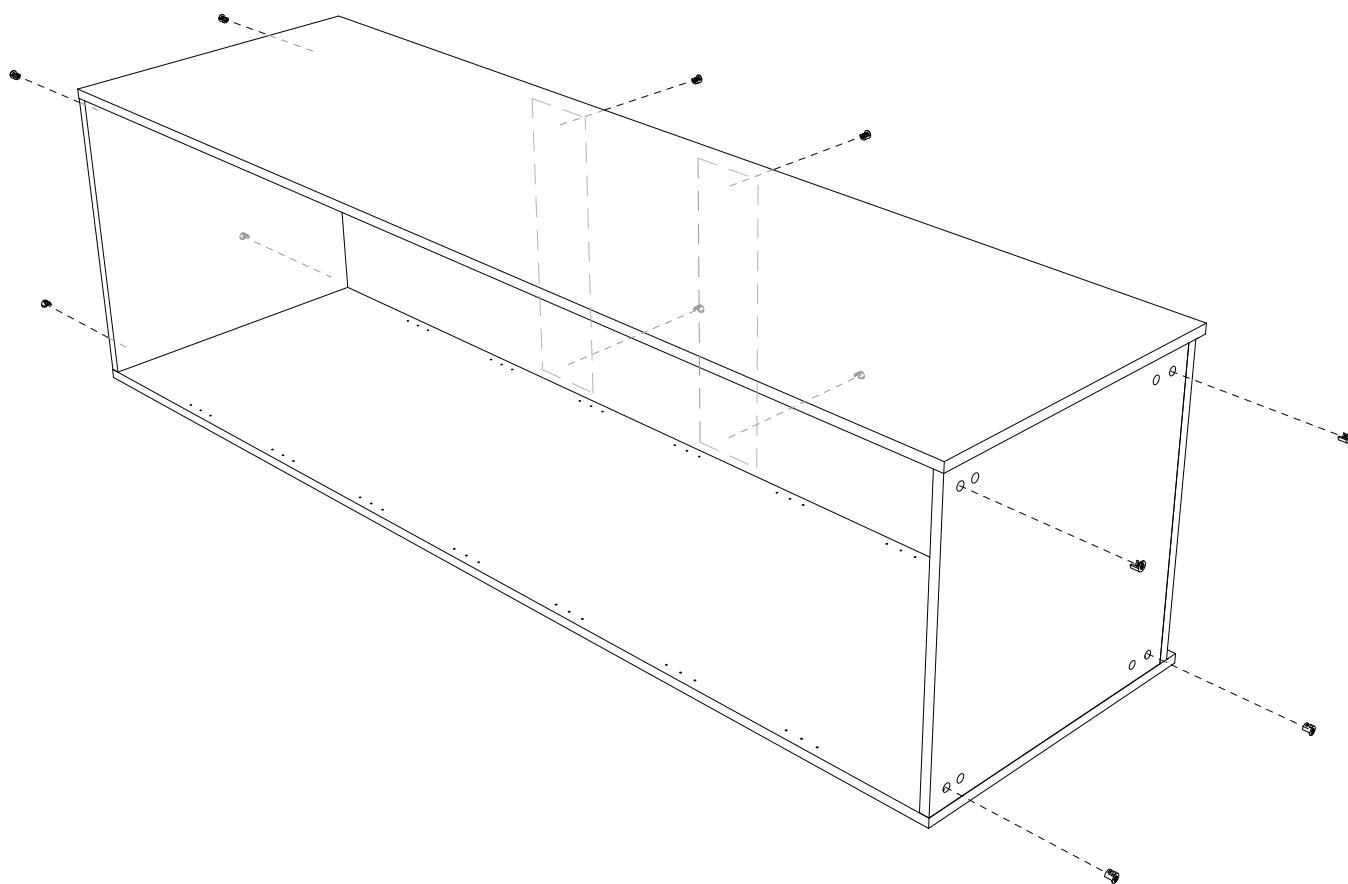

### Step 7.

Ensure the unit is square. Secure back panel **(A)** with 45mm screws **(P)** through the pre drilled holes in the top and bottom of the back panel **(A)** into the fixed shelves **(Ct)** and **(Cb)** as shown.

**The number of screws required depends on the width of the unit.**

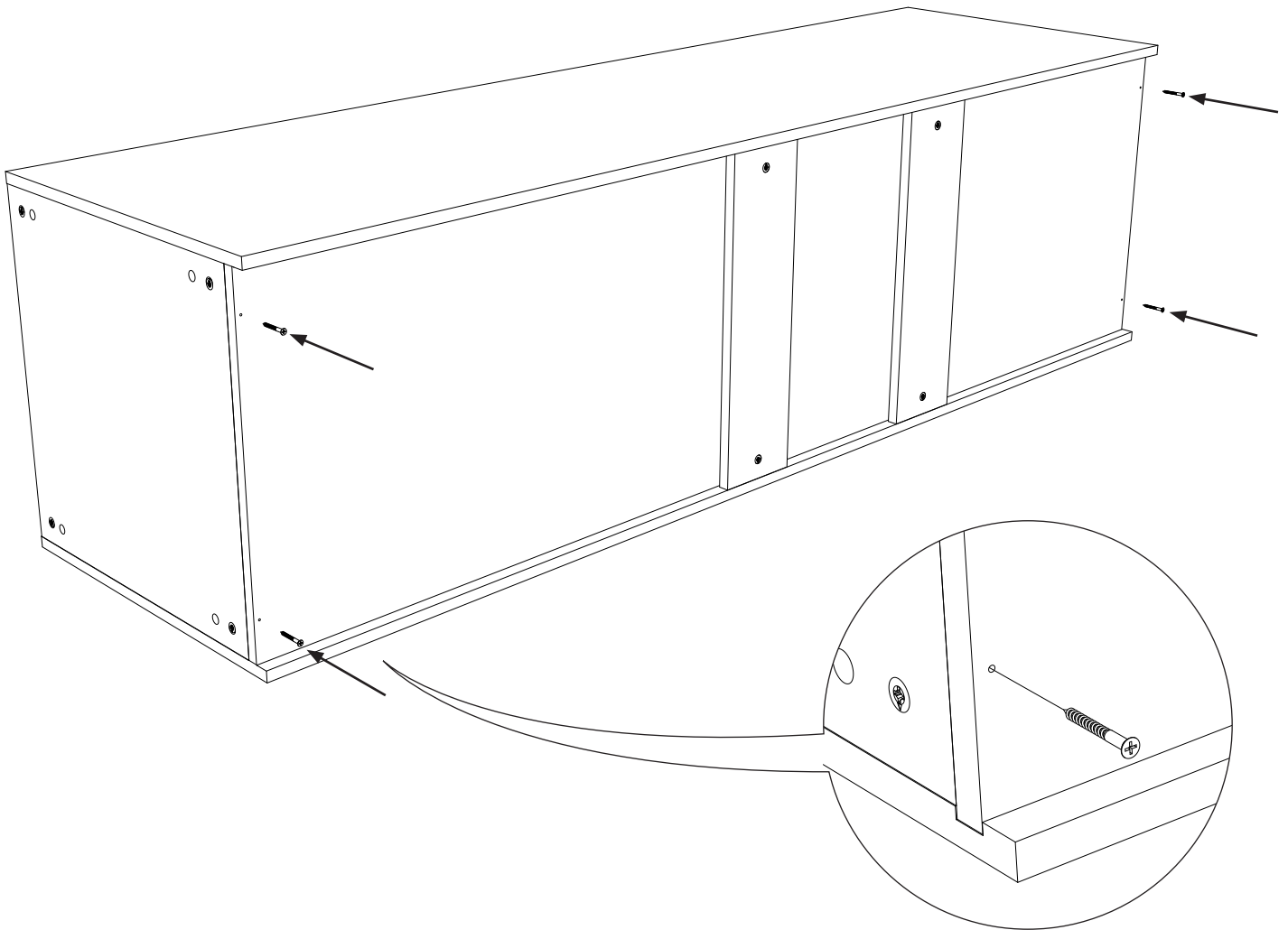

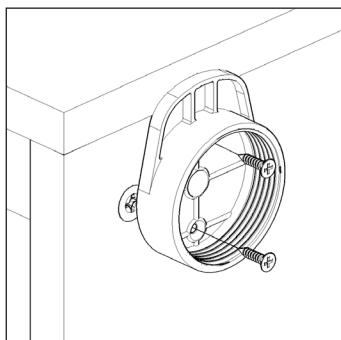

### Step 8.

Position the top section of the legs as shown. Ensure legs are rotated to provide support to the end panels **(B)**. Secure with 2 x 15mm screws **(L)** per leg. Attach the bottom section of the legs and set all legs to the same height.

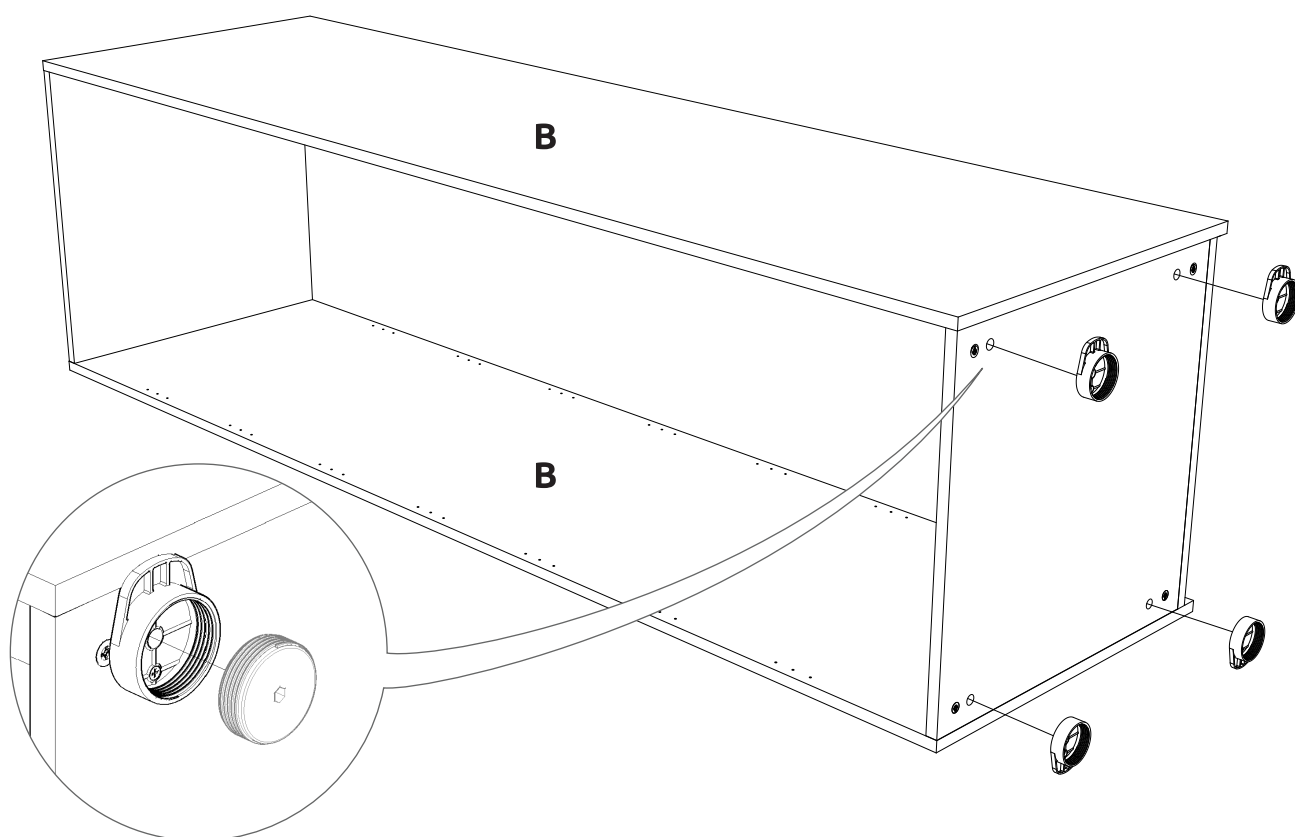

It is **important** to lift the unit onto its legs. Do not tilt as depicted in the image.



### Step 9.

Lift the unit upright. Once in situ, level accordingly using an 8mm hex key from inside the unit.  
Cover leg holes with 15mm cover caps **(LL)**.

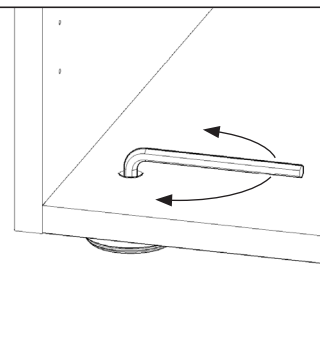



**Screws for fixing to walls are not provided as these vary depending on your wall material and construction. Ensure appropriate fixings for wall constructions are used.**

### Step 10.

Ensure the unit is level and positioned correctly.

Wren recommends securing the robe to the wall using rails **(D)**. Drill pilot holes through back panel **(A)** and rails **(D)** into the wall. Screw through the pilot holes into the wall, place cover stickers on the heads to conceal them. If unable to use the rails **(D)** to secure the robe to the wall use the anti-tipping brackets provided. Attach the brackets to the top of the robe using 15mm screws **(L)** provided. Screw through the brackets into the wall.

### Step 11.

Screw into any adjacent units using 30mm screws **(K)** provided to secure the unit. Screw just to the rear of the loose shelf peg hole at the top, middle and bottom on both sides. The loose shelf will conceal the screw heads once in place.

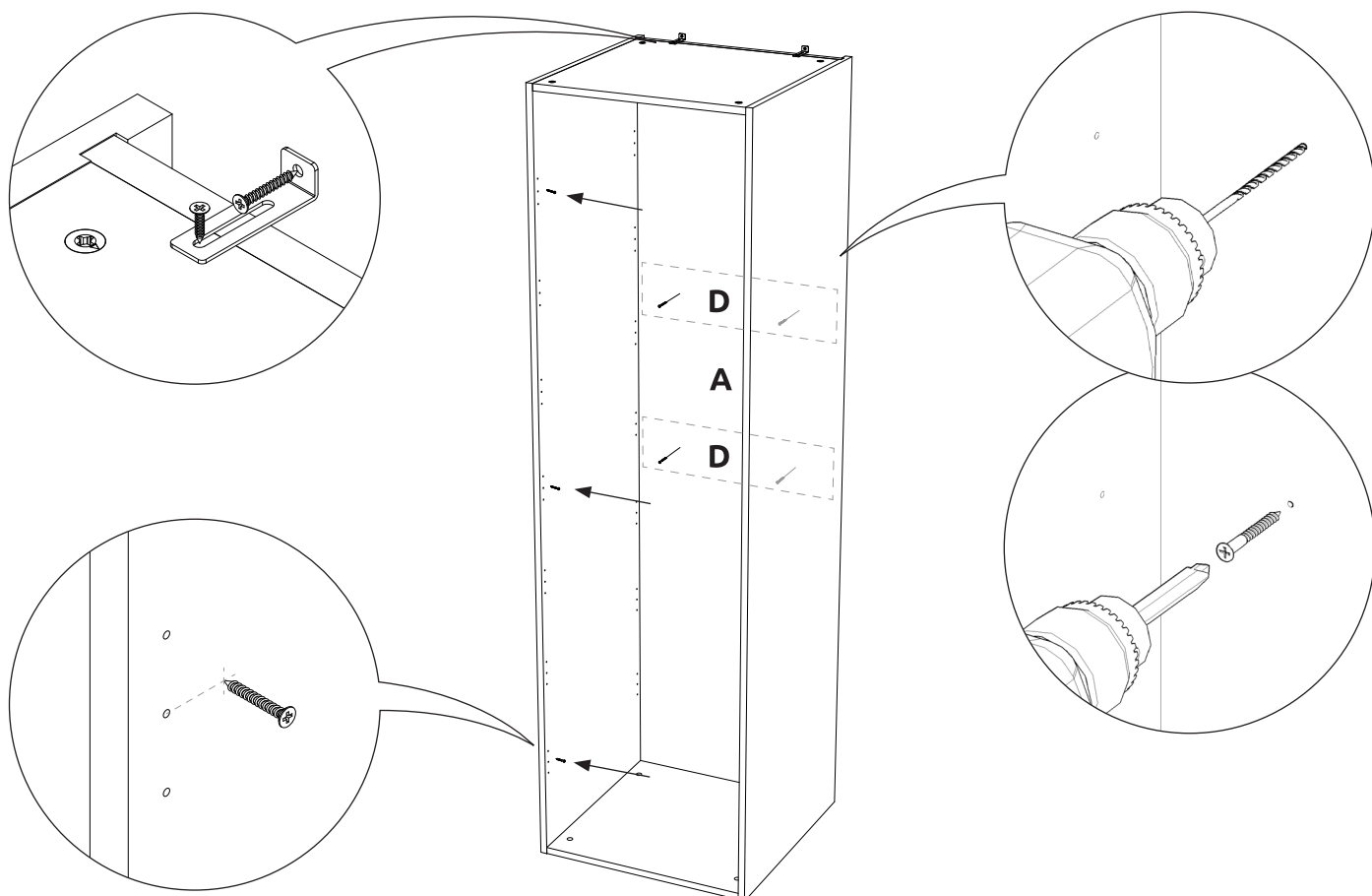

### Loose Shelves

Insert shelf pegs into holes on each end panel.

4 x shelf pegs are required per loose shelf.

Position loose shelf onto shelf pegs ensuring the shelf pegs locate in the holes on the bottom of the loose shelf.

**See customer-specific bedroom plan for position and number of loose shelves.**

