

## 400-1000, 1-2 Door Robe / Combi Robe Assembly Guide

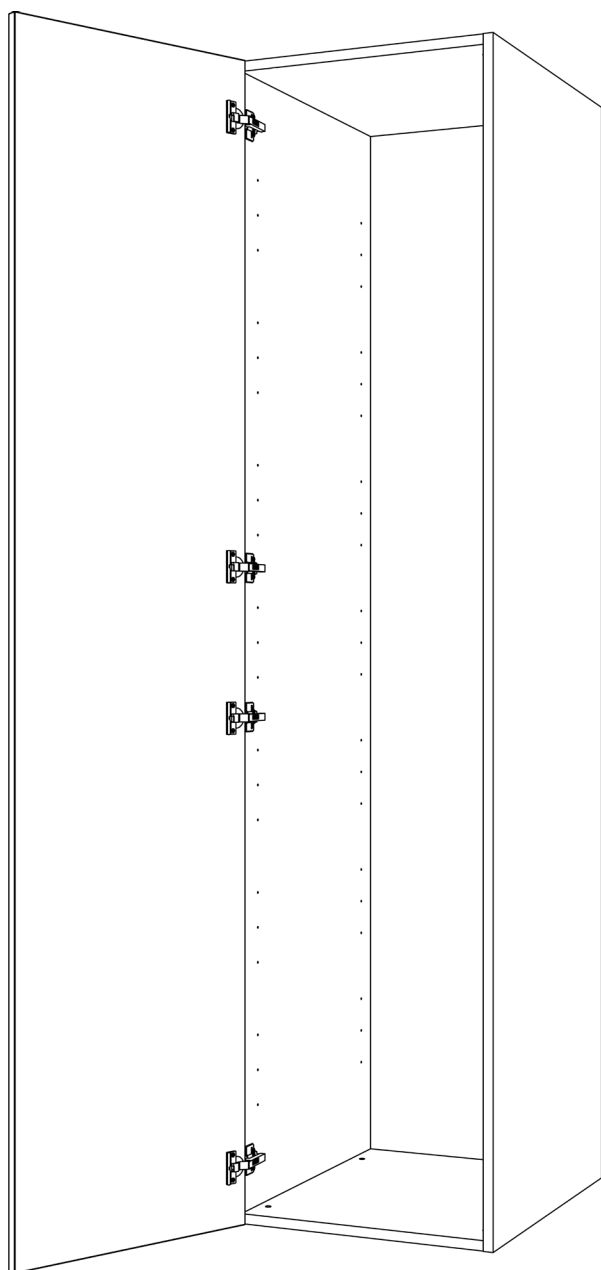

**Robe**

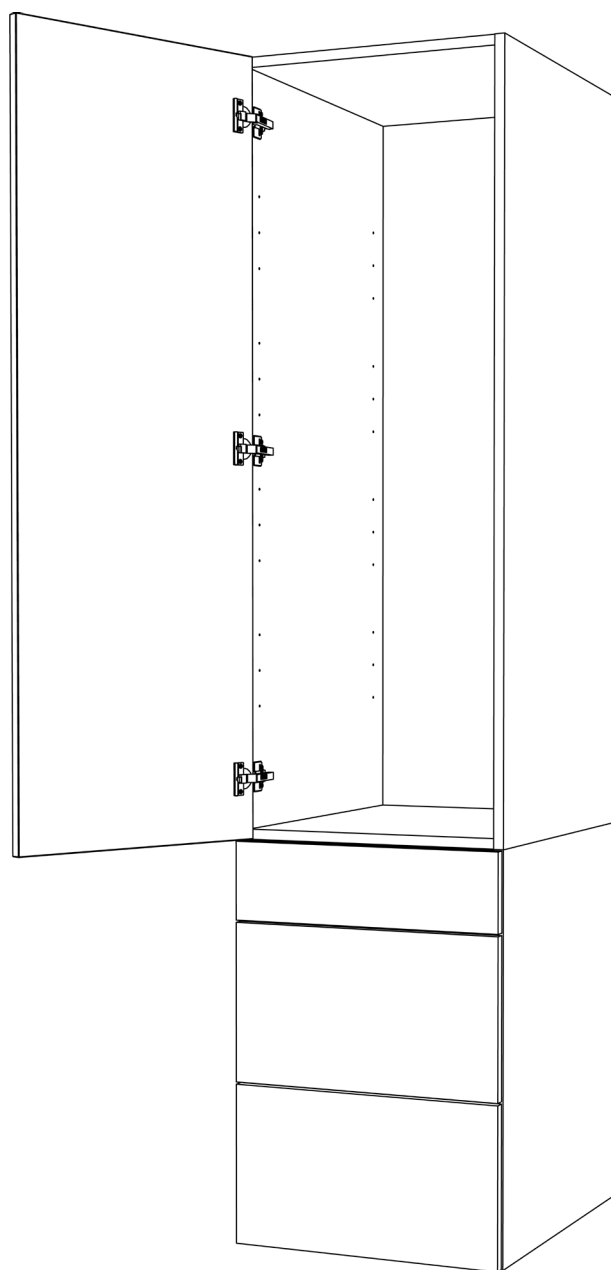

**Combi Robe**



### BEFORE YOU START

**THIS PRODUCT MUST BE SECURED TO THE WALL**

INSTALLATION SHOULD BE PERFORMED BY A COMPETENT PERSON ONLY.

THIS PRODUCT COULD BE DANGEROUS IF INCORRECTLY INSTALLED

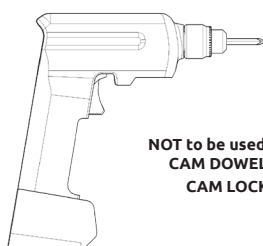
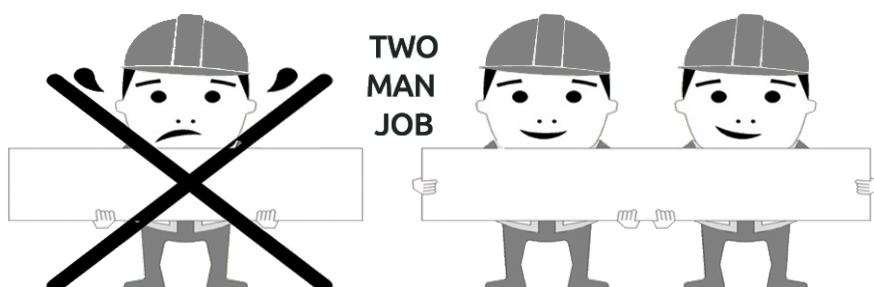

NOT to be used with  
CAM DOWEL &  
CAM LOCK

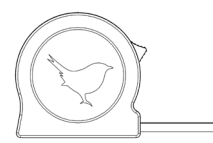
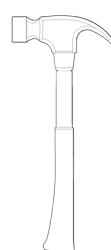

# CONTENTS

4	Robe panels
5	Components
6-12	Robe Assembly
13	Leg Attachment
14	Sliding Robe Leg Attachment
15	Hinge Plate Locations
16	Secure Robe To Wall & Adjacent Units
17-21	Internal Layout Options
22	Hanging Rail Locations
23-24	Internal Drawer Installation
25-26	Sliding Robe - Internal Drawer / Storage Installation
27	Combi Robe Secure Unit To Wall
28-29	Hinge Adjustment
30	Loose Shelf Fitting

## 400-1000, 1-2 Door Robe / Combi Robe Assembly Guide

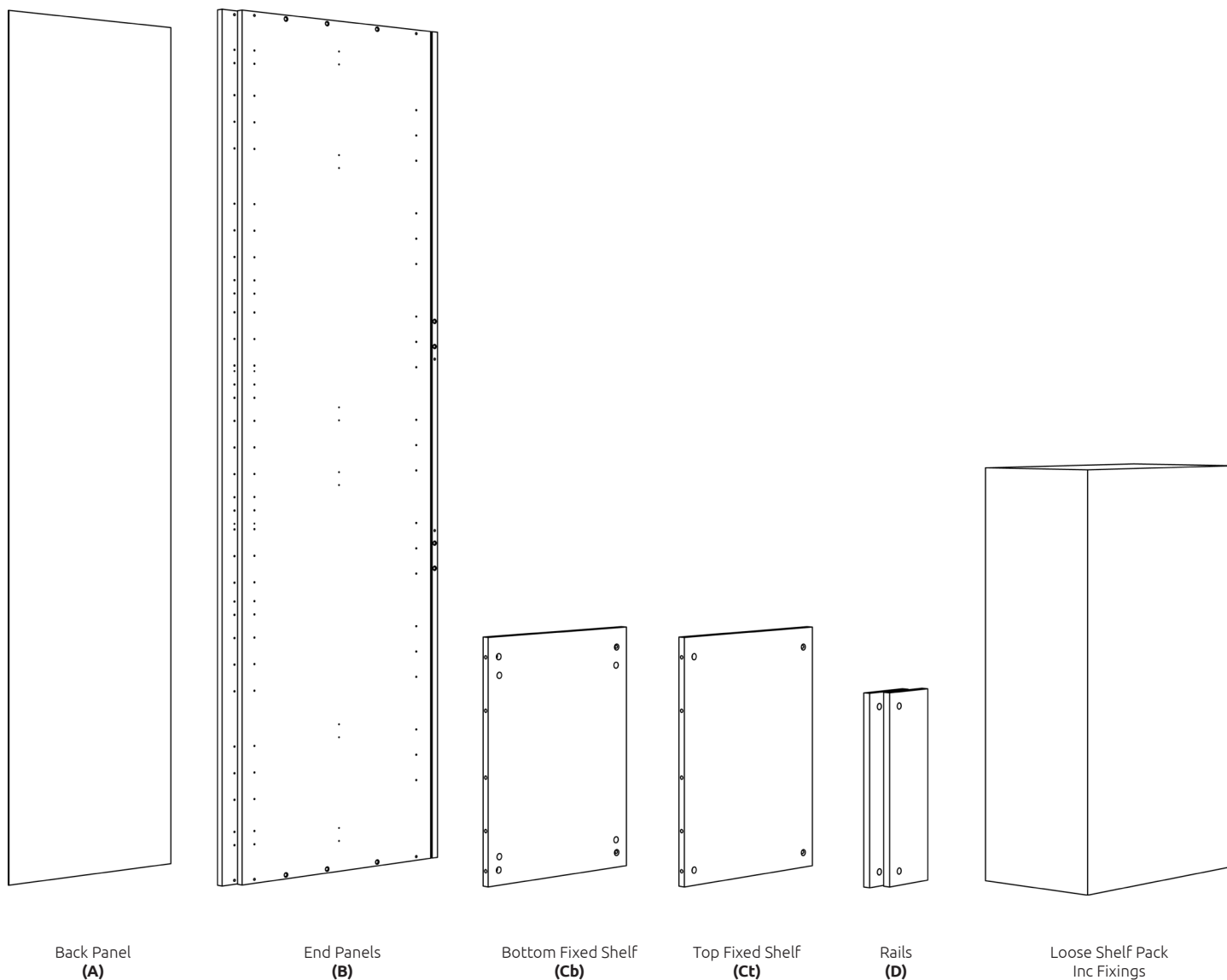

**RAILS PROVIDED WITH THIS UNIT MAY DIFFER IN COLOUR TO THE REST OF THE UNIT**

See Pages 17-21 for hanging rail / loose shelf layouts

## 400-1000, 1-2 Door Robe / Combi Robe Assembly Guide

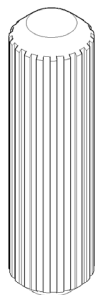

**(F) x20**  
Wooden  
Dowel



**(KK) x4**  
13.5mm  
Screw

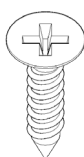

**(L) x28**  
15mm  
Screw

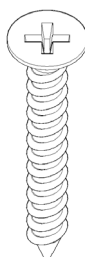

**(K) x12**  
30mm  
Screw



**(W) x12**  
Cam Dowel

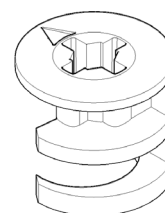

**(H) x12**  
Cam Lock

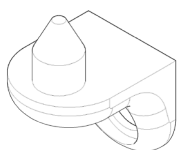

**(JJ) x4**  
Shelf Peg

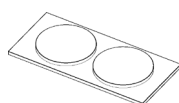

**(N) x6**  
Door Buffer

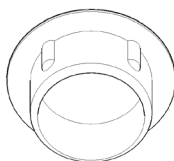

**(LL) x5**  
15mm  
Cover Cap

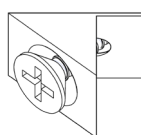

**(T) x16**  
Back Panel  
Clip

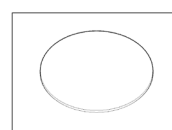

**x12**  
Stick On Cover Cap

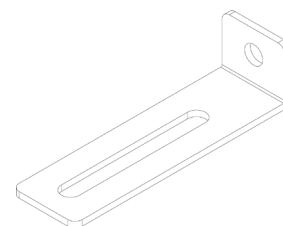

**x2**  
Anti Tipping  
Bracket

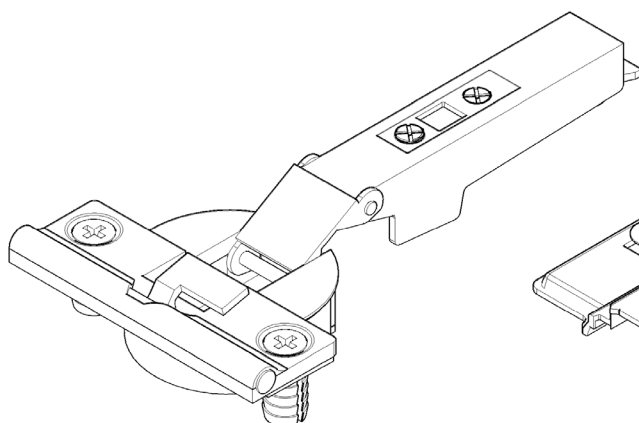

**Hinges**  
Inc Screws

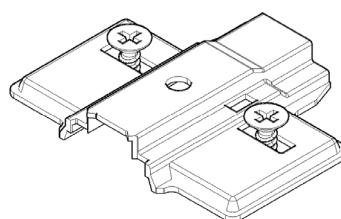

**Hinge Mounting Plates**  
Inc Screws

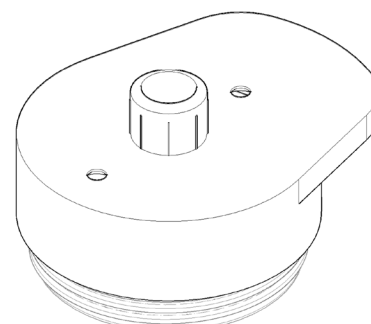

**Robe Legs**

## 400-1000, 1-2 Door Robe / Combi Robe Assembly Guide

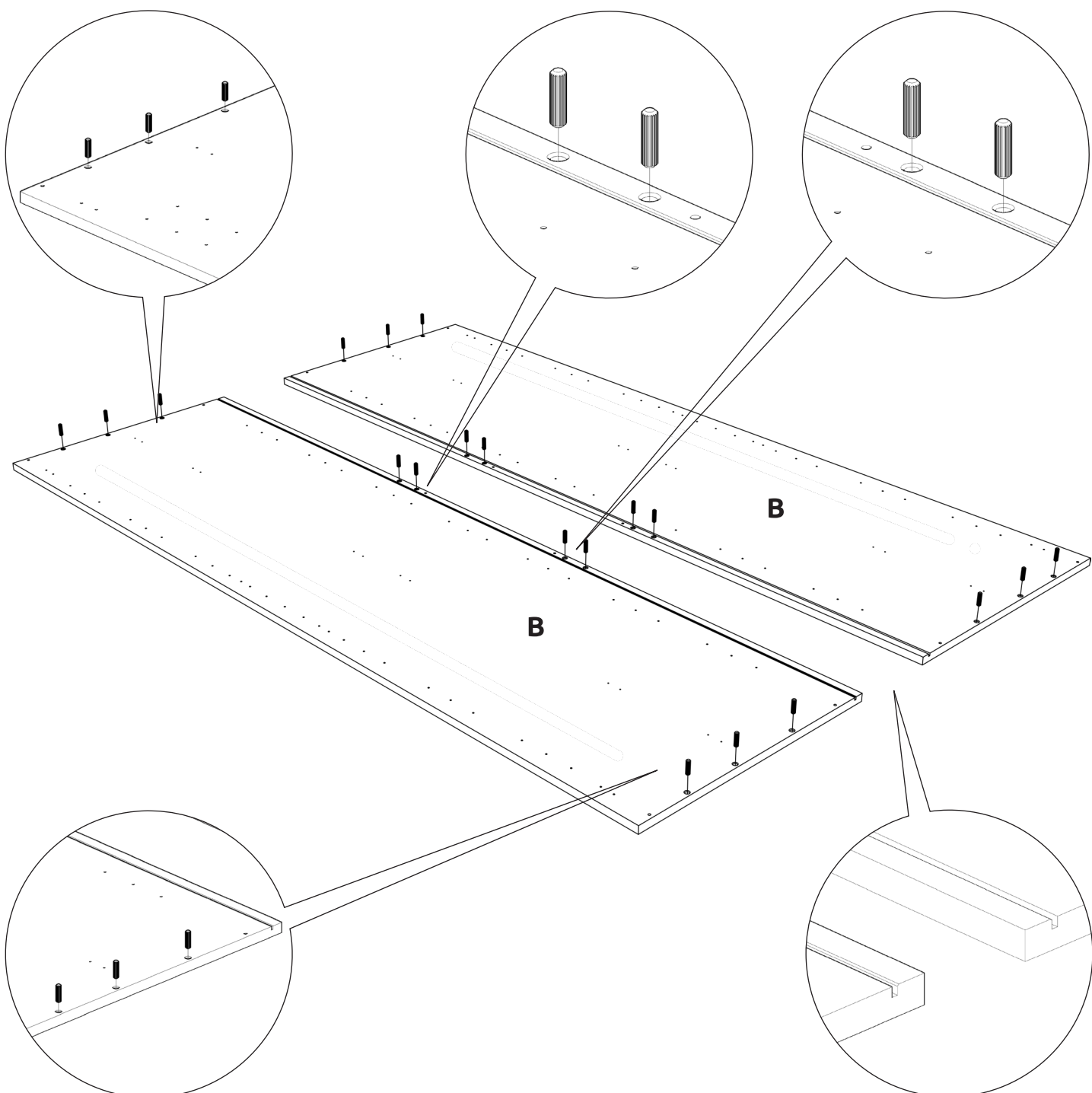
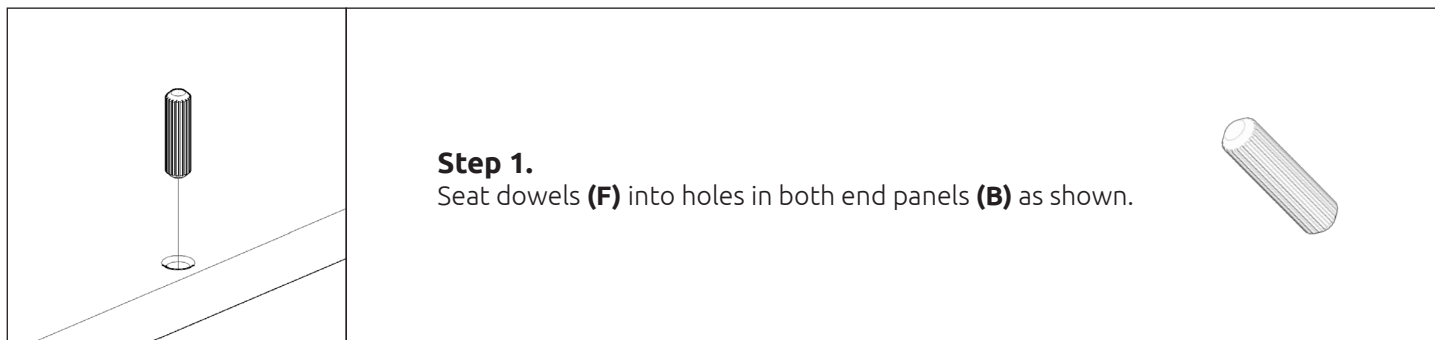

## 400-1000, 1-2 Door Robe / Combi Robe Assembly Guide

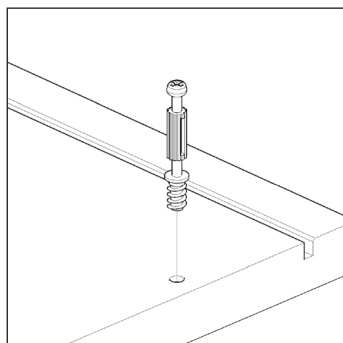

### Step 2.

Seat cam dowels **(W)** into holes in both end panels **(B)** as shown.

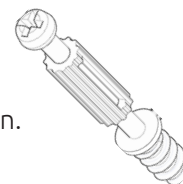

Do **not** use power tools with cam dowel **(W)** or cam lock **(H)**

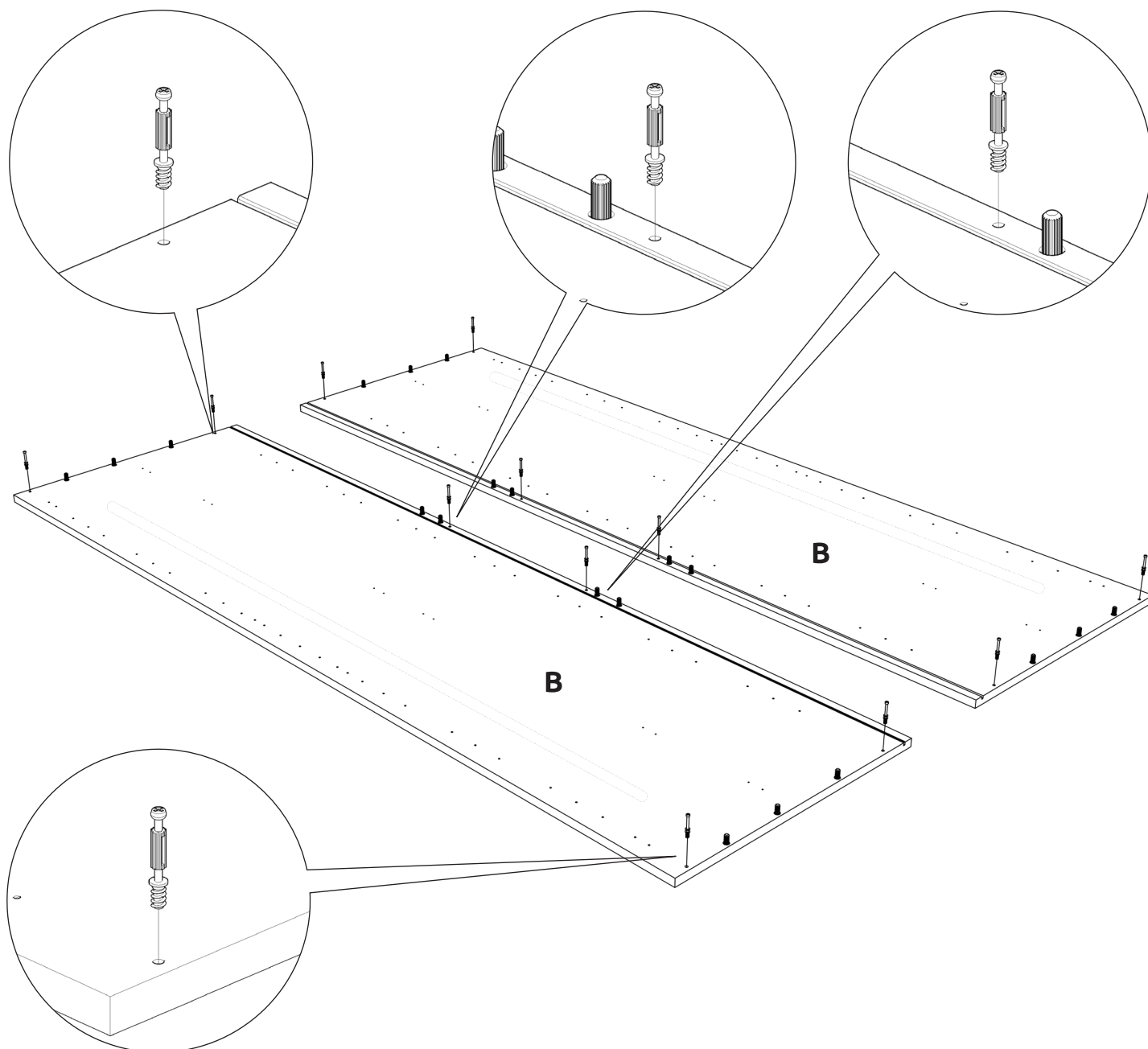

## 400-1000, 1-2 Door Robe / Combi Robe Assembly Guide

### Step 3.

Attach panels **(Ct)**, **(Cb)** & **(D)** to panels **(B)**, using cam dowels **(W)**, and also using dowels **(F)** in positions as shown.



All cam locks **(H)** are to be positioned facing the outside of the unit, for ease of tightening.

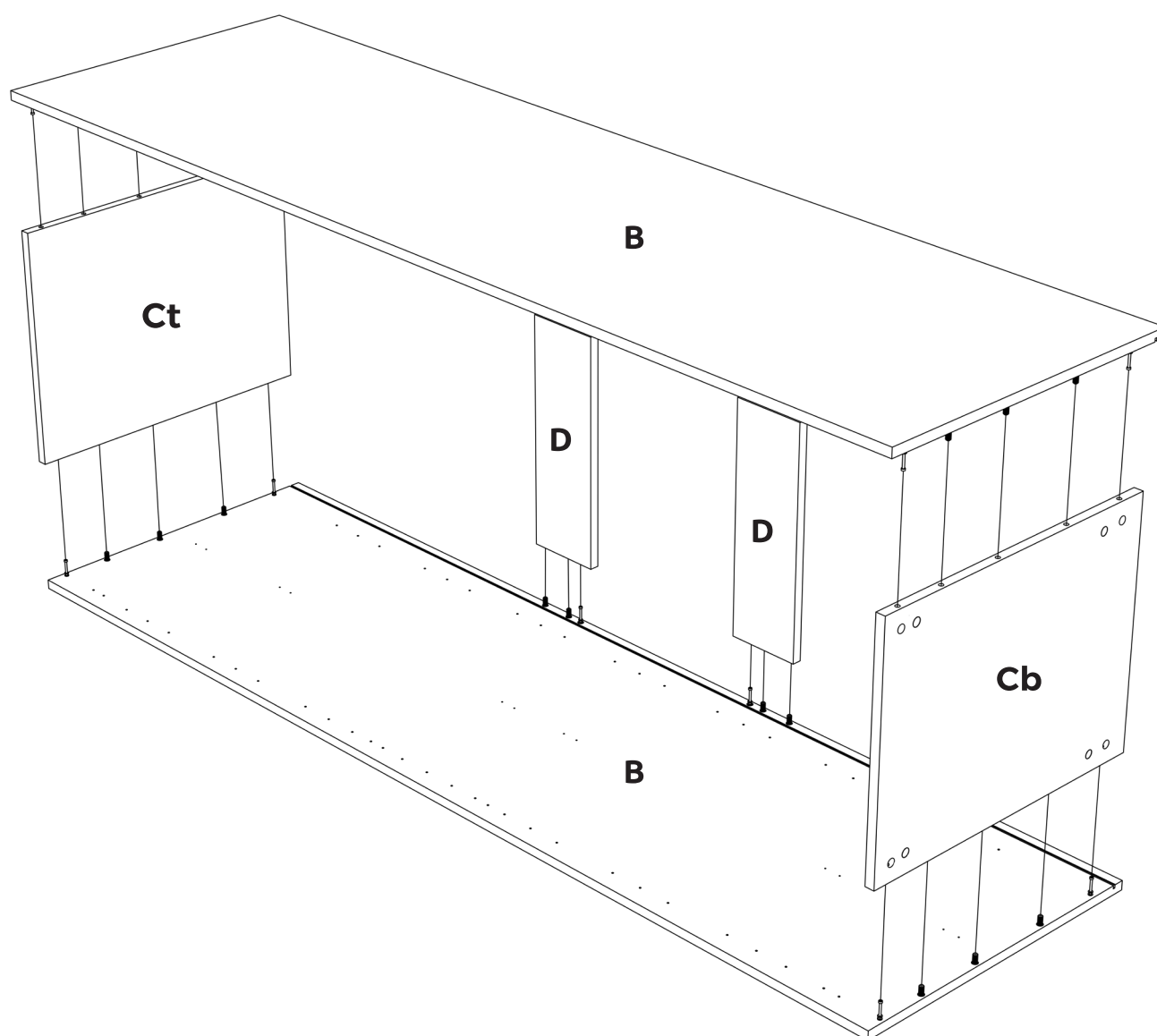



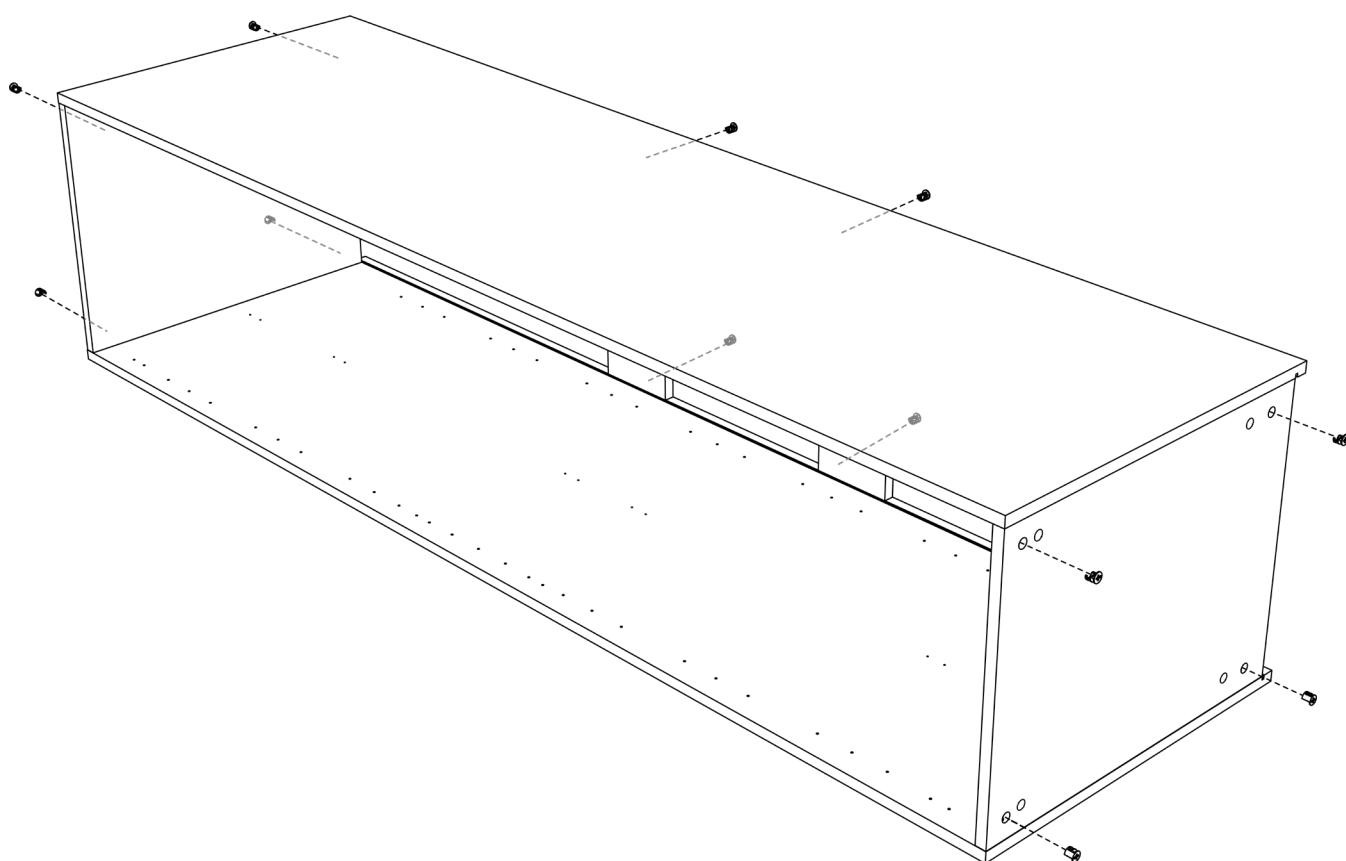
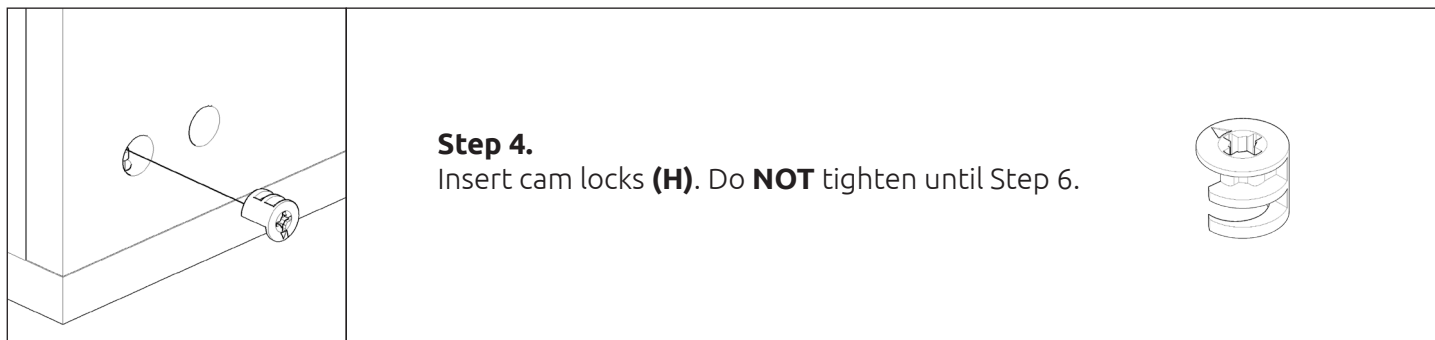

## 400-1000, 1-2 Door Robe / Combi Robe Assembly Guide

### Step 5.

Trim the edgeband covering the groove on the bottom of the end panels.

Slide back panel **(A)** into groove of end panels **(B)**.

Once back panel **(A)** is in position, ensure the panel is flush & square with bottom of end panels **(B)**.

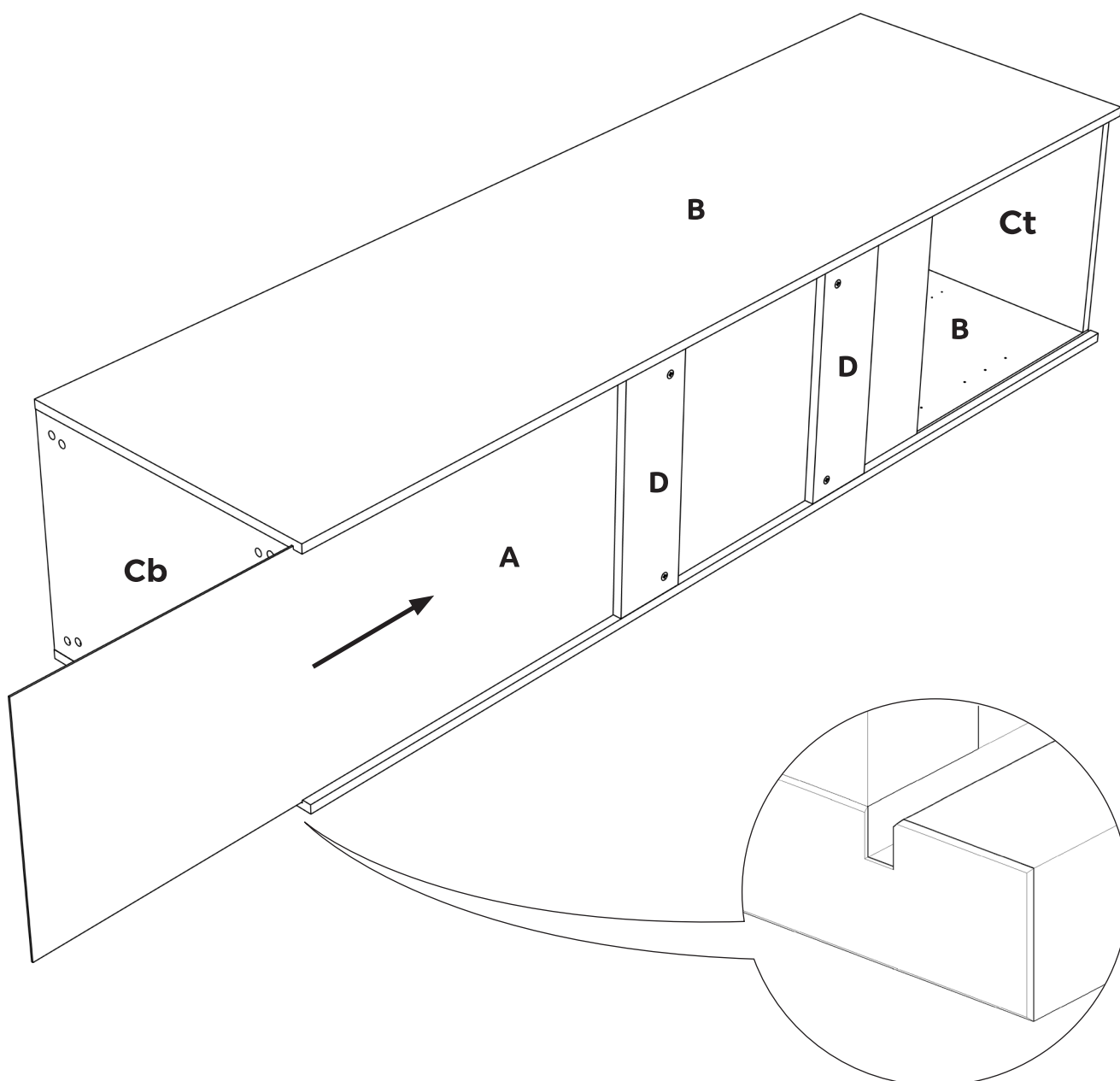

## 400-1000, 1-2 Door Robe / Combi Robe Assembly Guide

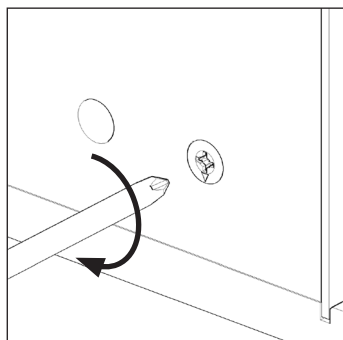

### Step 6.

Hand tighten all cam locks **(H)**, this will tighten the unit together.

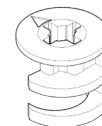

Do **not** use power tools with cam dowel **(W)** or cam lock **(H)**

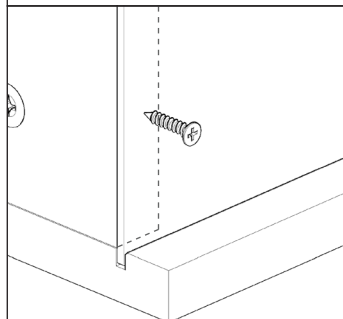

### Step 7.

Ensure unit is square. Secure back panel **(A)** with 15mm screws **(L)** equally spaced at the top and bottom of back panel **(A)** into the fixed shelves **(Ct)** and **(Cb)** as shown. Ensure you screw into the centre of fixed shelves **(Ct)** and **(Cb)**. (9mm from the edge).

**400 - 500 Widths: 6 x 15mm Screws**

**800 - 1000 Widths: 12 x 15mm Screws**

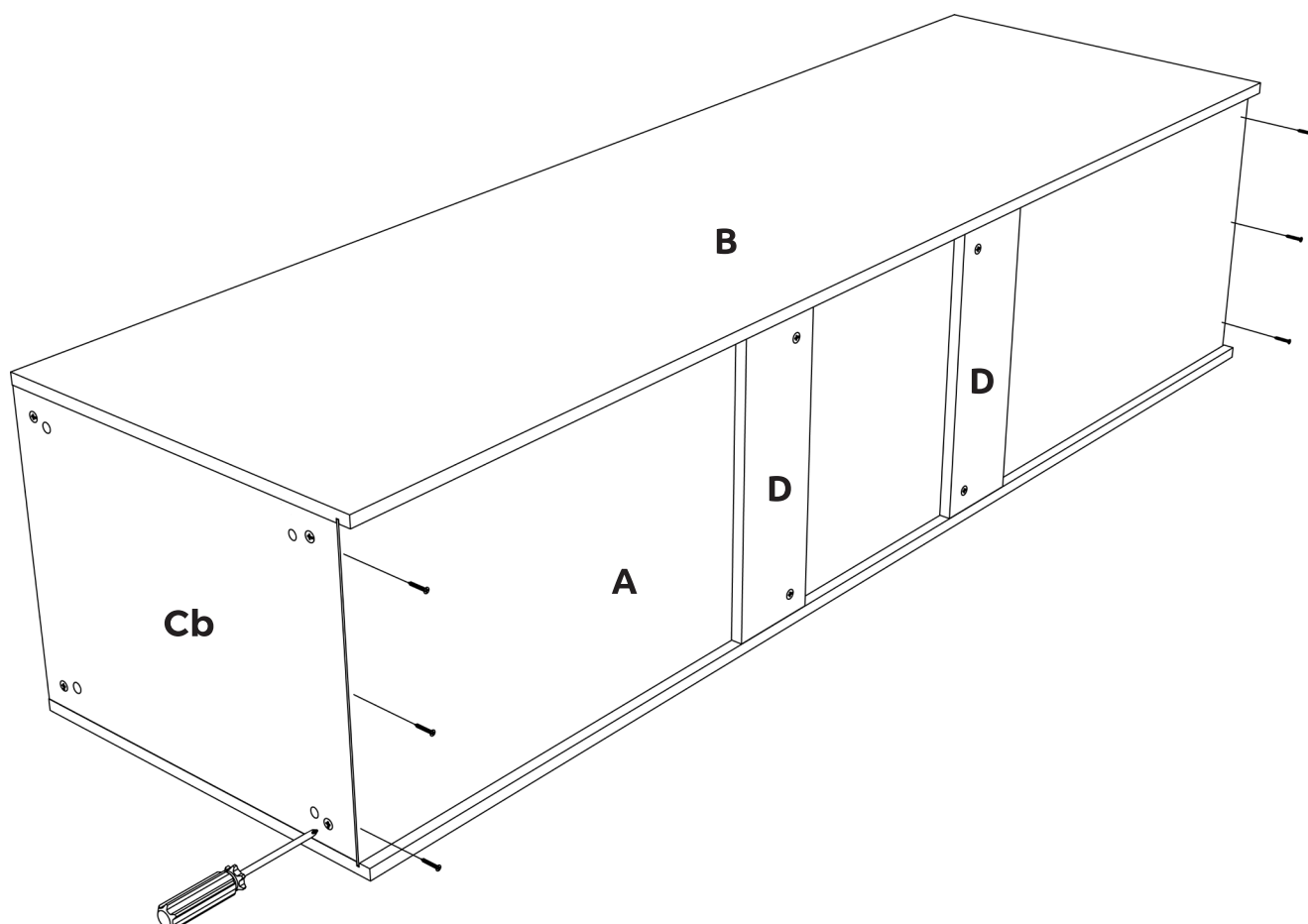
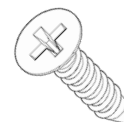

## 400-1000, 1-2 Door Robe / Combi Robe Assembly Guide

### Step 8.

Secure back panel using 16 x back panel clips **(T)**.

Slide the back panel clips **(T)** into the groove of both end panels **(B)**. The back panel clips **(T)** should be evenly spaced as shown . Once in place, tighten screw.

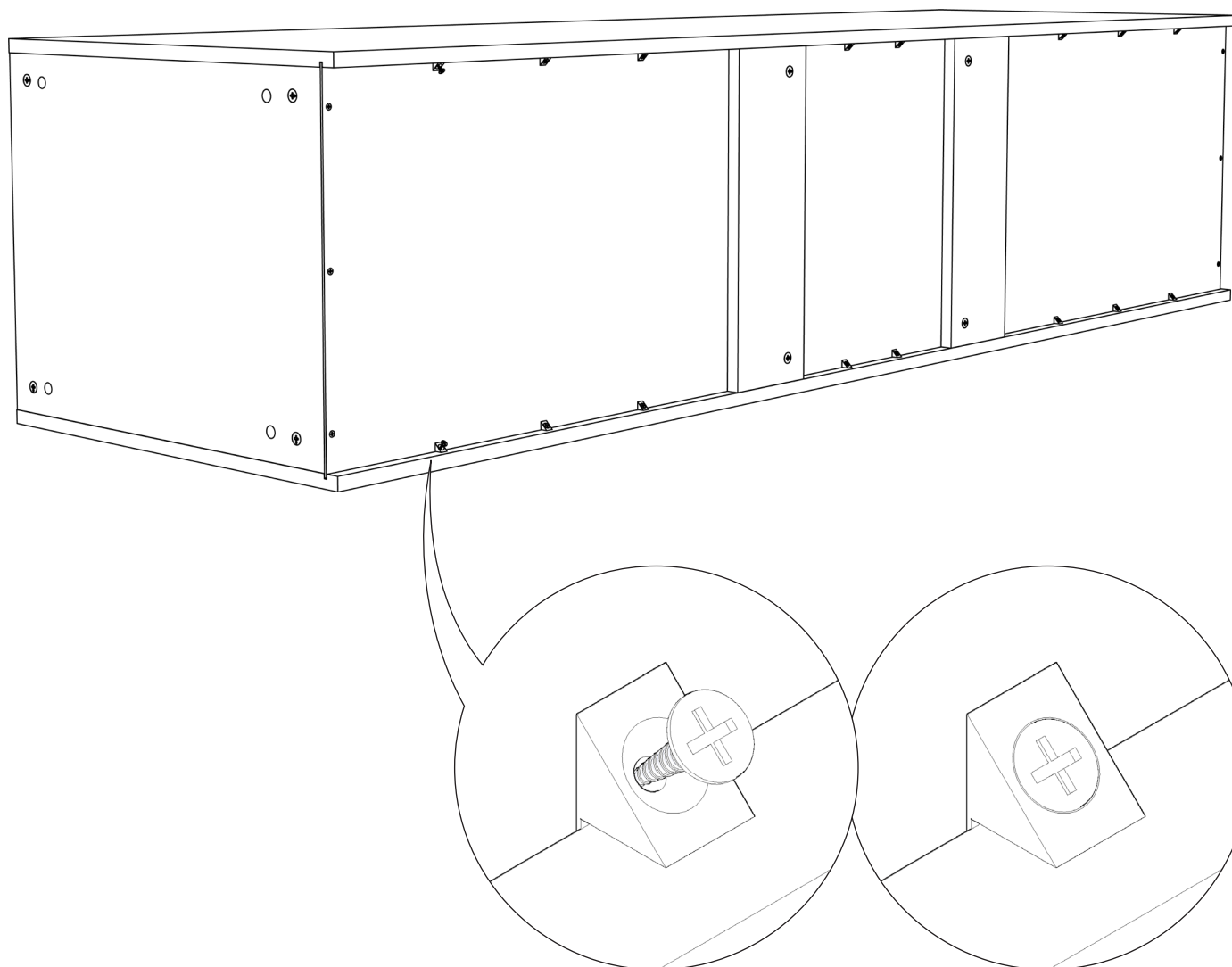
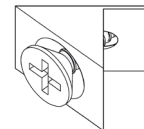

For adjustable and stable corner units  
please refer to fitting pack Instruction  
**FI.PK.BED.111.009 or FI.PK.BED.111.010**  
in your Adj/Stable corner pack for following steps

## 400-1000, 1-2 Door Robe / Combi Robe Assembly Guide

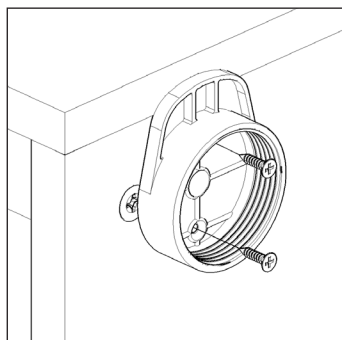

### Step 9.

Position top section of legs as shown. Ensure legs are rotated to provide support to the end panels **(B)**. Secure with 2 x 15mm screws per leg. Attach bottom section of legs and set all legs to the same height.

**400 - 500 Widths: 4 Legs**

**800 - 1000 Widths: 5 Legs**

**FOR SLIDING ROBE LEGS PLEASE SEE PAGE 14**

**For floor to ceiling sliding doors use these legs.**

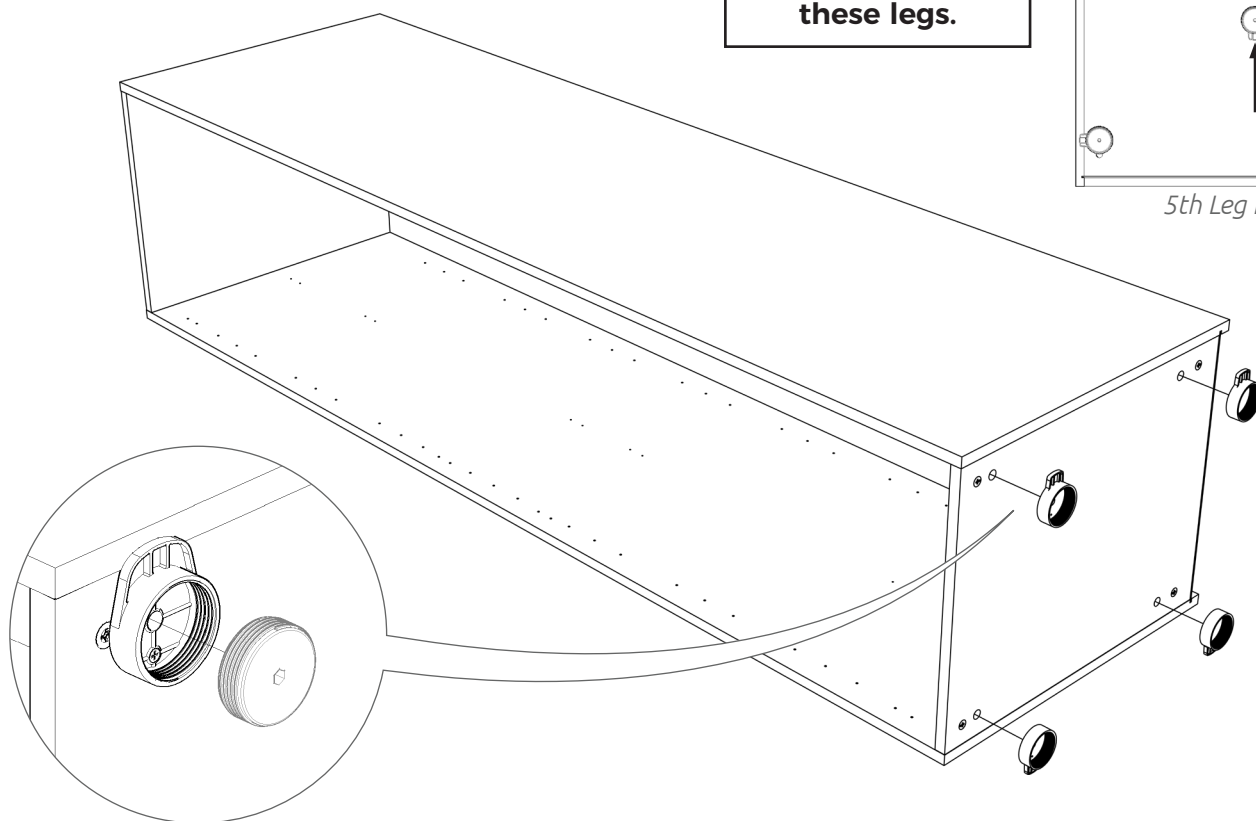
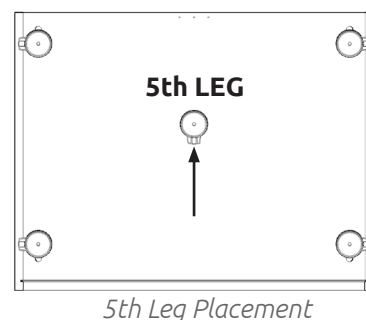

It is **important** to lift unit onto its legs. Do not tilt as depicted in image.



### Step 10.

Lift the unit upright. Once in situ level accordingly, using an 8mm hex key from inside the unit.

Cover leg holes with 15mm cover caps **(LL)**.

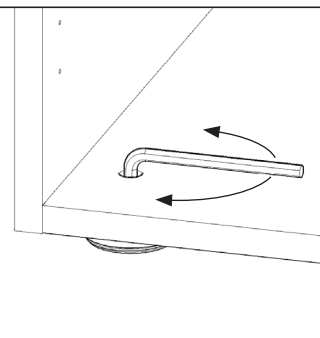

## 400-1000, 1-2 Door Robe / Combi Robe Assembly Guide

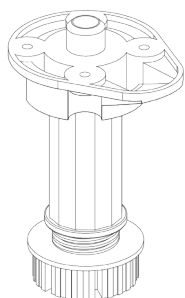

Standard Legs

### Sliding Robe Specific

#### Step 9.

The rear 2 legs (+ extra 5th leg if required) will use the existing leg positions.  
Position the 2 front legs as shown. Ensure legs are rotated to provide support to the end panels **(B)**. Secure all legs with 4 x 15mm screws and adjust all legs to 105mm.

**400 - 500 Widths: 4 Legs**

**800 - 1000 Widths: 5 Legs**

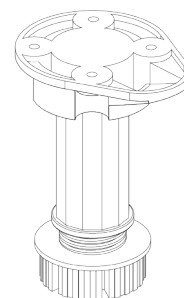

Front 2 Legs

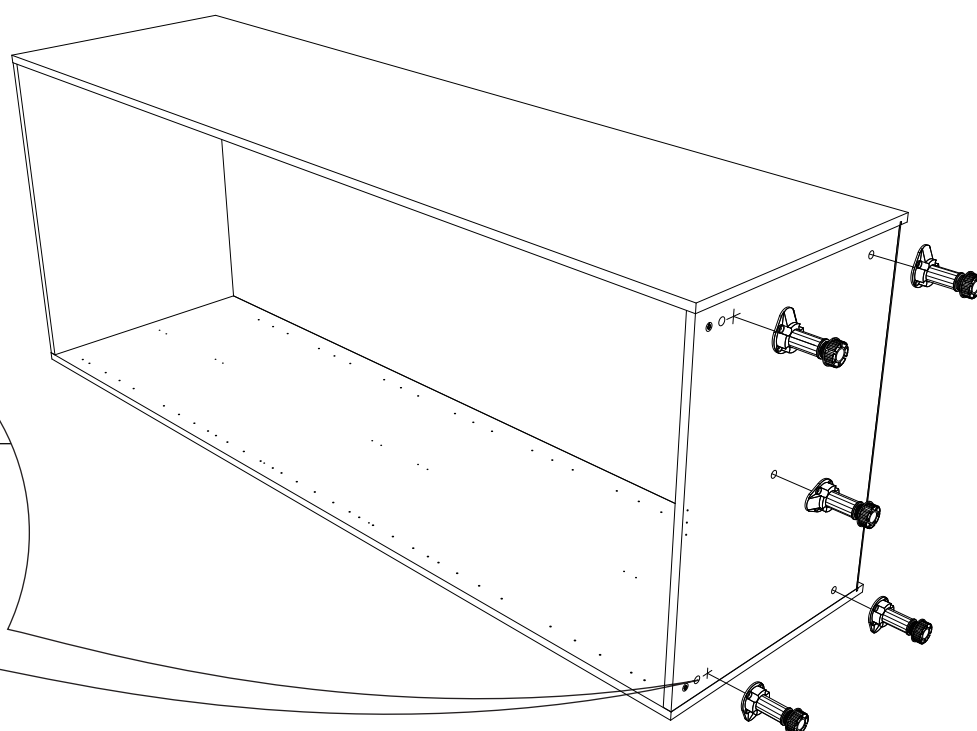
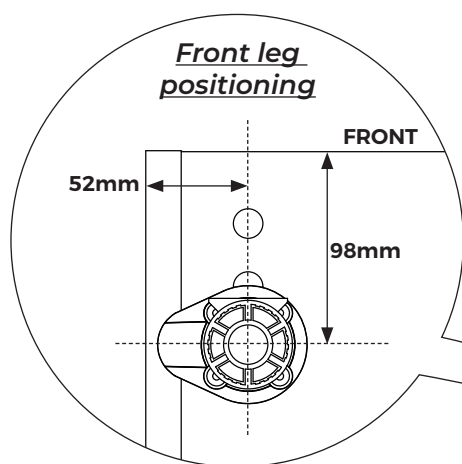
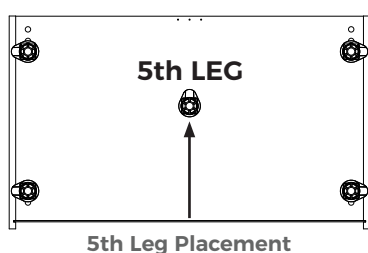

It is **important** to lift unit onto its legs. Do not tilt as depicted in image.



#### Step 10.

Lift the unit upright. Once in situ level accordingly.  
Cover leg holes with 15mm cover caps **(LL)**.

400-1000, 1-2 Door Robe / Combi Robe Assembly Guide

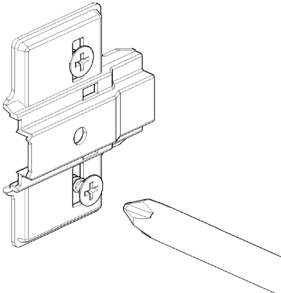

**Step 11. (Where Required)**  
Attach hinge plates onto end panels **(B)** to suit as shown using 2 screws already in hinge plates.

**Hinge side to be mounted in accordance to customer specific bedroom plan.**

2100 Robe

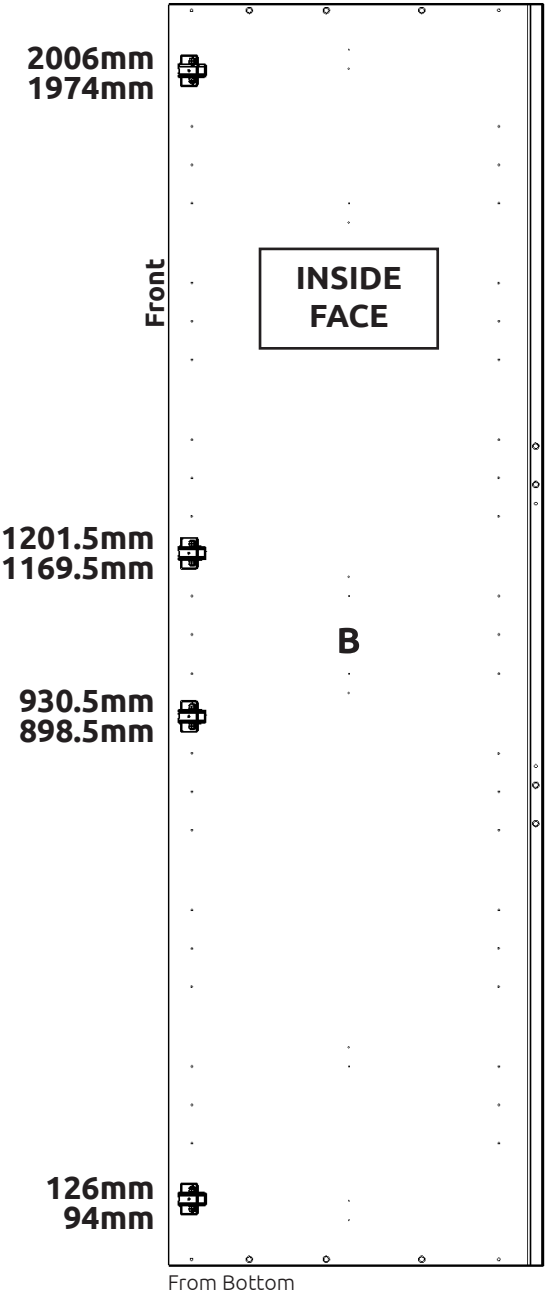

1380 Combi Robe

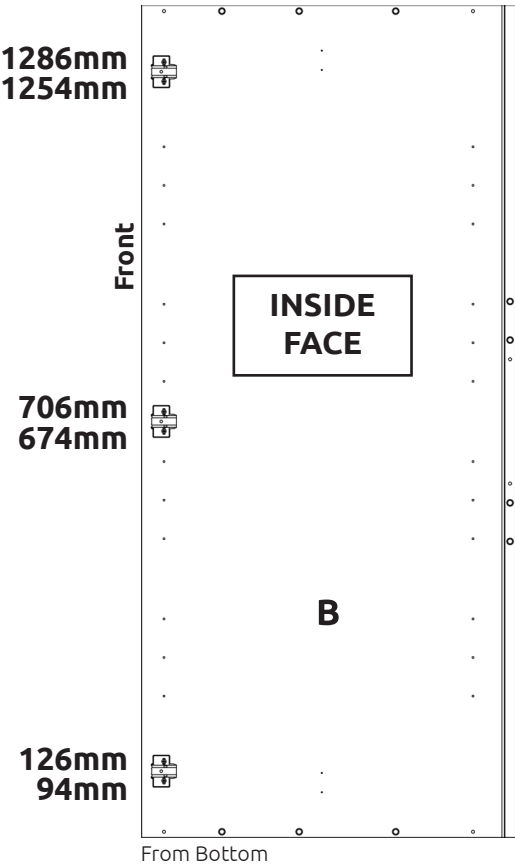

## 400-1000, 1-2 Door Robe / Combi Robe Assembly Guide



**Screws for fixing to walls are not provided as these vary depending on your wall material and construction. Ensure appropriate fixings for wall constructions are used.**

### Step 12.

Ensure the unit is level and positioned correctly.

Wren recommends securing the robe to the wall using rails **(D)**. Drill pilot holes through back panel **(A)** and rails **(D)** into the wall. Screw through the pilot holes into the wall, place cover stickers on the heads to conceal them. If unable to use the rails **(D)** to secure the robe to the wall use the anti tipping brackets provided. Attach the brackets the top of the robe using 15mm screws **(L)** provided. Screw through the brackets into the wall.

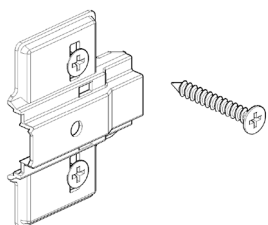

### Step 13.

Screw into any adjacent units using 30mm screws **(K)** provided to secure the unit. Screw just to the rear of the hinge plates at the top, middle and bottom on both sides. Place stick on cover caps on the heads to conceal them.



**SEE PAGE 26 FOR FIXING COMBI ROBES TO THE WALL**

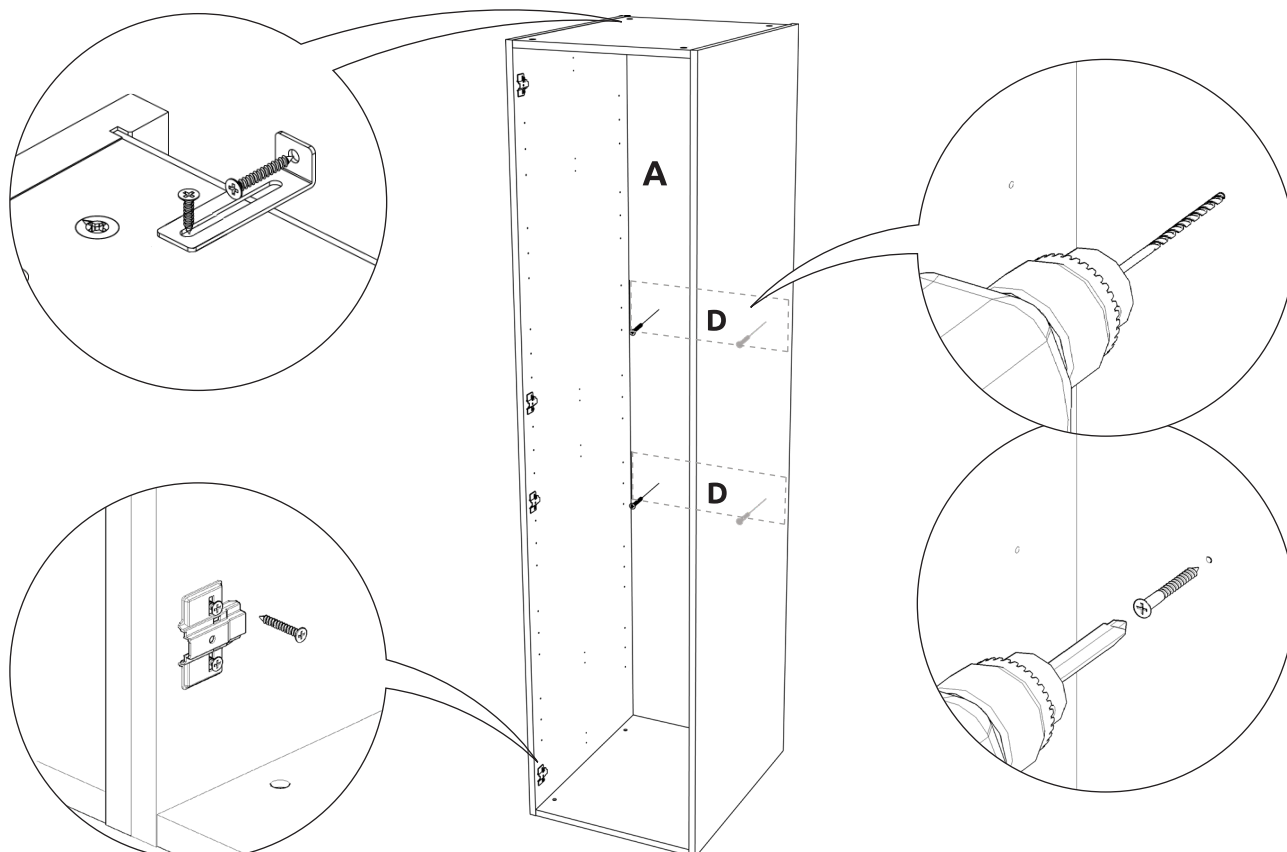



**ROBE INTERNAL LAYOUT OPTIONS**

1-2 Door  
1 Shelf and  
1 Rail

1-2 Door  
1 Shelf and  
2 Rails

1-2 Door  
7 Shelves

1-2 Door  
4 Shelves  
and 1 Rail

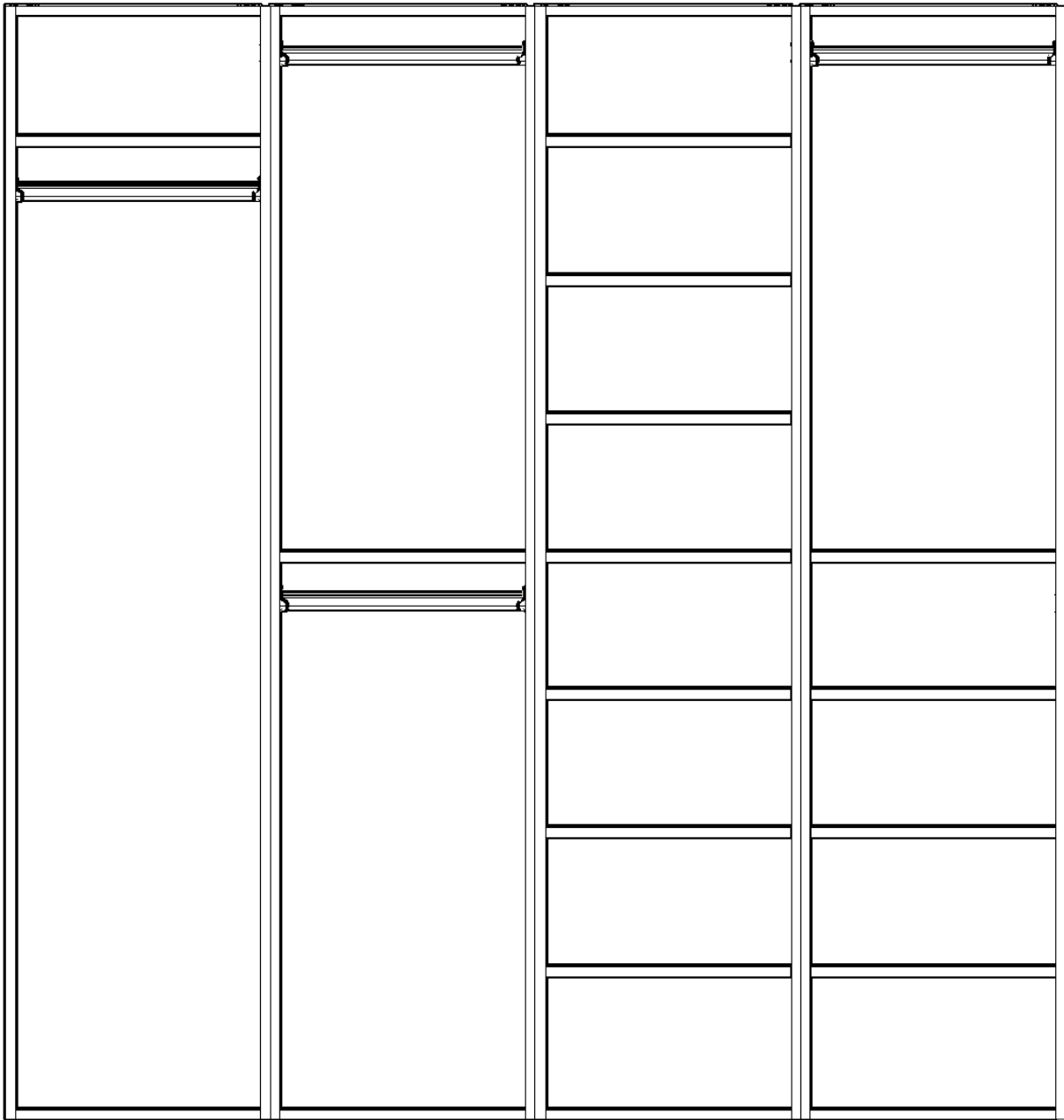

**ROBE INTERNAL LAYOUT OPTIONS**

1-2 Door  
1 Rail  
2 Internal  
Drawers

1-2 Door  
4 Shelves  
2 Internal  
Drawers

1-2 Door  
1 Rail  
3 Internal  
Drawers

1-2 Door  
4 Shelves  
3 Internal  
Drawers

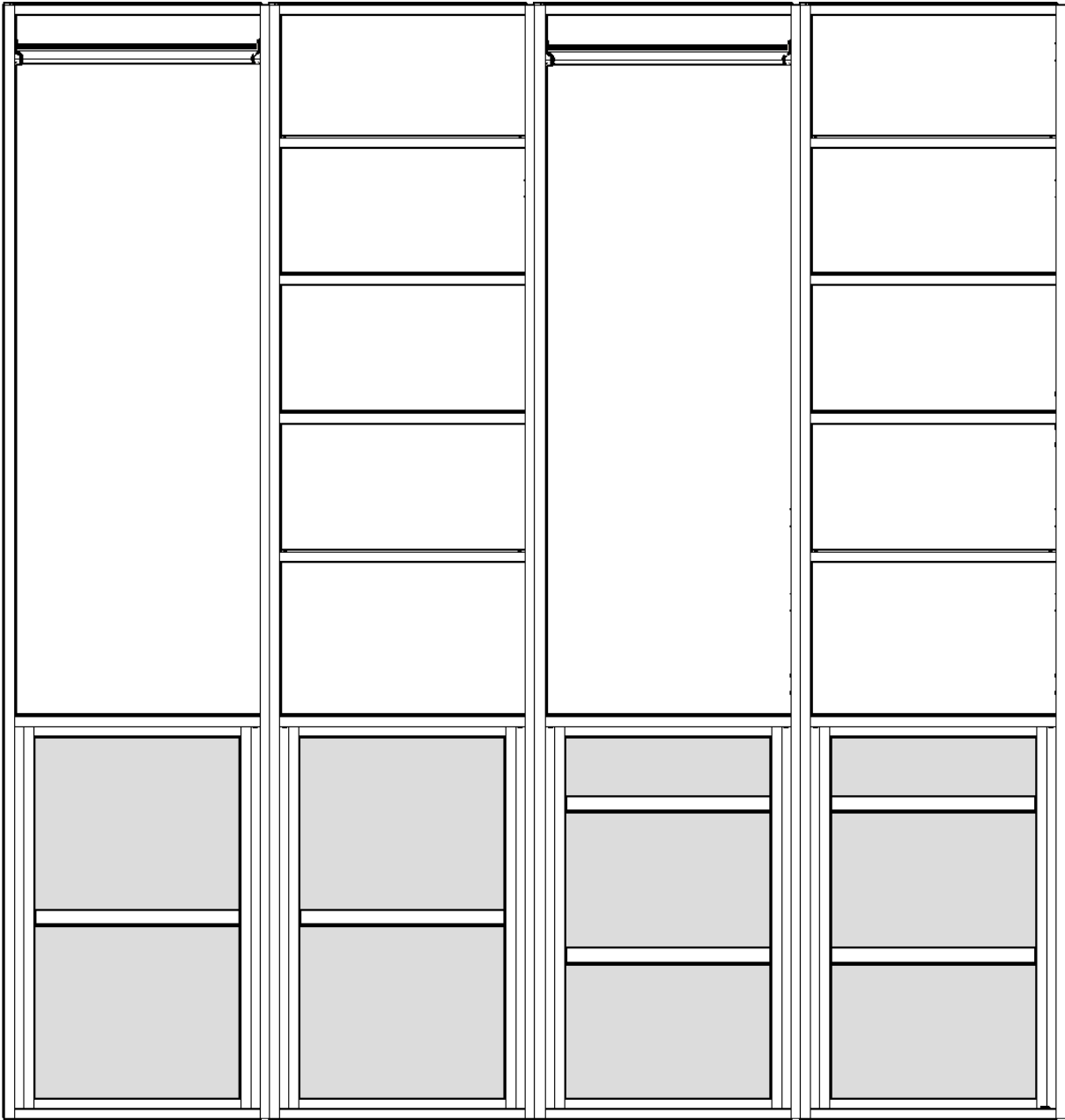

**ROBE INTERNAL LAYOUT OPTIONS**

1-2 Door  
1 Rail  
4 Internal  
Drawers

1-2 Door  
4 Shelves  
4 Internal  
Drawers

1-2 Door  
1 Rail  
5 Internal  
Drawers

1-2 Door  
4 Shelves  
5 Internal  
Drawers

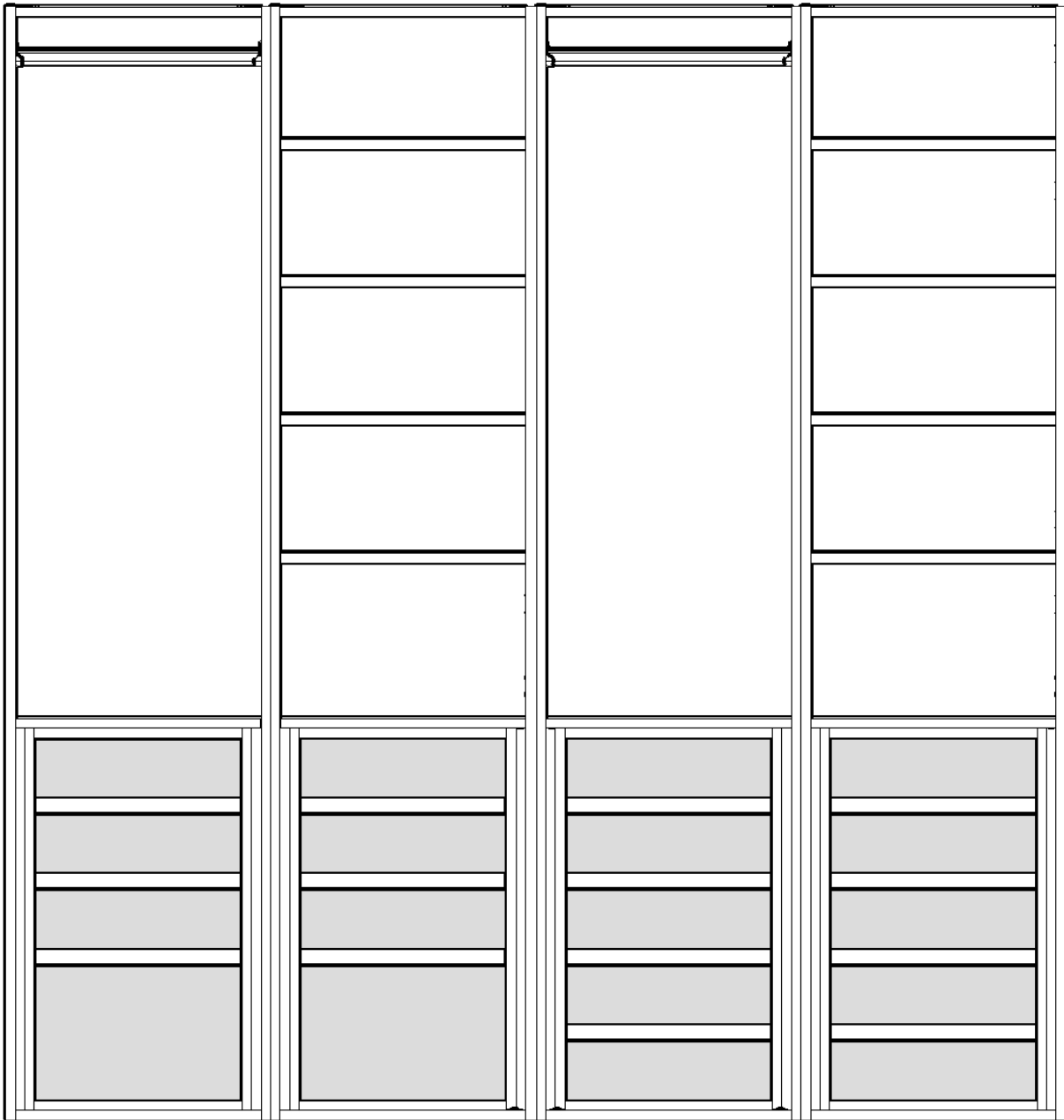

**SLIDING DOOR ROBE SPECIFIC  
INTERNAL LAYOUT OPTIONS**

**Sliding Door Robe**  
**1 Rail**  
**2, 3, 4 or 5 Internal Drawers**  
**Shoe / Storage Rack**

**Sliding Door Robe**  
**4 Shelves**  
**2, 3, 4 or 5 Internal Drawers**  
**Shoe / Storage Rack**

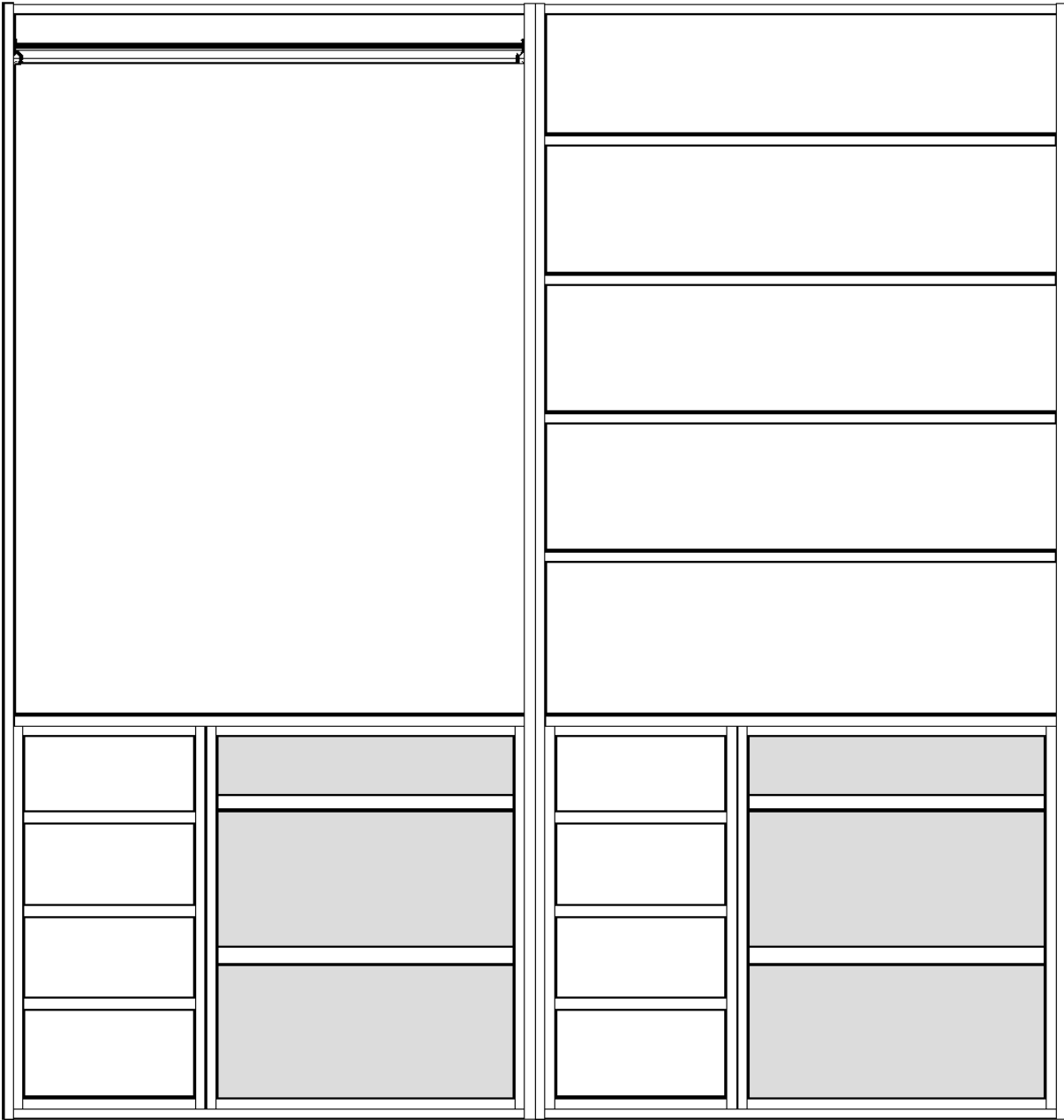

COMBI ROBE INTERNAL LAYOUT OPTIONS

Combi Robe  
1 Rail  
3 Drawers

Combi Robe  
4 Shelves  
3 Drawers

Combi Robe  
1 Rail  
4 Drawers

Combi Robe  
4 Rail  
4 Drawers

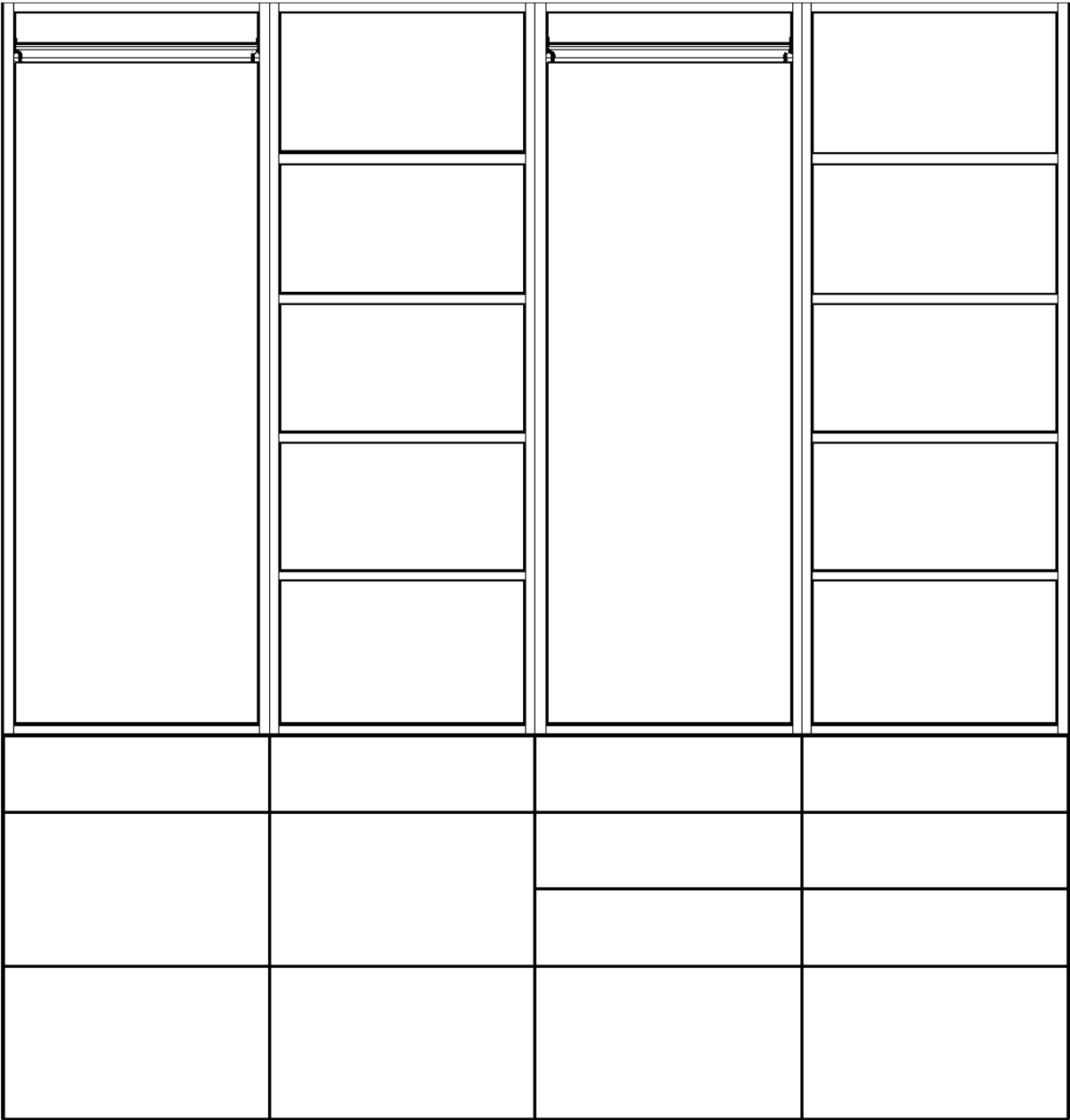

## 400-1000, 1-2 Door Robe / Combi Robe Assembly Guide

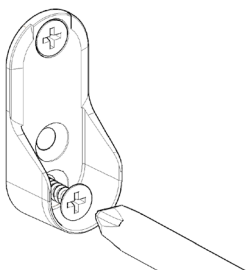
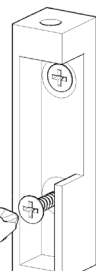
 <p><i>Infinity</i></p>	<p><b>Hanging Rails.</b> Attach hanging rail plates onto end panels <b>(B)</b> as shown using 2 x 15mm screws <b>(L)</b> provided per hanging plate. Using the measurements below screw the hanging rail plate onto the end panel using the top hole. Ensure the hanging plate is straight and screw into the bottom hole.</p> <p><b>Hanging rail plates to be mounted in accordance with customer specific bedroom plan.</b></p>	 <p><i>Infinity Plus</i></p>
--	---	---

### Hanging Rail options

- 1 x Hanging Rail **(1)**
- 1 x Hanging Rail + 1 x Shelf **(2)**
- 2 x Hanging Rails + 1 Shelf **(1+3)**

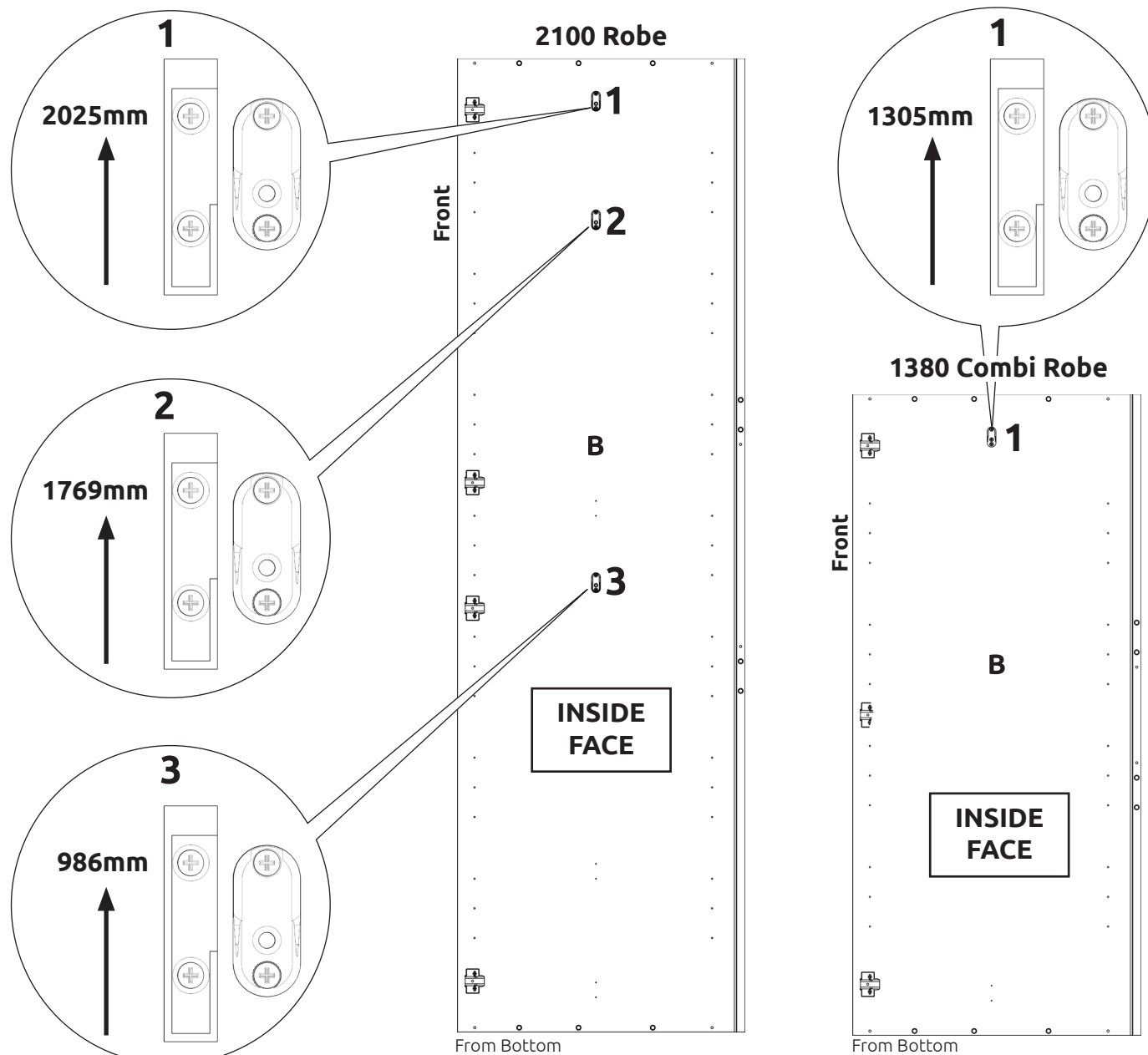

### Internal Drawers.

**A.** Insert the internal drawer unit into the robe unit. Align the back of the drawers with the back of the robe unit, ensuring the drawer unit is centred inside the robe unit.

**B.** Position the provided filler panel between the robe and drawer unit, set 5mm back from the front of the drawer unit.

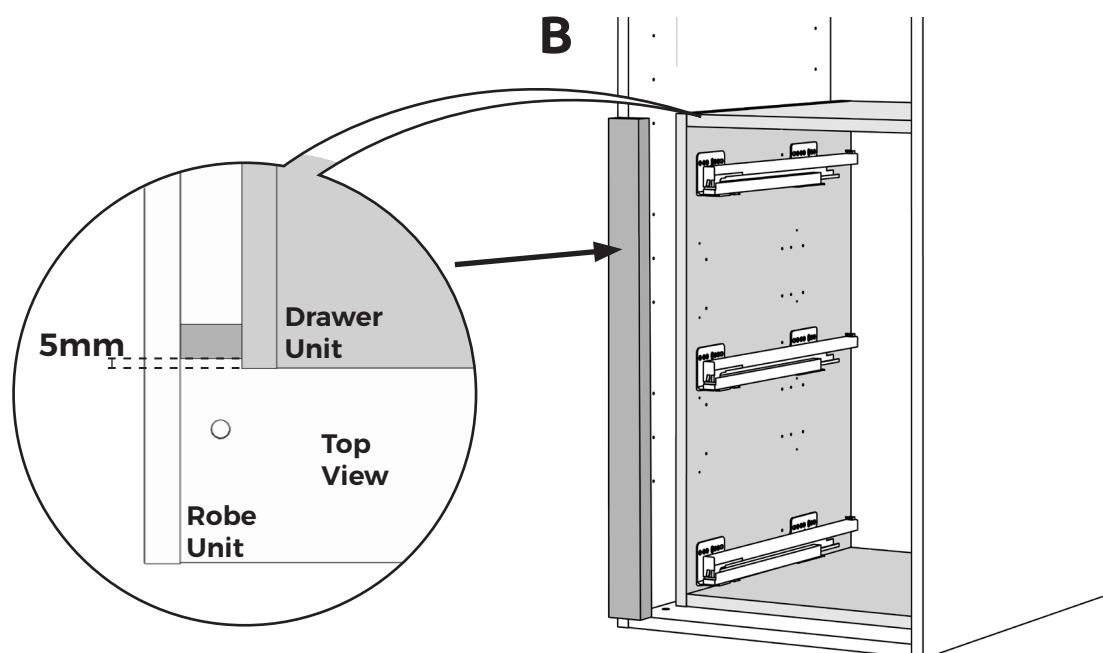
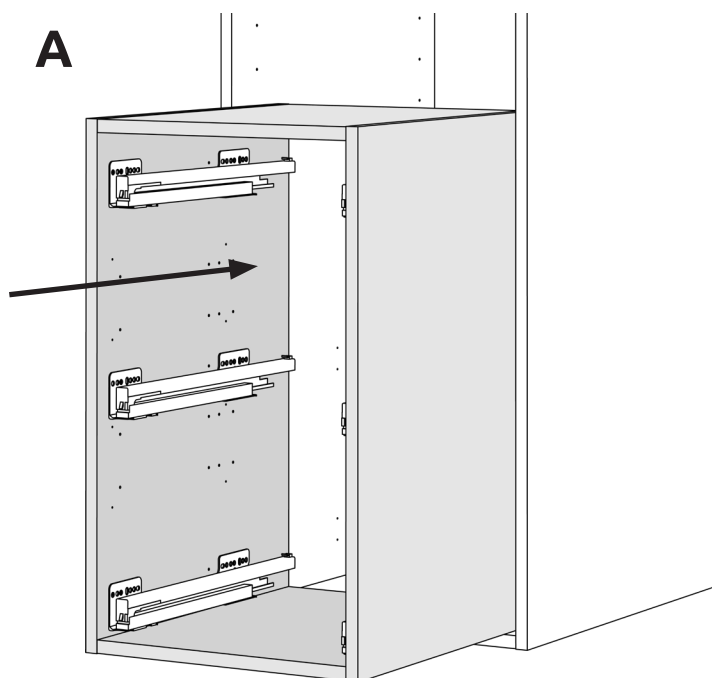

## 400-1000, 1-2 Door Robe / Combi Robe Assembly Guide

- C.** Screw through drawer end panel, into the filler panel using 2 x 30mm screws (**K**). Repeat on opposite side.
- D.** Screw down through the drawer unit fixed shelf into the Robe fixed shelf using 4 x 30mm screws (**K**).
- E.** Position loose shelf on top of drawer unit and screw up through drawer unit top shelf using 4 x 30mm screws (**K**) into loose shelf to secure in place.

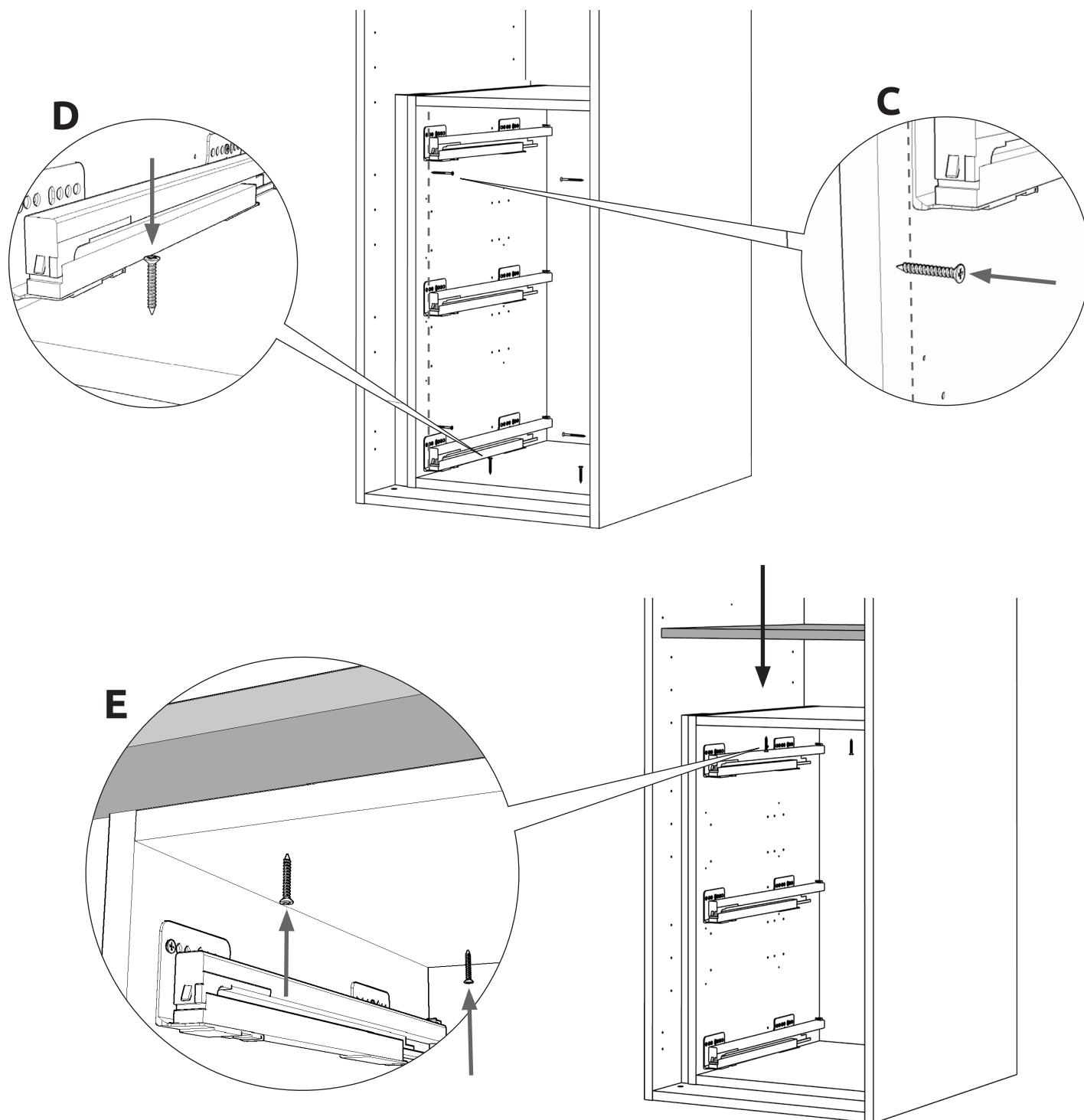



### Sliding Door Robe Internal Drawers & Storage.

- A.** Insert the internal drawer unit into the robe unit. Align the back of the drawers with the back of the robe unit, position the unit against the left or right of the unit. (Away from where the sliding doors overlap)
- B.** Position the storage unit next to the drawer unit, ensure both units are fully inserted into the robe.

**A**

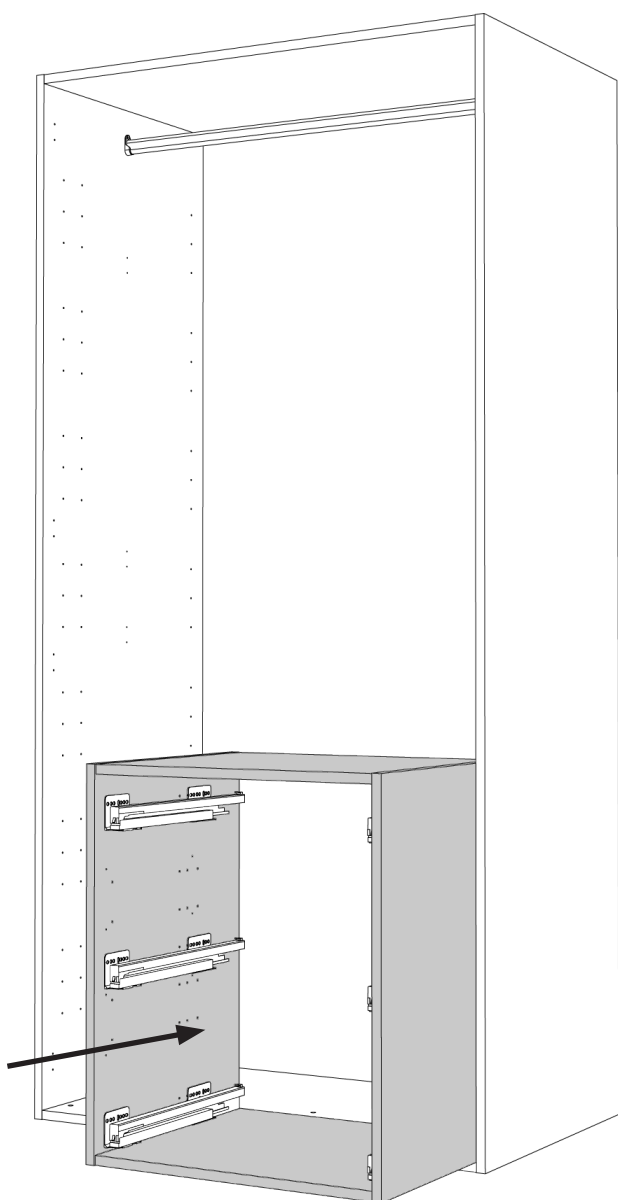

**B**

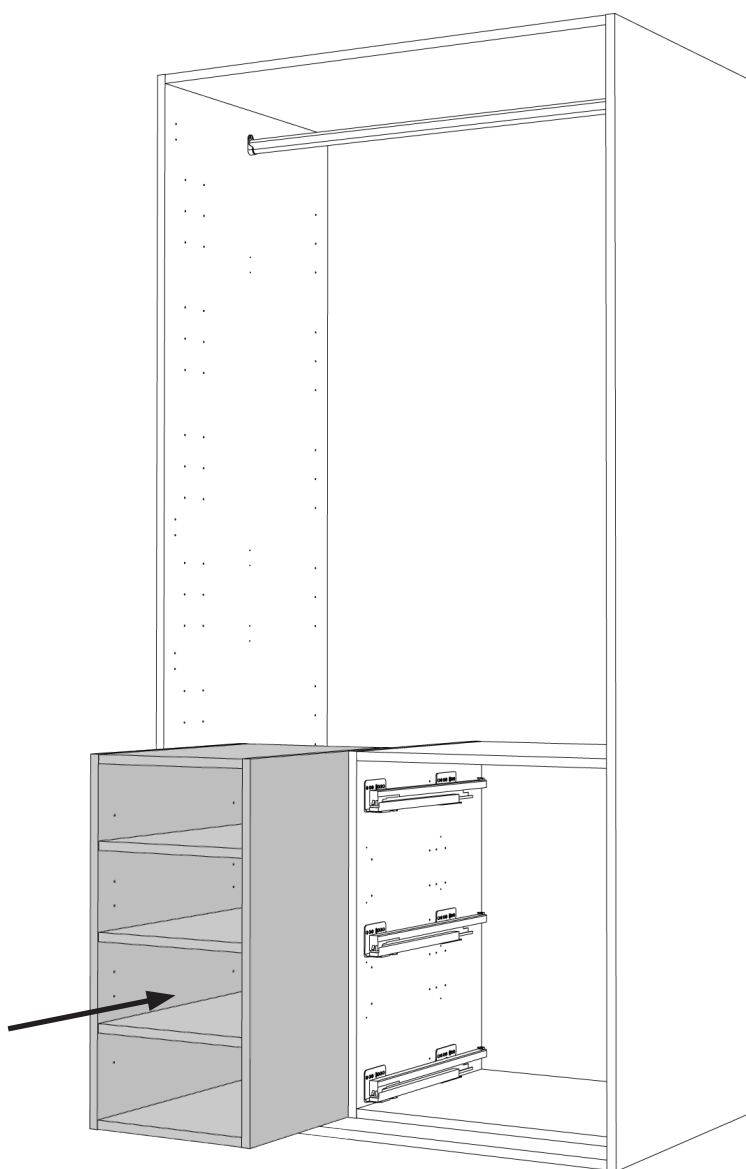

## 400-1000, 1-2 Door Robe / Combi Robe Assembly Guide

**C.** Secure the storage unit to the robe unit with 2 x 30mm screws (**K**) by screwing through the end panel into robe end panel. Lift the loose shelves and screw in-line with where the shelf sits to conceal the screw head.

**D.** Secure the storage unit to the drawer unit with 2 x 30mm screws (**K**) by screwing through the end panel into drawer end panel. Lift the loose shelves and screw in-line with where the shelf sits to conceal the screw head.

**E.** Secure the drawer unit to the robe unit with 2 x 30mm screws (**K**) by screwing through the drawer end panel into robe end panel.

**F.** Secure the storage and drawer units to the robe unit with 6 x 30mm screws (**K**) by screwing down through the bottom shelves into the robe bottom fixed shelf.

**G.** Position loose shelf on top of storage and drawer units and screw up through the units top shelves using 6 x 30mm screws (**K**) into loose shelf to secure in place.

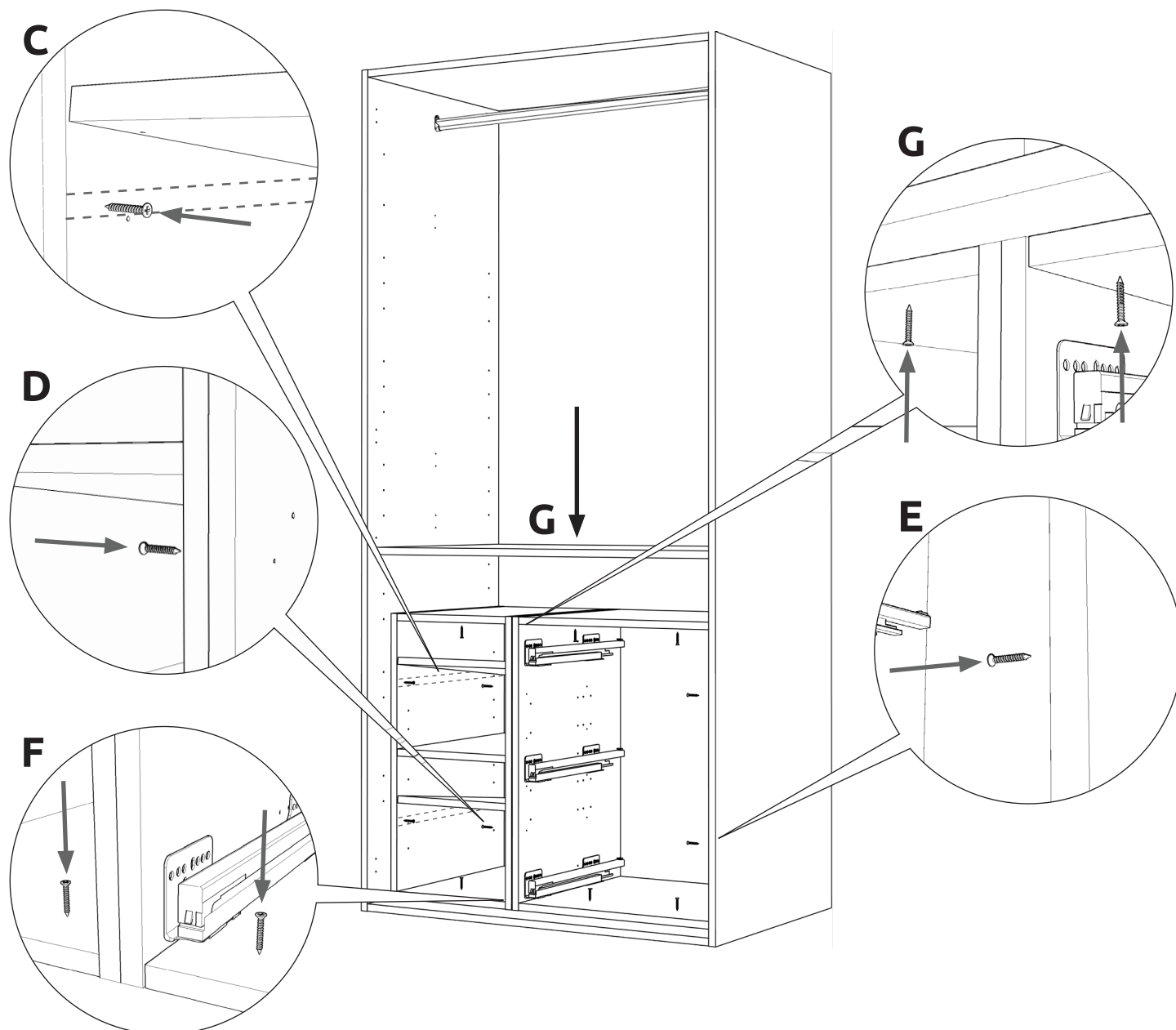



**Screws for fixing to walls are not provided as these vary depending on your wall material and construction. Ensure appropriate fixings for wall constructions are used.**

### Combi Robe

**A.** Ensure the combi chest unit is level and positioned correctly. Drill pilot holes through back panel and rail into the wall. Secure chest to the wall by screwing through the pilot holes into the wall.



**B.** Position the combi robe top section on top of the chest. Align the robe and chest sections so the sides and front are straight and flush, Screw up through the chest units top fixed shelf into the robes bottom fixed shelf using 4 x 30mm screws (**K**).

**C.** Drill pilot holes through back panel and rails of the top section into the wall. Secure combi robe to the wall.

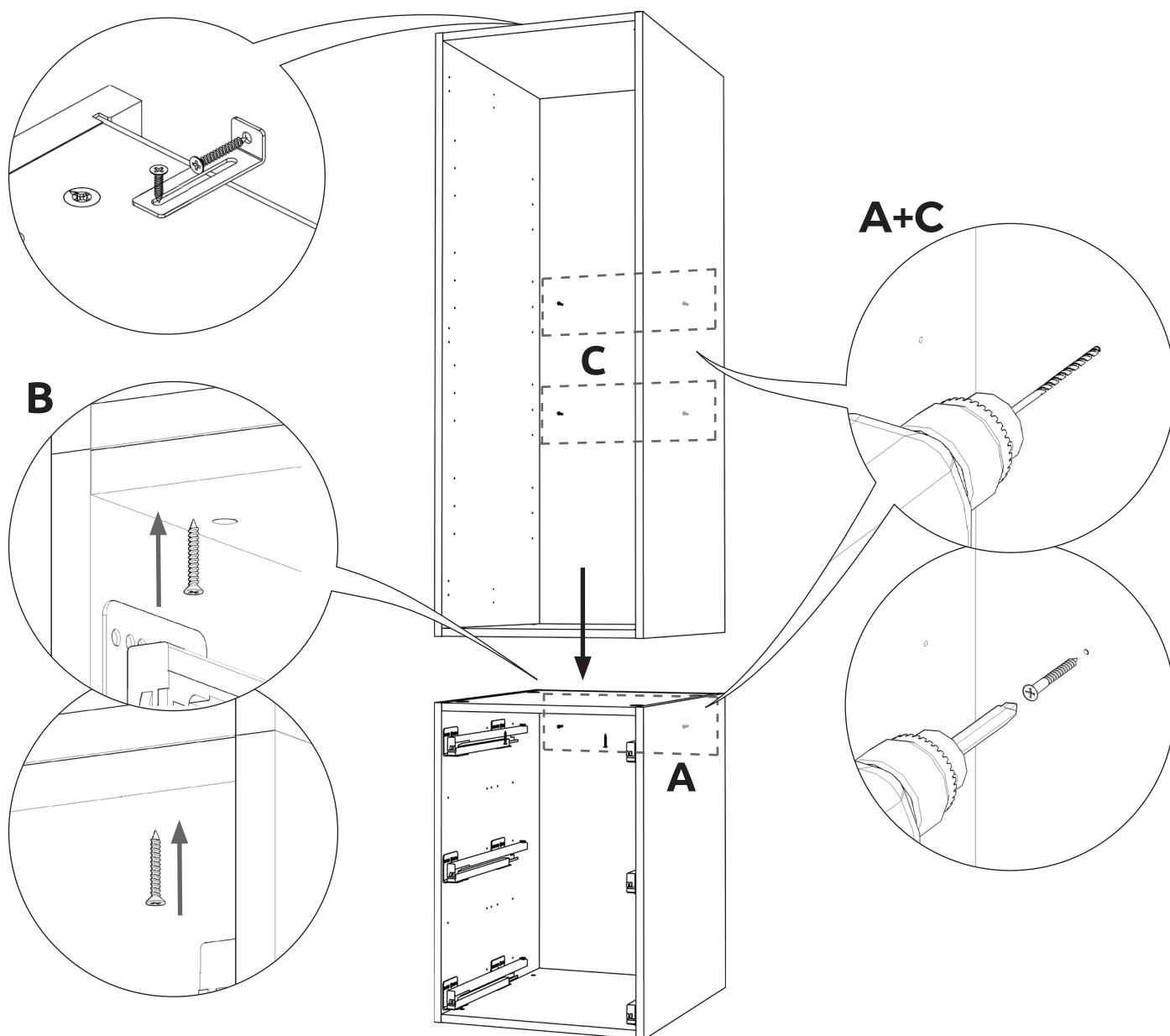
If unable to use the rails to secure the unit to the wall use the anti tipping brackets provided. Attach the bracket the top of the robe using 15mm screws (**L**) provided. Screw through the bracket into the wall.

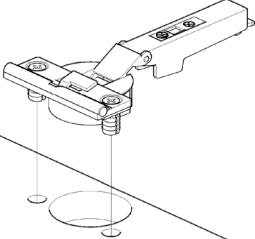

### Hinge Attachment and Adjustment

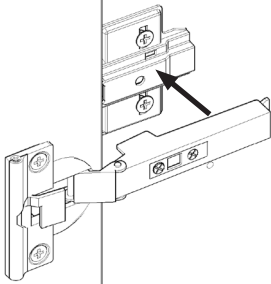
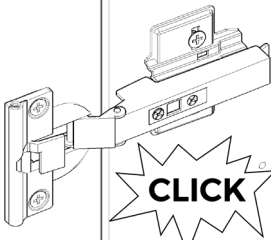
	<p><b>Step 1.</b> Insert hinges into frontal hinge holes provided, secure hinges with the 2 x screws and hinge dowels already located in the hinges.</p>  <p><i>Hinge dowels</i></p>	
	 <p><b>CLICK</b></p>	<p><b>Step 2.</b> Attach the door to unit, clip hinges onto hinge plates and click to secure.</p>
<p><b>Step 3.</b> Adjust hinges to suit, using the highlighted screw(s) shown.</p>		

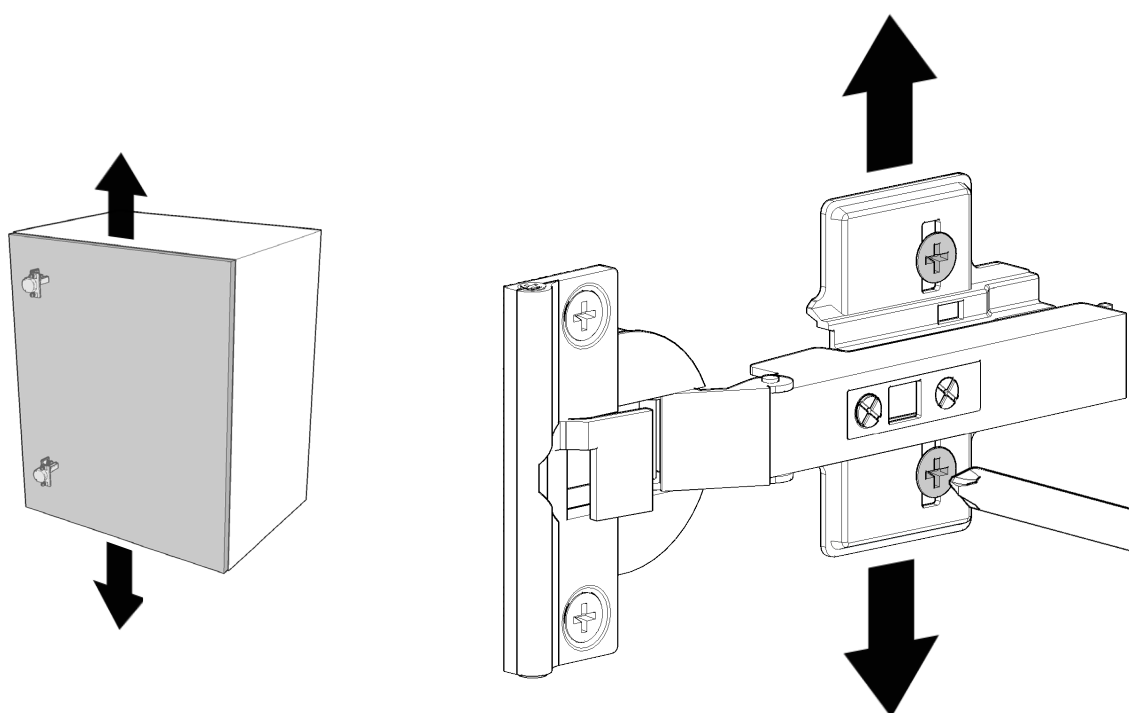

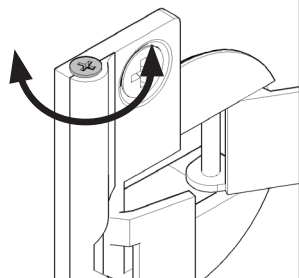
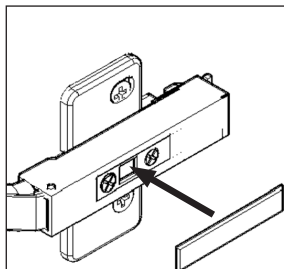
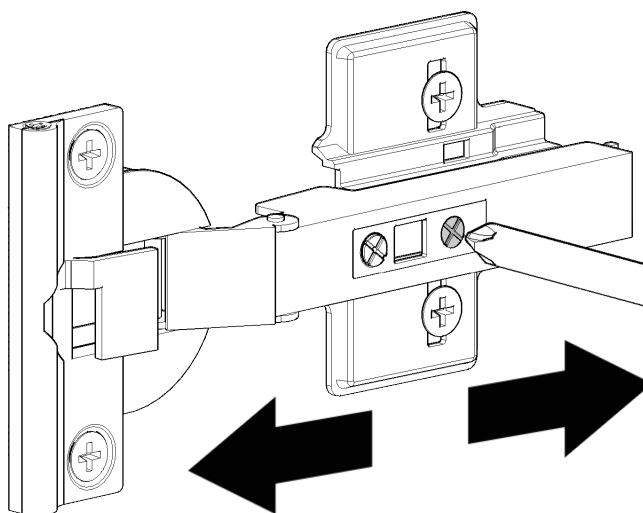
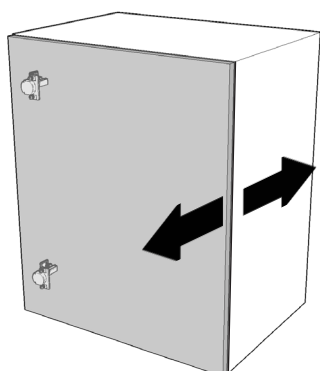
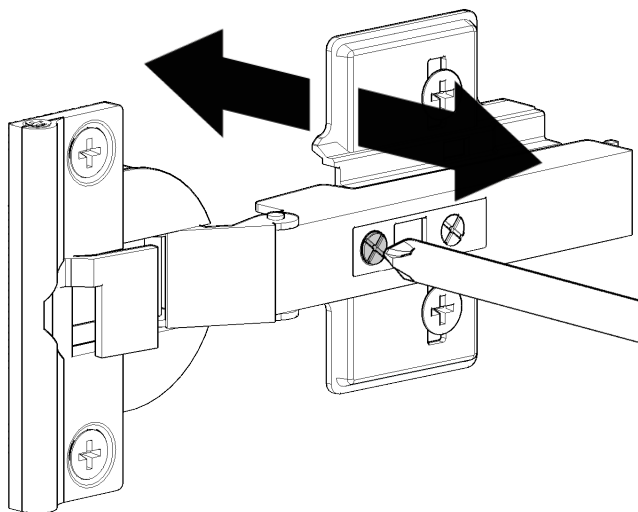
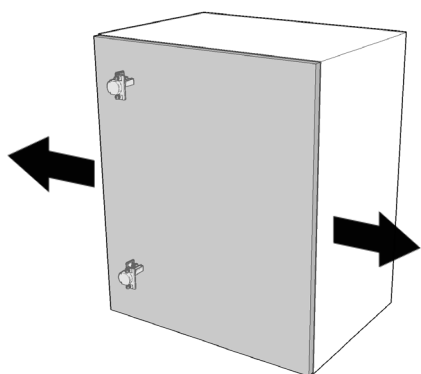

### Step 4.

Fit cover caps to hinges and adjust soft-close to suit.



The top and bottom hinges **MUST** be adjusted to the **SAME STRENGTH**.

### Loose Shelves

Secure shelf peg (JJ) to end panels (B) using 1 x 12.5mm screw (KK) per shelf peg.

4 x shelf pegs (JJ) are required per loose shelf.

Position loose shelf onto shelf pegs (JJ) ensuring the spikes on the shelf pegs locate in the holes on the bottom of the loose shelf.

**See customer specific bedroom plan for position and number of loose shelves.**

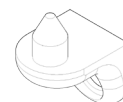

Shelf Peg



12.5mm Screw

