

**Robe**



### BEFORE YOU START

**INSTALLATION SHOULD BE PERFORMED BY A COMPETENT PERSON ONLY.**

**THIS PRODUCT COULD BE DANGEROUS IF INCORRECTLY INSTALLED**

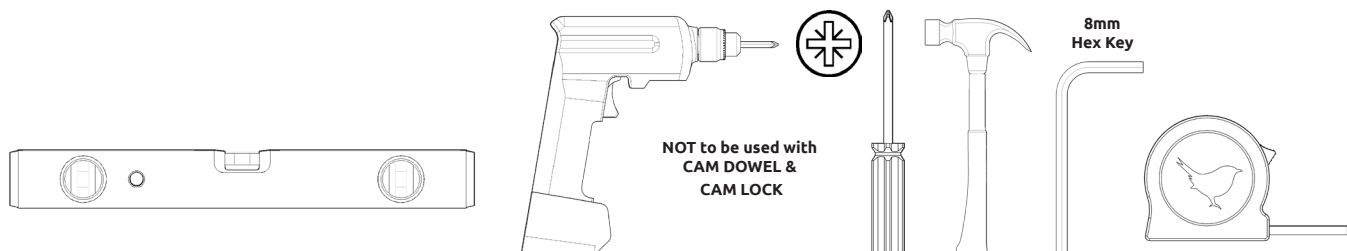
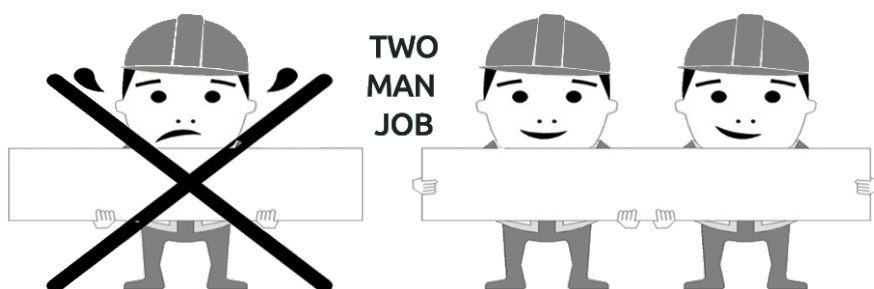

# CONTENTS

4	Robe panels
5	Components
6-12	Robe Assembly
13	Leg Attachment
14	Sliding Robe Leg Attachment
15	Hinge Plate Locations
16	Secure Robe To Wall & Adjacent Units
17-18	Internal Layout Options
19	Divider Panel - 1000 Width Robes
20	Front Facing Hanging Rail Locations
21	Open Robe Hanging Rail Locations
22-23	Hinge Adjustment
24	Loose Shelf Fitting

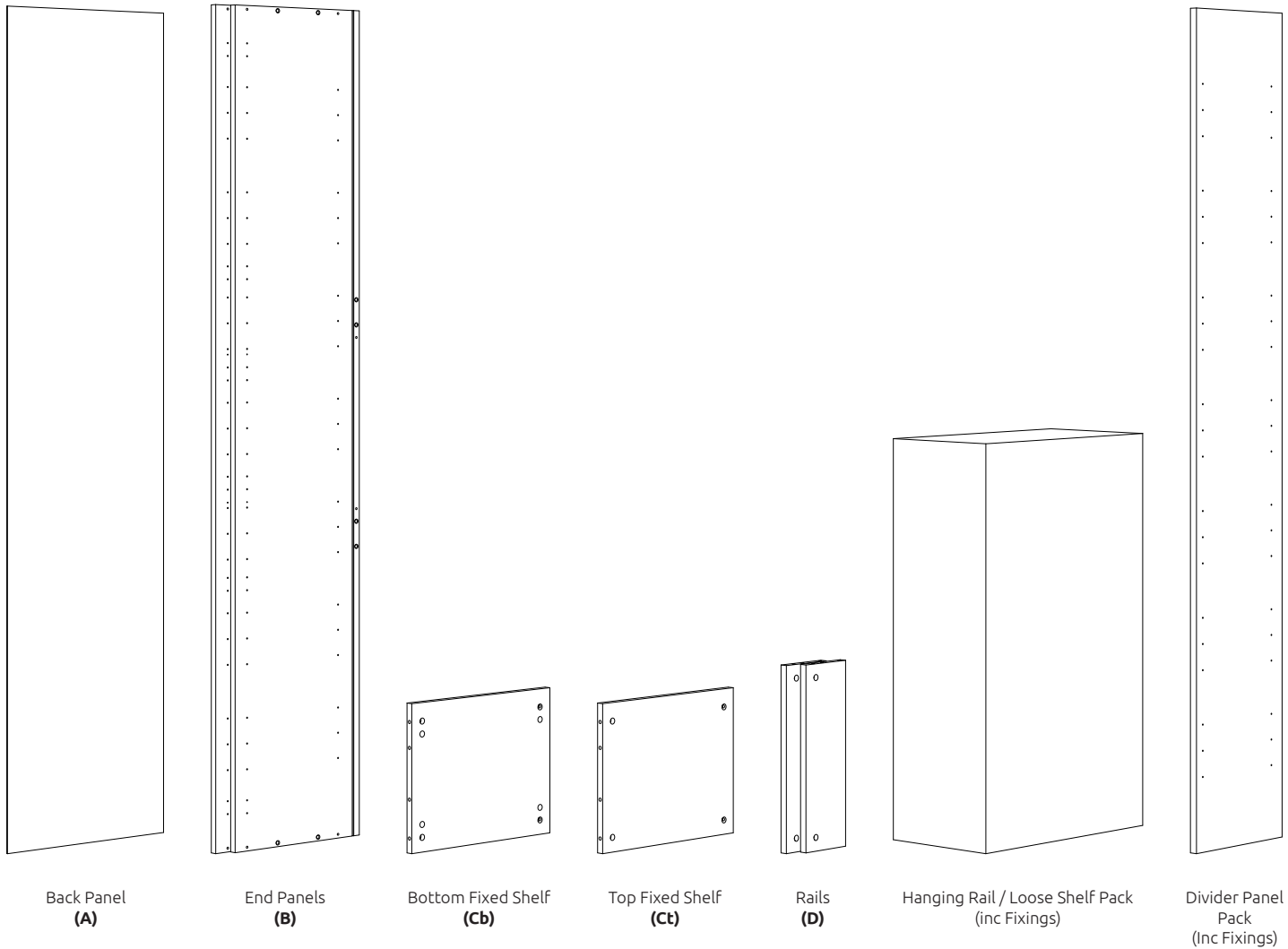

See Pages 17-18 for hanging rail / loose shelf layouts

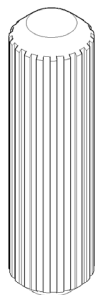

**(F) x16**  
Wooden  
Dowel



**(KK) x4**  
13.5mm  
Screw

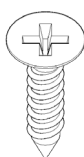

**(L) x20**  
15mm  
Screw

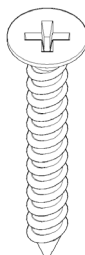

**(K) x12**  
30mm  
Screw



**(W) x12**  
Cam Dowel

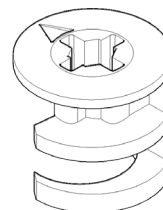

**(H) x12**  
Cam Lock

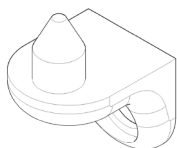

**(JJ) x4**  
Shelf Peg

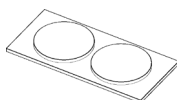

**(N) x6**  
Door Buffer

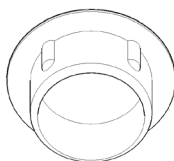

**(LL) x5**  
15mm  
Cover Cap

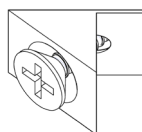

**(T) x16**  
Back Panel  
Clip

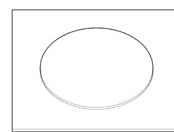

**x12**  
Stick On Cover Cap

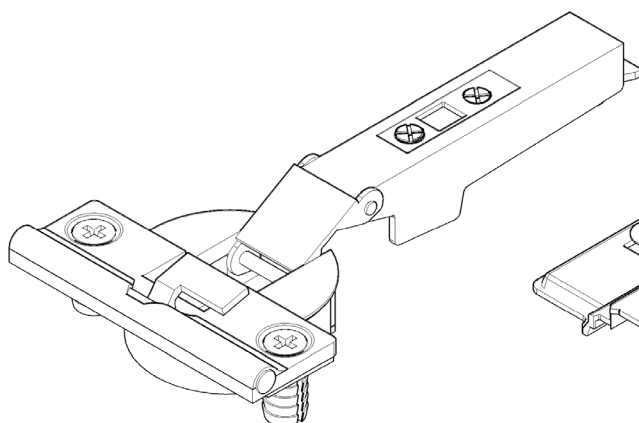

**Hinges**  
Inc Screws

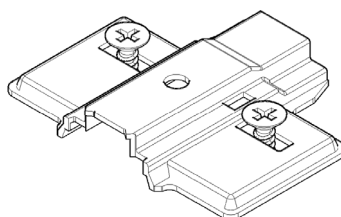

**Hinge Mounting Plates**  
Inc Screws

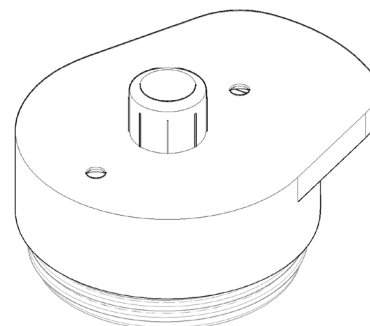

**Robe Legs**

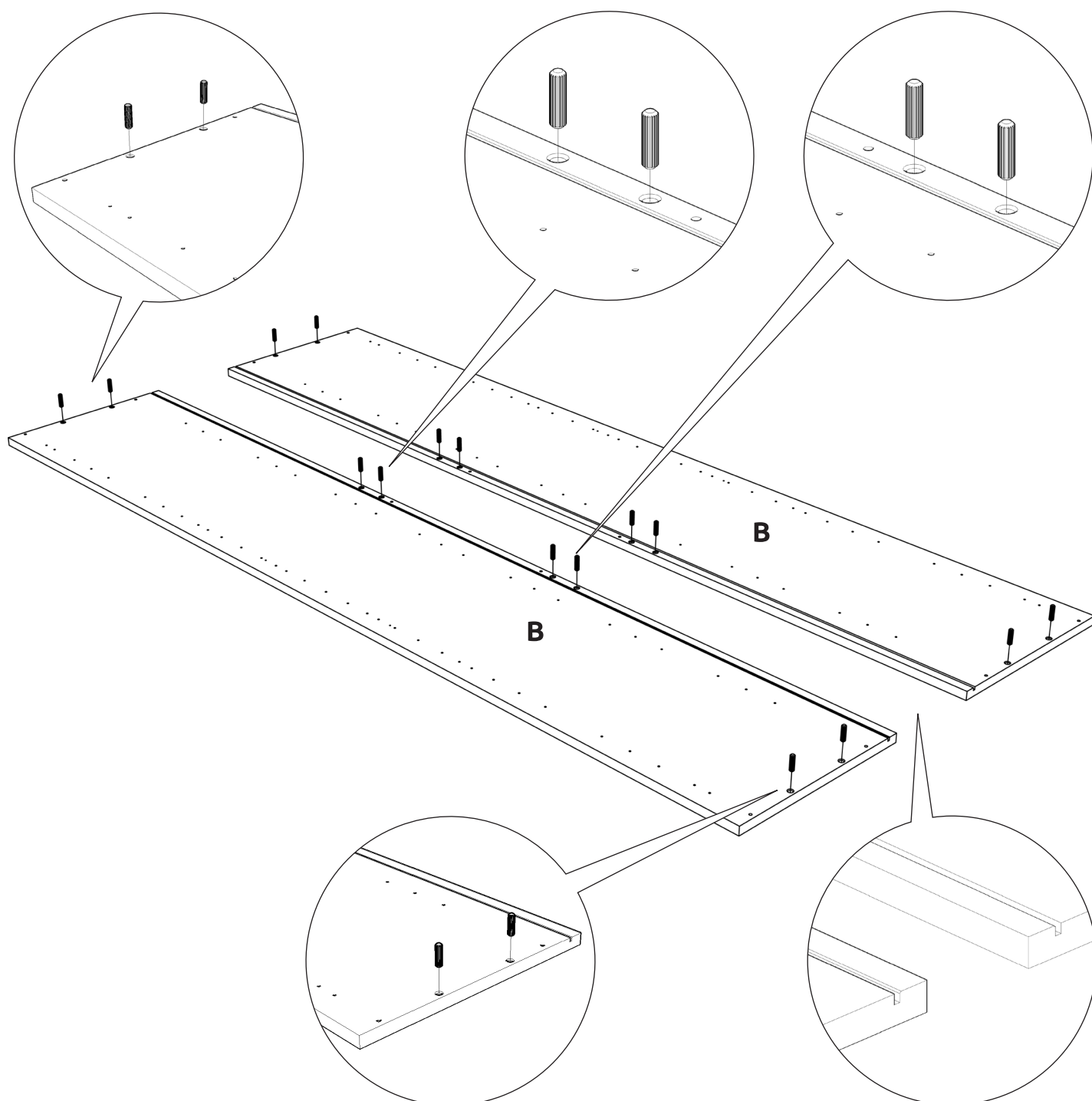
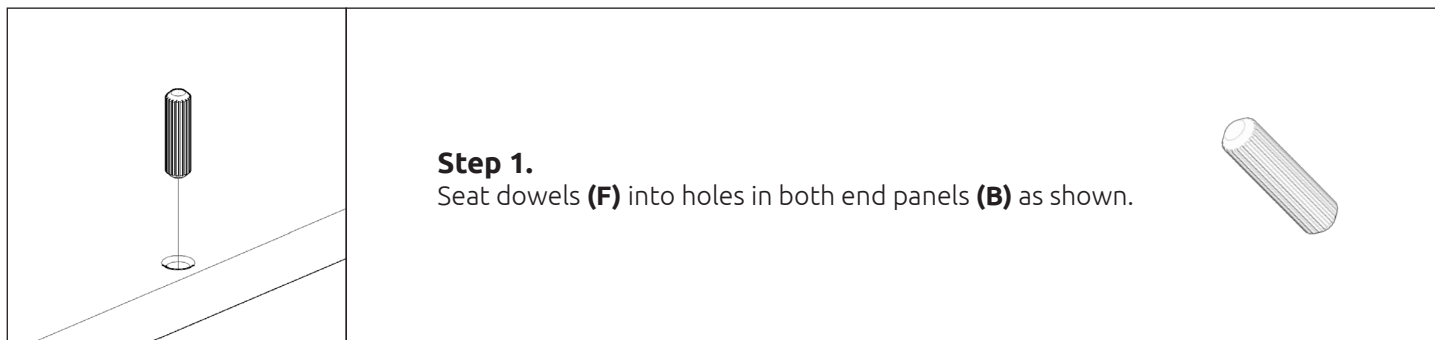

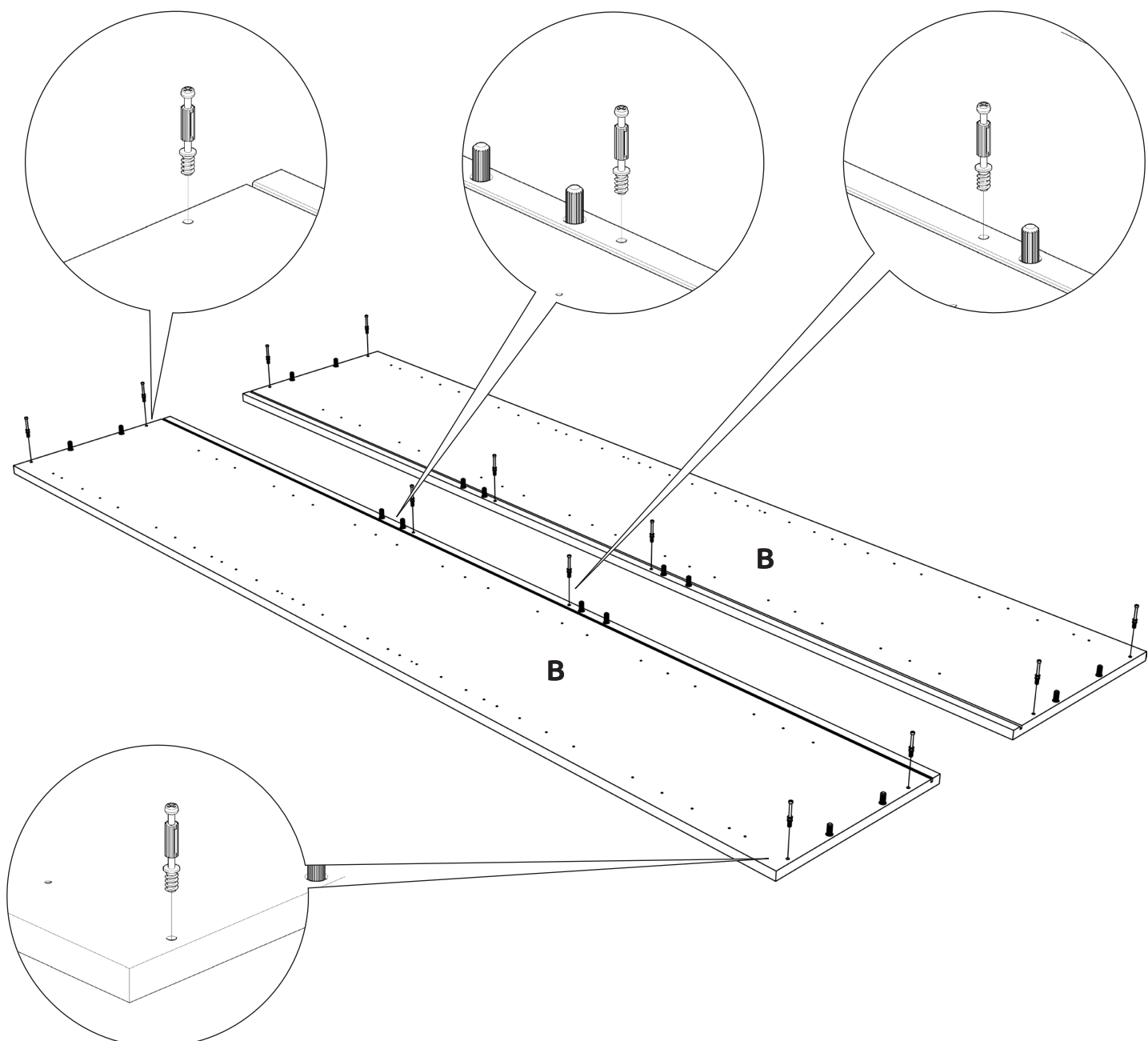
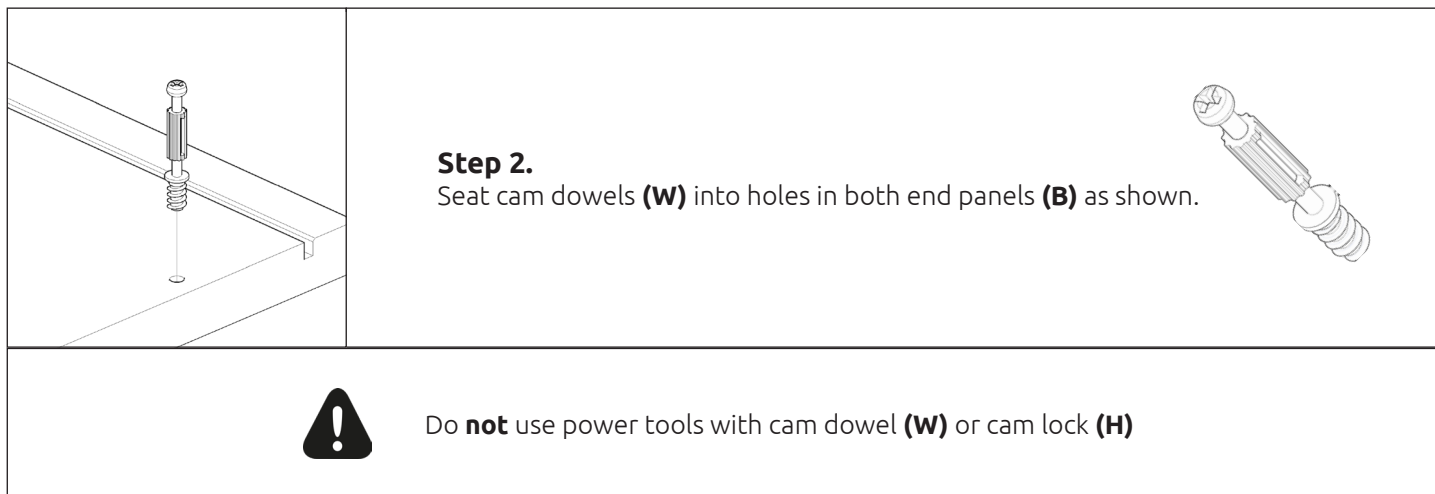

### Step 3.

Attach panels **(Ct)**, **(Cb)** & **(D)** to panels **(B)**, using cam dowels **(W)**, and also using dowels **(F)** in positions as shown.



All cam locks **(H)** are to be positioned facing the outside of the unit, for ease of tightening.

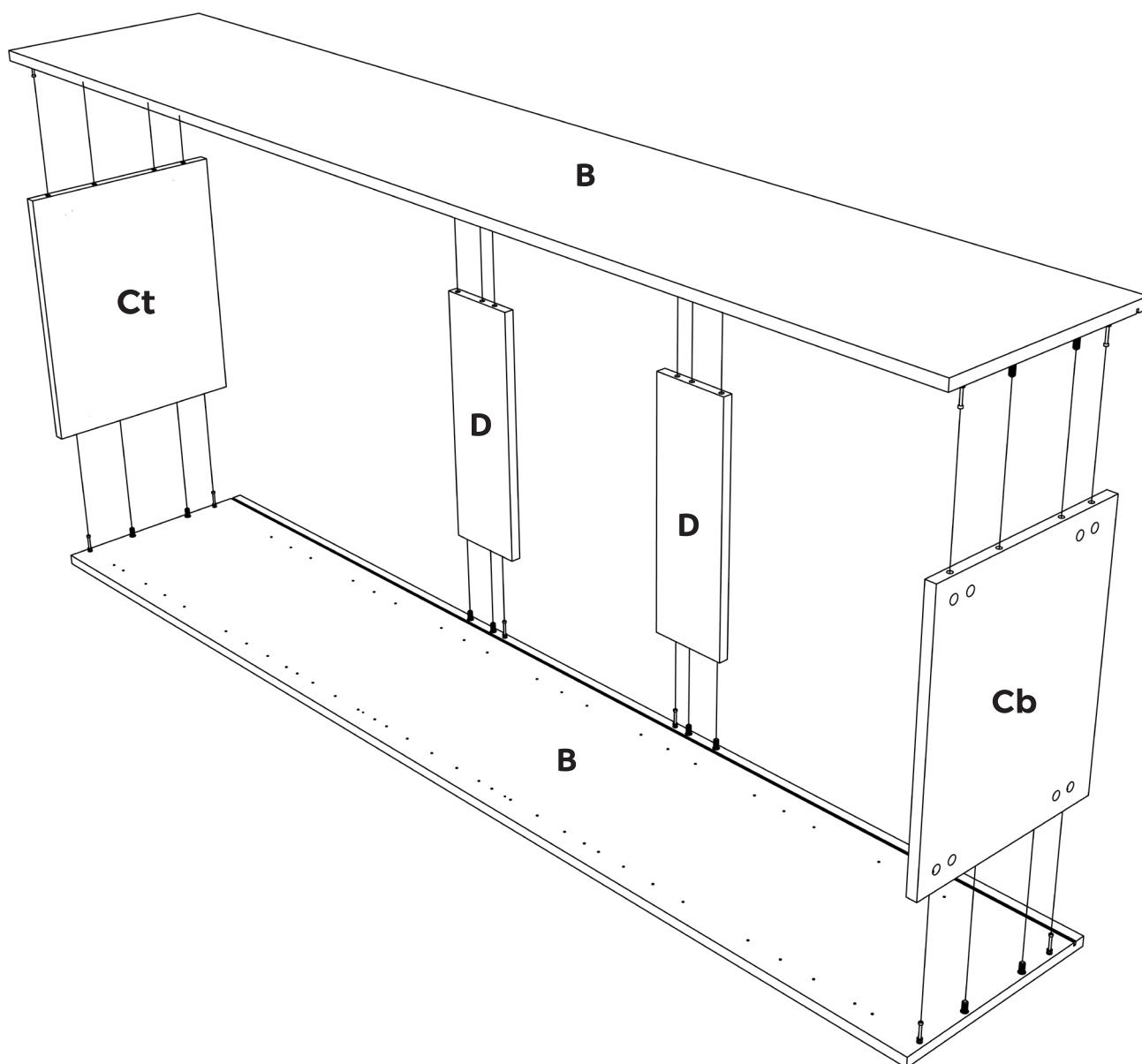



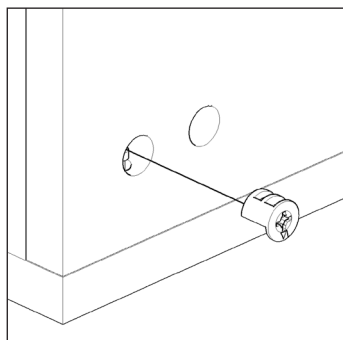

### Step 4.

Insert cam locks **(H)**. Do **NOT** tighten until Step 6.

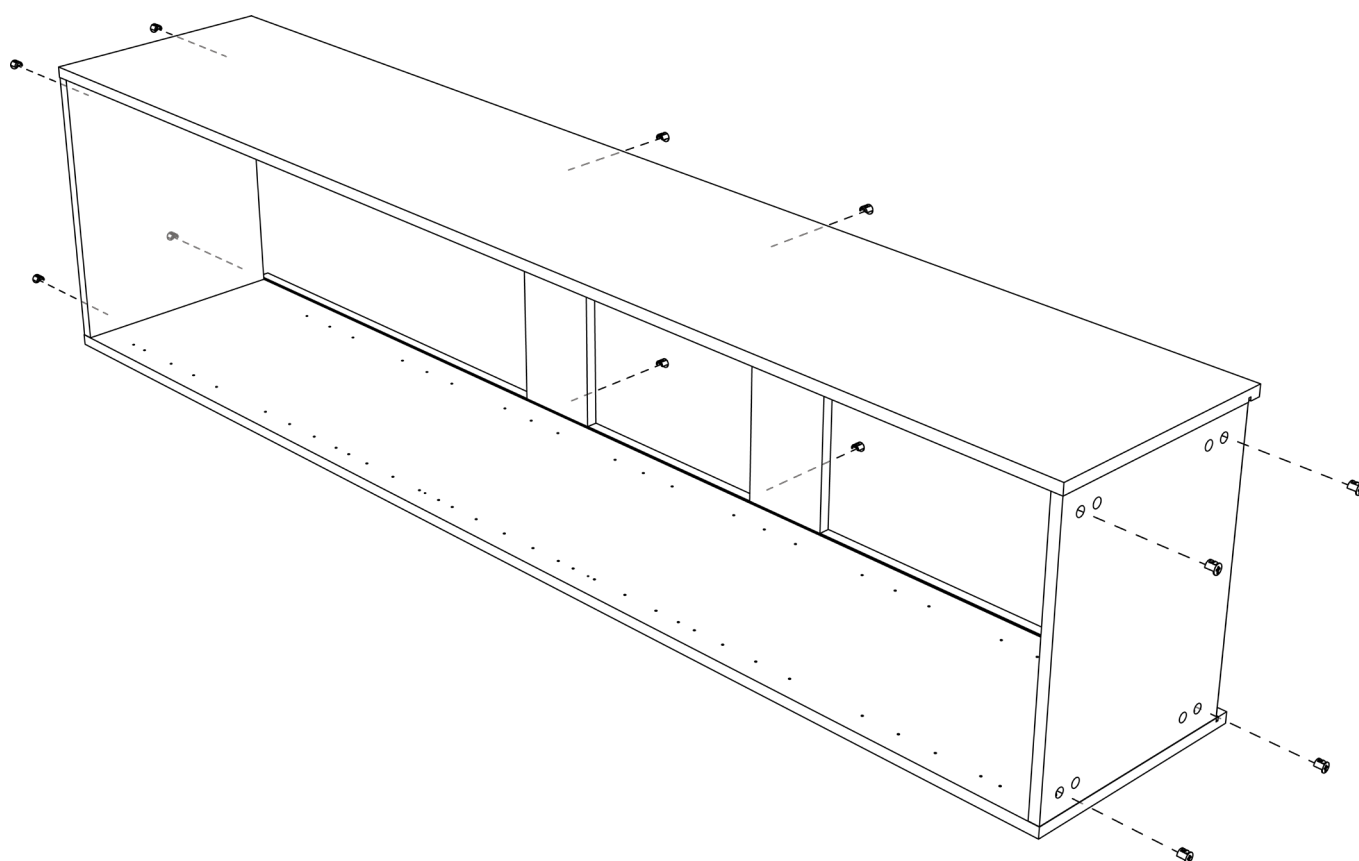
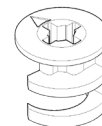

### Step 5.

Slide back panel **(A)** into groove of end panels **(B)**.

Once back panel **(A)** is in position, ensure the panel is flush & square with bottom of end panels **(B)**.

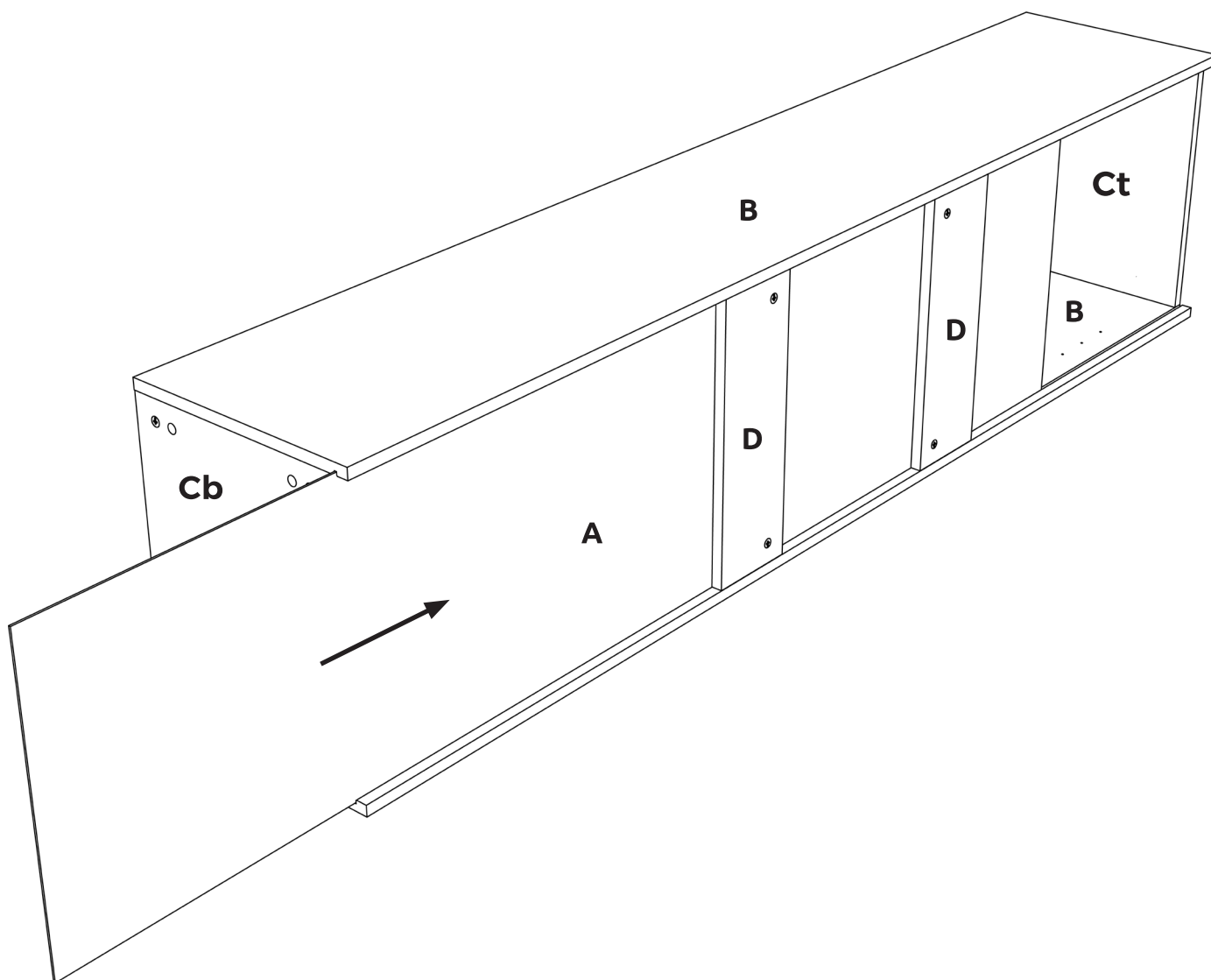

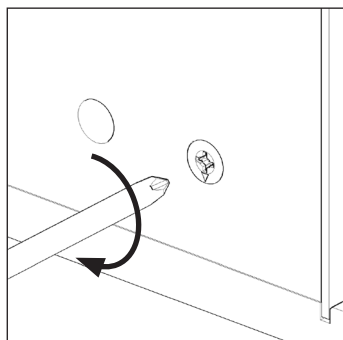

### Step 6.

Hand tighten all cam locks **(H)**, this will tighten the unit together.

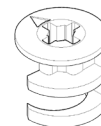

Do **not** use power tools with cam dowel **(W)** or cam lock **(H)**

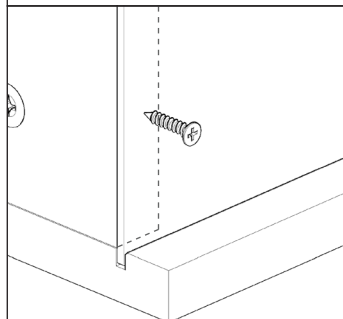

### Step 7.

Ensure unit is square. Secure back panel **(A)** with 15mm screws **(L)** equally spaced at the top and bottom of back panel **(A)** into the fixed shelves **(Ct)** and **(Cb)** as shown. Ensure you screw into the centre of fixed shelves **(Ct)** and **(Cb)**. (9mm from the edge).

**400 - 500 Widths: 6 x 15mm Screws**

**800 - 1000 Widths: 10 x 15mm Screws**

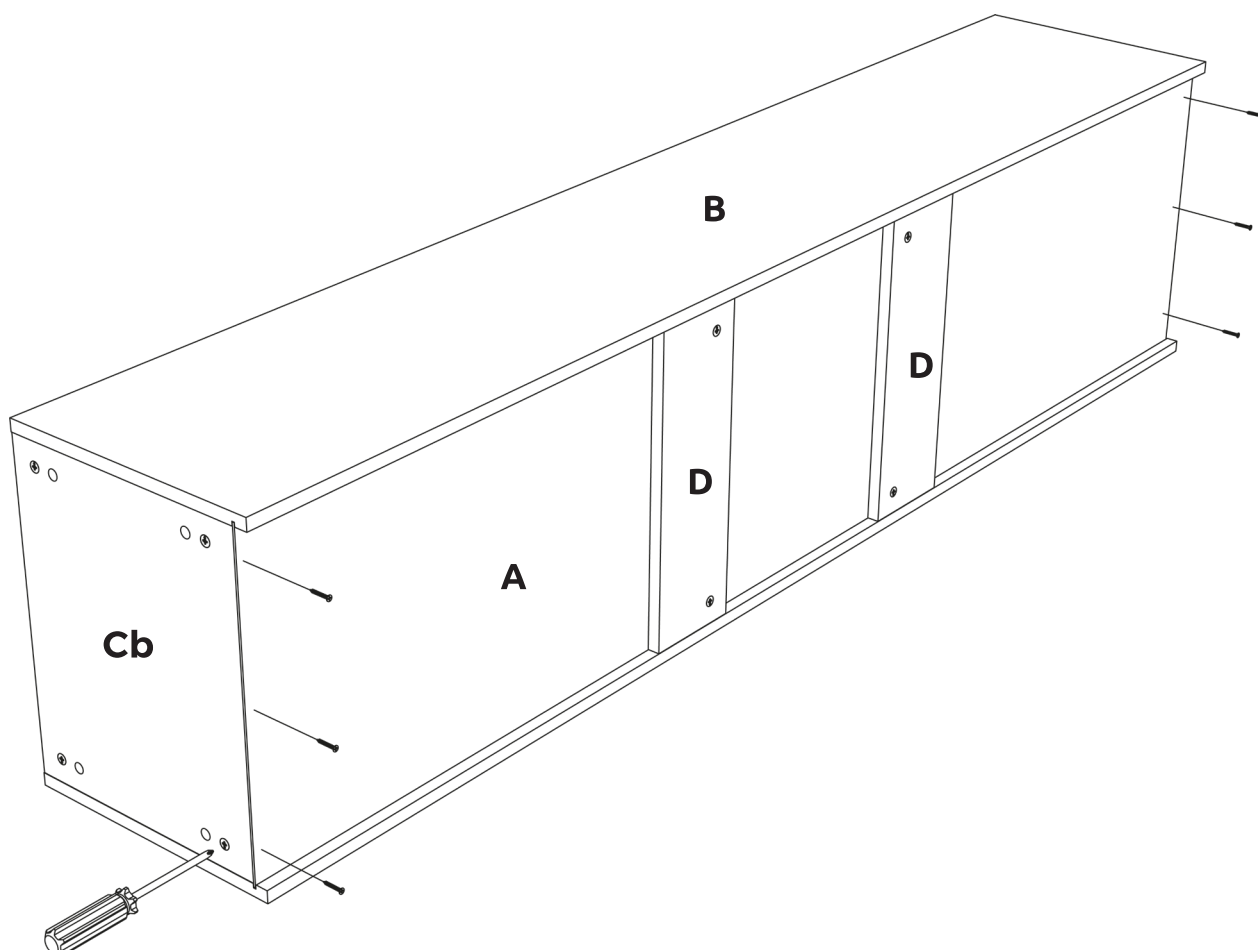
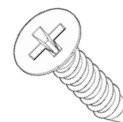

### Step 8.

Secure back panel using 16 x back panel clips (**T**).

Slide the back panel clips (**T**) into the groove of both end panels (**B**). The back panel clips (**T**) should be evenly spaced as shown . Once in place, tighten screw.

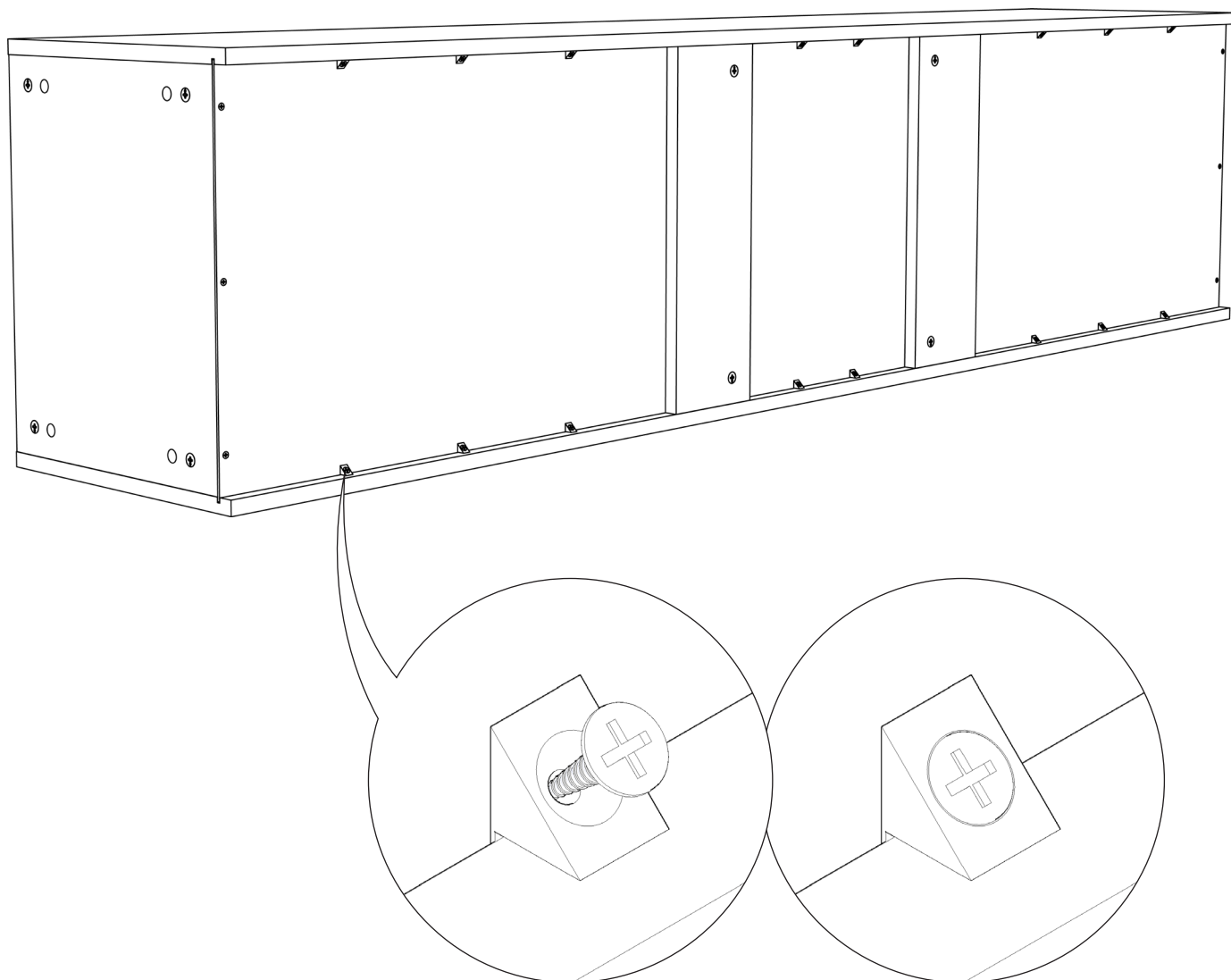
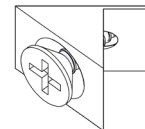

For adjustable and stable corner units  
please refer to fitting pack Instruction  
**FI.PK.BED.111.009 or FI.PK.BED.111.010**  
in your Adj/Stable corner pack for following steps.

## 400-1000, 1-2 Door Robe Assembly Guide

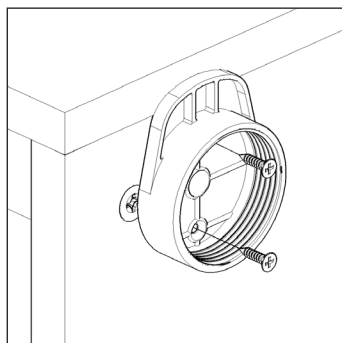

### Step 9.

Position top section of legs as shown. Ensure legs are rotated to provide support to the end panels **(B)**. Secure with 2 x 15mm screws per leg. Attach bottom section of legs and set all legs to the same height.

**400 - 500 Widths: 4 Legs**

**800 - 1000 Widths: 5 Legs**

**FOR SLIDING ROBE LEGS PLEASE SEE PAGE 14**

**For floor to ceiling  
sliding doors use  
these legs.**

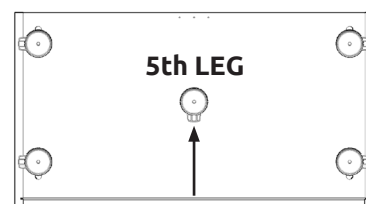

5th Leg Placement

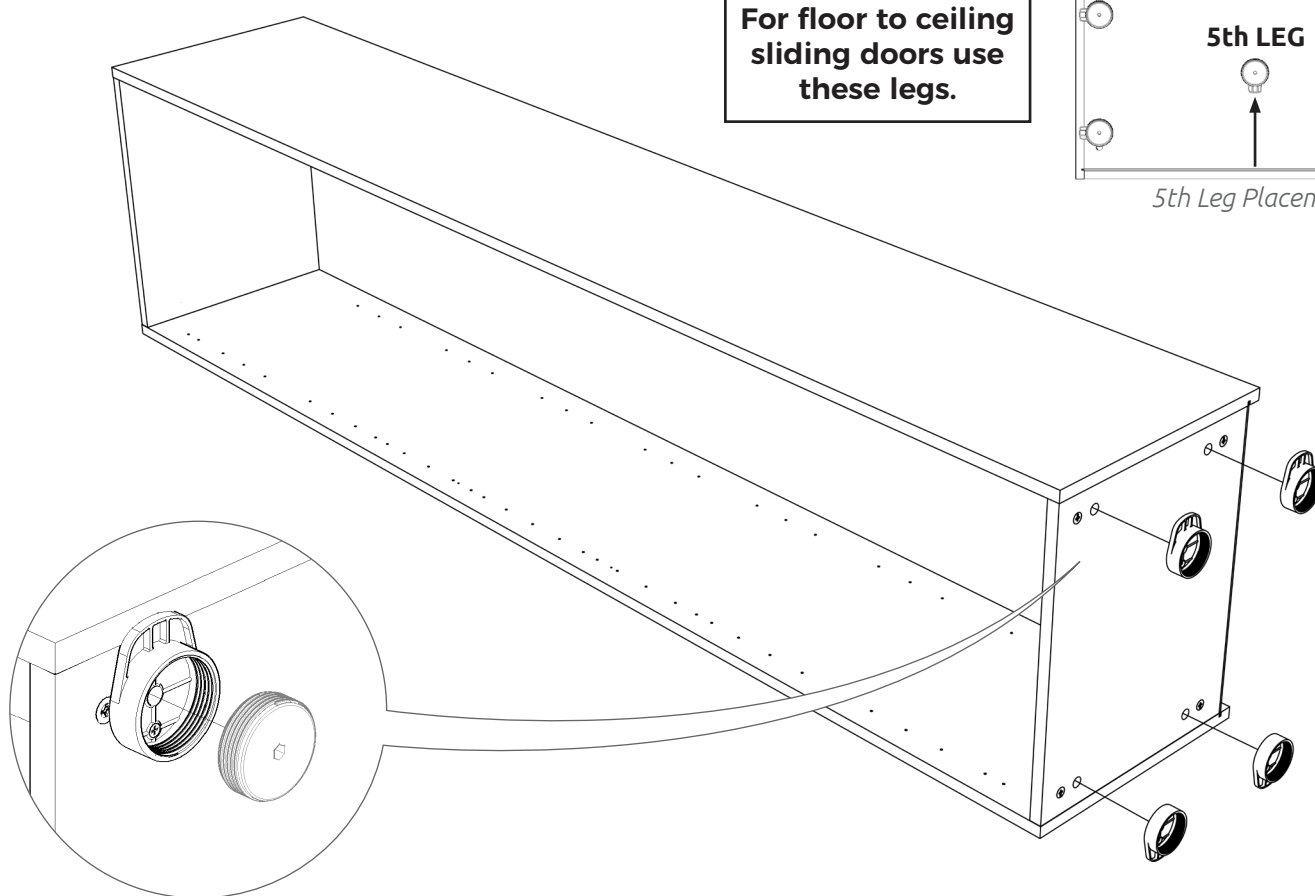

It is **important** to lift unit onto its legs. Do not tilt as depicted in image.

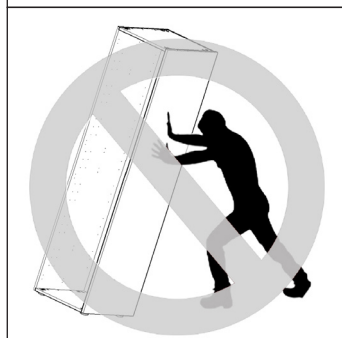

### Step 10.

Lift the unit upright. Once in situ level accordingly, using an 8mm hex key from inside the unit.

Cover leg holes with 15mm cover caps **(LL)**.

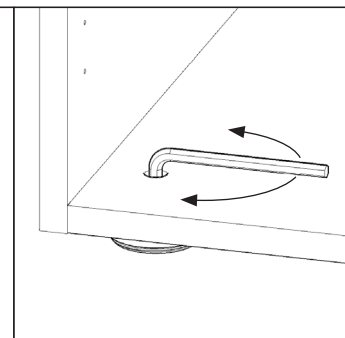

## 400-1000, 1-2 Door Robe Assembly Guide

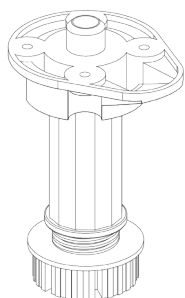

Standard Legs

### Sliding Robe Specific

#### Step 9.

The rear 2 legs (+ extra 5th leg if required) will use the existing leg positions.  
Position the 2 front legs as shown. Ensure legs are rotated to provide support to the end panels **(B)**. Secure all legs with 4 x 15mm screws and adjust all legs to 105mm.

**400 - 500 Widths: 4 Legs**

**800 - 1000 Widths: 5 Legs**

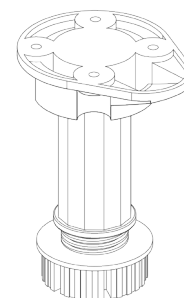

Front 2 Legs

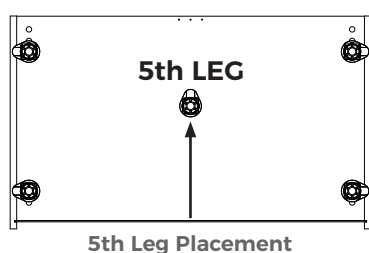

5th Leg Placement

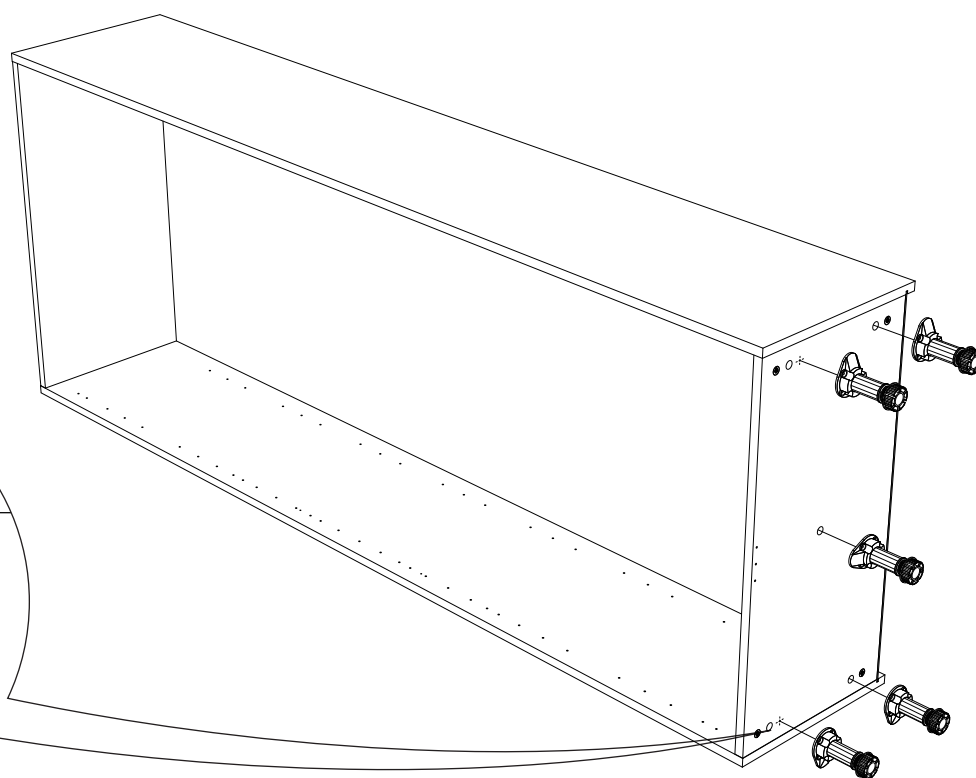
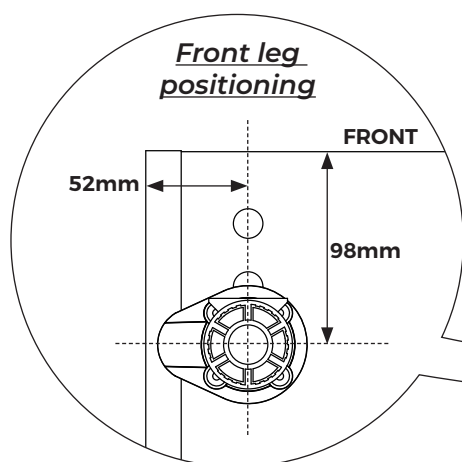

It is **important** to lift unit onto its legs. Do not tilt as depicted in image.



#### Step 10.

Lift the unit upright. Once in situ level accordingly.  
Cover leg holes with 15mm cover caps **(LL)**.

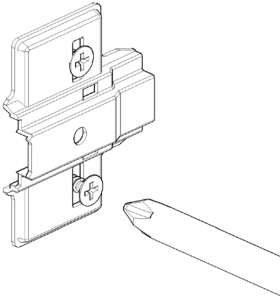

**Step 11. (Where Required)**  
Attach hinge plates onto end panels **(B)** to suit as shown using 2 screws already in hinge plates.

**Hinge side to be mounted in accordance to customer specific bedroom plan.**

2100 Robe

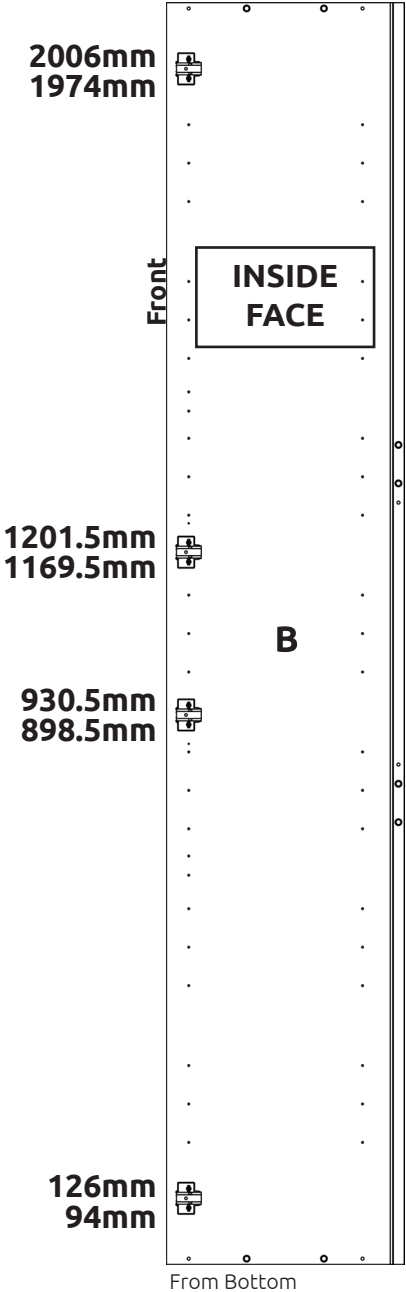



**Screws for fixing to walls are not provided as these vary depending on your wall material and construction. Ensure appropriate fixings for wall constructions are used.**

### Step 12.

Ensure the unit is level and positioned correctly.

Drill pilot holes through back panel **(A)** and rails **(D)** into the wall. Secure robe to the wall by screwing through the pilot holes into the wall. Place stick on cover caps on the heads to conceal them.

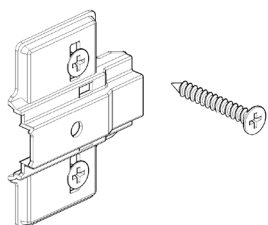

### Step 13.

Screw into any adjacent units using 30mm screws **(K)** provided to secure the unit. Screw just to the rear of the hinge plates at the top, middle and bottom on both sides. Place stick on cover caps on the heads to conceal them.

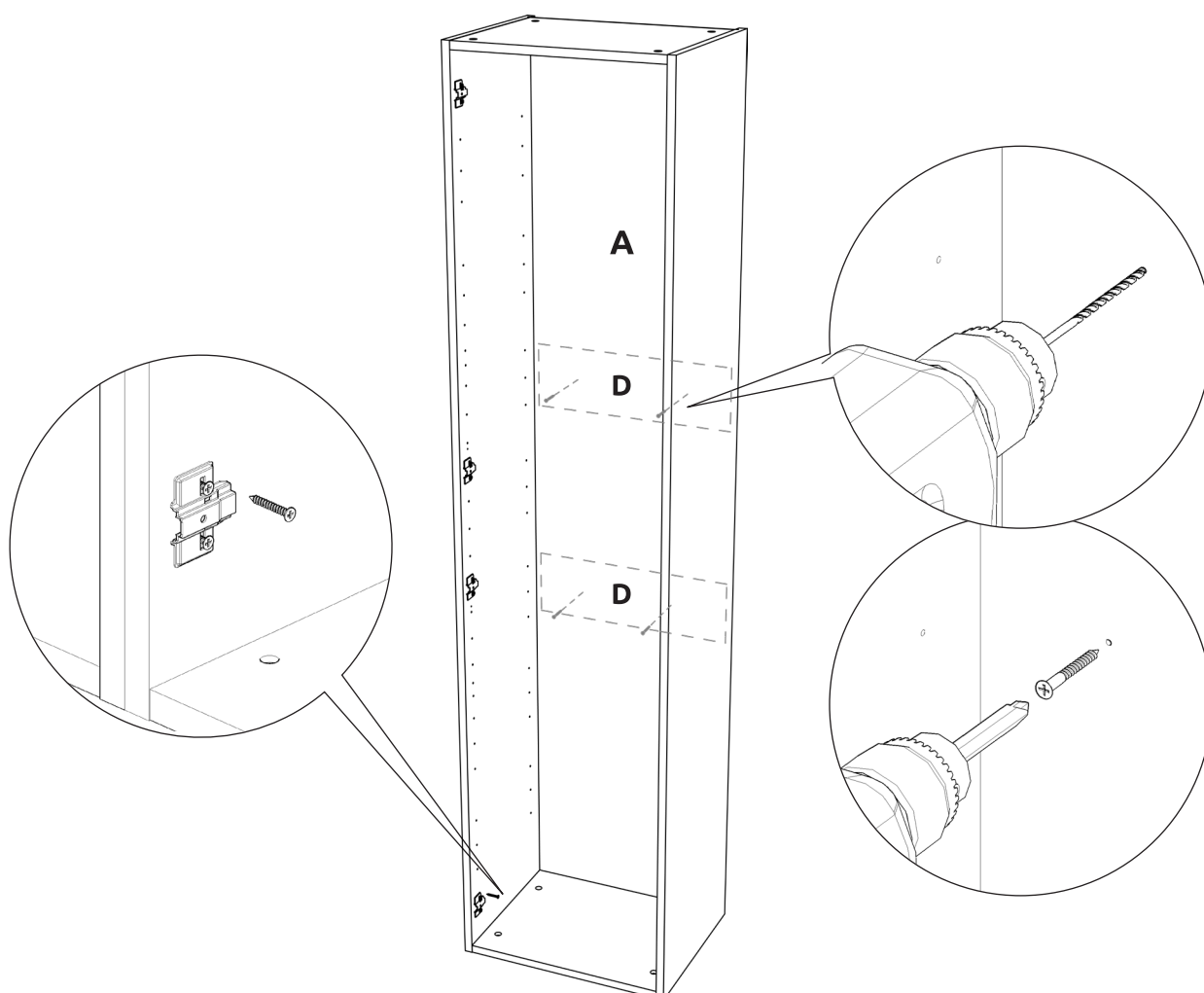



**ROBE INTERNAL LAYOUT OPTIONS**  
**inc SLIDING ROBES**

**1-2 Door**  
**4 Shelves and**  
**2 Baskets**

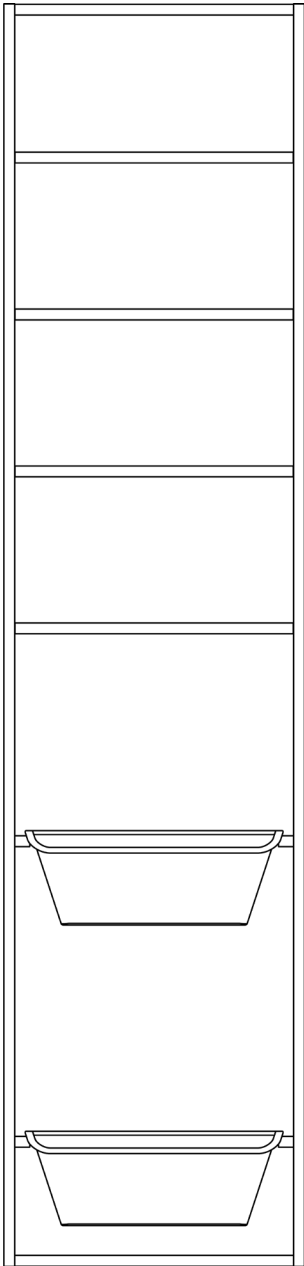

**1-2 Door**  
**7 Shelves**

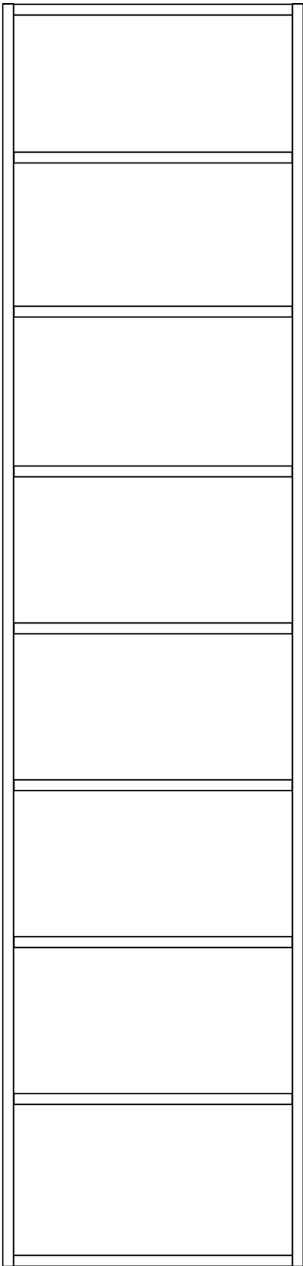

**ROBE INTERNAL LAYOUT OPTIONS  
inc SLIDING ROBES**

**2 Door - 1000 Width Specific  
6 Shelves and  
1 Front Facing Hanging Rail**

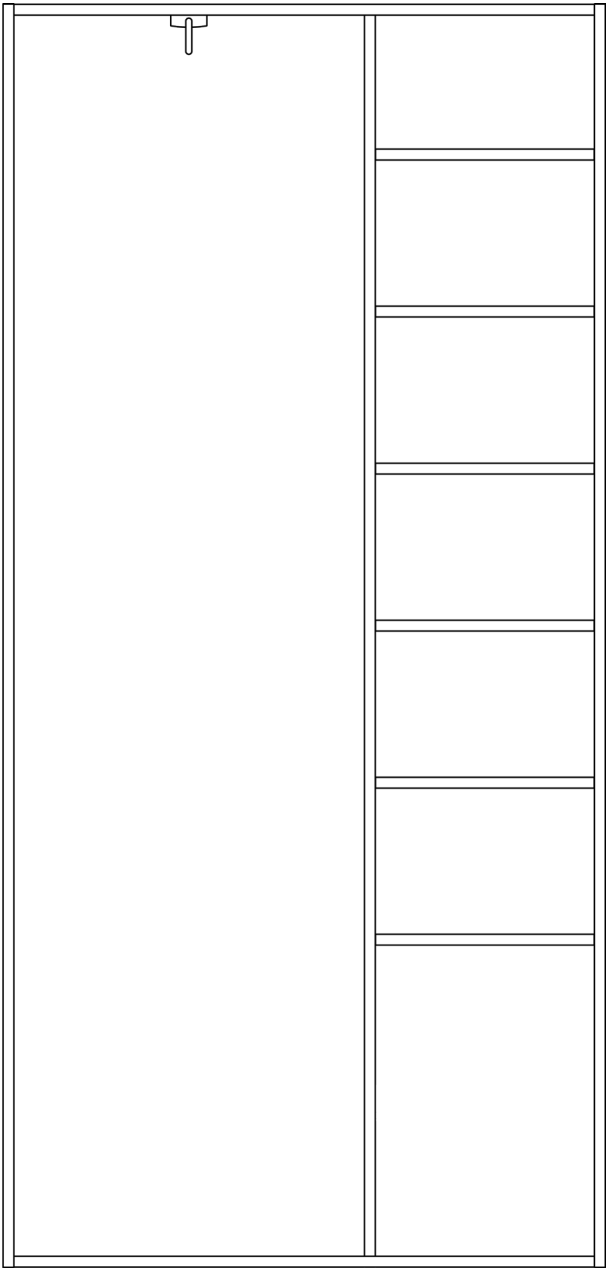

## 400-1000, 1-2 Door Robe Assembly Guide

### Divider Panel - 1000 width unit specific

On the top and bottom fixed shelves mark a line 364mm from the side.

On the marked line secure 2 x fixing blocks to the each shelf using 2 x 15mm screws (L) per fixing block.

Position the divider panel against the fixing blocks, ensure the shelf drilling is facing the correct direction and secure the divider panel to the fixing blocks using 2 x 15mm screws (L) per fixing block.

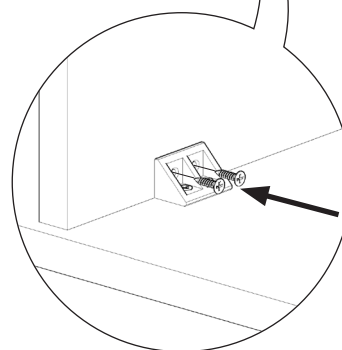
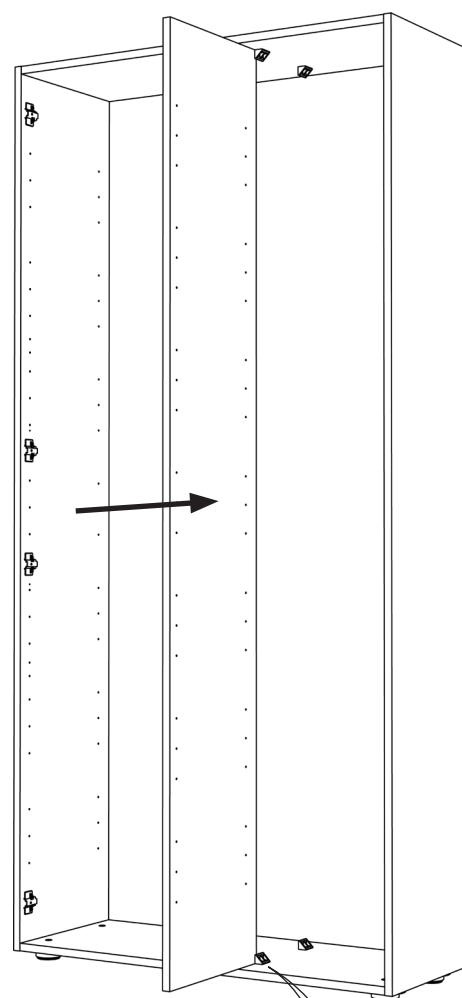
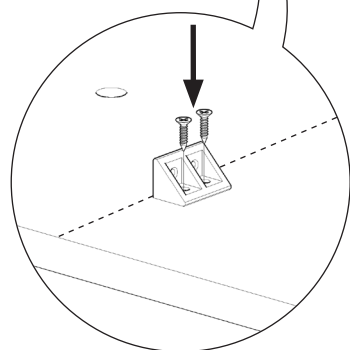
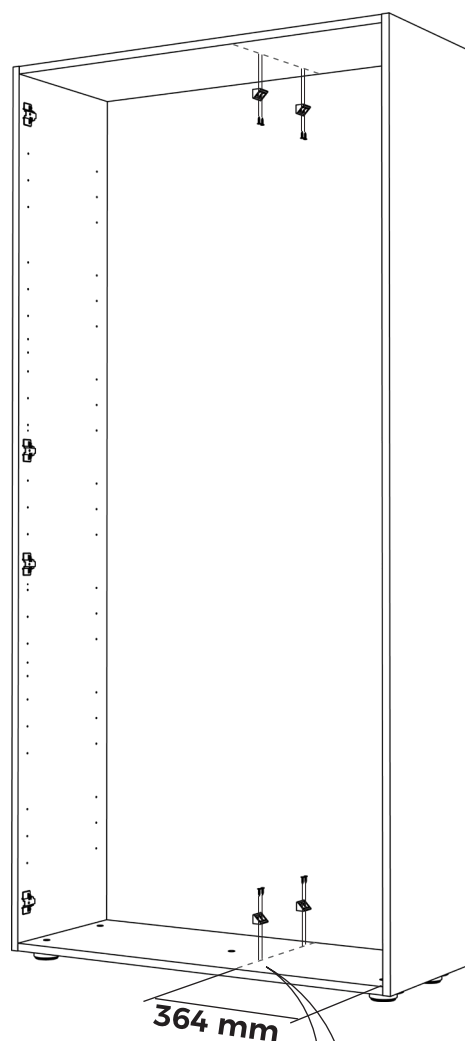

### Front Facing Hanging Rail.

Position the hanging rail in the centre of the top fixed shelf of the larger aperture and secure with 4 x 30mm screws (**K**). Ensure the front facing hanging rail is set back from the front of the fixed shelf to not clash with the rear of the robe door.

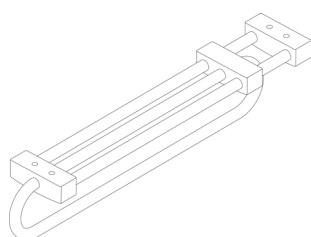
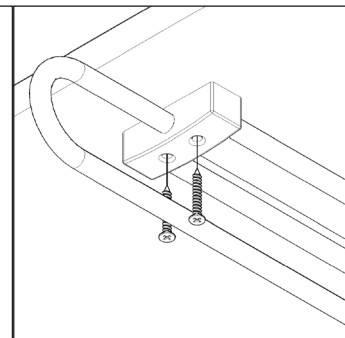

**Closed / Retracted**

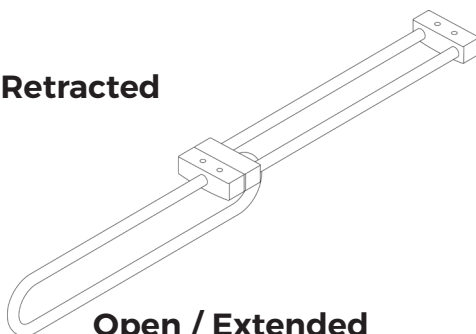

**Open / Extended**

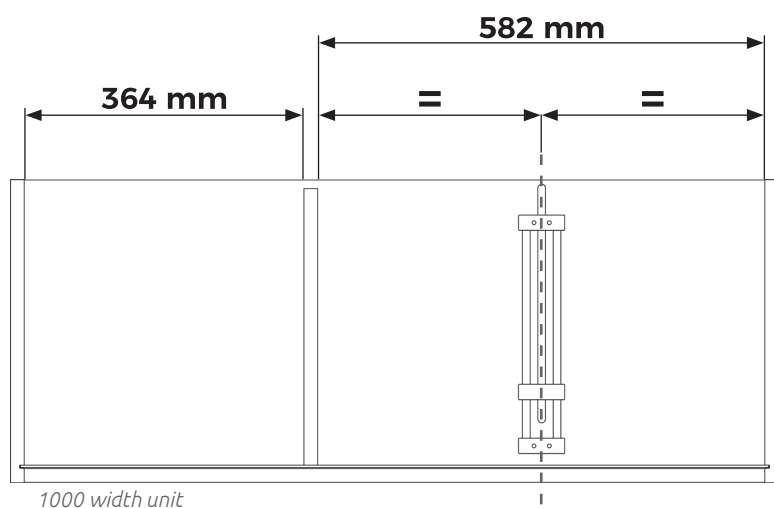
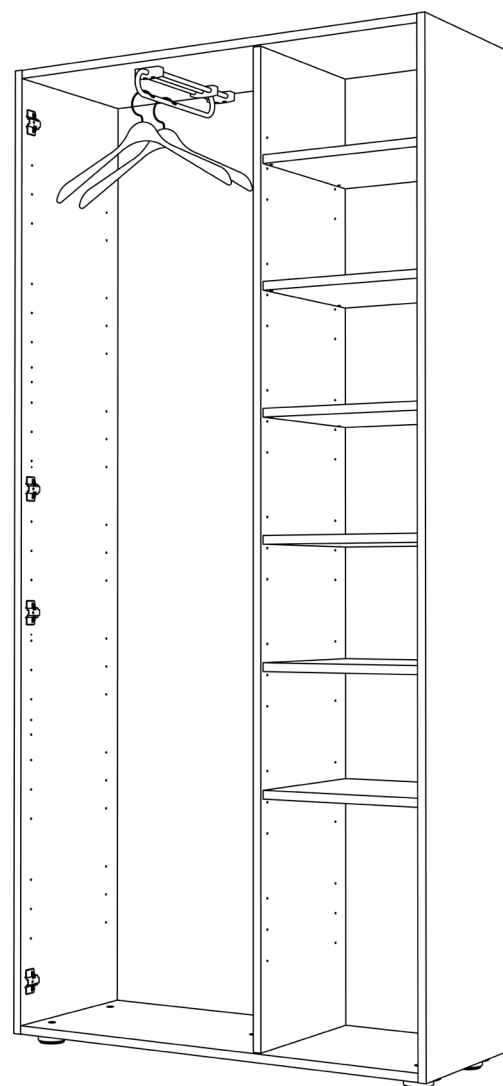

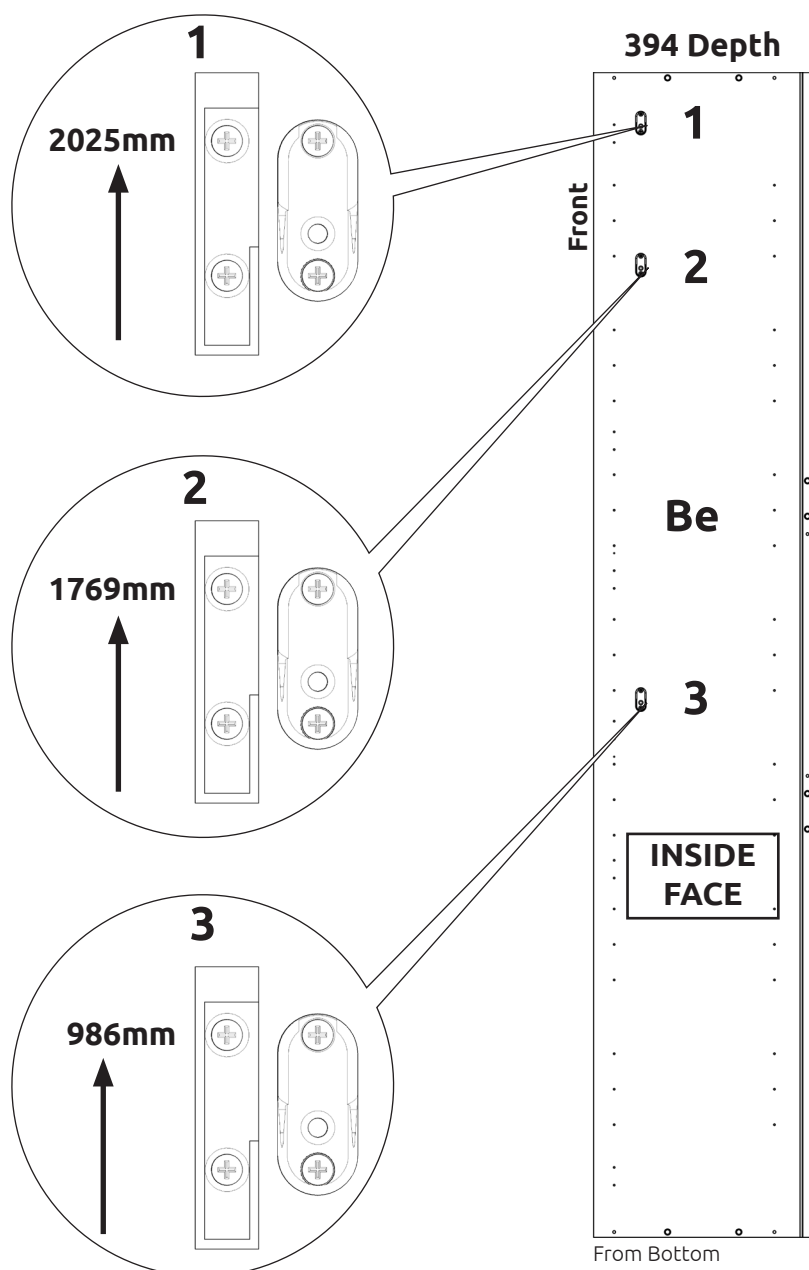
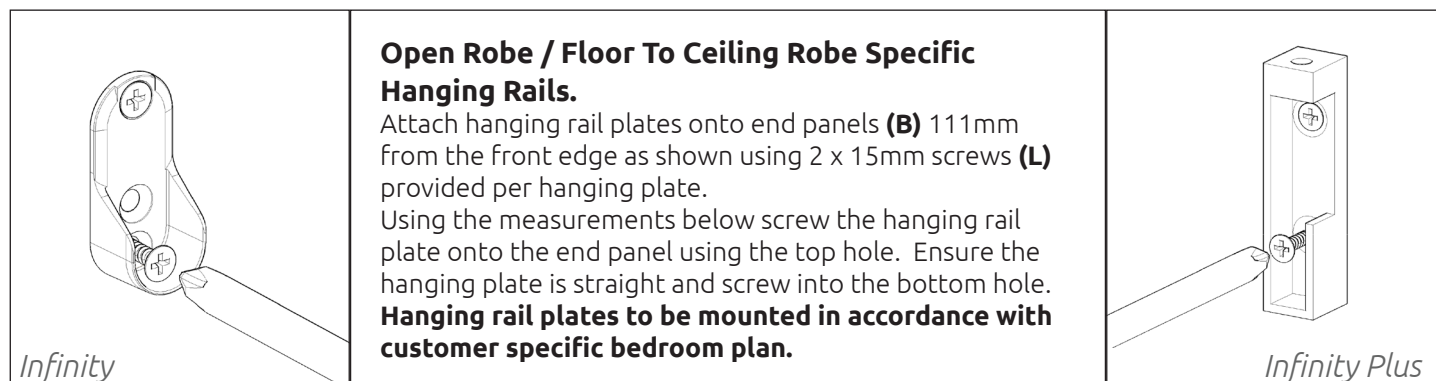

### Hanging Rail options

- 1 x Hanging Rail (1)
- 1 x Hanging Rail + 1 x Shelf (2)
- 2 x Hanging Rails + 1 Shelf (1+3)

### Hinge Attachment and Adjustment

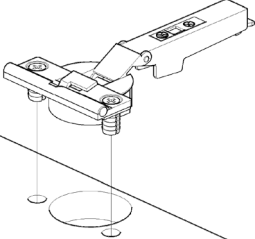
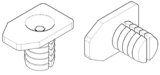
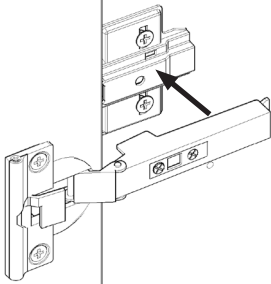
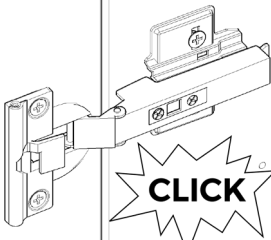
	<p><b>Step 1.</b> Insert hinges into frontal hinge holes provided, secure hinges with the 2 x screws and hinge dowels already located in the hinges.</p>  <p><i>Hinge dowels</i></p>	
	 <p><b>CLICK</b></p>	<p><b>Step 2.</b> Attach the door to unit, clip hinges onto hinge plates and click to secure.</p>
<p><b>Step 3.</b> Adjust hinges to suit, using the highlighted screw(s) shown.</p>		

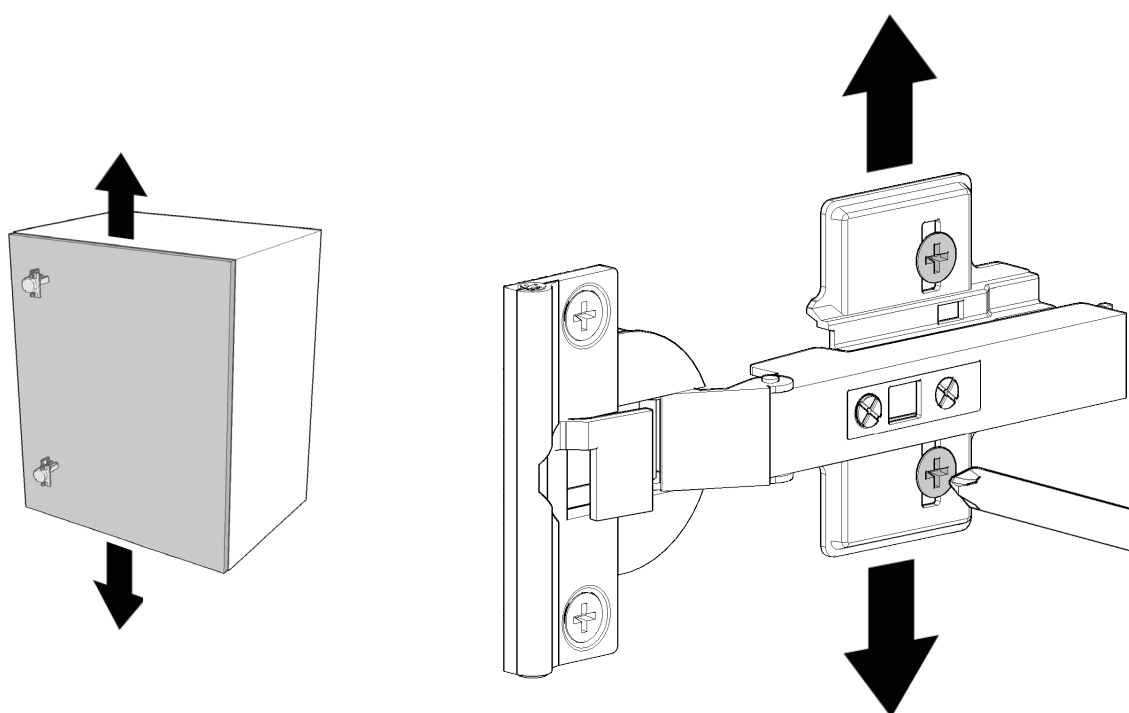

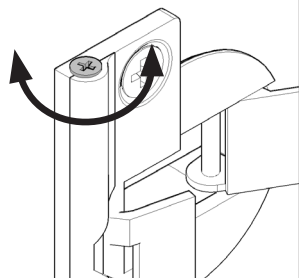
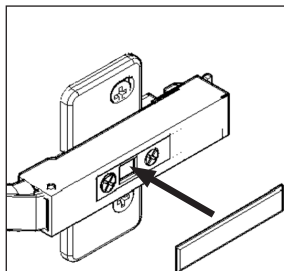
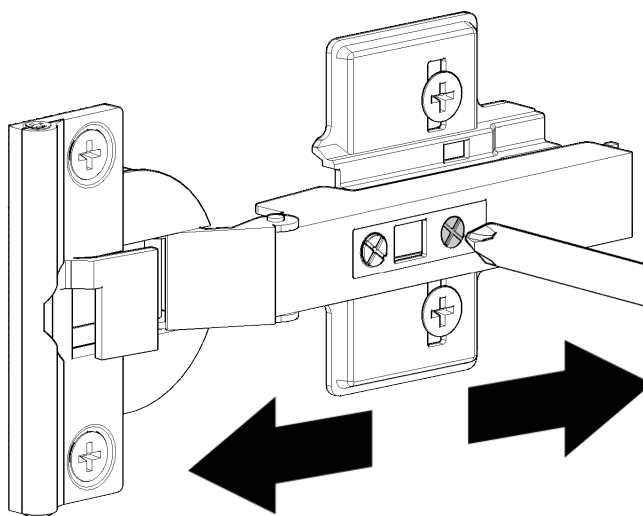
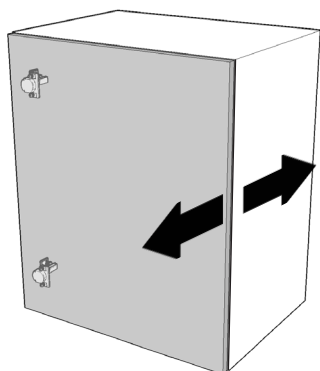
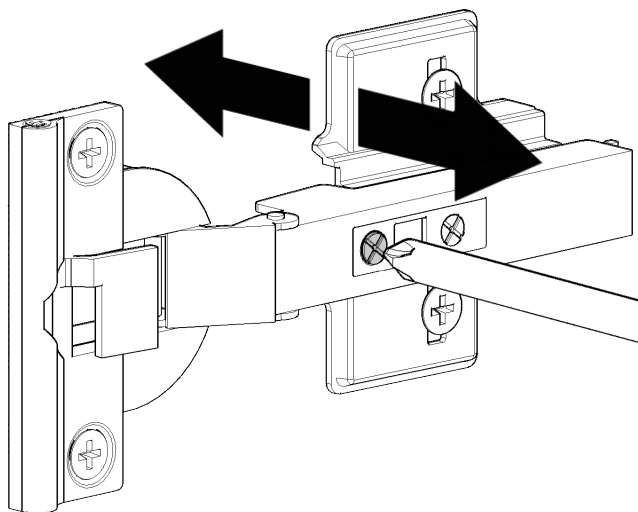
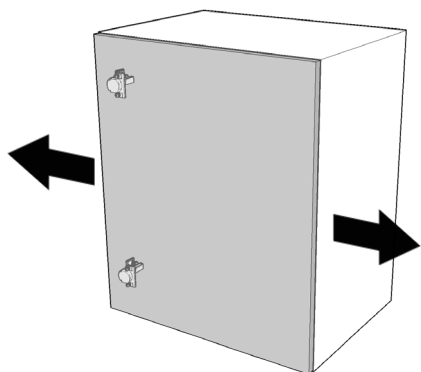

### Step 4.

Fit cover caps to hinges and adjust soft-close to suit.



The top and bottom hinges **MUST** be adjusted to the **SAME STRENGTH**.

### Loose Shelves

Secure shelf peg (JJ) to end panels (B) using 1 x 12.5mm screw (KK) per shelf peg.

4 x shelf pegs (JJ) are required per loose shelf.

Position loose shelf onto shelf pegs (JJ) ensuring the spikes on the shelf pegs locate in the holes on the bottom of the loose shelf.

**See customer specific bedroom plan for position and number of loose shelves.**

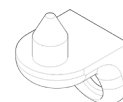

Shelf Peg



12.5mm Screw

